

## 2001-02 Drive Axles

### Drive Shafts - MDX

## INSPECTION

**NOTE:** Letters in parenthesis refer to letters in figures.

### CENTER SUPPORT BEARING & UNIVERSAL JOINTS

1. Shift into Neutral position.
2. Raise vehicle off the ground, and support it with safety stands in the proper location.
3. Check the center support bearings (A) for excessive play or rattle. If the center support bearing has excessive play or rattle, replace the driveshaft assembly. See **Fig. 1**.

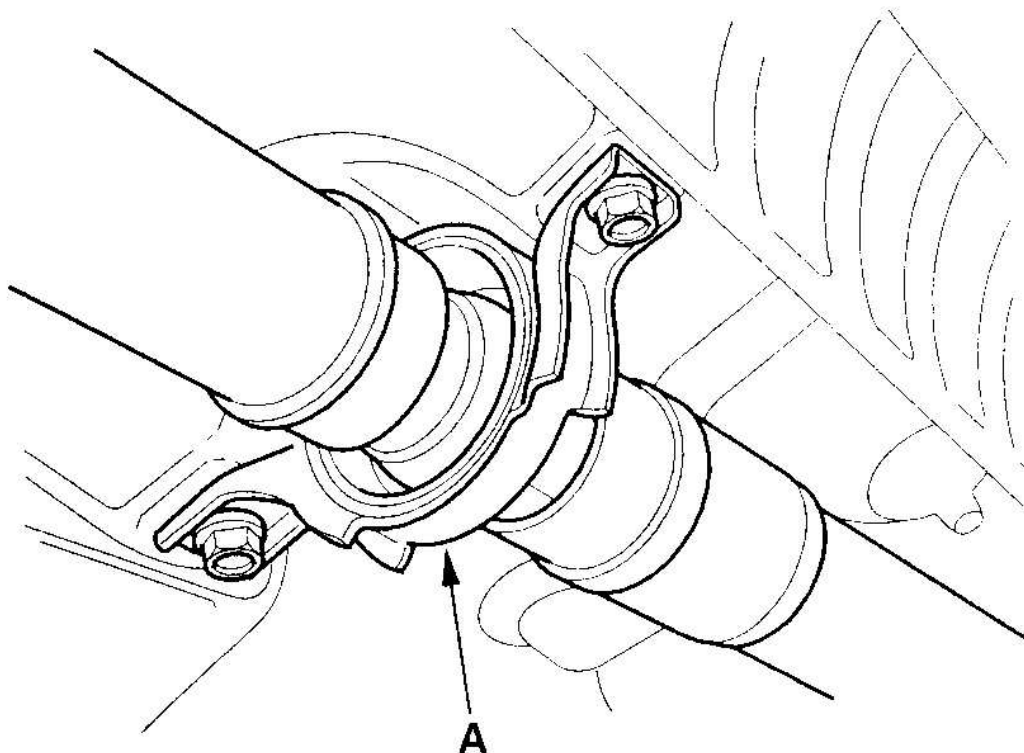

G00148111

**Fig. 1: Inspecting Center Support Bearing**  
Courtesy of AMERICAN HONDA MOTOR CO., INC.

4. Check the universal joint boots for damage and deterioration. If the boots are damaged or deteriorated, replace the driveshaft assembly.
5. Check the universal joints for excessive play or rattle. If the universal joints have excessive play or rattle, replace the driveshaft assembly.

## **DRIVESHAFT RUNOUT**

1. Install a dial indicator (A) with its needle on the center of No. 1 driveshaft (B) or No. 2 driveshaft (C). See **Fig. 2** for No. 1 driveshaft **Fig. 3** for No. 2 driveshaft.
2. Turn the other driveshaft slowly and check the runout. Repeat this procedure for the other driveshaft.
3. If the runout on either driveshaft exceeds the service limit, replace the driveshaft assembly. Drive shaft runout service limit is 1.5 mm (0.06 in.).

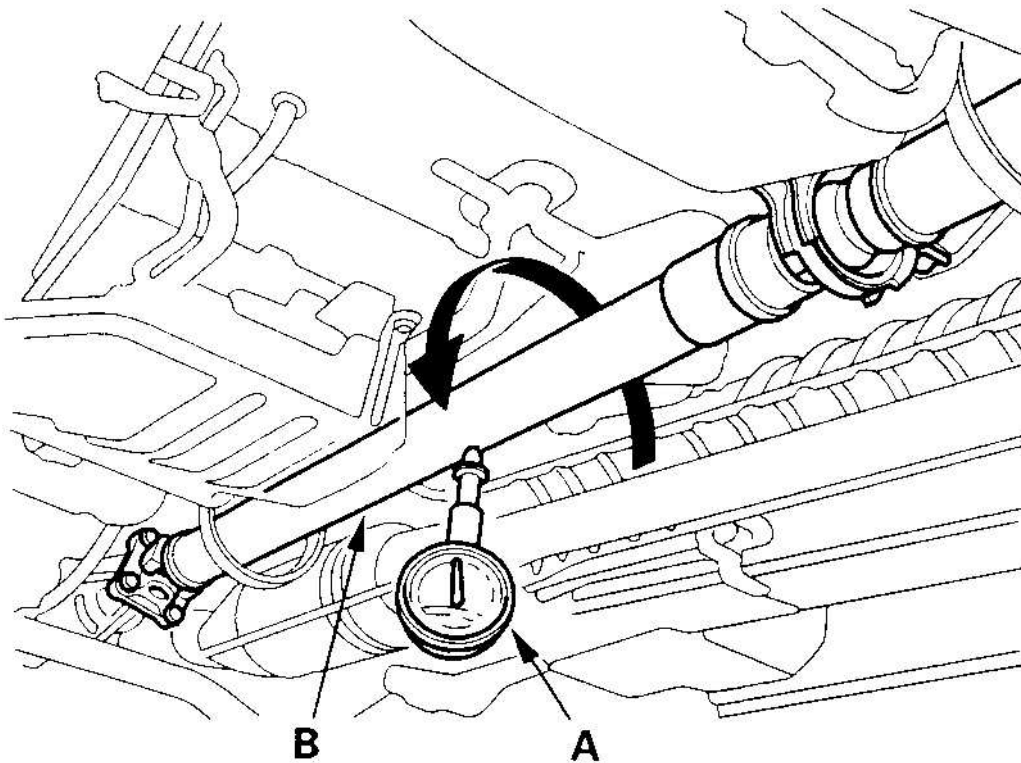

G00148112

**Fig. 2: Identifying No. 1 Driveshaft Service Limit**  
Courtesy of AMERICAN HONDA MOTOR CO., INC.

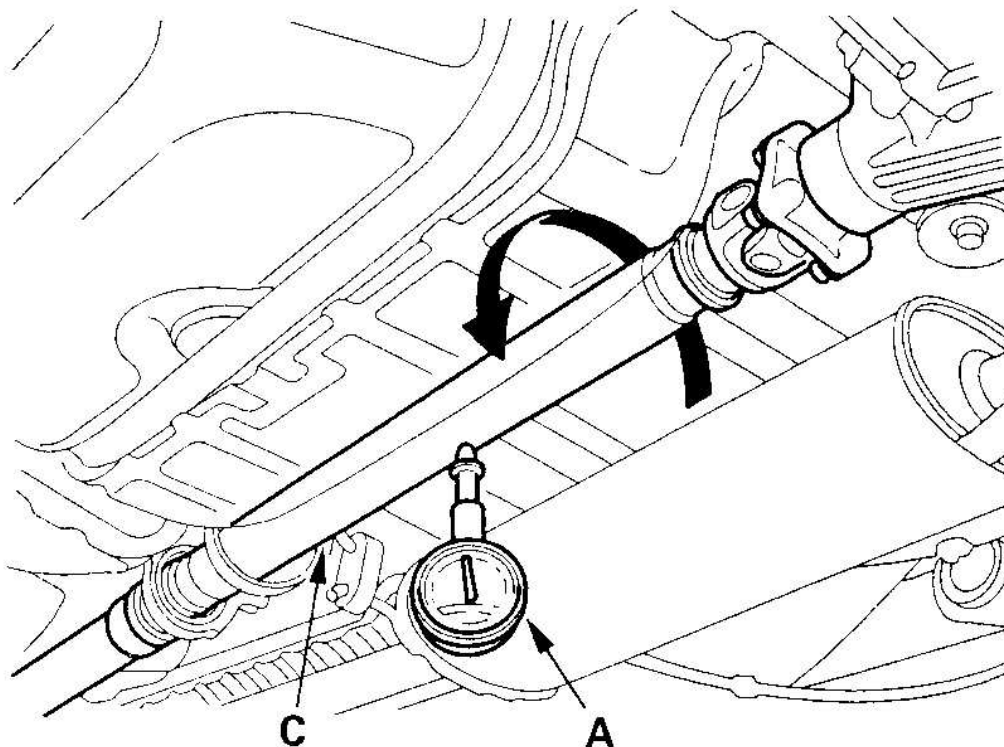

G00148113

**Fig. 3: Identifying No. 2 Driveshaft Service Limit**  
Courtesy of AMERICAN HONDA MOTOR CO., INC.

## REMOVAL & INSTALLATION

**NOTE:** Letters in parenthesis refer to letters in figures.

### DRIVESHAFT

**NOTE:** Driveshaft may also be called propeller shaft.

#### Removal

1. Raise the vehicle off the ground, and support it with safety stands in the proper location.
2. Remove the No. 1 driveshaft protector. See **Fig. 4**.

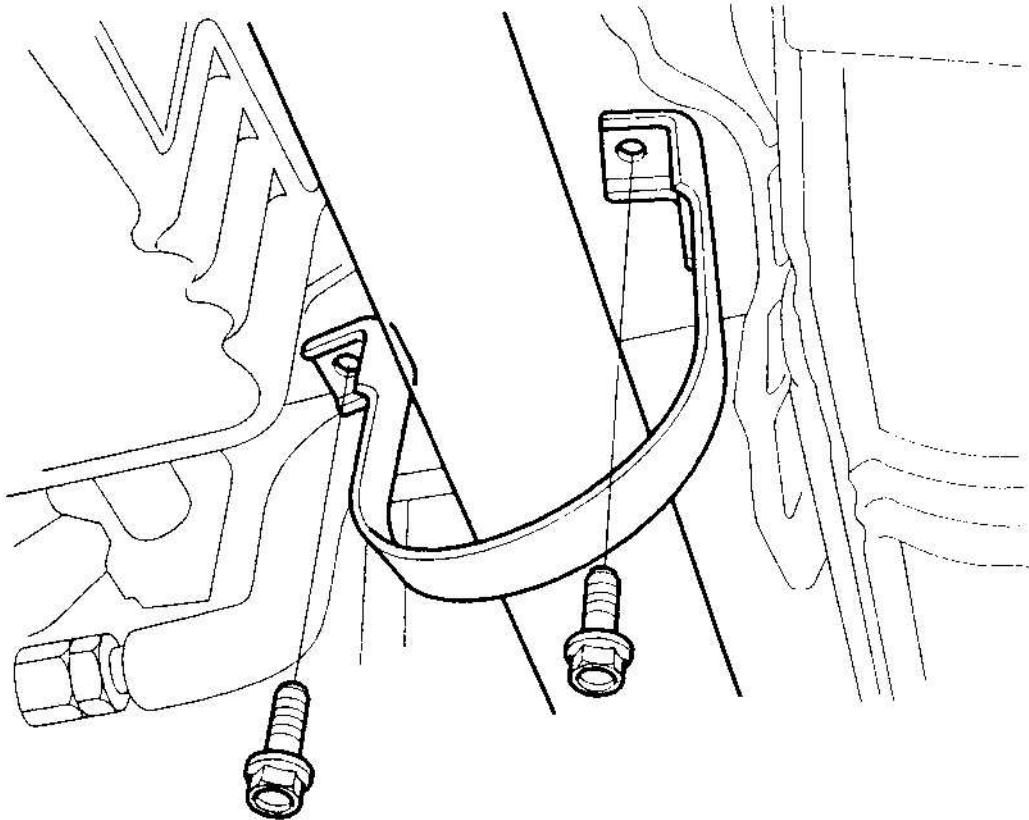

G00148114

**Fig. 4: Removing & Installing No. 1 Driveshaft Protector**  
Courtesy of AMERICAN HONDA MOTOR CO., INC.

3. Remove the No. 2 driveshaft protector. See **Fig. 5** .

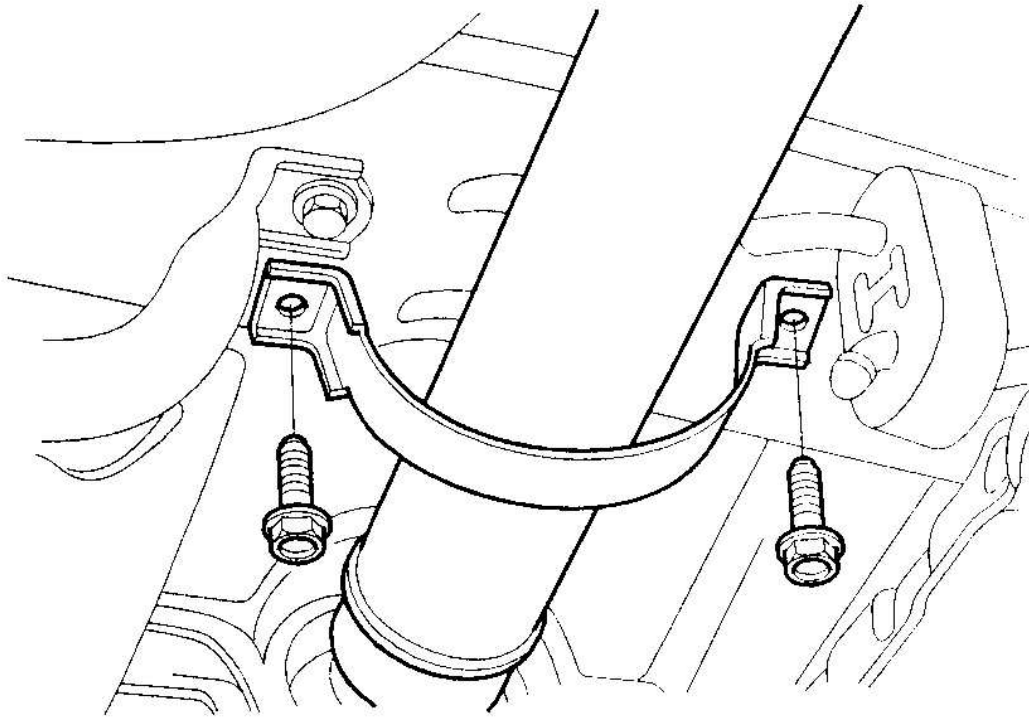

G00148115

**Fig. 5: Removing & Installing No. 2 Driveshaft Protector**  
Courtesy of AMERICAN HONDA MOTOR CO., INC.

4. Make a reference mark (A) across the driveshaft (B) and transfer companion flange (C). See **Fig. 6** .

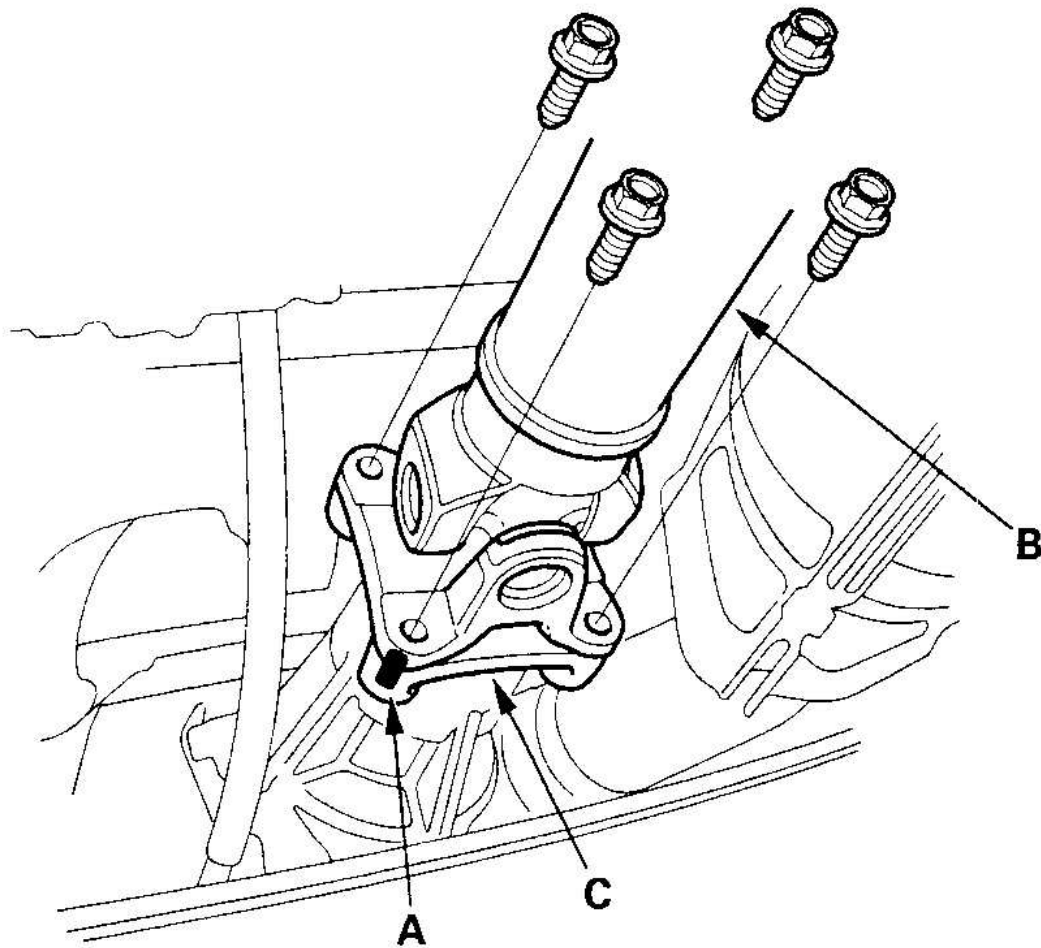

G00148116

**Fig. 6: Marking Driveshaft & Transfer Companion Flange**  
Courtesy of AMERICAN HONDA MOTOR CO., INC.

5. Separate the driveshaft from the transfer assembly.
6. Remove the center support bearing mounting bolts. See **Fig. 7**.



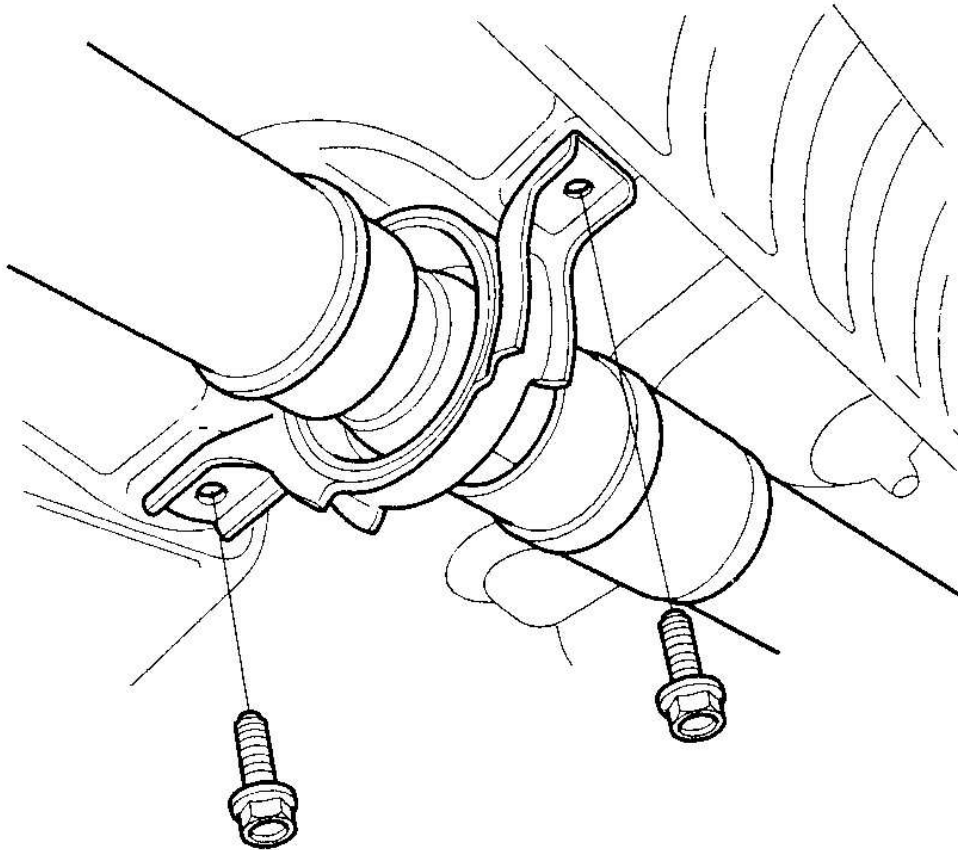

G00148117

**Fig. 7: Removing & Installing Center Support Bearing Mounting Bolts**  
Courtesy of AMERICAN HONDA MOTOR CO., INC.

7. Make a reference mark (A) across the driveshaft (B) and rear differential companion flange (C). See **Fig. 8**.
8. Separate the driveshaft from the rear differential, then remove the driveshaft.

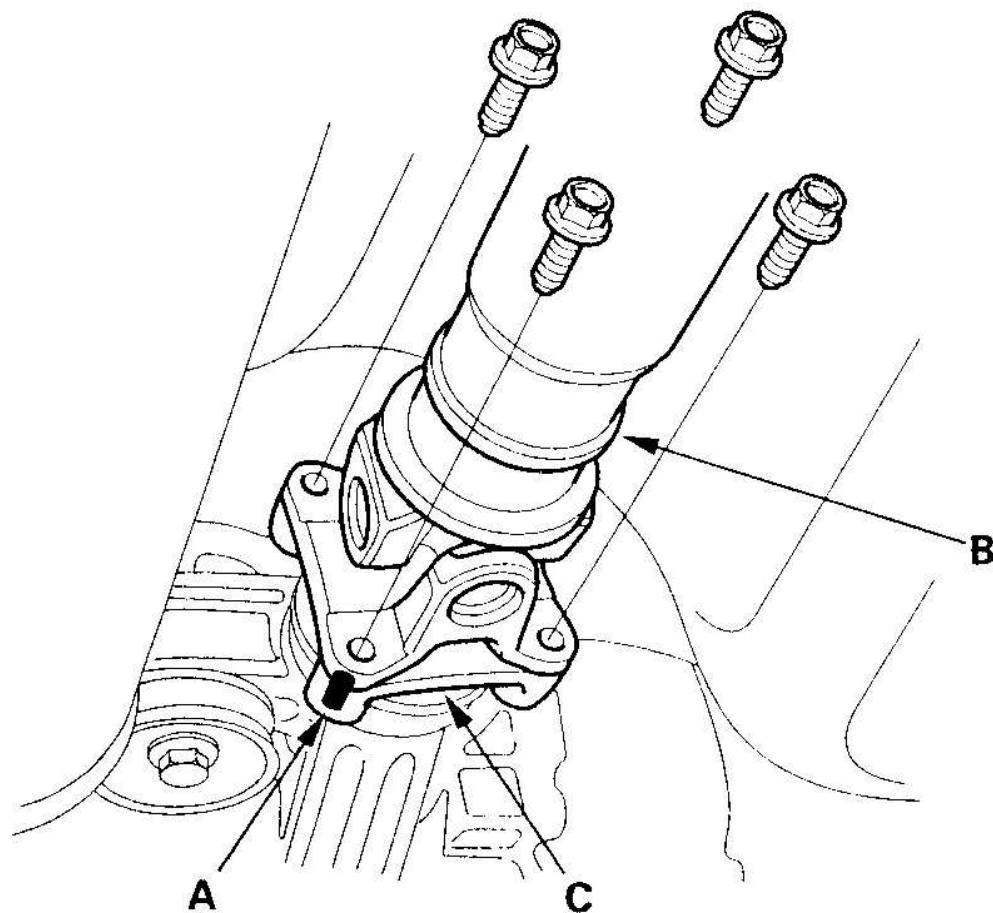

G00148118

**Fig. 8: Marking Driveshaft & Rear Differential Companion Flange**  
Courtesy of AMERICAN HONDA MOTOR CO., INC.

**Installation**

1. Install the new driveshaft (A) onto the rear differential (B), by aligning the reference mark (C). See **Fig. 9**.
2. Attach the driveshaft (B) to the rear differential (C) with NEW mounting bolts. See **Fig. 8**.



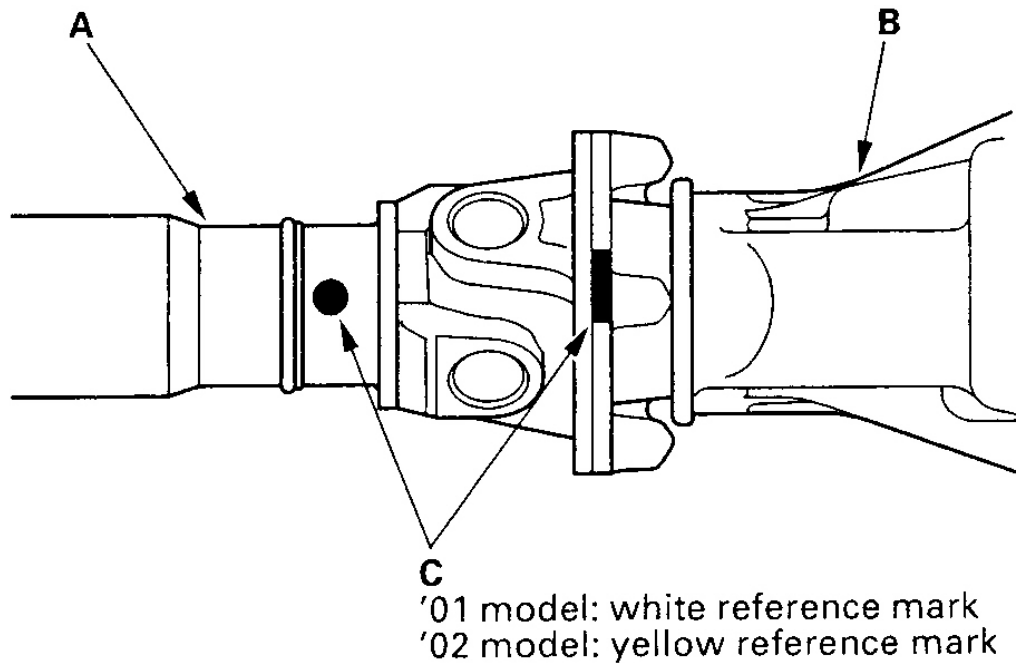

G00148119

**Fig. 9: Installing Driveshaft Onto Rear Differential**  
Courtesy of AMERICAN HONDA MOTOR CO., INC.

3. Install the center support bearing mounting bolts. Make sure you use new mounting bolts. See **Fig. 7**.
4. Install the driveshaft (B) onto the transfer (C) by aligning the reference mark (A). Make sure you use new mounting bolts. See **Fig. 6**.
5. Install the No. 2 driveshaft protector. See **Fig. 5**.
6. Install the No. 1 driveshaft protector. See **Fig. 4**.

## TORQUE SPECIFICATIONS

### TORQUE SPECIFICATIONS

Application	Ft. Lbs. (N.m)
Center Support-To-Body Bolts	29 (39)
Driveshaft To Rear Differential/Transfer Case Bolts <sup>(1)</sup>	53 (72)
Driveshaft Protector Bolts	17 (22)
(1) Manufacturer recommends using new bolts during installation.	