

2003-06 ACCESSORIES & EQUIPMENT

Doors - MDX

COMPONENT LOCATION INDEX - FRONT DOOR

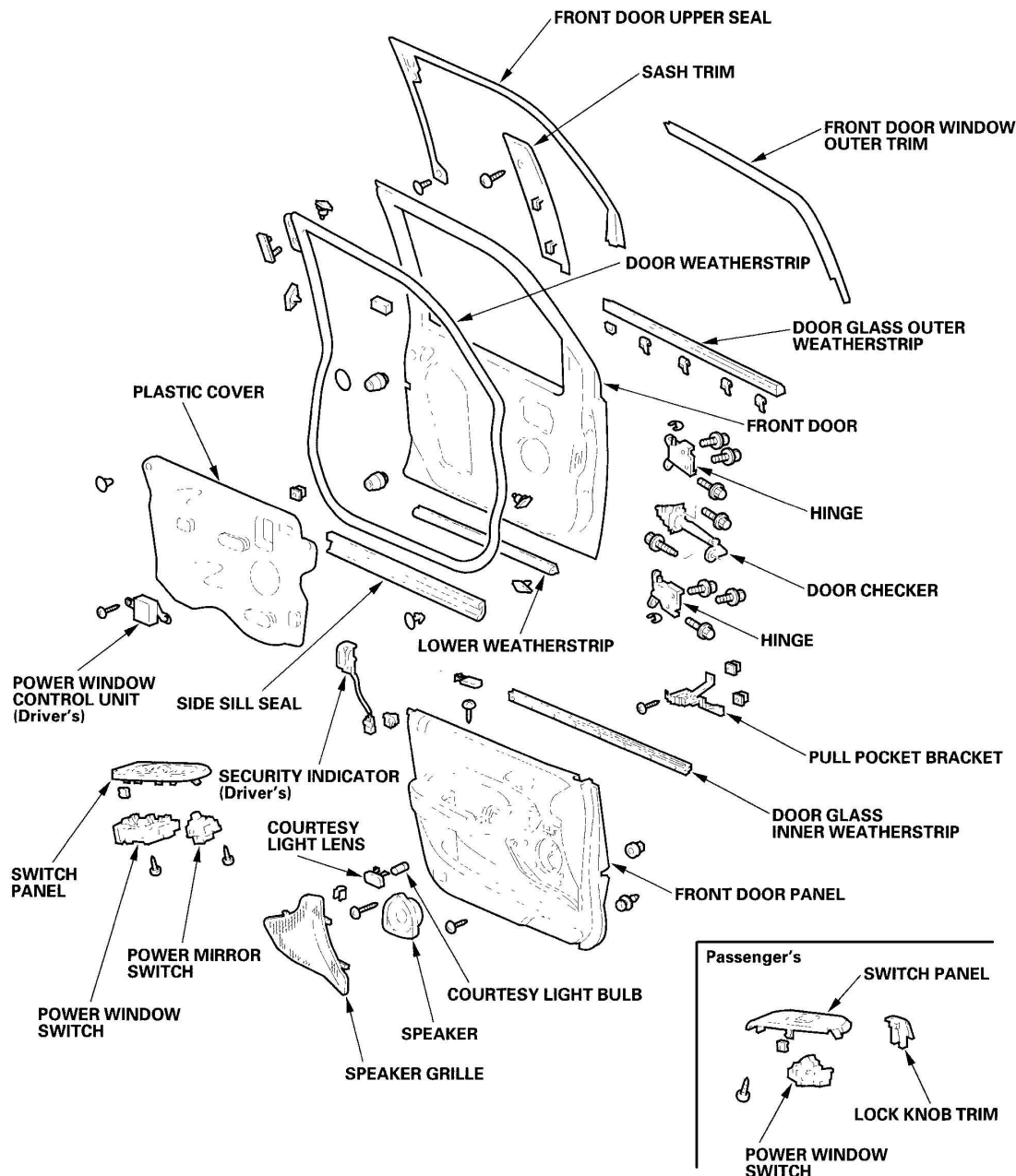

G03641477

Fig. 1: Component Location Index - Front Door (1 Of 2)
 Courtesy of AMERICAN HONDA MOTOR CO., INC.

2006 Acura MDX

2003-06 ACCESSORIES & EQUIPMENT Doors - MDX

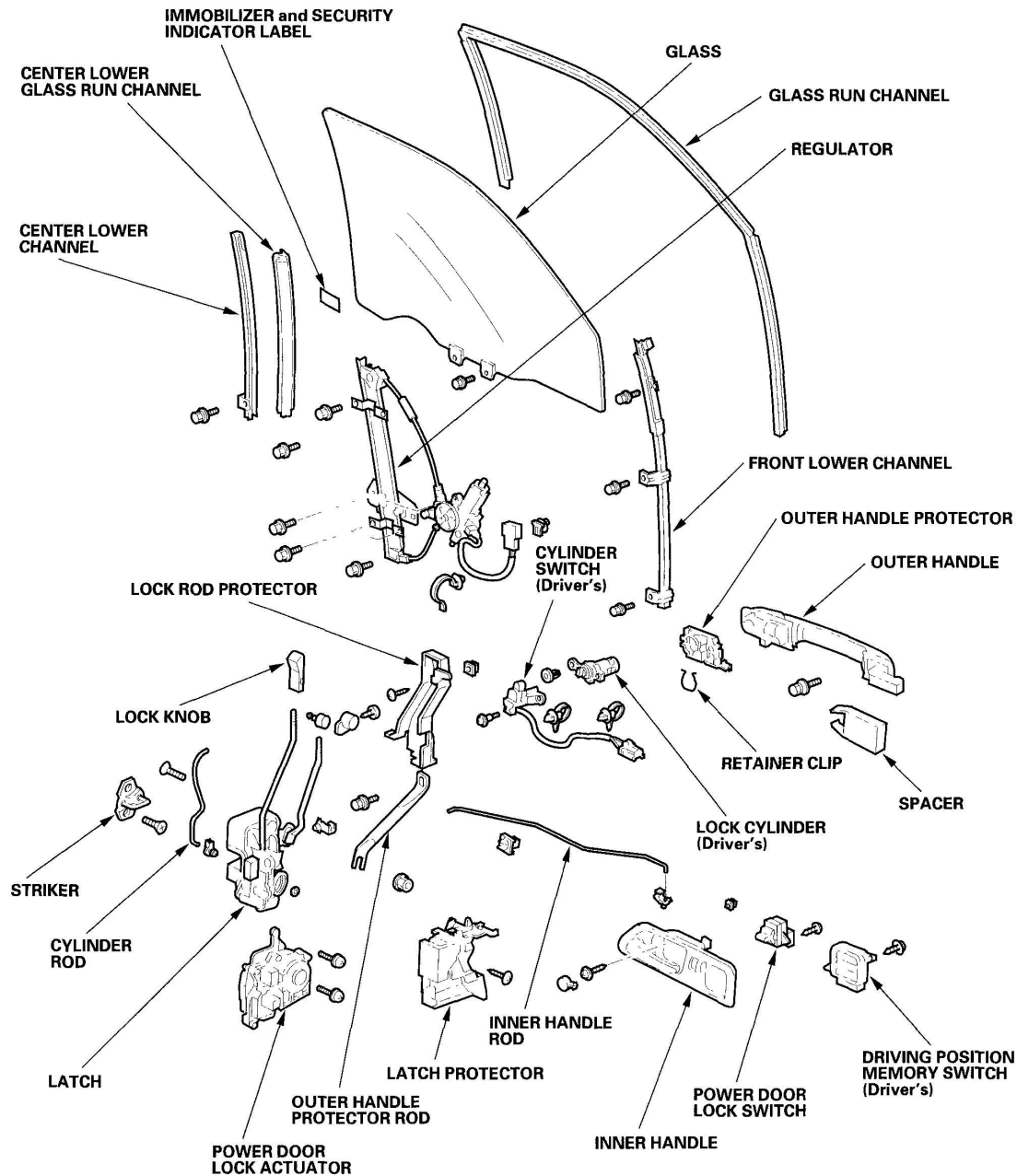

G03641478

Fig. 2: Component Location Index - Front Door (2 Of 2)

Courtesy of AMERICAN HONDA MOTOR CO., INC.

COMPONENT LOCATION INDEX - REAR DOOR

2006 Acura MDX

2003-06 ACCESSORIES & EQUIPMENT Doors - MDX

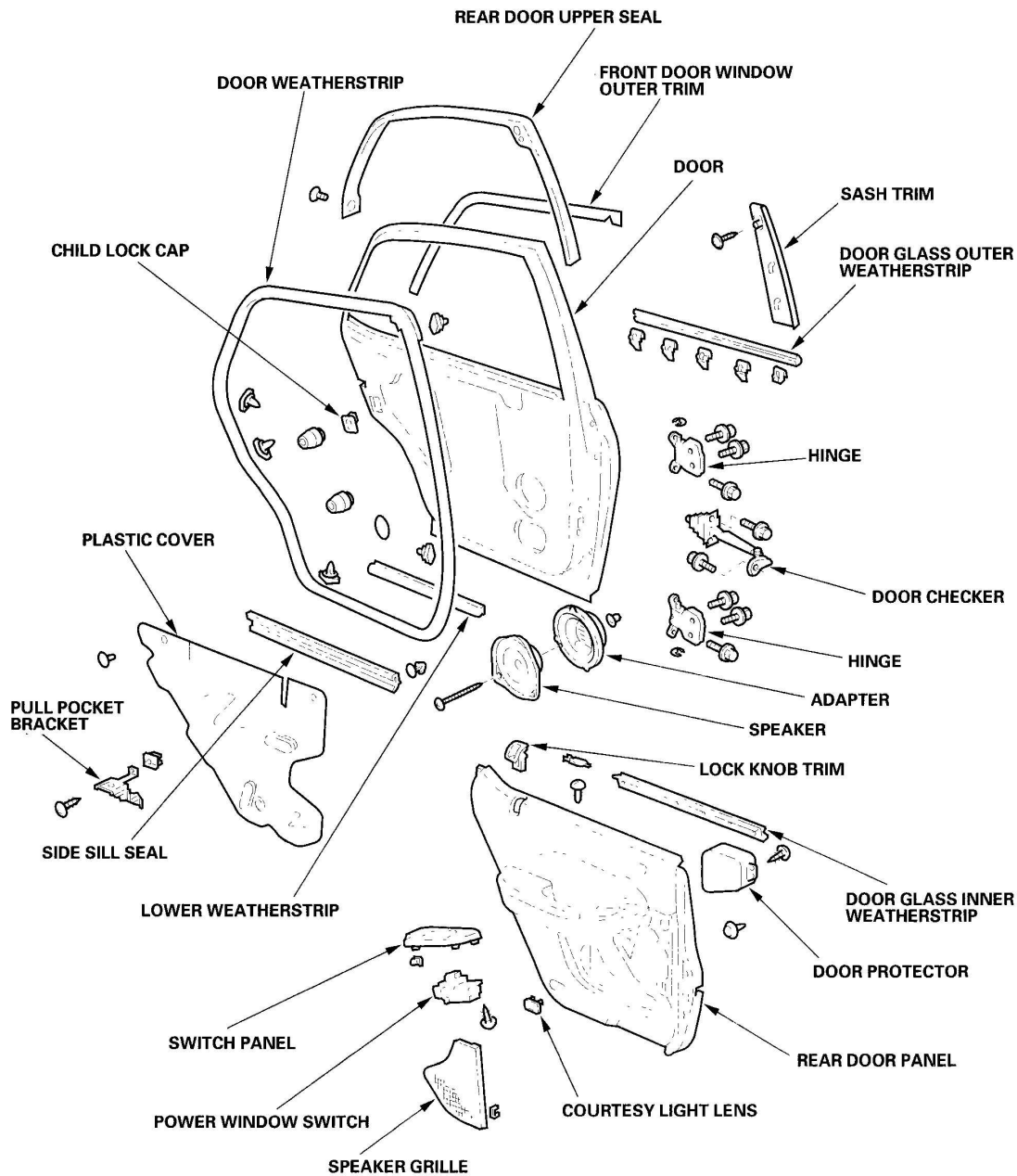

G03641479

Fig. 3: Component Location Index - Rear Door (1 Of 2)
Courtesy of AMERICAN HONDA MOTOR CO., INC.

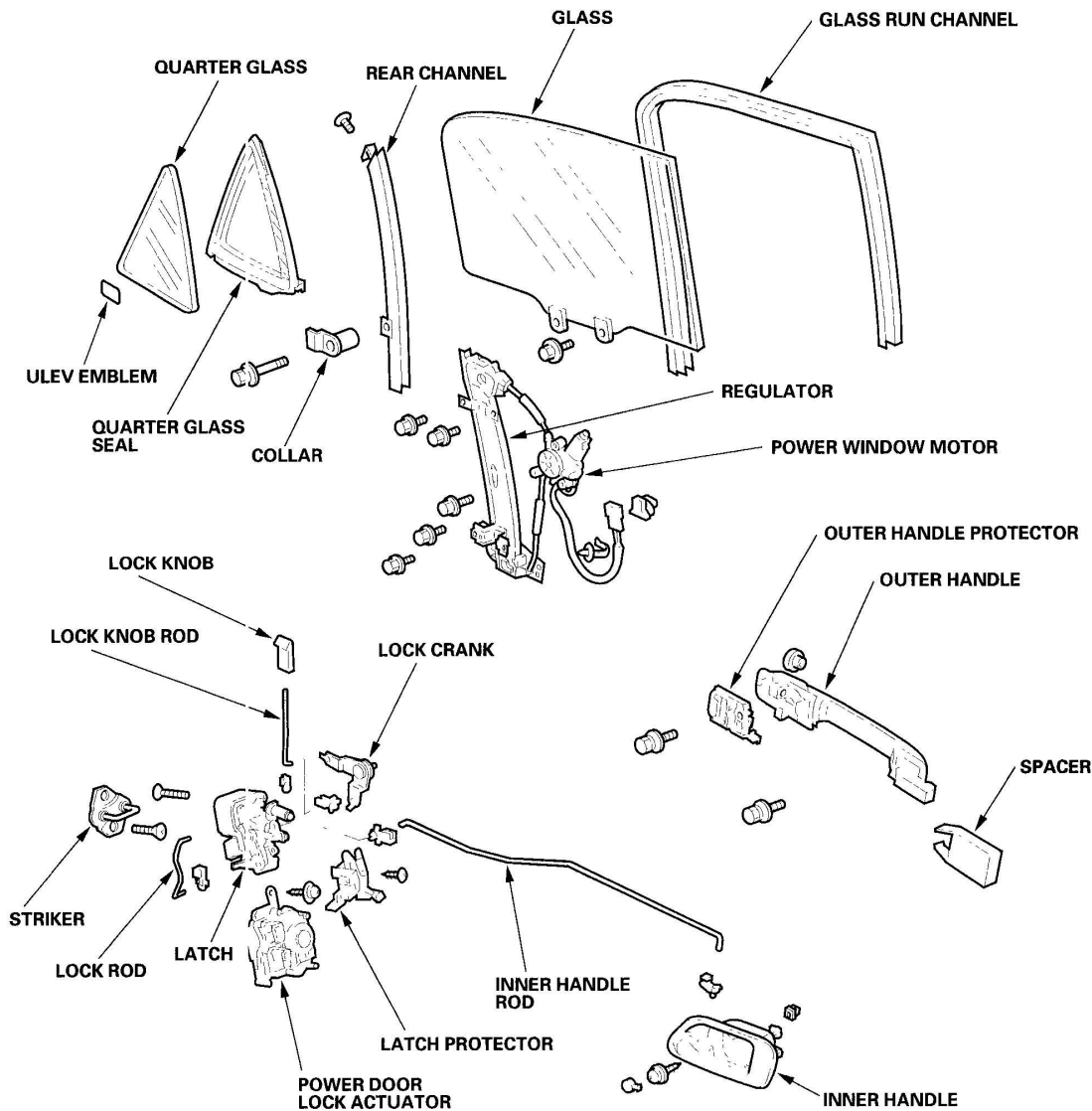

G03641480

Fig. 4: Component Location Index - Rear Door (2 Of 2)

Courtesy of AMERICAN HONDA MOTOR CO., INC.

FRONT DOOR PANEL REMOVAL/INSTALLATION

Special Tools Required

- KTC trim tool set SOJATP2014
- Trim pad remover, Snap-on A 177A or equivalent

NOTE: Use the appropriate tool from the KTC trim tool set to avoid damage when prying components.

1. Remove the mirror mount cover (see step 2 in **POWER MIRROR REPLACEMENT**). Take care not to scratch the door panel.
2. Remove the inner handle (A). Take care not to scratch the door panel.
 - 1 Pry out the cap (B), and remove the screw (C).
 - 2 Pull the inner handle forward and out half-way.
 - 3 Disconnect the inner handle rod (D) from the joint bushing (E), and power door lock switch connector (F). For some models: On driver's side, disconnect the driving position memory switch connector (G).

NOTE: Check the bushing for damage, and replace if necessary.

Fastener Location

C ► : Screw, 1

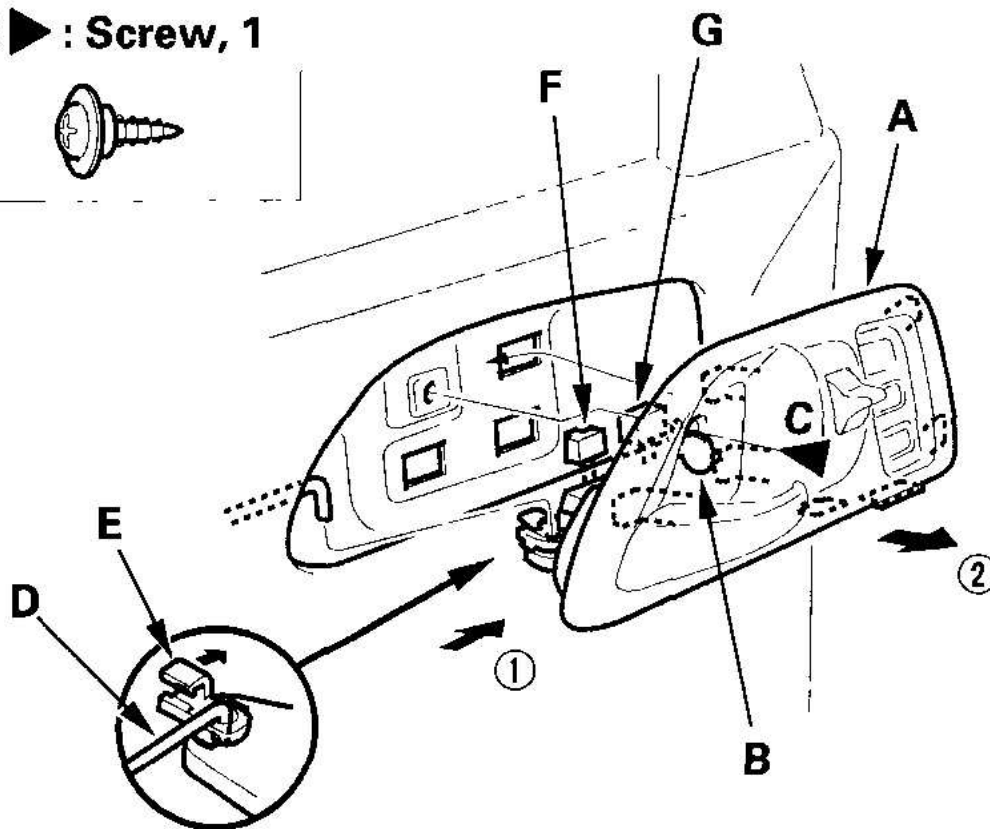
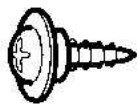

G03641481

Fig. 5: Removing Inner Handle
Courtesy of AMERICAN HONDA MOTOR CO., INC.

- Detach the clips (A) and hooks (B), then remove the speaker grille (C). Remove the screws (D).

Fastener Locations

A ▷ : Clip, 2 D ► : Screw, 3

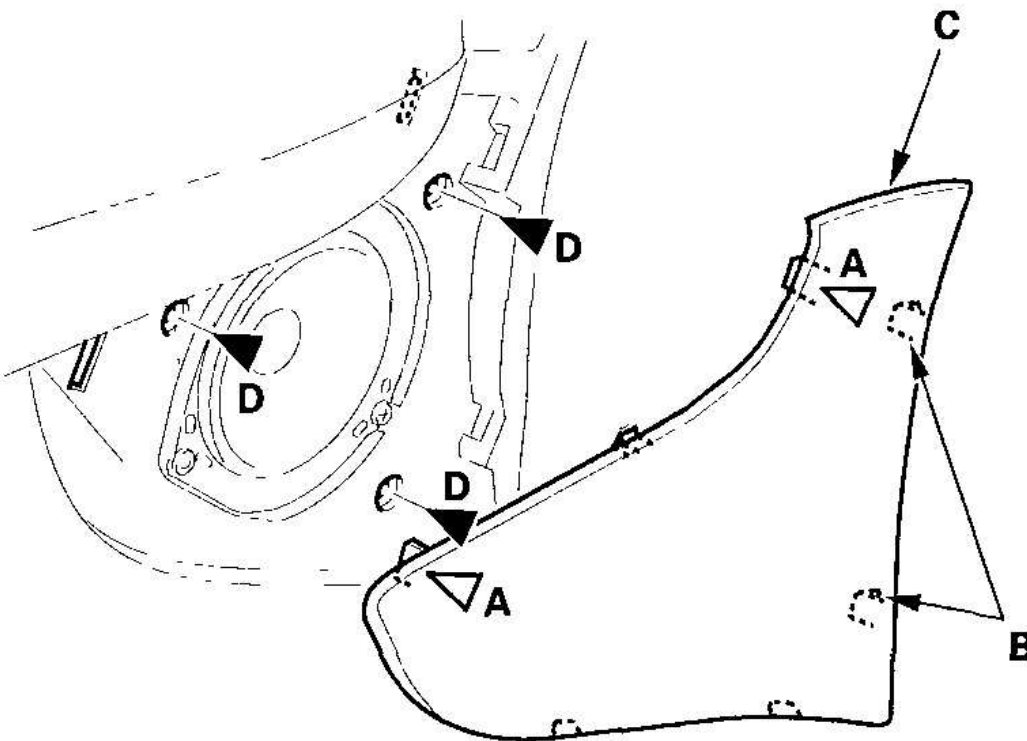
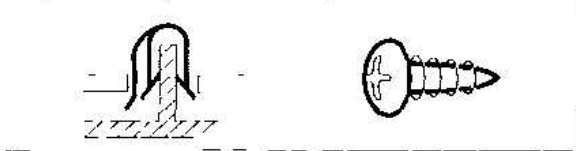

G03641482

Fig. 6: Removing Speaker Grille

Courtesy of AMERICAN HONDA MOTOR CO., INC.

- Detach the clips (A) and release the hooks (B), then remove the switch panel (C). Take care not to scratch the door panel. Disconnect the power window switch (door multiplex control unit) connectors (D). On driver's side, disconnect the power mirror switch connector (E).

Fastener Locations

A▷ : Clip, 3 G▶ : Screw, 1

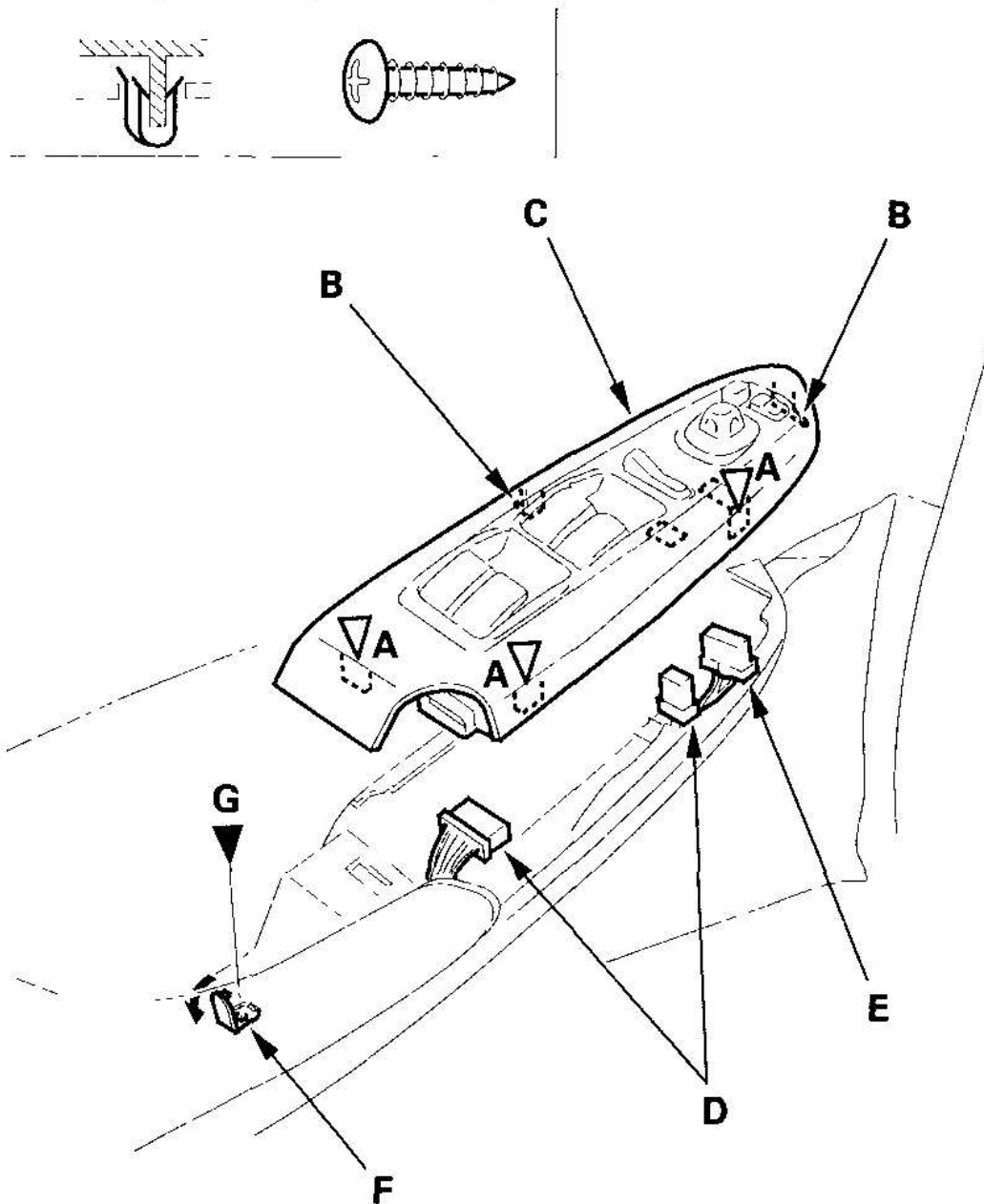

G03641483

Fig. 7: Removing Switch Panel (Driver's)

2006 Acura MDX
2003-06 ACCESSORIES & EQUIPMENT Doors - MDX

Courtesy of AMERICAN HONDA MOTOR CO., INC.

5. Pry out the cap (F), and remove the screw (G).
6. Release the clips that hold the door panel (A) with a commercially available trim pad remover (B), then remove the door panel by pulling it upward. Disconnect the speaker connector (C). On driver's side, disconnect the front door subharness connector (D). On passenger's side, disconnect the courtesy light bulb socket (E), and detach the harness clip (F) from the panel. Remove the door panel with as little bending as possible to avoid creasing or breaking it.

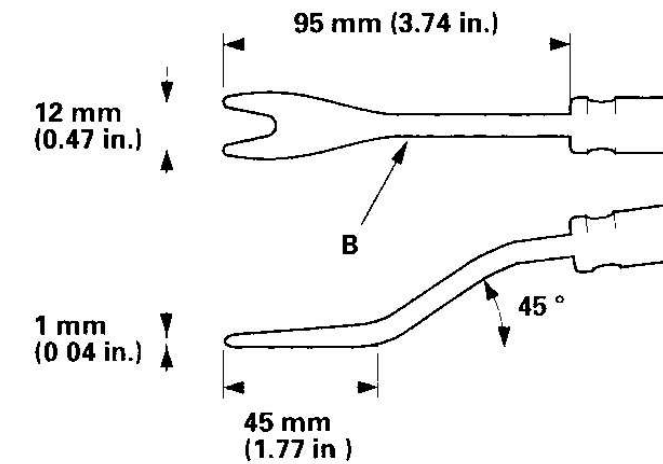

Fastener Locations

▷ : Clip, 8

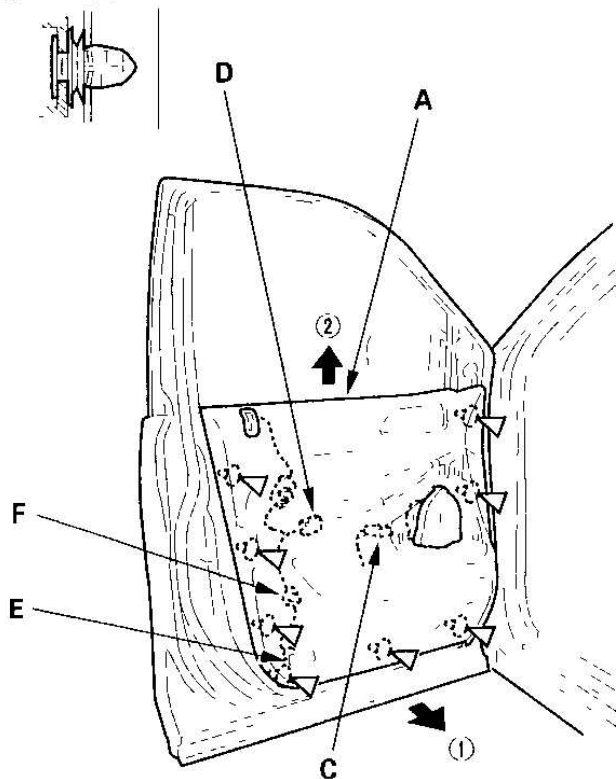

G03641484

Fig. 8: Releasing Clips Holding Door Panel With Trim Pad Remover
 Courtesy of AMERICAN HONDA MOTOR CO., INC.

7. Install the door panel in the reverse order of removal, and note these items:

- Check the clip(s) for damage or stress-whitened, and replace them with new one(s).
- Make sure the connectors are plugged in properly, and the inner handle rod and courtesy light bulb socket are connected properly.
- Push the clips into place securely.
- Do the power window control unit reset procedure (see **RESETTING THE POWER WINDOW CONTROL UNIT**).
- Make sure the window and power door locks operate properly.
- If equipped with driving position memory switch, check for proper operation.

FRONT DOOR OUTER HANDLE REPLACEMENT

NOTE: **Put on gloves to protect your hands.**

1. Raise the glass fully.
2. Remove these items:
 - Mirror mount cover (see step 2 in **POWER MIRROR REPLACEMENT**)
 - Door panel (see **FRONT DOOR PANEL REMOVAL/INSTALLATION**)
 - Plastic cover, as necessary (see **COMPONENT LOCATION INDEX - FRONT DOOR**)
3. Remove the bolt, then remove the center lower channel (A) with the center lower glass run channel (B) by pulling it downward.

Fastener Location

► : Bolt, 1

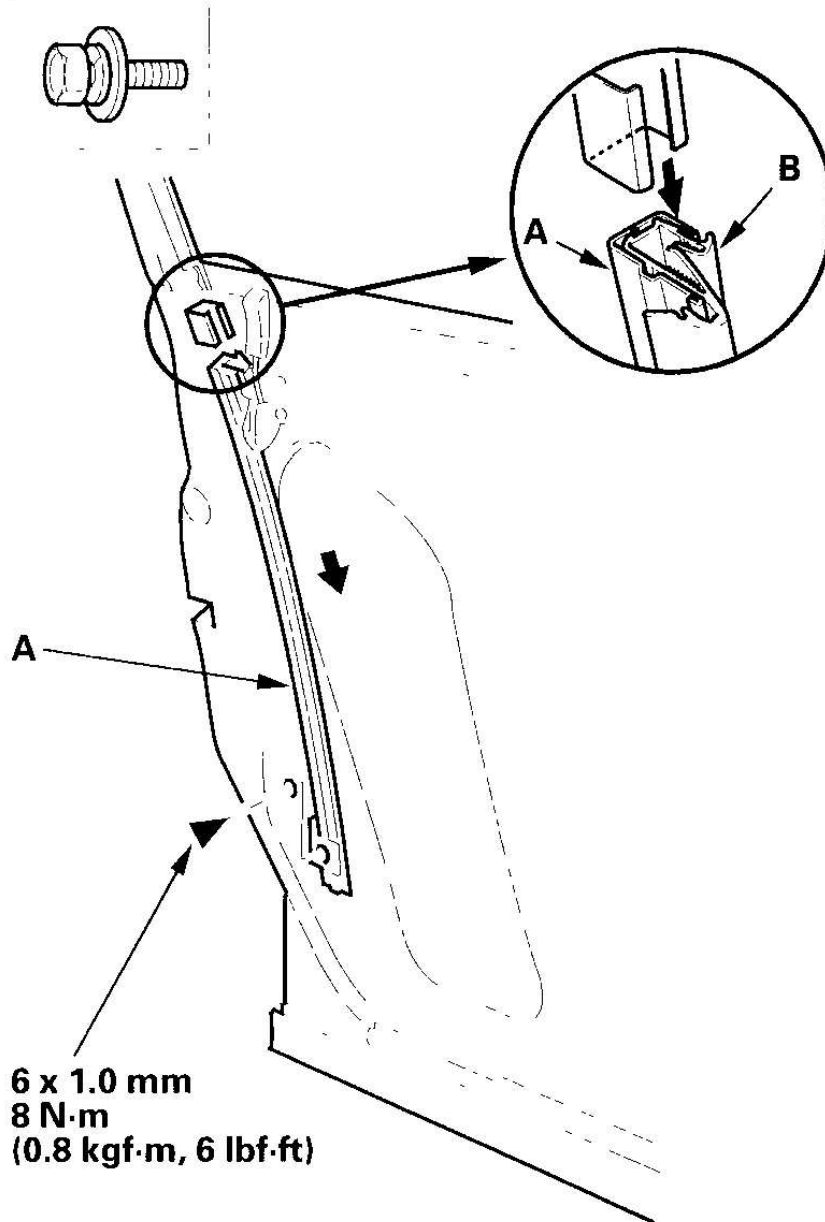

G03641485

Fig. 9: Removing Center Lower Channel With Center Lower Glass Run Channel Pulling Downward

Courtesy of AMERICAN HONDA MOTOR CO., INC.

2006 Acura MDX
2003-06 ACCESSORIES & EQUIPMENT Doors - MDX

4. Remove the screw and detach the hooks (A), then remove the lock rod protector (B).

Fastener Location

► : Screw, 1

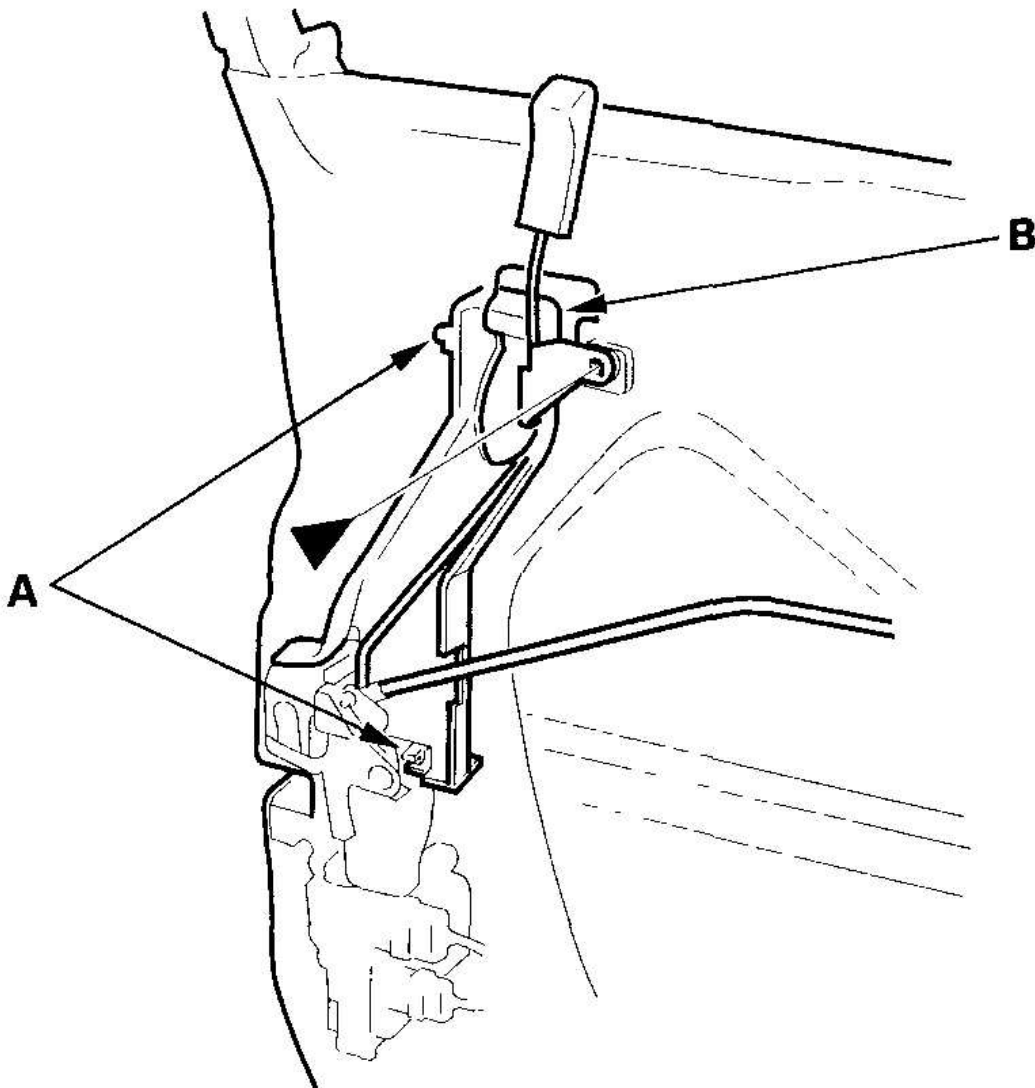
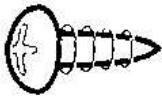
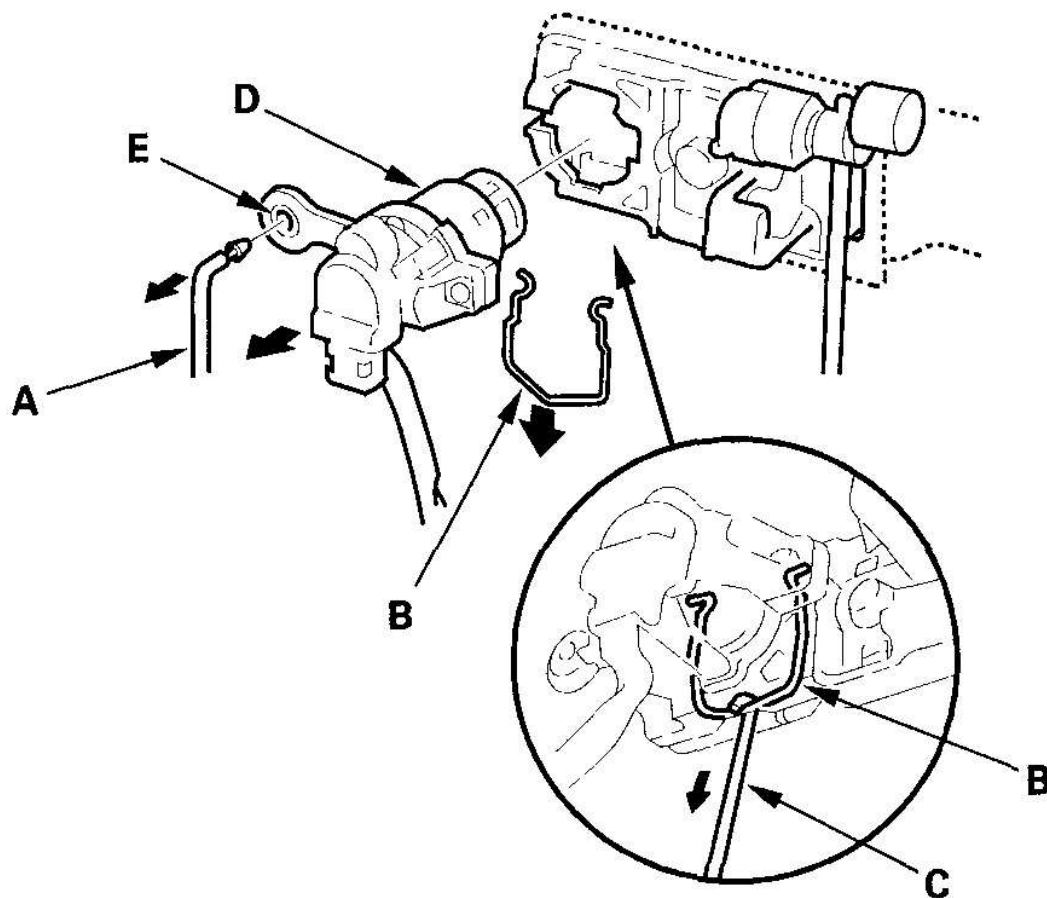

Fig. 10: Removing Lock Rod Protector

Courtesy of AMERICAN HONDA MOTOR CO., INC.

5. Disconnect the cylinder rod (A). Release the retainer clip (B) with a hooked-shaped tool (C), then remove the lock cylinder (D).



G03641487

Fig. 11: Disconnecting Cylinder Rod

Courtesy of AMERICAN HONDA MOTOR CO., INC.

6. Replace the bushing (E) with a new one on the lock cylinder.

NOTE: Do not reuse the bushing when disconnect the lock cylinder rod.

7. Remove the screw, then separate the lock cylinder (A) and cylinder switch (B).

Fastener Location

► : Screw, 1

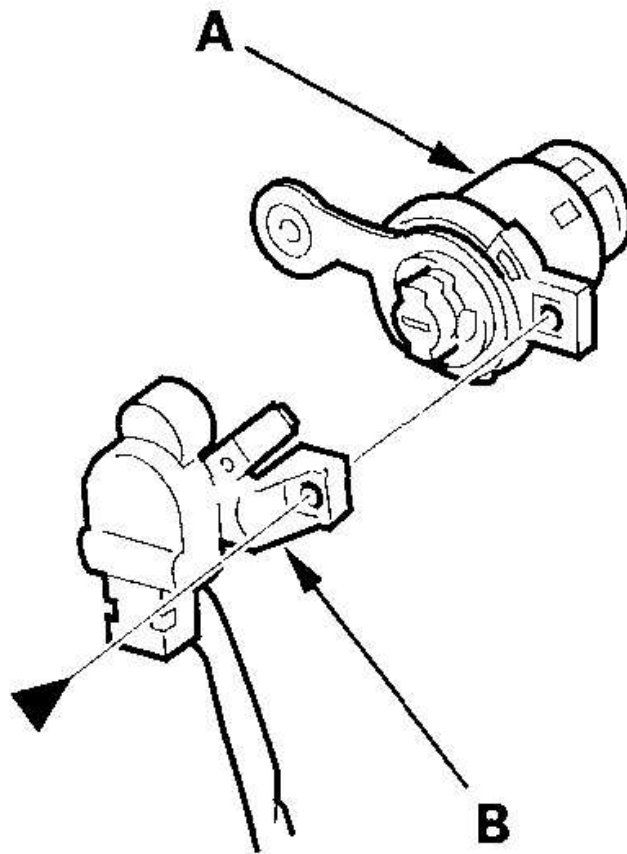
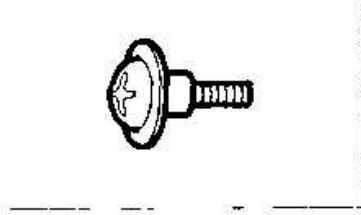

G03641488

Fig. 12: Separating Lock Cylinder And Cylinder Switch
Courtesy of AMERICAN HONDA MOTOR CO., INC.

8. Disconnect the cylinder switch connector (A), and detach the harness clips (B), and release the cylinder switch harness (C) from the harness clip (D).

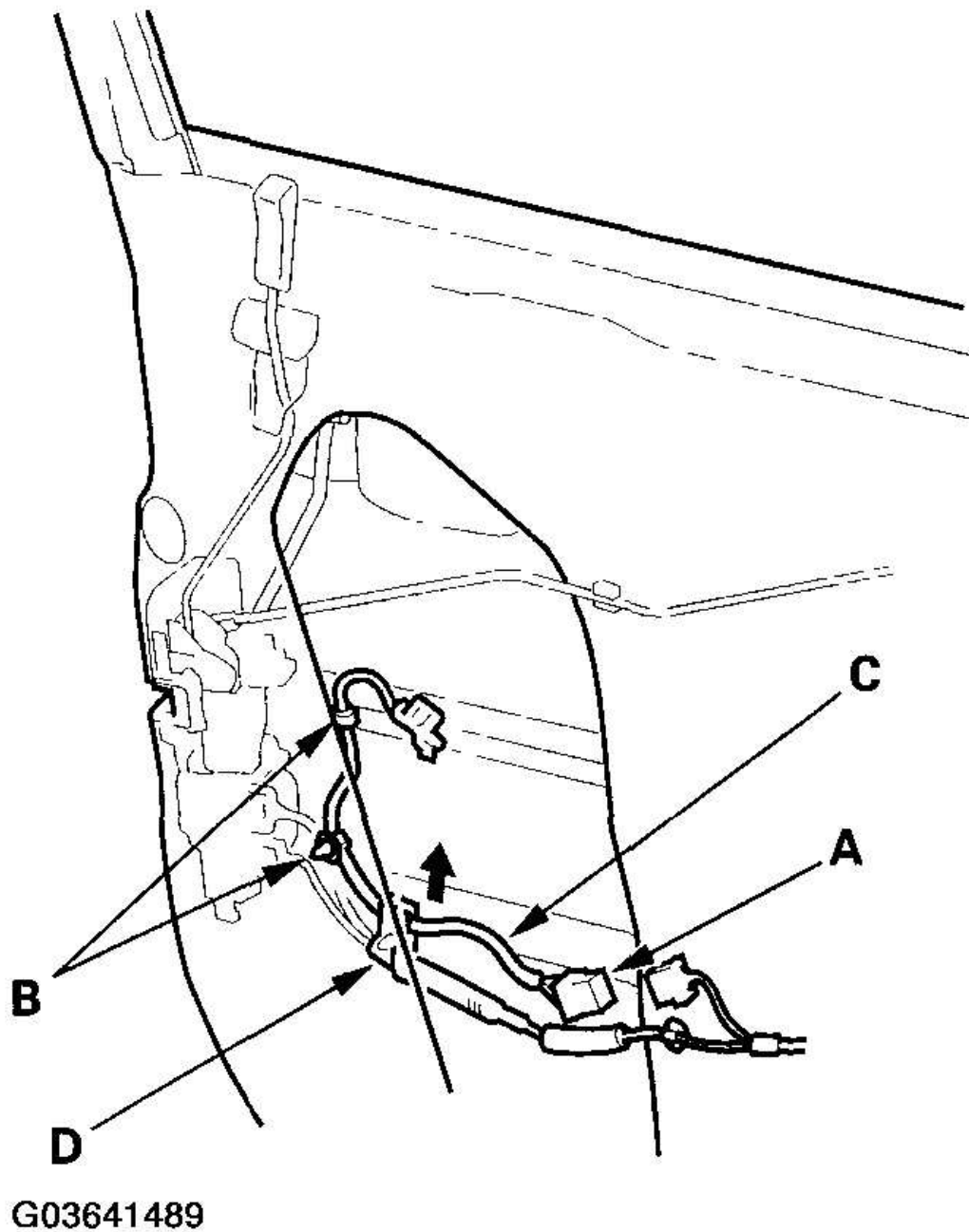
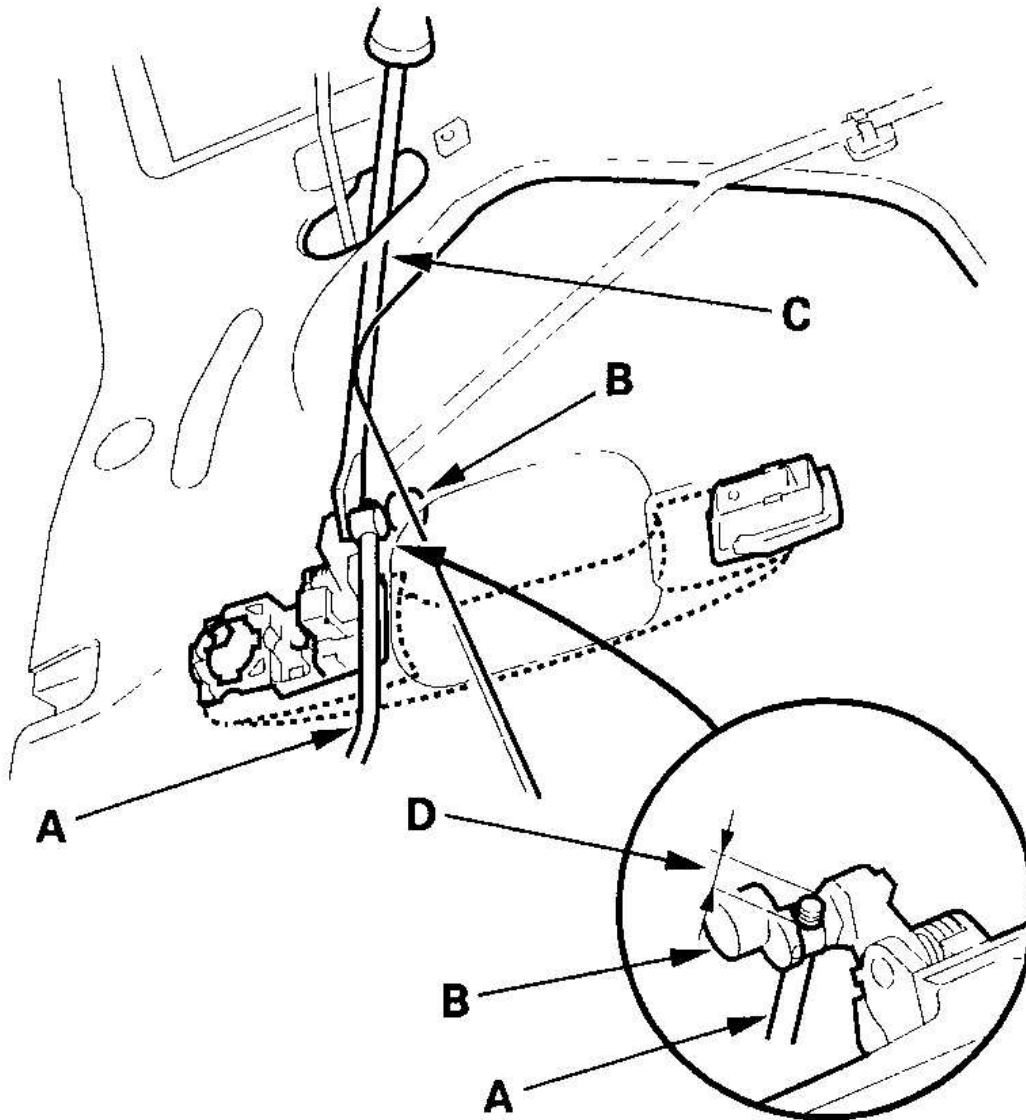

Fig. 13: Disconnecting Cylinder Switch Connector
Courtesy of AMERICAN HONDA MOTOR CO., INC.

9. Pry the outer handle rod (A) out of its joint (B) using a flat-tip screwdriver (C).

NOTE:

- To ease reassembly, note the distance (D) of the outer handle rod on the joint before disconnecting it.
- Take care not to bend the outer handle rod.



G03641490

Fig. 14: Prying Outer Handle Rod Out Of Joint Using Screwdriver
Courtesy of AMERICAN HONDA MOTOR CO., INC.

10. Remove the maintenance hole seal (A), and remove the bolt (B) and nut (C) securing the outer handle

protector rod (D), then remove the rod. Remove the bolt (E) securing the outer handle protector (F) and outer handle (G).

Fastener Locations

B ▶: Bolt, 1 **E ▶: Bolt, 1** **C ●: Nut, 1**

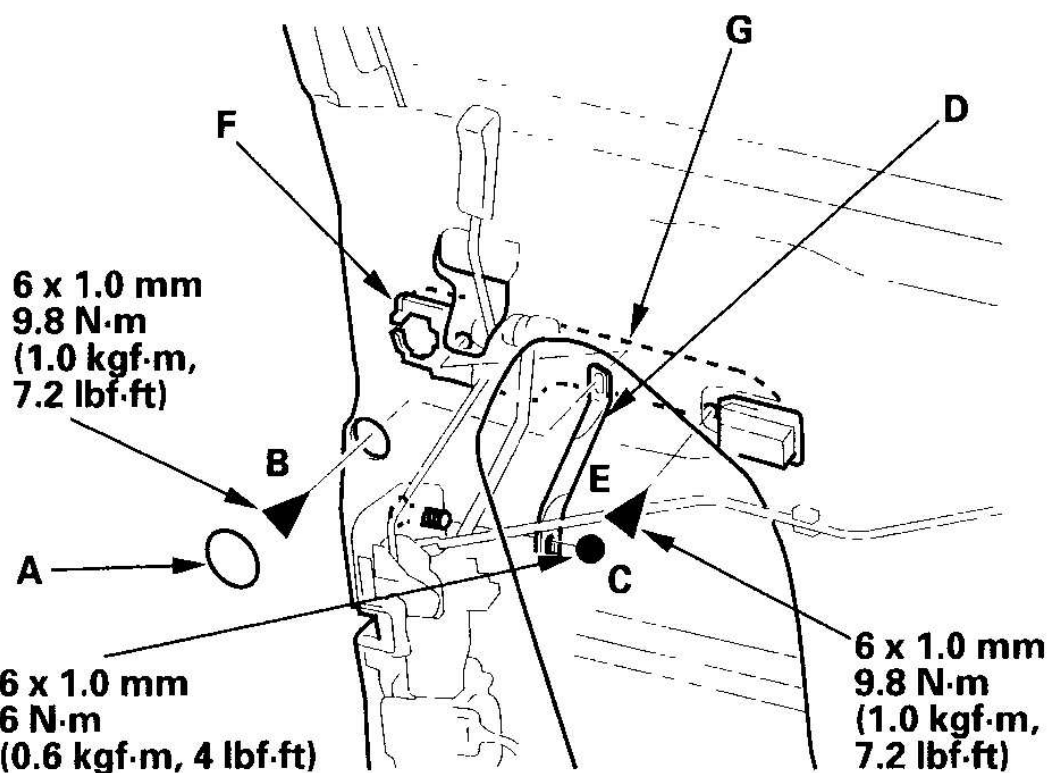
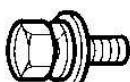
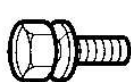

G03641491

Fig. 15: Removing Maintenance Hole Seal

Courtesy of AMERICAN HONDA MOTOR CO., INC.

11. Release the hook (A), then remove the outer handle protector (B) and spacer (C).

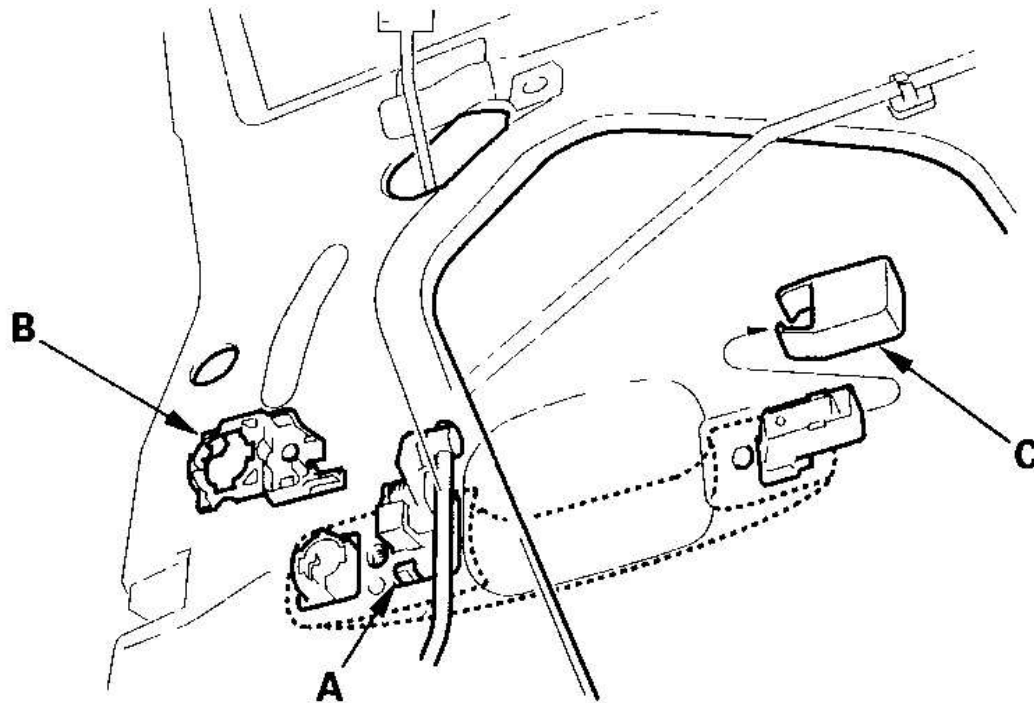

G03641492

Fig. 16: Removing Outer Handle Protector And Spacer
Courtesy of AMERICAN HONDA MOTOR CO., INC.

12. Remove the outer handle (A). Replace the bushing (B) with new one on the outer handle.

NOTE: Do not reuse the bushing when you disconnect the outer handle rod.

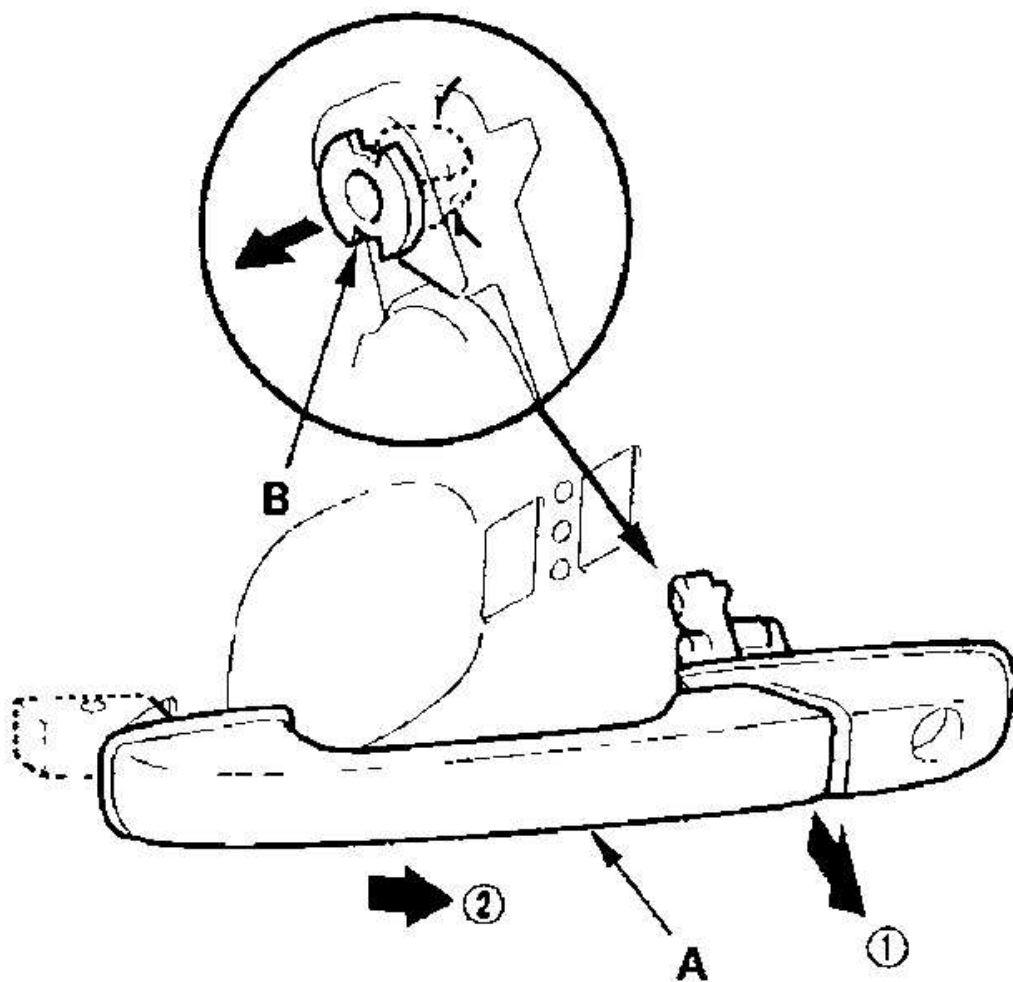

G03641493

Fig. 17: Removing Outer Handle

Courtesy of AMERICAN HONDA MOTOR CO., INC.

13. Install the outer handle in the reverse order of removal, and note these items:
- Make sure the cylinder switch is installed correctly, with the slot and tab aligned.
 - Make sure the cylinder switch harness is routed properly.
 - Make sure the connector is plugged in properly, and each rod is connected securely.
 - Make sure the door locks and opens properly.
 - When installing the lock cylinder, leave the outer door handle bolts loose so the inner protector does not interfere with the lock cylinder installation, then tighten the handle bolts.

- Install the lock cylinder retaining clip on the handle, then install the lock cylinder. Be sure the clip is fully seated in the slot on the lock cylinder.
- When reinstalling the door panel, make sure the plastic cover is installed properly and sealed around its outside perimeter to seal out water.

FRONT DOOR LATCH REPLACEMENT

NOTE: **Put on gloves to protect your hands.**

1. Raise the glass fully.
2. Remove these items:
 - Door panel (see **FRONT DOOR PANEL REMOVAL/INSTALLATION**)
 - Plastic cover, as necessary (see **COMPONENT LOCATION INDEX - FRONT DOOR**)
 - Outer handle (see **FRONT DOOR OUTER HANDLE REPLACEMENT**)
3. Detach the inner handle rod (A), and disconnect the actuator connectors (B).

Fastener Locations

► : Screw, 3

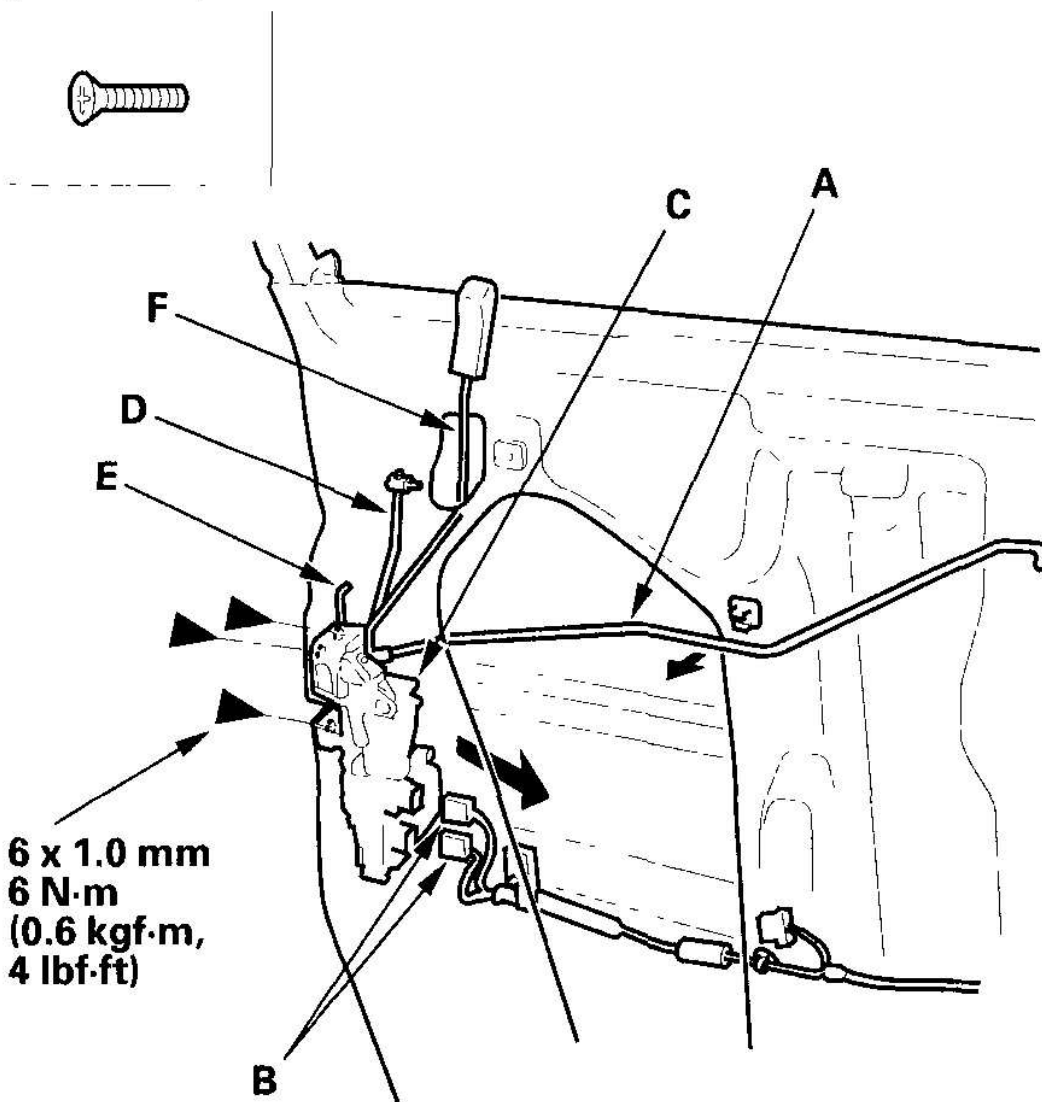

G03641494

Fig. 18: Detaching Inner Handle Rod

Courtesy of AMERICAN HONDA MOTOR CO., INC.

4. Remove the screws, then remove the latch (C) through the hole in the door. Take care not to bend the outer handle rod (D), cylinder rod (E), lock rod (F), and inner handle rod.
5. Install the latch in the reverse order of removal, and note these items:

- Make sure the actuator connectors are plugged in properly, and each rod is connected securely.
- Make sure the door locks and opens properly.
- When reinstalling the door panel, make sure the plastic cover is installed properly and sealed around its outside perimeter to seal out water.

FRONT DOOR GLASS AND REGULATOR REPLACEMENT

1. Remove these items:
 - Door panel (see **FRONT DOOR PANEL REMOVAL/INSTALLATION**)
 - Pull pocket bracket (see **COMPONENT LOCATION INDEX - FRONT DOOR**)
 - Power window control unit, driver's door (see **COMPONENT LOCATION INDEX - FRONT DOOR**)
 - Plastic cover (see **COMPONENT LOCATION INDEX - FRONT DOOR**)
2. Carefully raise the glass (A) until you can see the bolts, then remove them. Carefully pull the glass out through the window slot. Take care not to drop the glass inside the door.

Fastener Locations

► : Bolt, 2

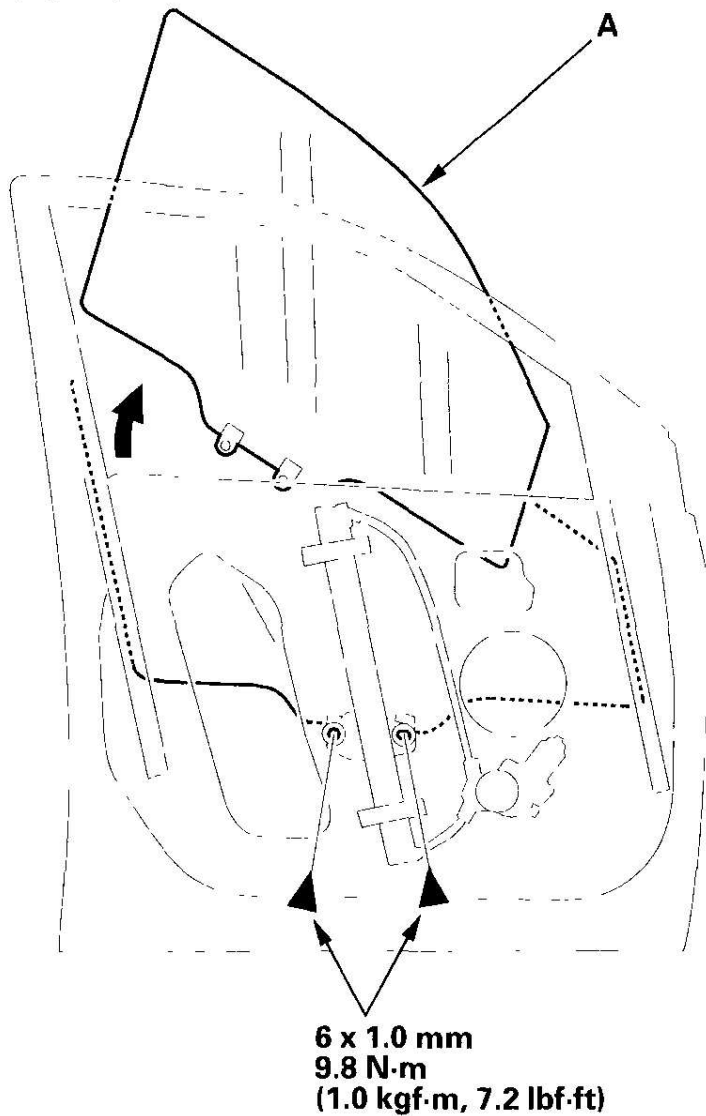
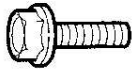

**6 x 1.0 mm
9.8 N·m
(1.0 kgf·m, 7.2 lbf·ft)**

G03641495

Fig. 19: Raising Glass To Remove
Courtesy of AMERICAN HONDA MOTOR CO., INC.

3. Disconnect and detach the connector (A) and harness clip (B) from the door. Remove the bolts (C) and

loosen the bolts (D), then remove the regulator (E) through the hole in the door.

Fastener Locations

C ▶ : Bolt, 4 **D ▶ : Bolt, 3**

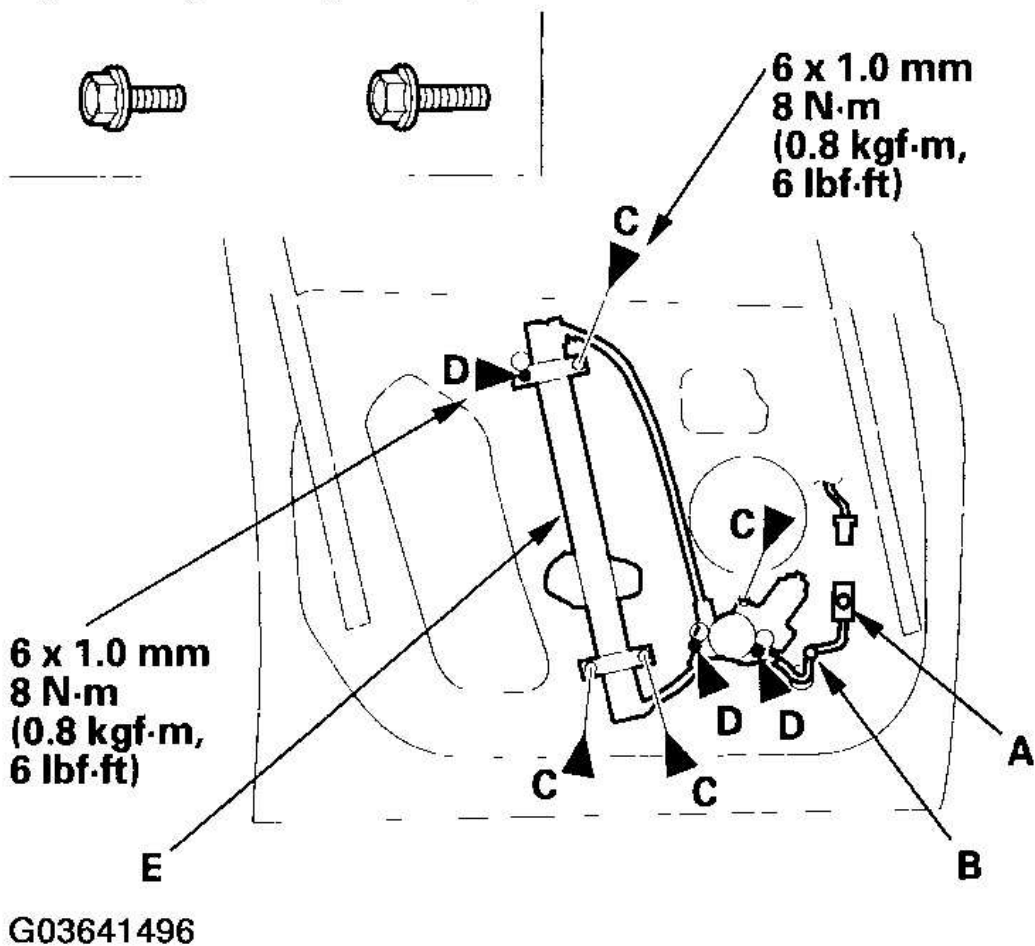
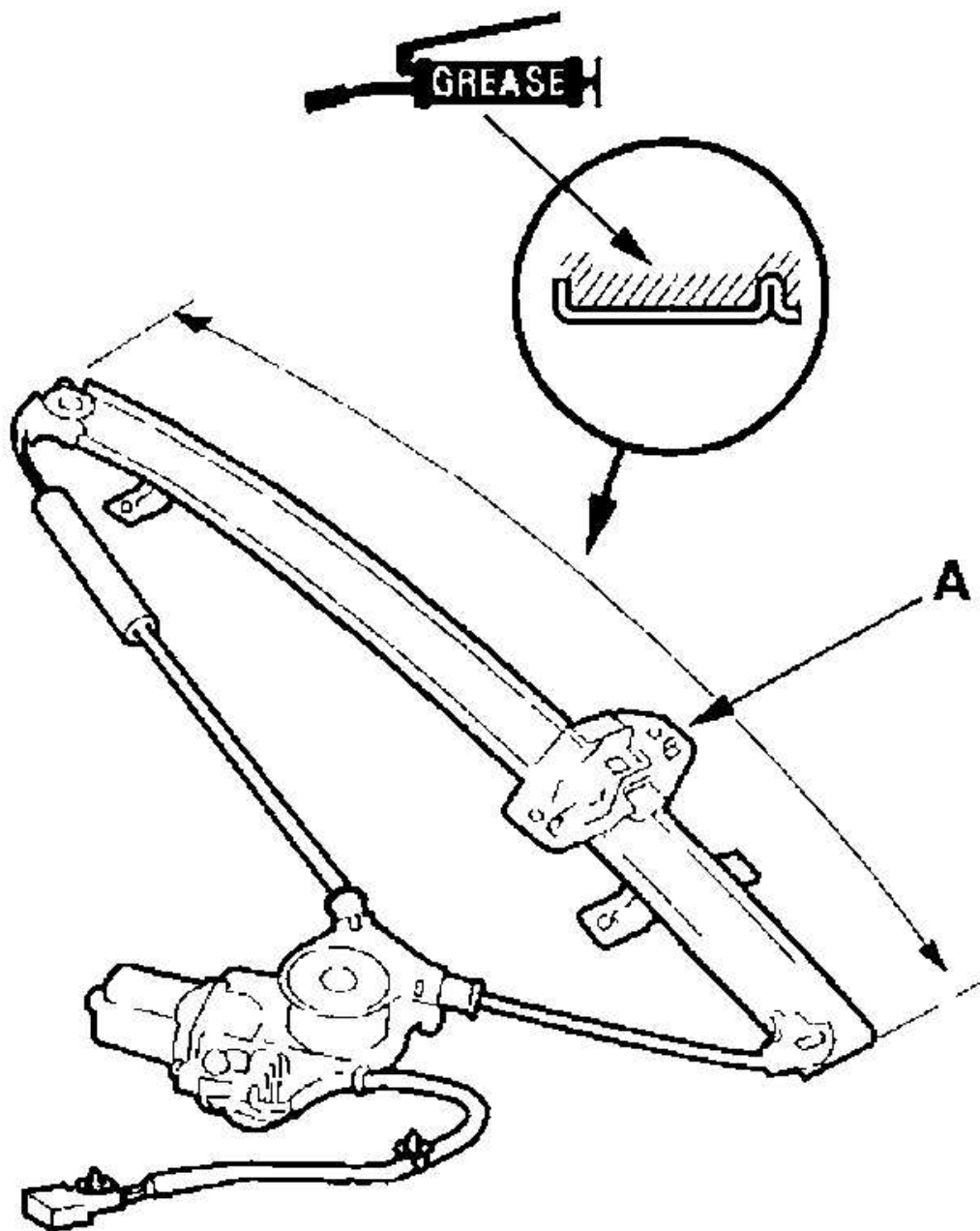

Fig. 20: Disconnecting And Detaching Connector & Harness Clip From Door
Courtesy of AMERICAN HONDA MOTOR CO., INC.

4. Apply multipurpose grease to all the sliding surfaces of the regulator (A) where shown in **Fig. 21** .



G03641497

Fig. 21: Applying Multipurpose Grease To Sliding Surfaces Of Regulator
Courtesy of AMERICAN HONDA MOTOR CO., INC.

5. Install the glass and regulator in the reverse order of removal, and note these items:
 - Roll the glass up and down to see if it moves freely without binding.
 - Make sure that there is no clearance between the glass and glass run channel when the glass is closed.
 - Adjust the position of the glass as necessary (see **FRONT AND REAR DOOR GLASS ADJUSTMENT**).
 - Do the power window control unit reset procedure (see **RESETTING THE POWER WINDOW CONTROL UNIT**).
 - Check for water leaks (see step 7 in **FRONT AND REAR DOOR GLASS ADJUSTMENT**).
 - Test-drive and check for wind noise and rattles.
 - When reinstalling the door panel, make sure the plastic cover is installed properly and sealed around its outside perimeter to seal out water.

FRONT DOOR SASH TRIM REPLACEMENT

NOTE: **Take care not to scratch the door.**

1. Turn the door weatherstrip (A) at the rear upper corner portion, then remove the screw.

Fastener Location

► : Screw, 1

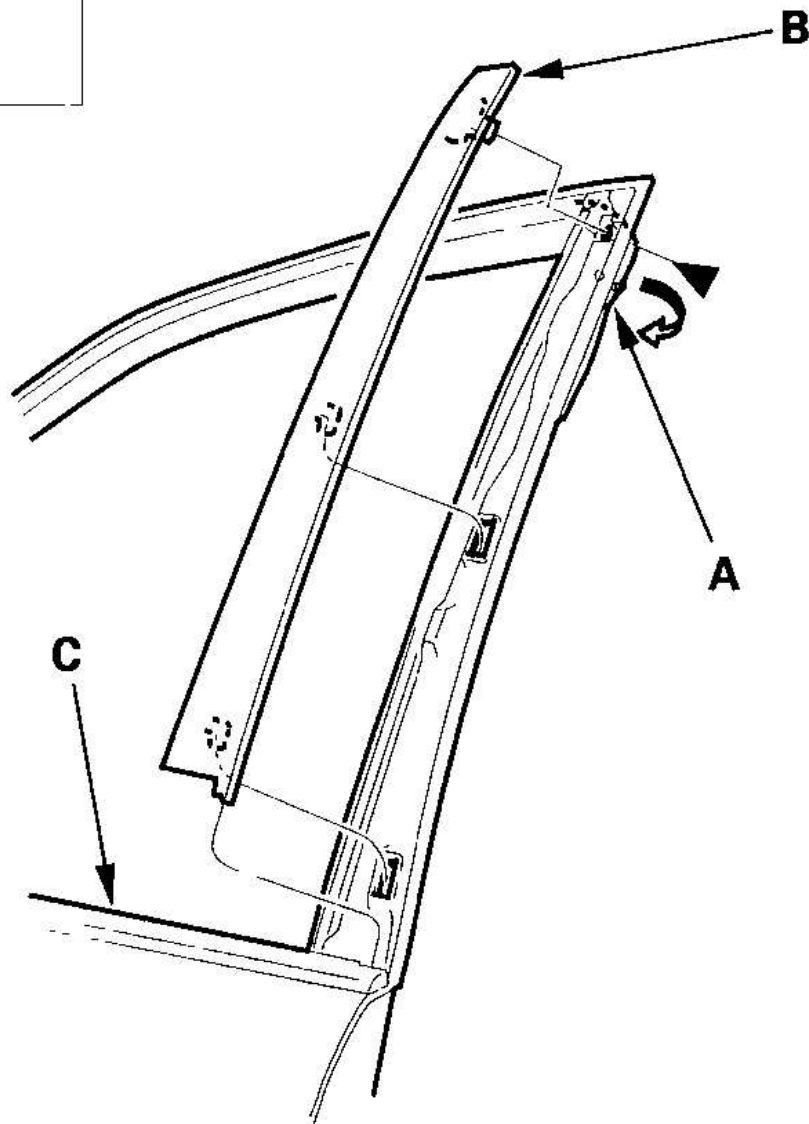

G03641498

2006 Acura MDX
2003-06 ACCESSORIES & EQUIPMENT Doors - MDX

-
2. Pull up the sash trim (B). Take care not to damage the door glass outer weatherstrip (C).
3. Install the sash trim in the reverse order of removal.

FRONT DOOR GLASS OUTER WEATHERSTRIP REPLACEMENT

NOTE:

- **Put on gloves to protect your hands.**
- **Take care not to scratch the door and molding.**

1. Starting at the rear, pry the door glass outer weatherstrip (A) up to detach the clip (B).

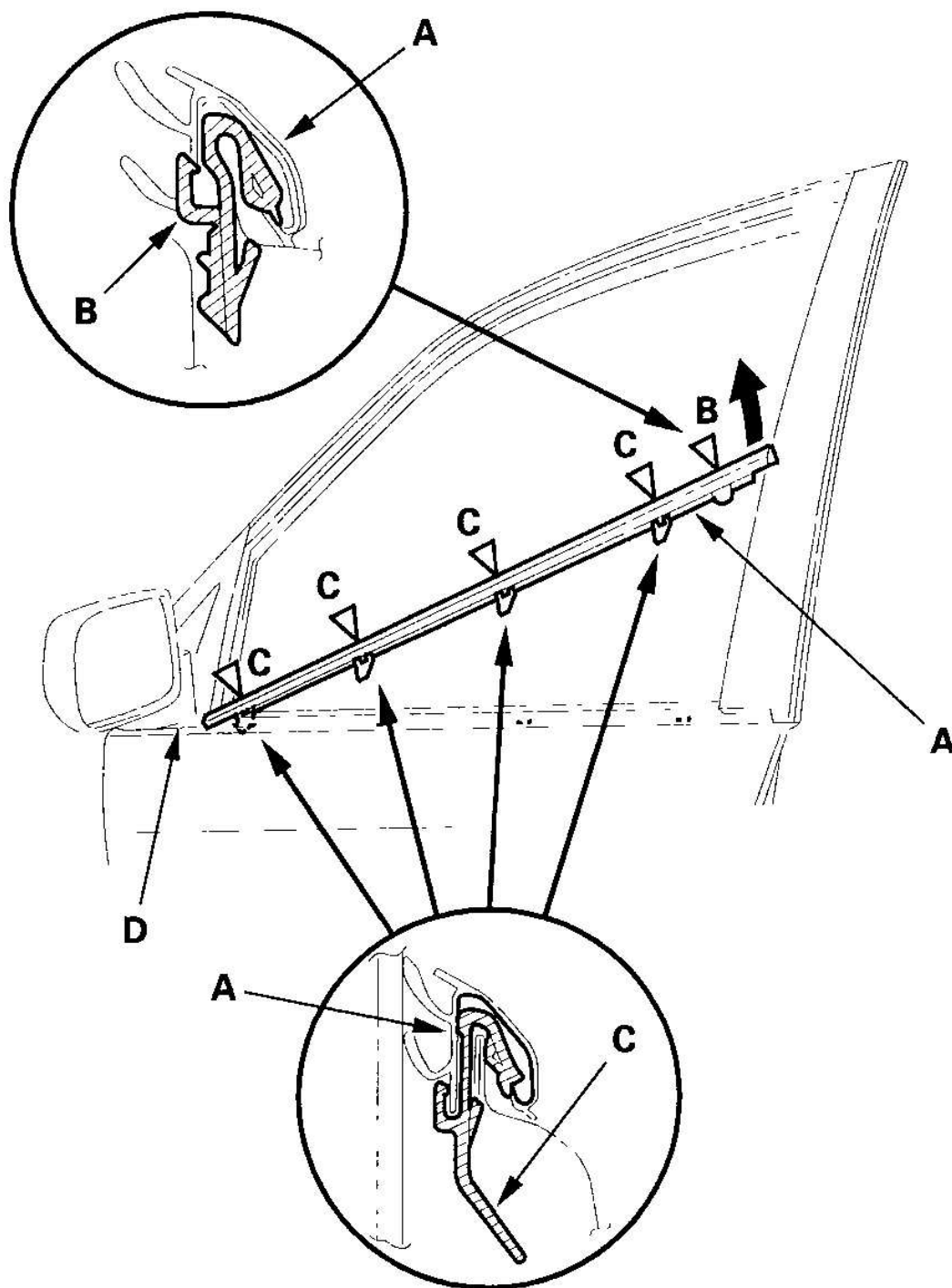

G03641499

Fig. 23: Prying Door Glass Outer Weatherstrip To Detach Clip

Courtesy of AMERICAN HONDA MOTOR CO., INC.

2. Detach the clips (C), then pull the forward end of the weatherstrip from under the power mirror base (D).
3. Install the outer weatherstrip in the reverse order of removal, and note these items:
 - Check the clip(s) for damage or stress-whitened, and replace them with new one(s).
 - Push the clips into place securely.

FRONT DOOR WEATHERSTRIP AND FRONT DOOR LOWER WEATHERSTRIP REPLACEMENT

NOTE:

- Take care not to scratch the door.
- Use a clip remover to remove the clips.

1. At the A-pillar, remove the door checker mounting bolt (A).

Fastener Locations

A ► : Bolt, 1 **B** ▷ : Clip, 29 **C** ▷ : Clip, 1

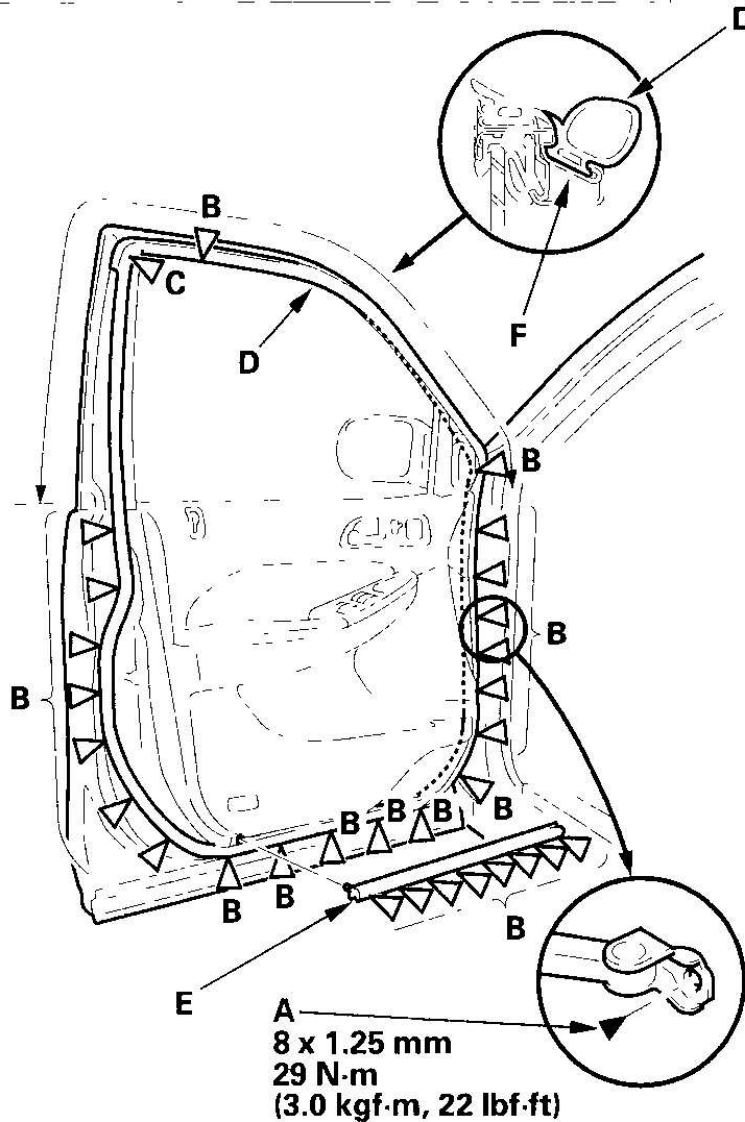
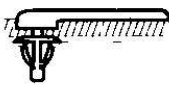
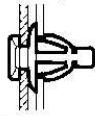
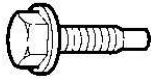

G03641500

Fig. 24: Removing Door Checker Mounting Bolt At A-Pillar
Courtesy of AMERICAN HONDA MOTOR CO., INC.

2. Detach the clips (B, C), then remove the door weatherstrip (D), and the door lower weatherstrip (E).

3. Install the weatherstrips in the reverse order of removal, and note these items:
 - Check the clip(s) for damage or stress-whitened, and replace them with new one(s).
 - Push the clips into place securely.
 - Make sure the weatherstrip is installed in the holder (F) securely.
 - Apply liquid thread lock to door checker mounting bolt before installation.
 - Check for water leaks (see step 7 in **FRONT AND REAR DOOR GLASS ADJUSTMENT**).
 - Test-drive and check for wind noise.

FRONT DOOR UPPER SEAL REPLACEMENT

NOTE:

- **Take care not to scratch the door.**
- **Use a clip remover to remove the clips.**

1. Remove these items:
 - Power mirror, as necessary (see **POWER MIRROR REPLACEMENT**)
 - Door sash trim (see **FRONT DOOR SASH TRIM REPLACEMENT**)
2. Detach the door weatherstrip clip (A) and lower clip (B), then remove the door upper seal (C).

Fastener Locations

A ▷ : Clip, 1 B ▷ : Clip, 1

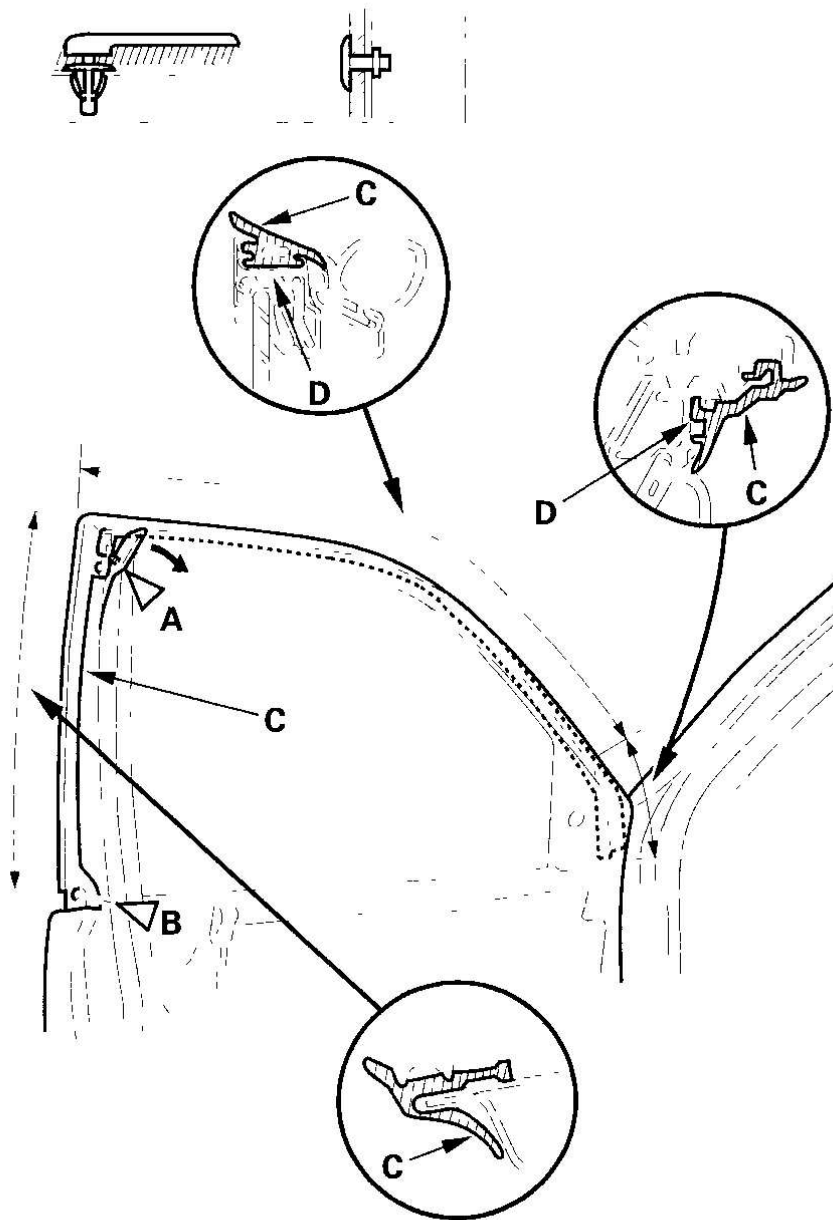

G03641501

Fig. 25: Detaching Door Weatherstrip Clip And Lower Clip
 Courtesy of AMERICAN HONDA MOTOR CO., INC.

3. Install the upper seal in the reverse order of removal, and note these items:

2006 Acura MDX
2003-06 ACCESSORIES & EQUIPMENT Doors - MDX

- Check the clip(s) for damage or stress-whitened, and replace them with new one(s).
- Push the clips into place securely.
- Make sure the upper seal is installed in the holder (D) securely.

FRONT DOOR SIDE SILL SEAL REPLACEMENT

NOTE:

- **Take care not to scratch the door.**
- **Use a clip remover to remove the clips.**

1. Detach the clips (A), then remove the door side sill seal (B).

Fastener Locations

A ▷ : Clip, 9

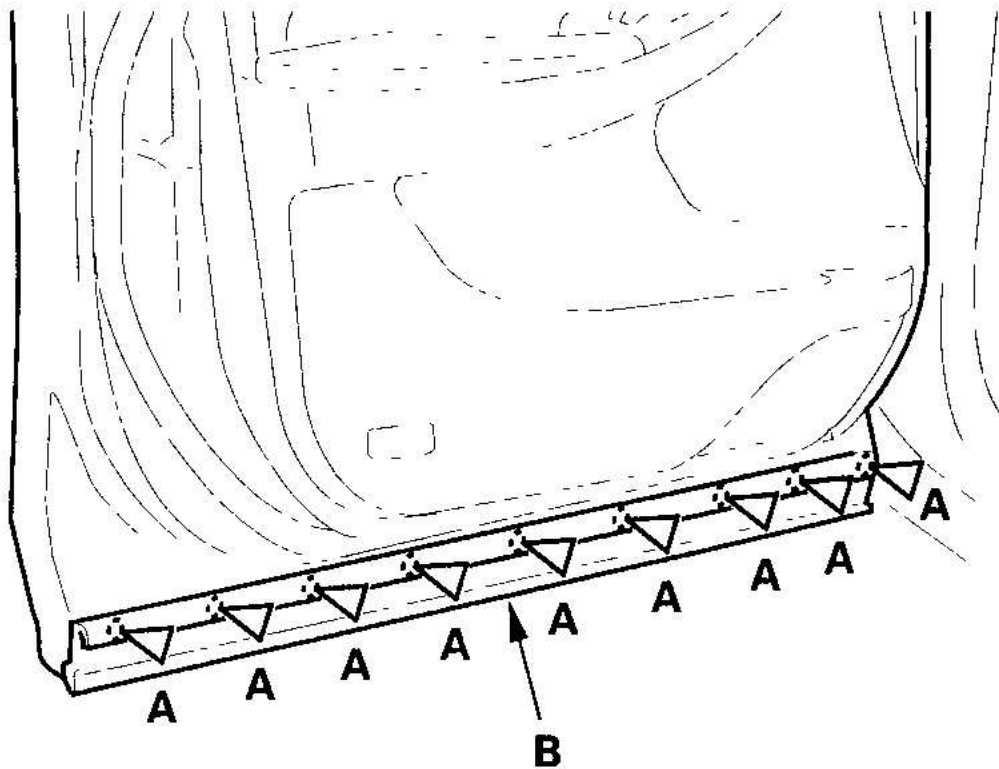
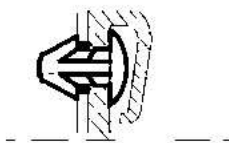

G03641502

Fig. 26: Removing Door Side Sill Seal By Detaching Clips
Courtesy of AMERICAN HONDA MOTOR CO., INC.

2. Install the side sill seal in the reverse order of removal, and note these items:
 - Check the clip(s) for damage or stress-whitened, and replace them with new one(s).
 - Push the clips into place securely.

REAR DOOR PANEL REMOVAL/INSTALLATION

2006 Acura MDX

2003-06 ACCESSORIES & EQUIPMENT Doors - MDX

Special Tools Required

- KTC trim tool set SOJATP2014
- Trim pad remover, Snap-on A 177A or equivalent, commercially available

NOTE: Use the appropriate tool from the KTC trim tool set to avoid damage when prying components.

1. Remove the inner handle (A). Take care not to scratch the door panel.
 - 1 Pry out the cap (B), and remove the screw.
 - 2 Move the inner handle forward and half-way out, then disconnect the inner handle rod (C) from the joint bushing (D).

NOTE: Check the bushing for damage, and replace if necessary.

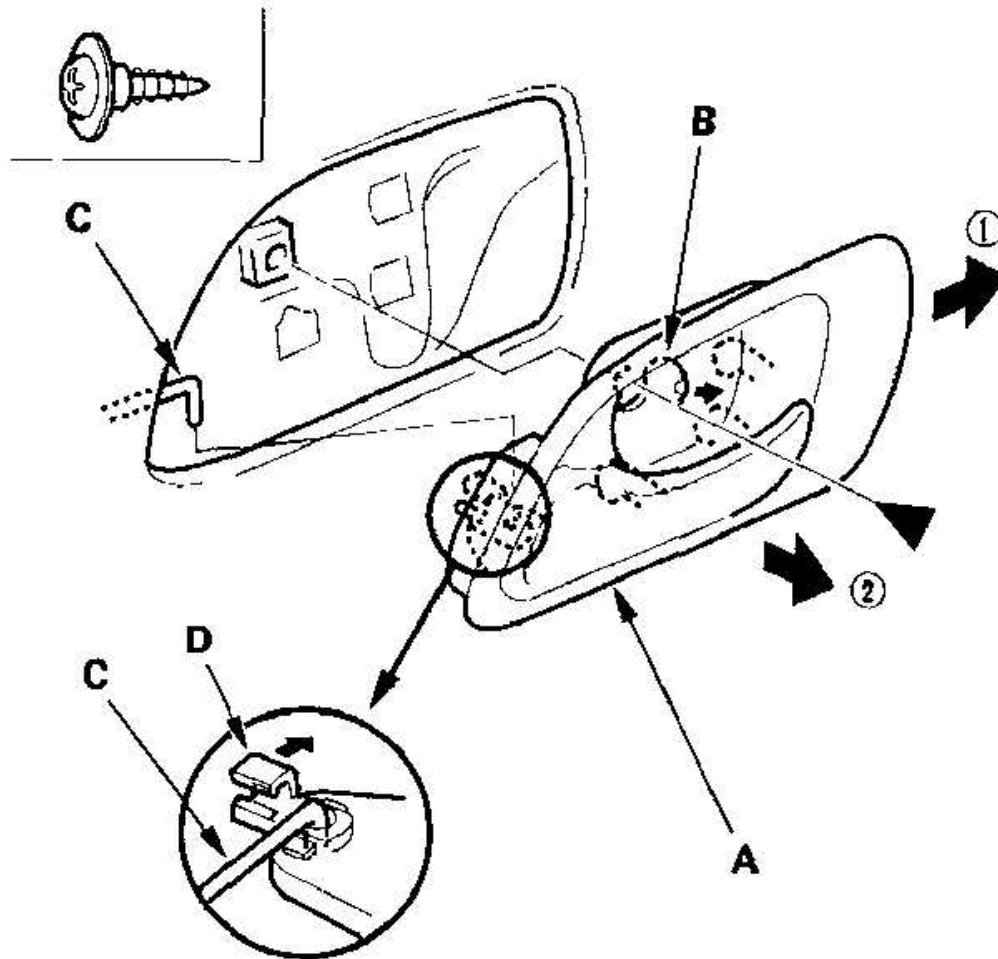
Fastener Location**► Screw, 1****G03641503****Fig. 27: Removing Inner Handle****Courtesy of AMERICAN HONDA MOTOR CO., INC.**

2. Detach the clips (A) and release the hooks (B), then remove the switch panel (C). Take care not to scratch the door panel. Disconnect the power window switch connector (D).

Fastener Locations

A ▴ : Clip, 3 F ▴ : Screw, 1

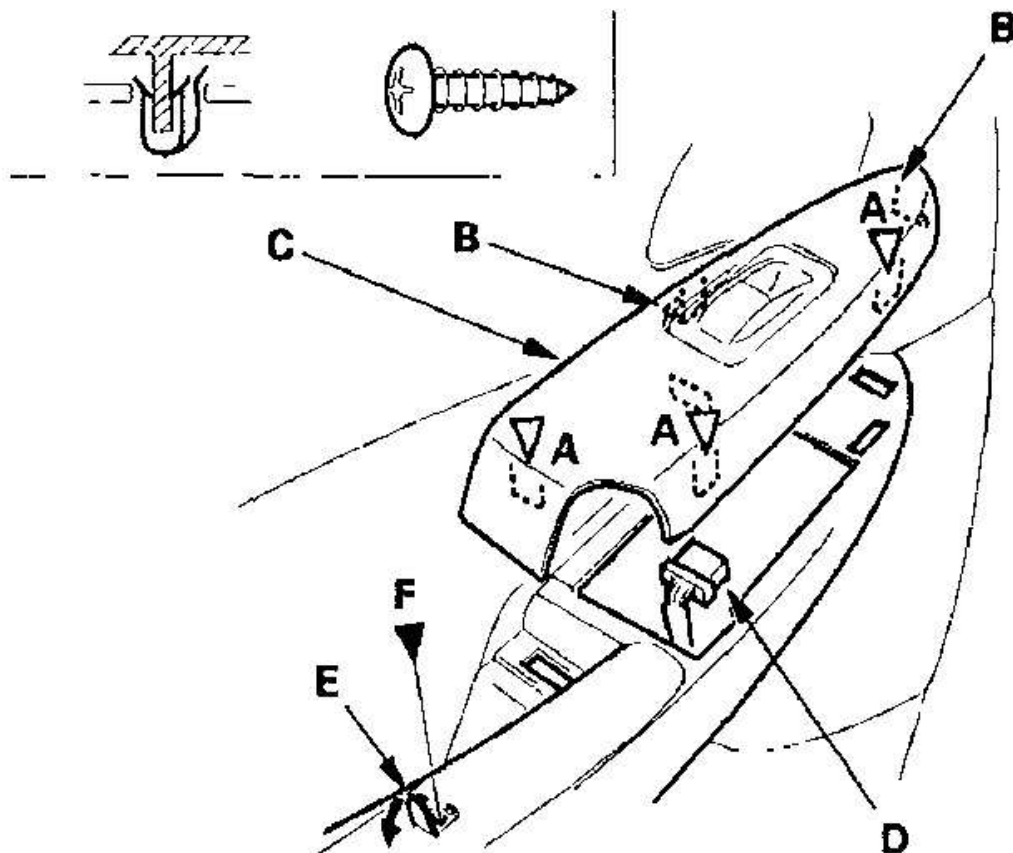

G03641504

Fig. 28: Detaching Clips And Releasing Hooks To Remove Switch Panel
Courtesy of AMERICAN HONDA MOTOR CO., INC.

3. Pry out the cap (E), and remove the screw (F).
4. Release the clips that hold the door panel (A) with a commercially available trim pad remover (B), then remove the door panel by pulling it upward. Disconnect the courtesy light bulb socket (C). Remove the door panel with as little bending as possible to avoid creasing or breaking it.

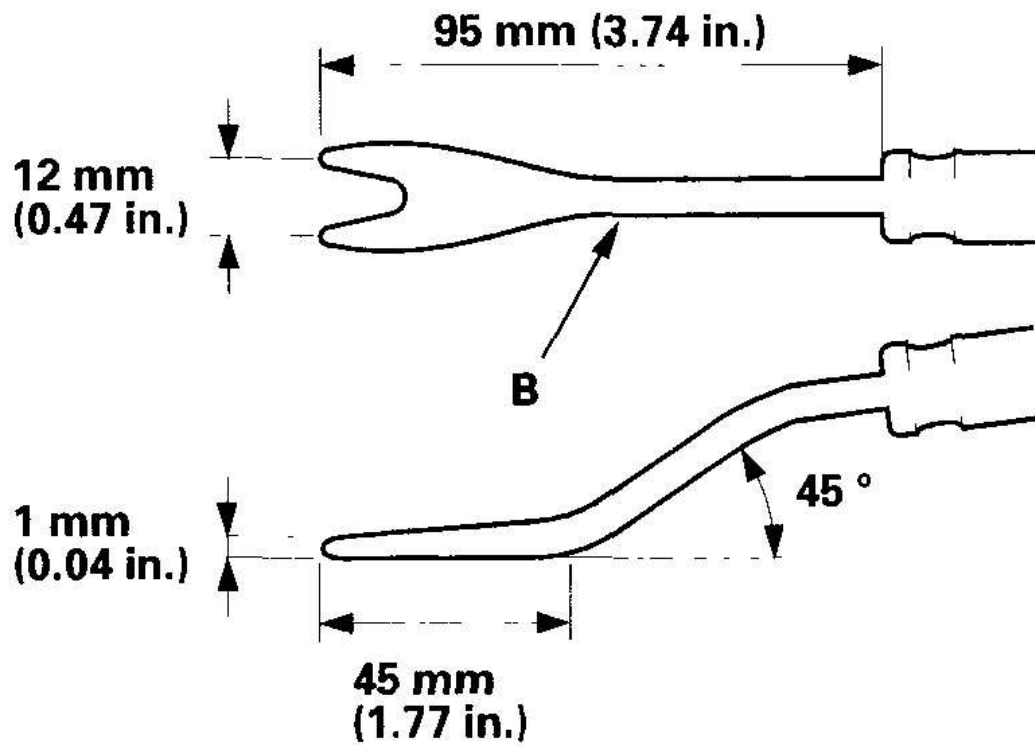

G03641505

Fig. 29: Releasing Clips Holding Door Panel With Trim Pad Remover (1 Of 2)
Courtesy of AMERICAN HONDA MOTOR CO., INC.

Fastener Locations

▷ : Clip, 8

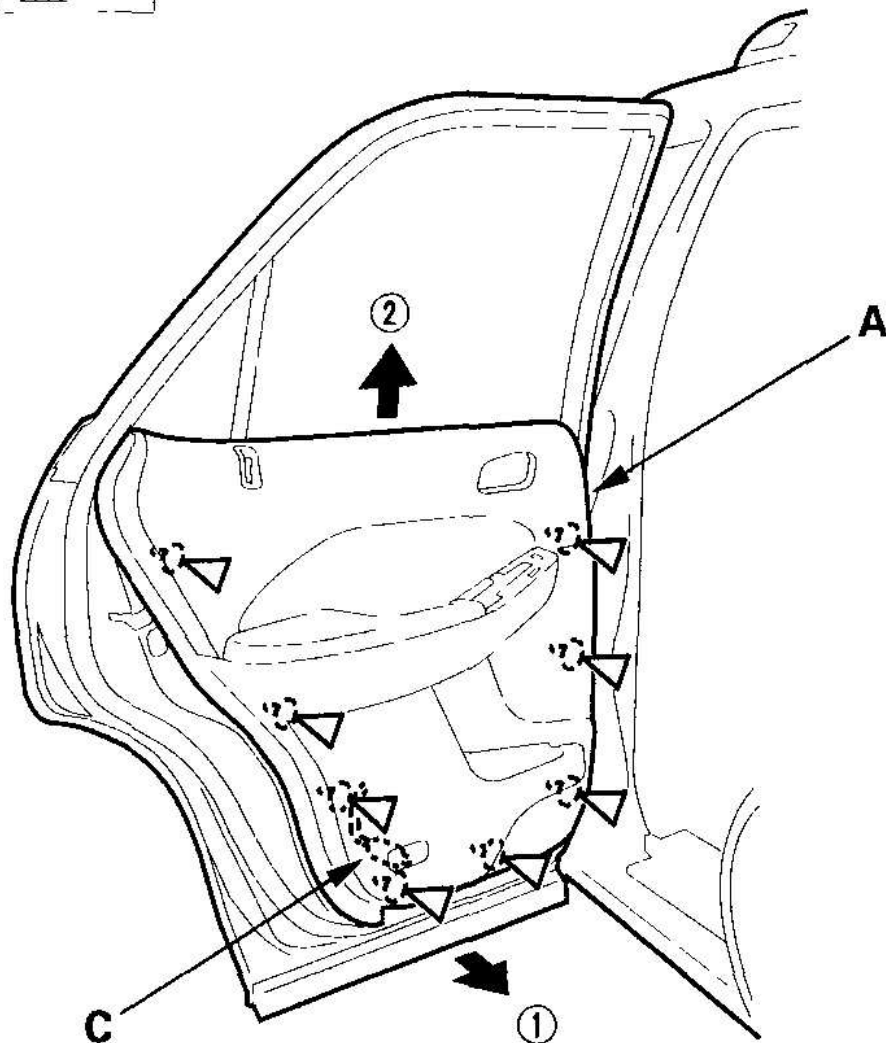
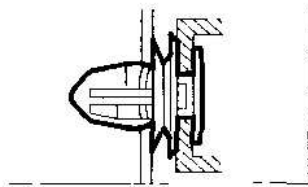

G03641506

Fig. 30: Releasing Clips Holding Door Panel With Trim Pad Remover (2 Of 2)
Courtesy of AMERICAN HONDA MOTOR CO., INC.

5. Install the door panel in the reverse order of removal, and note these items:
 - Check the clip(s) for damage or stress-whitened, and replace them with new one(s).
 - Make sure the connector is plugged in properly, and the inner handle rod and courtesy light bulb socket are connected properly.
 - Make sure the window operates properly.

REAR DOOR OUTER HANDLE REPLACEMENT

NOTE: **Put on gloves to protect your hands.**

1. Remove these items:
 - Door panel (see **REAR DOOR PANEL REMOVAL/INSTALLATION**)
 - Plastic cover, as necessary (see **COMPONENT LOCATION INDEX - REAR DOOR**)
2. Raise the glass fully.
3. Remove the screws securing the latch (A), then lower the latch.

Fastener Locations

► : Screw, 3

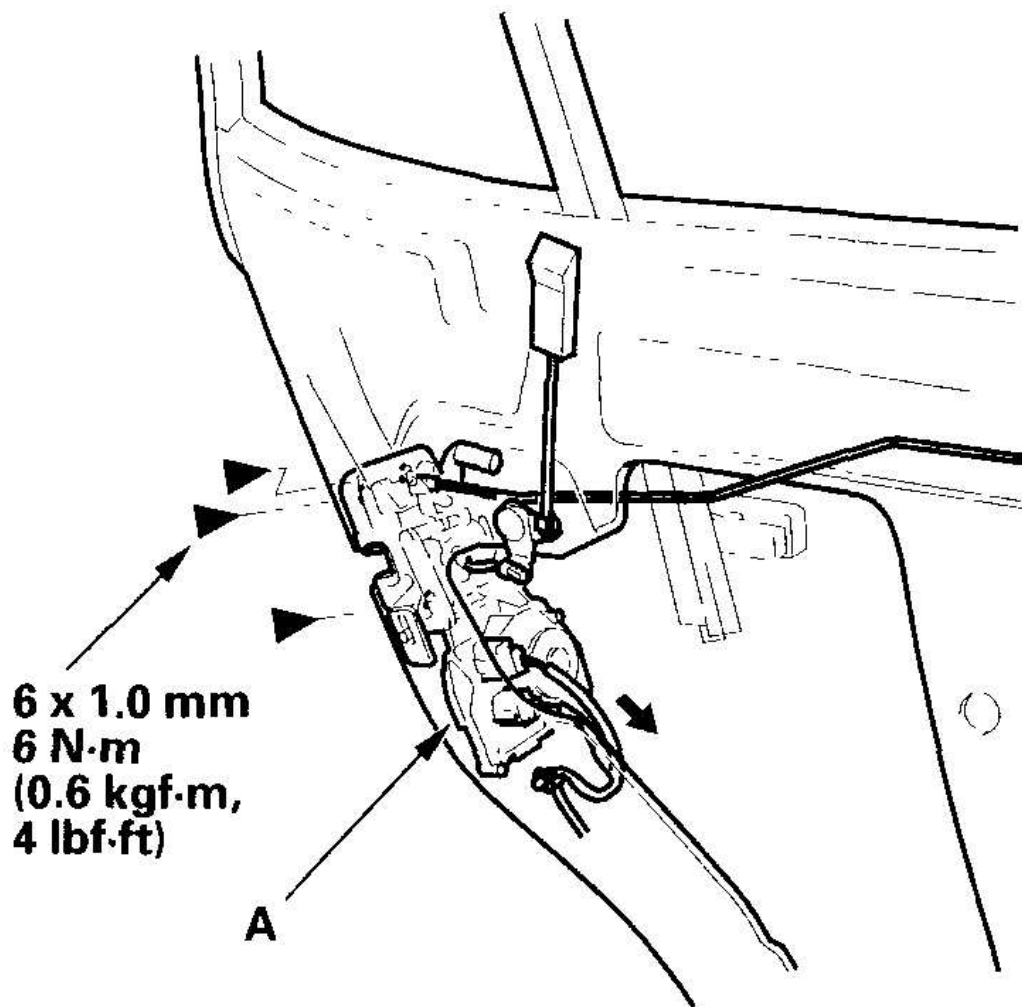
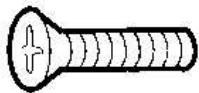

G03641507

Fig. 31: Removing Latch

Courtesy of AMERICAN HONDA MOTOR CO., INC.

4. Remove the bolts securing the outer handle protector (A) and outer handle (B). Release the hook (C), then remove the protector and spacer (D).

Fastener Locations

► : Bolt, 2

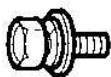

6 x 1.0 mm
9.8 N·m
(1.0 kgf·m, 7.2 lbf·ft)

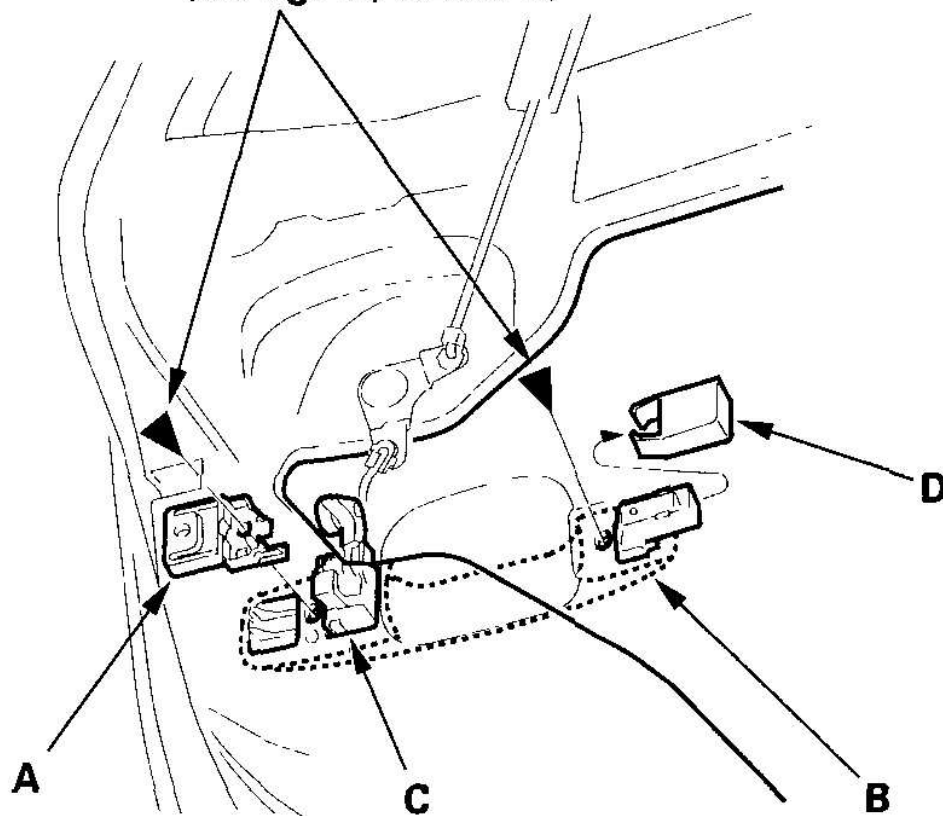

G03641508

Fig. 32: Removing Outer Handle Protector And Outer Handle Bolts
Courtesy of AMERICAN HONDA MOTOR CO., INC.

5. Remove the outer handle (A).

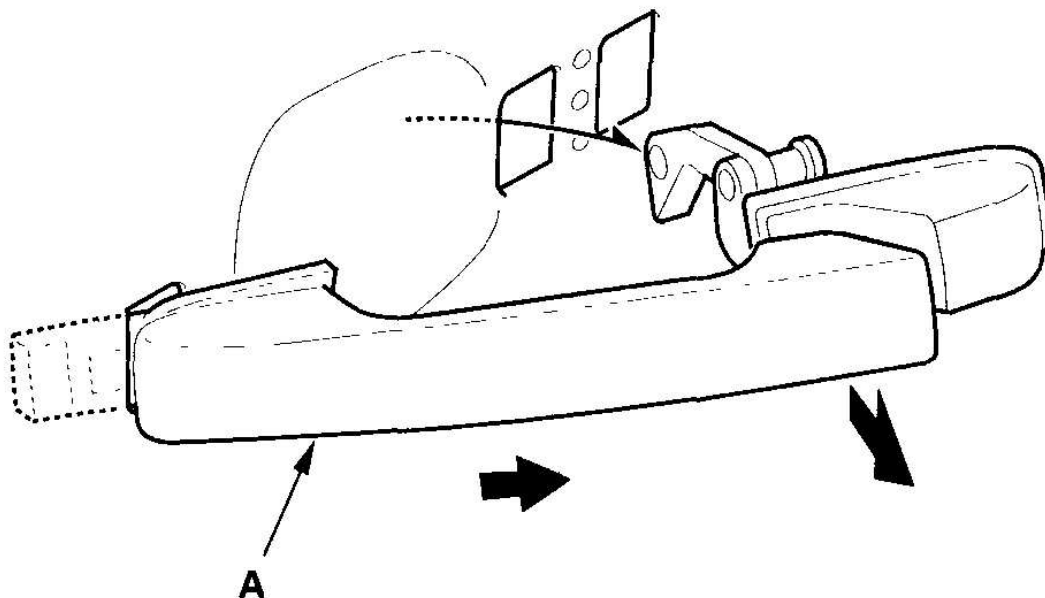

G03641509

Fig. 33: Removing Outer Handle

Courtesy of AMERICAN HONDA MOTOR CO., INC.

6. Install the outer handle in the reverse order of removal, and note these items:
 - Make sure the door locks and opens properly.
 - When reinstalling the door panel, make sure the plastic cover is installed properly and sealed around its outside perimeter to seal out water.

REAR DOOR LATCH REPLACEMENT

NOTE: Put on gloves to protect your hands.

1. Remove these items:
 - Door panel (see **REAR DOOR PANEL REMOVAL/INSTALLATION**)
 - Plastic cover, as necessary (see **COMPONENT LOCATION INDEX - REAR DOOR**)
2. Raise the glass fully.
3. Disconnect the lock rod (A) from the joint bushing (B) on the lock crank. Detach the inner handle rod (C) from the rod holder (D), and disconnect the actuator connectors (E). Take care not to bend any of the rods.

NOTE: Check the bushing for damage, and replace if necessary.

Fastener Location**► : Screw, 3**

Fig. 34: Disconnecting Lock Rod From Joint Bushing On Lock Crank
Courtesy of AMERICAN HONDA MOTOR CO., INC.

4. Remove the screws securing the latch (F), then remove the latch through the hole in the door. Take care not to bend any of the rods.
5. If necessary, detach the lock crank (A) from the door.

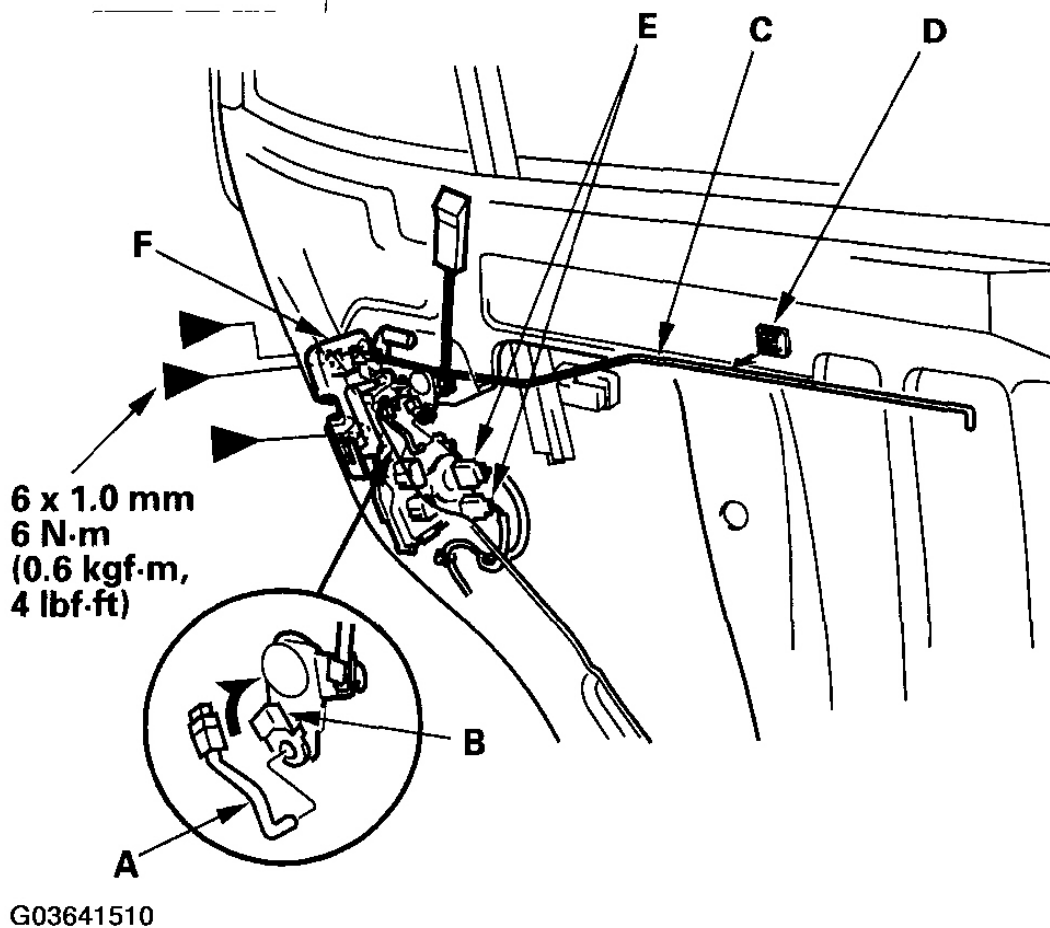
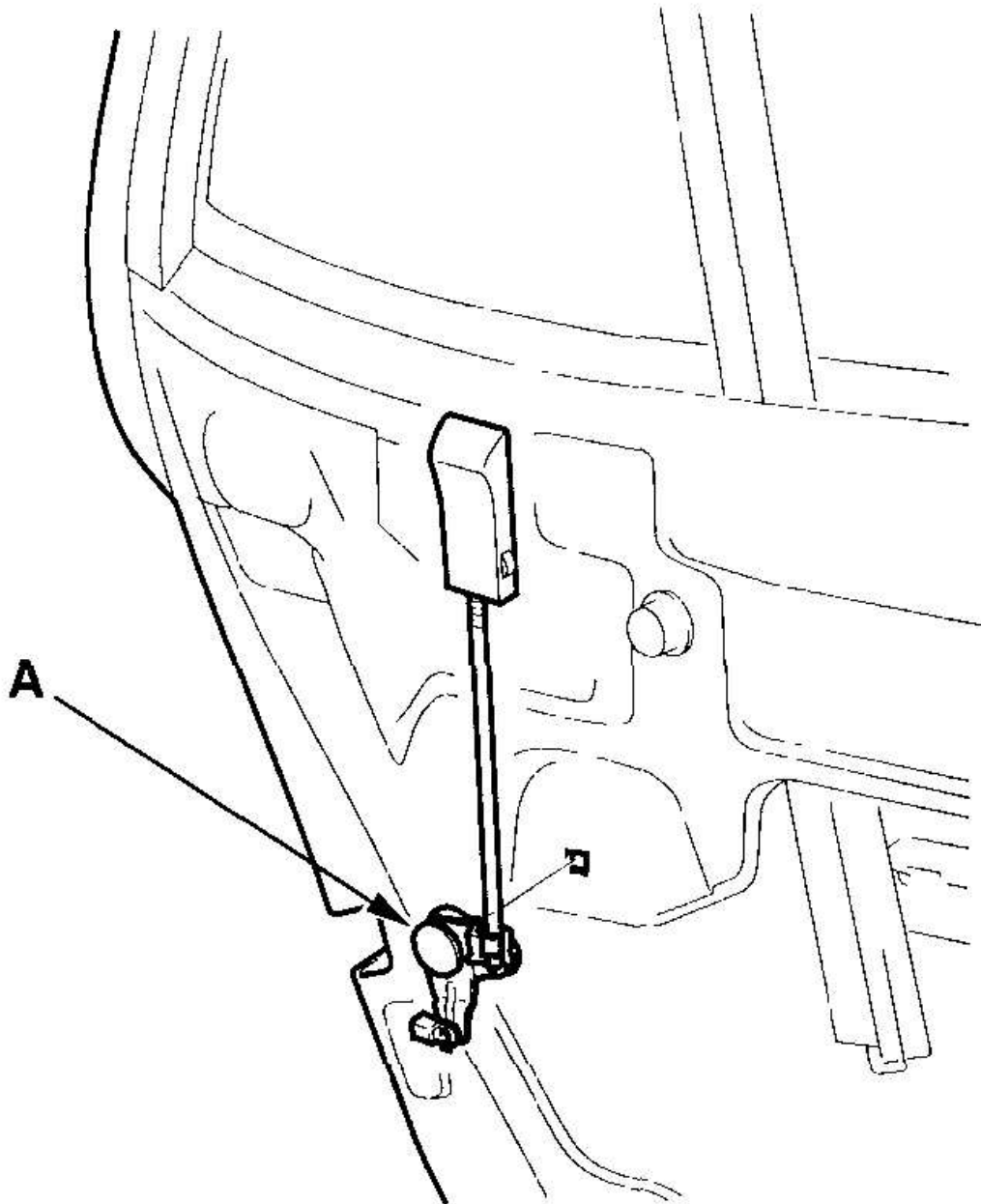

G03641511

Fig. 35: Detaching Lock Crank From Door
Courtesy of AMERICAN HONDA MOTOR CO., INC.

6. Install the latch in the reverse order of removal, and note these items:

- Make sure the actuator connectors are plugged in properly, and each rod is connected securely.
- Make sure the door locks and opens properly.
- When reinstalling the door panel, make sure the plastic cover is installed properly and sealed around its outside perimeter to seal out water.

REAR DOOR GLASS, QUARTER GLASS, AND REGULATOR REPLACEMENT

NOTE: Put on gloves to protect your hands.

1. Remove these items:
 - Door panel (see **REAR DOOR PANEL REMOVAL/INSTALLATION**)
 - Plastic cover (see **COMPONENT LOCATION INDEX - REAR DOOR**)
2. Carefully move the glass (A) until you can see the bolts, then remove them. Carefully lower the glass. Take care not to drop the glass inside the door.

Fastener Locations

► : Bolt, 2

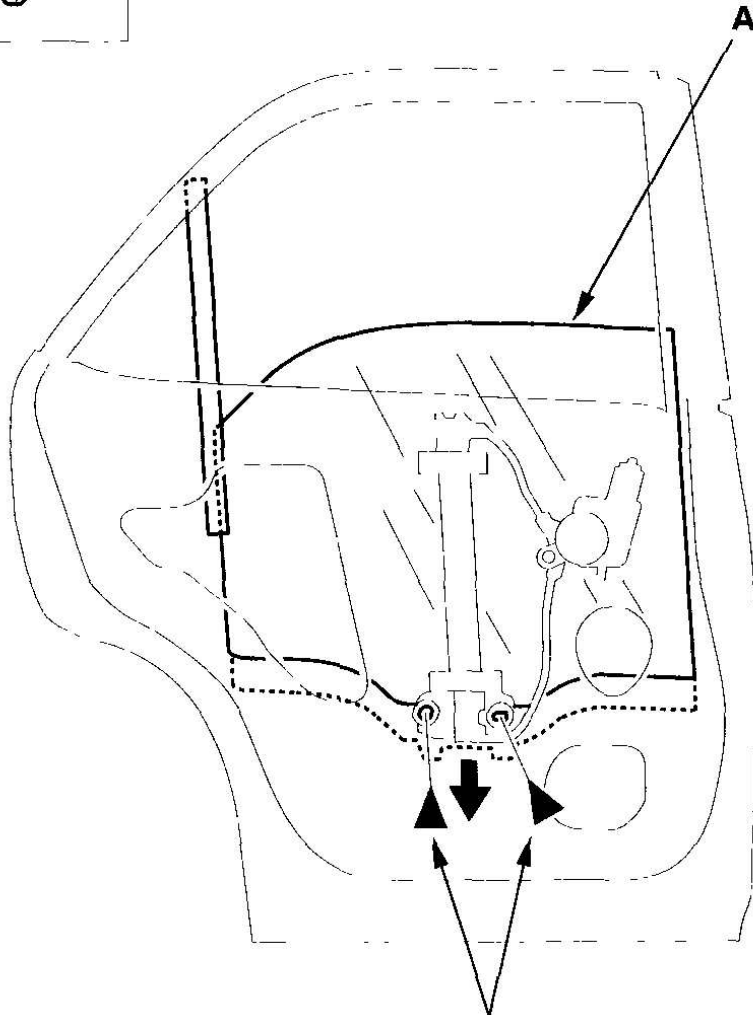
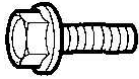

6 x 1.0 mm
9.8 N·m
(1.0 kgf·m, 7.2 lbf·ft)

G03641512

Fig. 36: Removing Glass

Courtesy of AMERICAN HONDA MOTOR CO., INC.

3. Remove the bolt (A) and collar (B) from the rear channel (C). Pull the upper seal (D) away as needed, and

2006 Acura MDX

2003-06 ACCESSORIES & EQUIPMENT Doors - MDX

remove the screw (E). Pull the glass run channel (F) away as needed from the rear channel.

Fastener Locations

A ► : Bolt, 1

E ► : Screw, 1

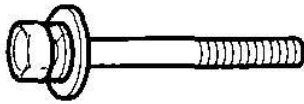

**4 x 0.8 mm
4 N·m
(0.4 kgf·m,
3 lbf·ft)**

**6 x 1.0 mm
8 N·m
(0.8 kgf·m,
6 lbf·ft)**

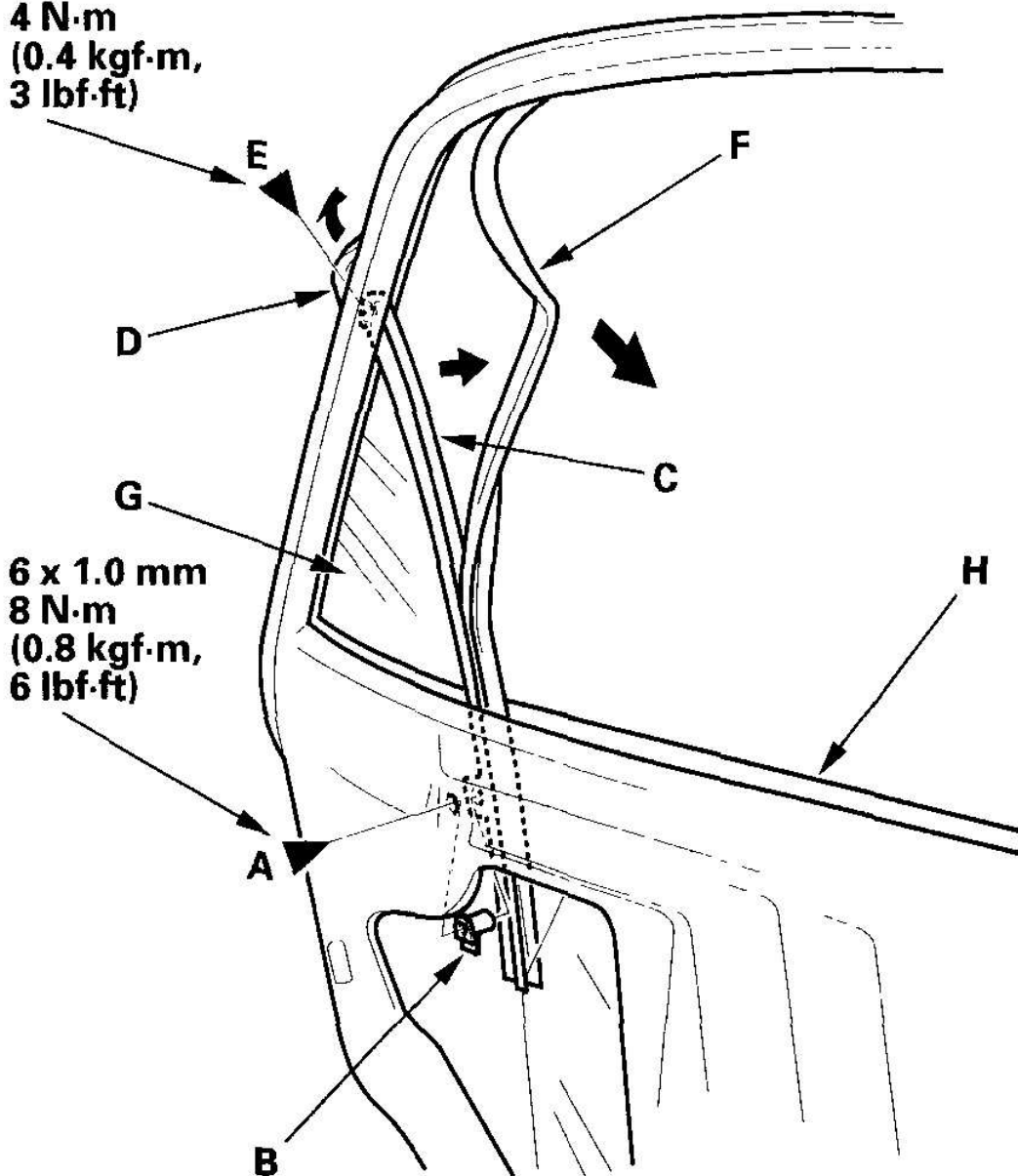
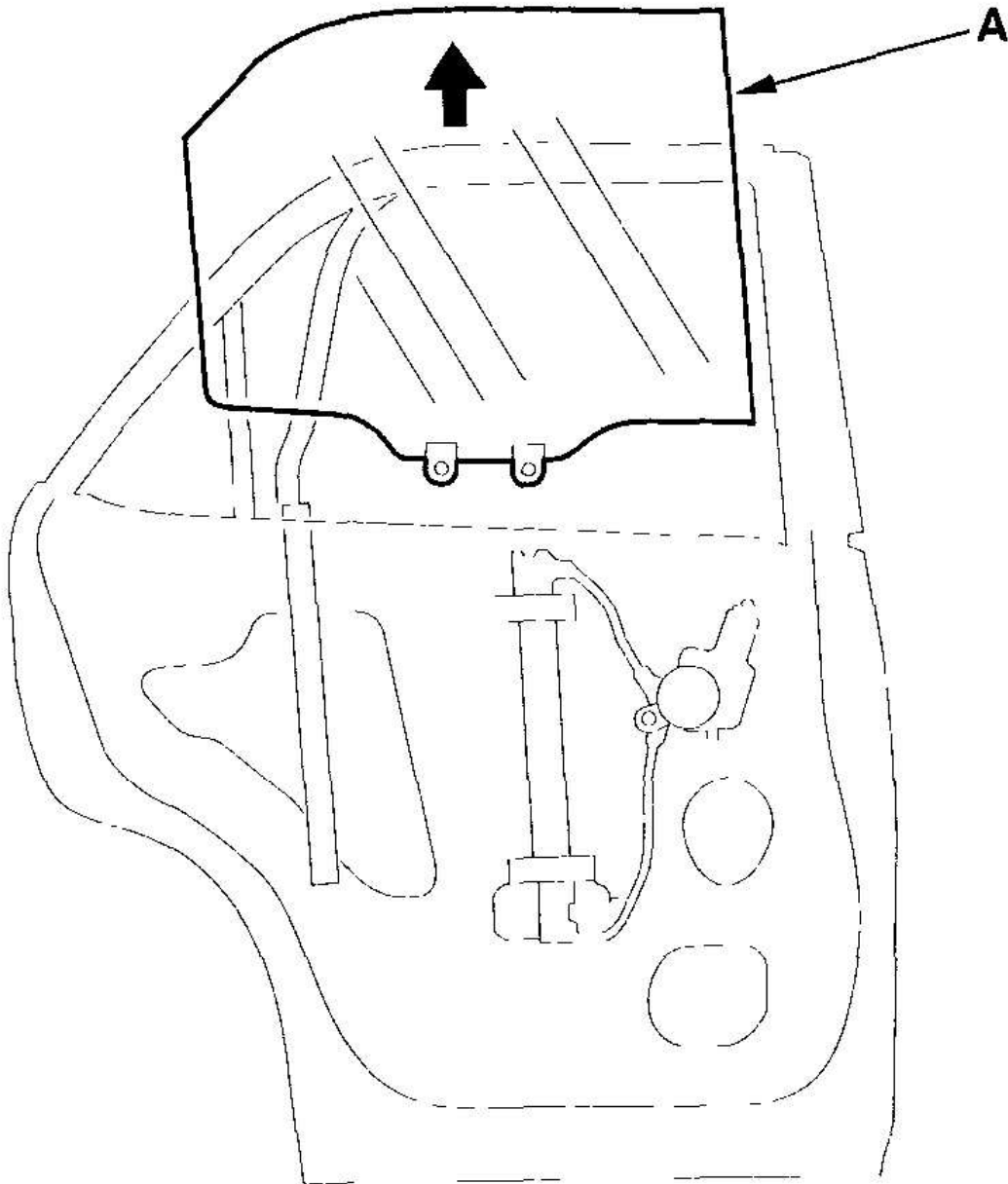

Fig. 37: Removing Collar From Rear Channel
Courtesy of AMERICAN HONDA MOTOR CO., INC.

4. Move rear channel away from the quarter glass (G), then remove it out through the window slot. Take care not to damage the door molding (H).
5. Carefully remove the glass (A) out through the window slot. Take care not to drop the glass inside the door.



G03641514

Fig. 38: Removing Glass Out Through Window Slot
Courtesy of AMERICAN HONDA MOTOR CO., INC.

6. Remove the door glass outer weatherstrip (see **REAR DOOR GLASS OUTER WEATHERSTRIP REPLACEMENT**).

7. Remove the quarter glass (A).

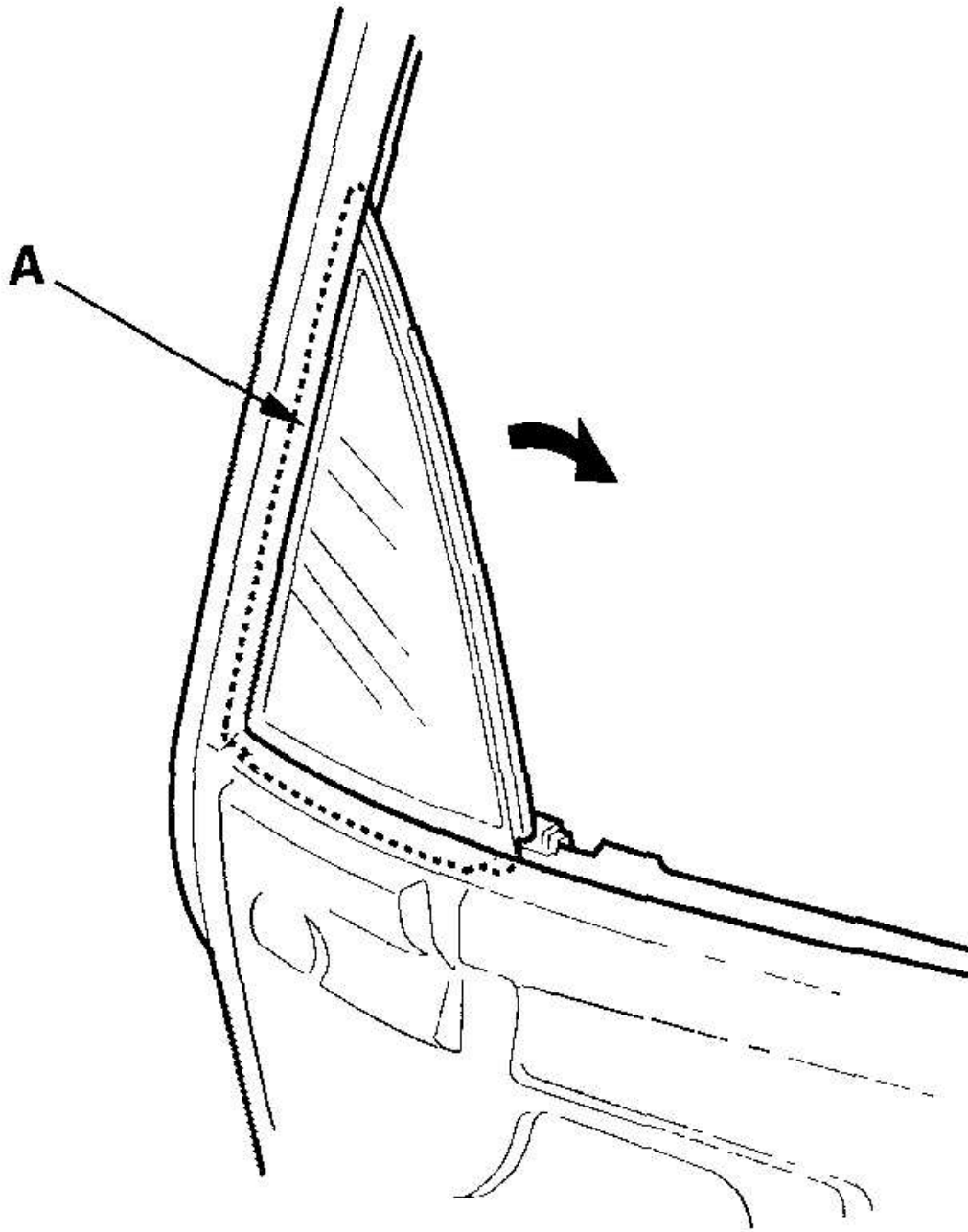

G03641515

Fig. 39: Removing Quarter Glass

Courtesy of AMERICAN HONDA MOTOR CO., INC.

8. Disconnect and detach the connector (A) and harness clip (B) from the door. Remove the bolts (C), and loosen the bolts (D), then remove the regulator (E) through the hole in the door.

Fastener Locations

C ▶ : Bolt, 4 D ▶ : Bolt, 3

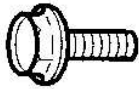
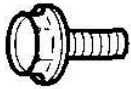

**6 x 1.0 mm
8 N·m
(0.8 kgf·m, 6 lbf·ft)**

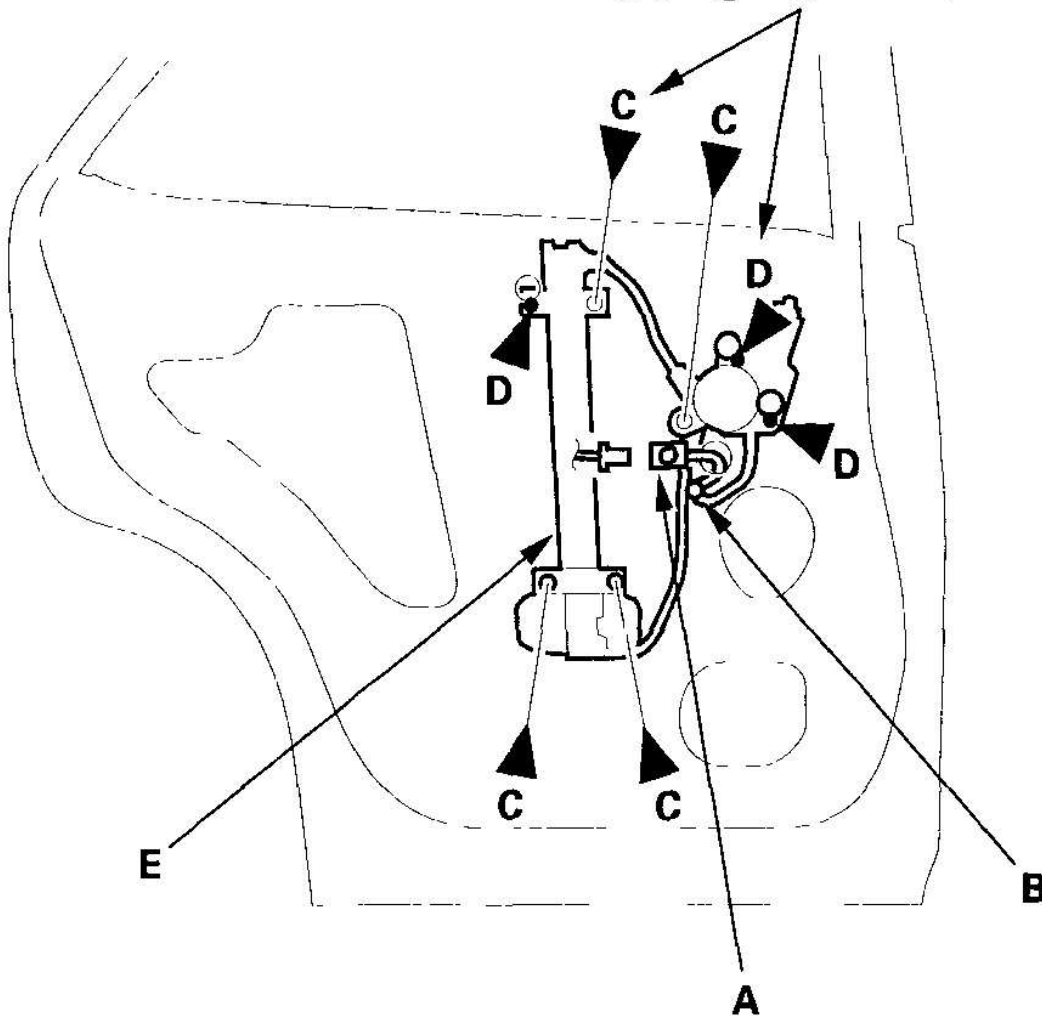

G03641516

Fig. 40: Disconnecting And Detaching Connector & Harness Clip From Door
 Courtesy of AMERICAN HONDA MOTOR CO., INC.

9. Apply multipurpose grease to all the sliding surfaces of the regulator (A) where shown in **Fig. 41** .

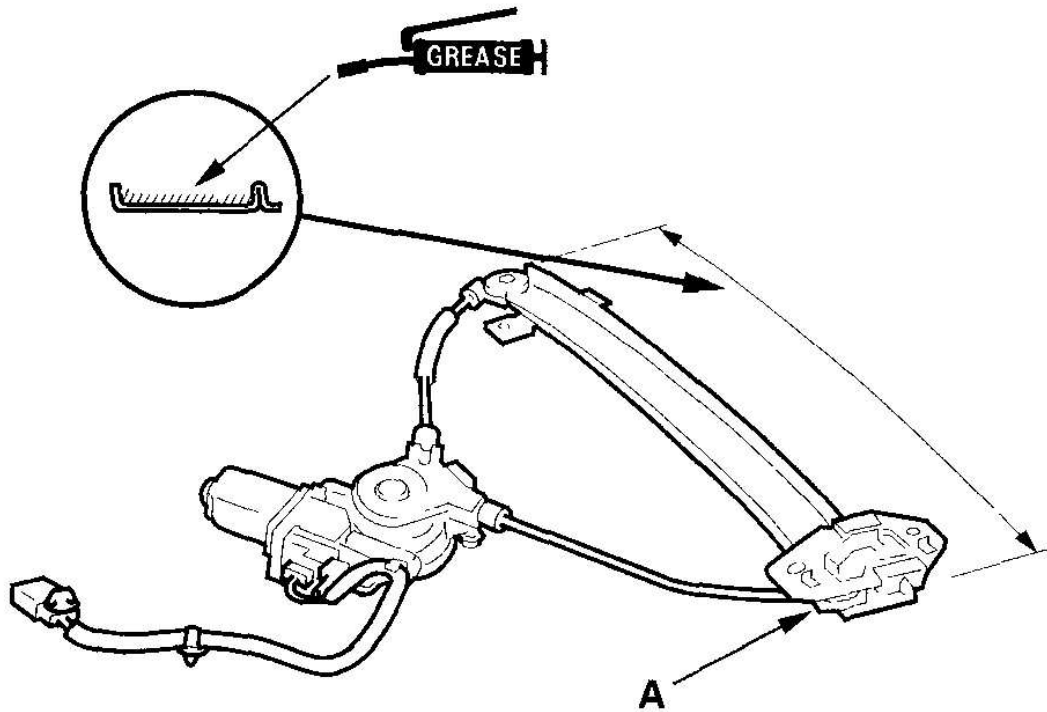

G03641517

Fig. 41: Applying Multipurpose Grease To Sliding Surfaces Of Regulator
Courtesy of AMERICAN HONDA MOTOR CO., INC.

10. Install the door glass, quarter glass, and regulator in the reverse order of removal, and note these items:
- Roll the glass up and down to see if it moves freely without binding.
 - Make sure that there is no clearance between the glass and glass run channel when the glass is closed.
 - Adjust the position of the glass as necessary (see **FRONT AND REAR DOOR GLASS ADJUSTMENT**).
 - Check for water leaks (see step 7 in **FRONT AND REAR DOOR GLASS ADJUSTMENT**).
 - Test-drive and check for wind noise and rattles.
 - When reinstalling the door panel, make sure the plastic cover is installed properly and sealed around its outside perimeter to seal out water.

REAR DOOR SASH TRIM REPLACEMENT

NOTE: Take care not to scratch the door.

2006 Acura MDX

2003-06 ACCESSORIES & EQUIPMENT Doors - MDX

1. Turn the door weatherstrip (A) at the front upper corner portion, then remove the screw.

Fastener Location

► : Screw, 1

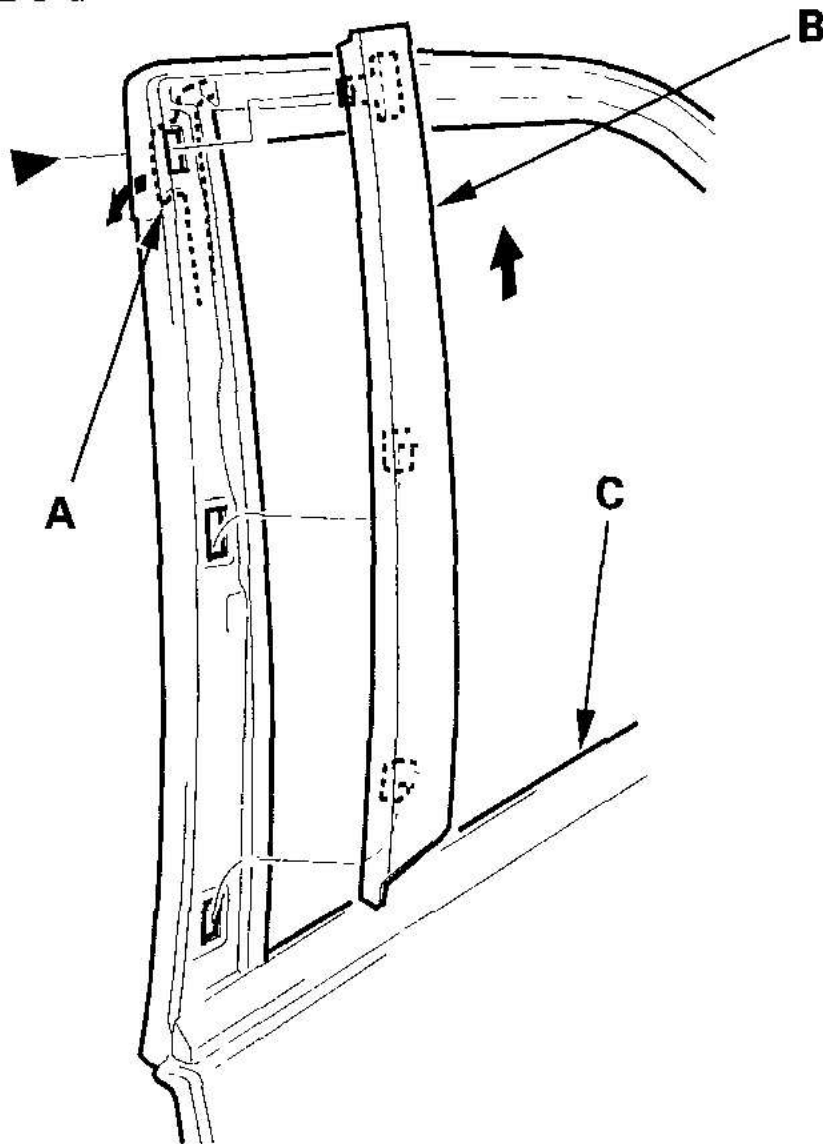
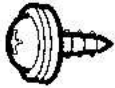

Fig. 42: Removing Door Weatherstrip At Front Upper Corner Portion
Courtesy of AMERICAN HONDA MOTOR CO., INC.

2. Pull up the sash trim (B). Take care not to damage the door glass outer weatherstrip (C).
3. Install the sash trim in the reverse order of removal.

REAR DOOR GLASS OUTER WEATHERSTRIP REPLACEMENT

NOTE:

- Put on gloves to protect your hands.
- Take care not to scratch the door and molding.

1. Starting at the front, pry the door glass outer weatherstrip (A) up to detach the clip (B).

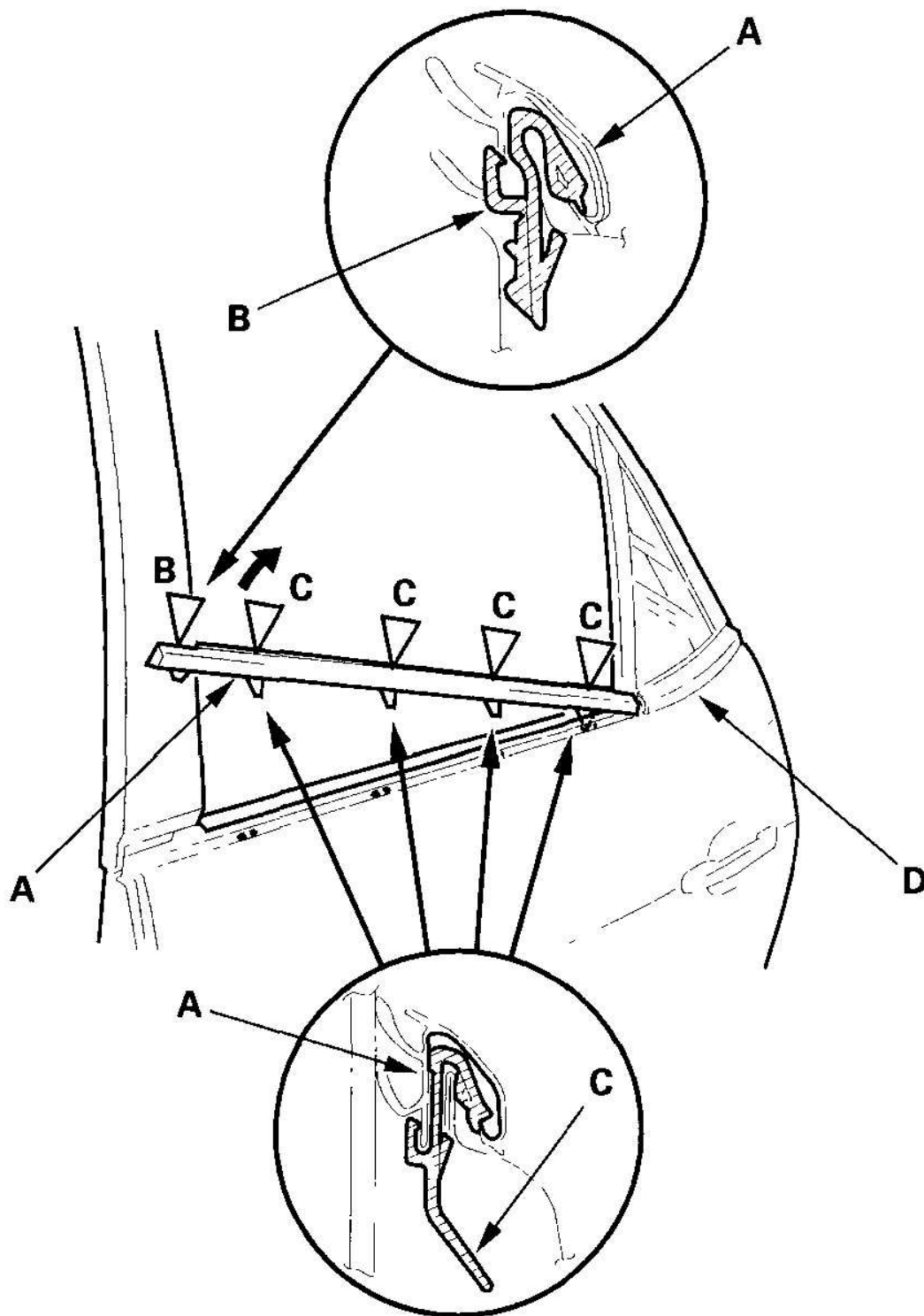

Fig. 43: Prying Door Glass Outer Weatherstrip Up To Detach Clip
Courtesy of AMERICAN HONDA MOTOR CO., INC.

2. Detach the clips (C), then pull the weatherstrip forward to release the end of it from the joint of the quarter glass seal (D).
3. Install the outer weatherstrip in the reverse order of removal, and note these items:
 - Check the clip(s) for damage or stress-whitened, and replace them with new one(s).
 - Make sure the end of outer weatherstrip is attached to the quarter glass seal securely.
 - Push the clips into place securely.

REAR DOOR WEATHERSTRIP AND REAR DOOR LOWER WEATHERSTRIP REPLACEMENT

NOTE:

- Take care not to scratch the door.
- Use a clip remover to remove the clips.

1. At the B-pillar, remove the door checker mounting bolt (A).

Fastener Locations

A  : Bolt, 1 B  : Clip, 27

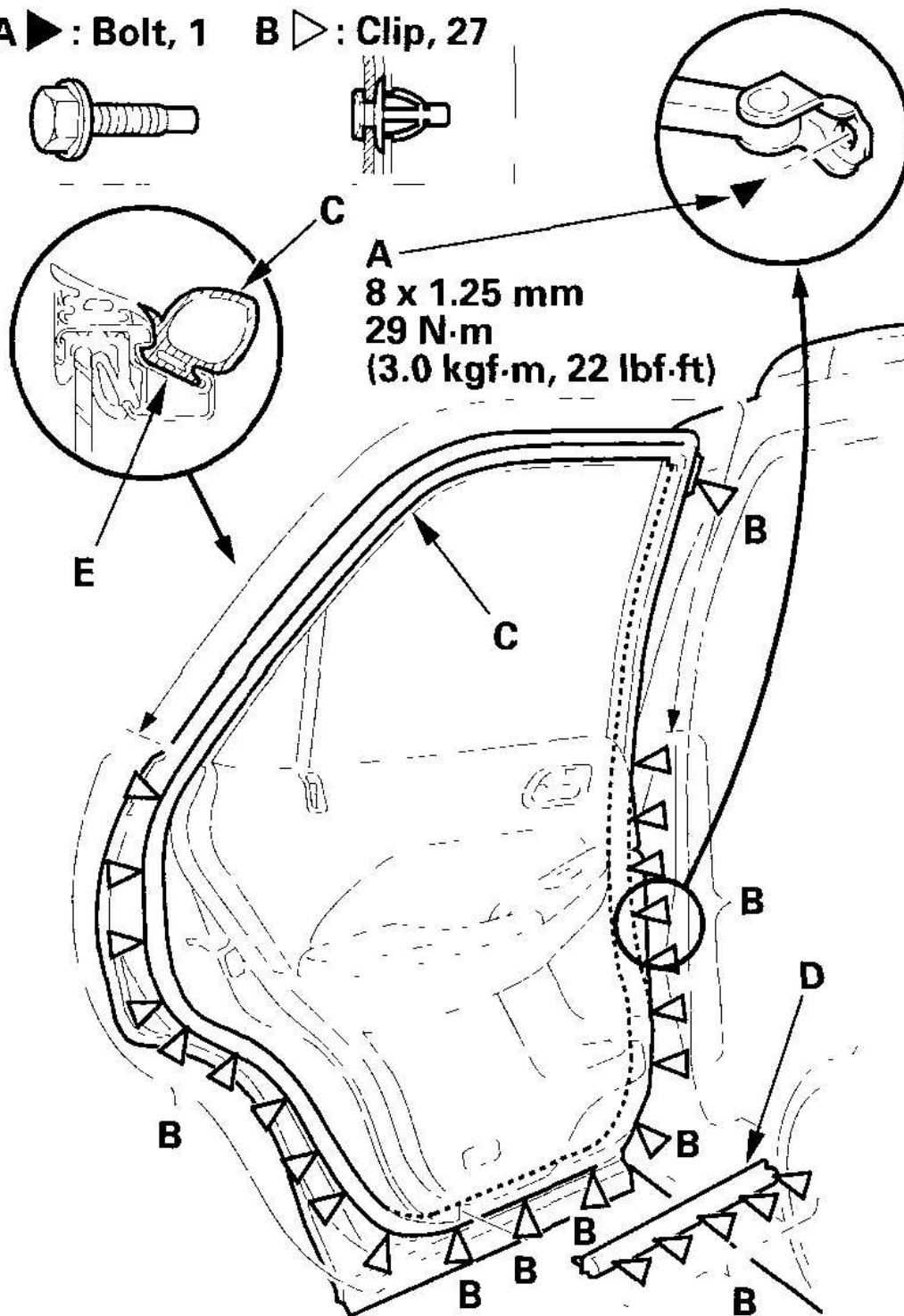

Fig. 44: Removing Door Checker Mounting Bolt At B-Pillar
Courtesy of AMERICAN HONDA MOTOR CO., INC.

2. Detach the clips (B), then remove the door weatherstrip (C), and the door lower weatherstrip (D).
3. Install the weatherstrip in the reverse order of removal, and note these items:
 - Check the clip(s) for damage or stress-whitened, and replace them with new one(s).
 - Push the clips into place securely.
 - Make sure the weatherstrip is installed in the holder (E) securely.
 - Apply liquid thread lock to the door checker mounting bolt before installation.
 - Check for water leaks (see step 7 in **FRONT AND REAR DOOR GLASS ADJUSTMENT**).
 - Test-drive and check for wind noise.

REAR DOOR UPPER SEAL REPLACEMENT

NOTE:

- **Take care not to scratch the door.**
- **Use a clip remover to remove the clips.**

1. Remove the door sash trim (see **REAR DOOR SASH TRIM REPLACEMENT**).
2. Detach the door weatherstrip clip (A) and rear clip (B), then remove the door upper seal (C).

Fastener Locations

A ▷ : Clip, 1 B ▷ : Clip, 1

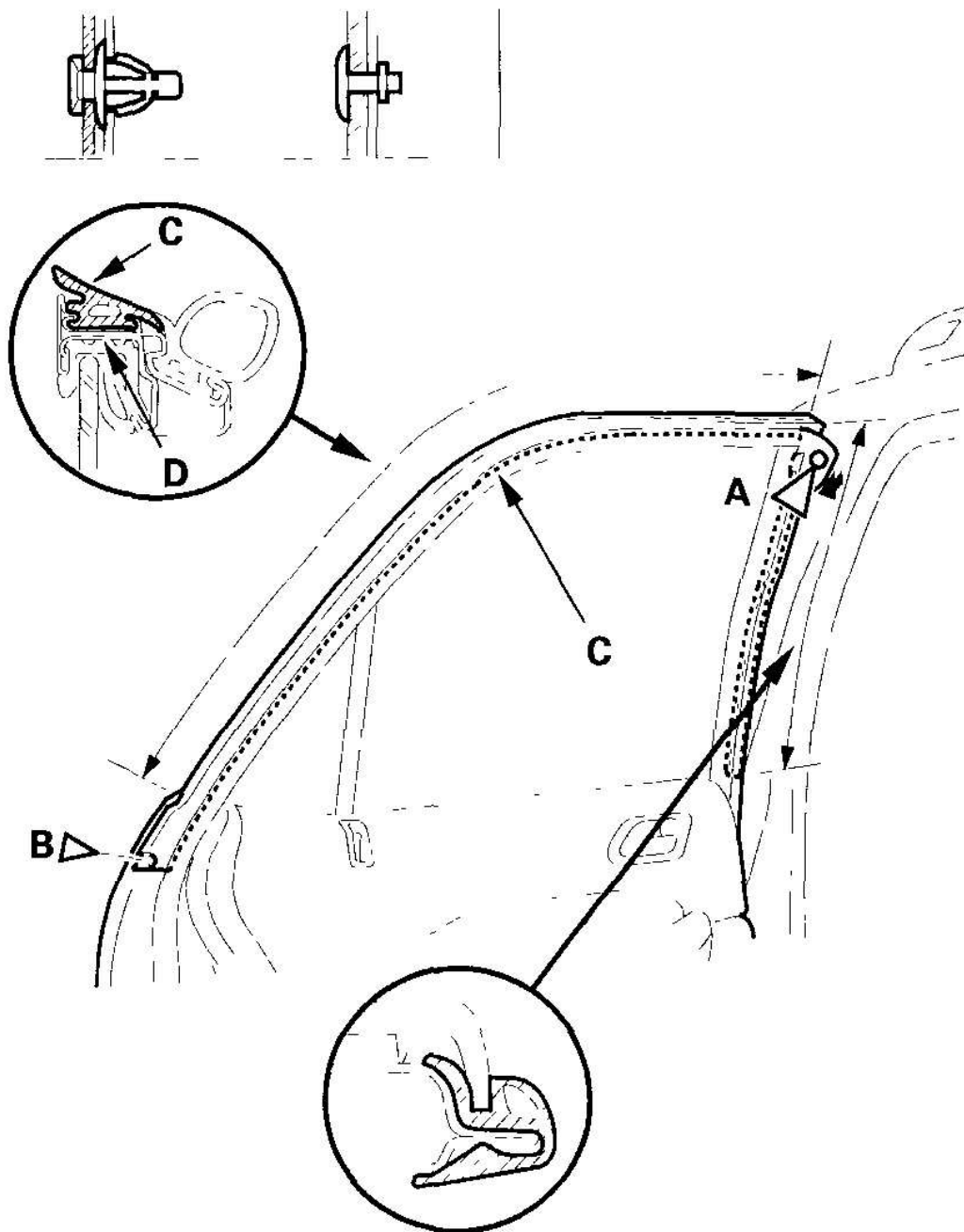

Fig. 45: Detaching Door Weatherstrip Clip And Rear Clip
Courtesy of AMERICAN HONDA MOTOR CO., INC.

3. Install the upper seal in the reverse order of removal, and note these items:
 - Check the clip(s) for damage or stress-whitened, and replace them with new one(s).
 - Push the clips into place securely.
 - Make sure the upper seal is installed in the holder (D) securely.

REAR DOOR SIDE SILL SEAL REPLACEMENT

NOTE:

- **Take care not to scratch the door.**
- **Use a clip remover to remove the clip.**

1. Detach the clips, then remove the door side sill seal (A).

Fastener Locations

▷ : Clip, 7

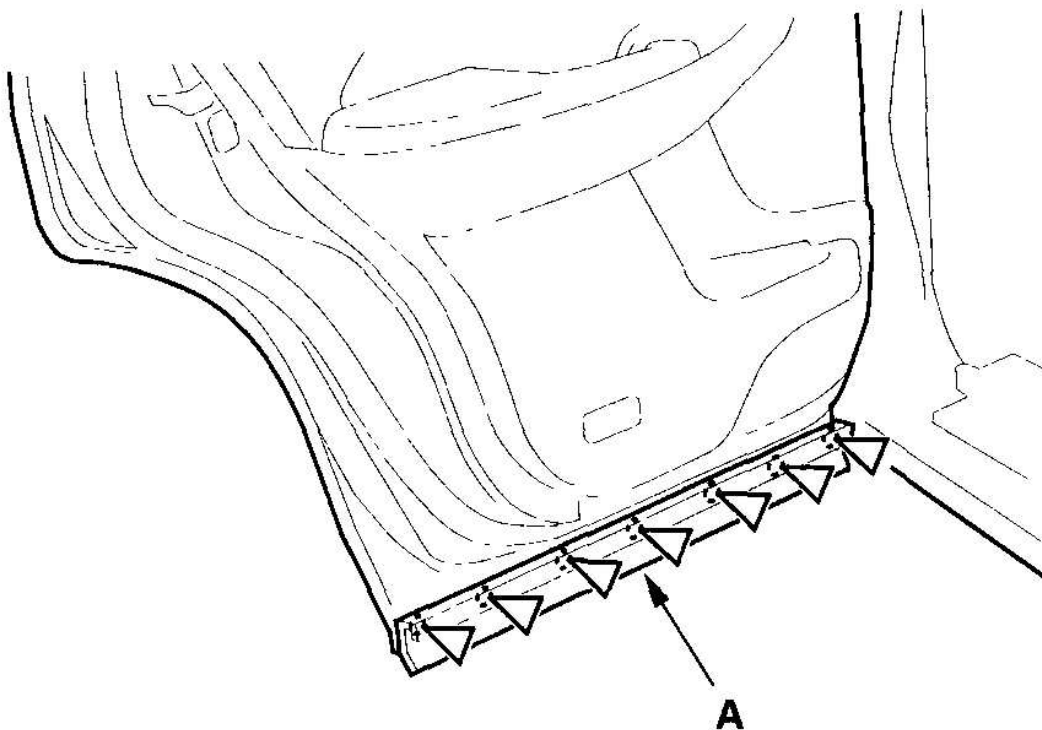
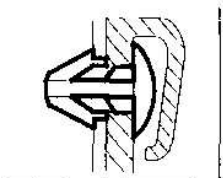

G03641522

Fig. 46: Removing Door Side Sill Seal

Courtesy of AMERICAN HONDA MOTOR CO., INC.

2. Install the side sill seal in the reverse order of removal, and note these items:
 - Check the clip(s) for damage or stress-whitened, and replace them with new one(s).
 - Push the clips into place securely.

FRONT AND REAR DOOR GLASS ADJUSTMENT

NOTE:

- Check the weatherstrips and glass run channel for damage or

2006 Acura MDX

2003-06 ACCESSORIES & EQUIPMENT Doors - MDX

deterioration, and replace them if necessary.

- Wipe the run channel clean with a shop towel.
- Lubricate the run channel with Shin-Etsu grease P/N 08798-9013.

1. Place the vehicle on a firm, level surface.
2. Remove these items:
 - Door panel, front door (see **FRONT DOOR PANEL REMOVAL/INSTALLATION**), rear door (see **REAR DOOR PANEL REMOVAL/INSTALLATION**)
 - Pull pocket bracket, front door (see **COMPONENT LOCATION INDEX - FRONT DOOR**), rear door (see **COMPONENT LOCATION INDEX - REAR DOOR**)
 - Power window control unit, front driver's door (see **COMPONENT LOCATION INDEX - FRONT DOOR**)
 - Plastic cover, front door (see **COMPONENT LOCATION INDEX - FRONT DOOR**), rear door (see **COMPONENT LOCATION INDEX - REAR DOOR**)
3. Carefully move the glass (A) until you can see the glass mounting bolts (B), then loosen them.

Front

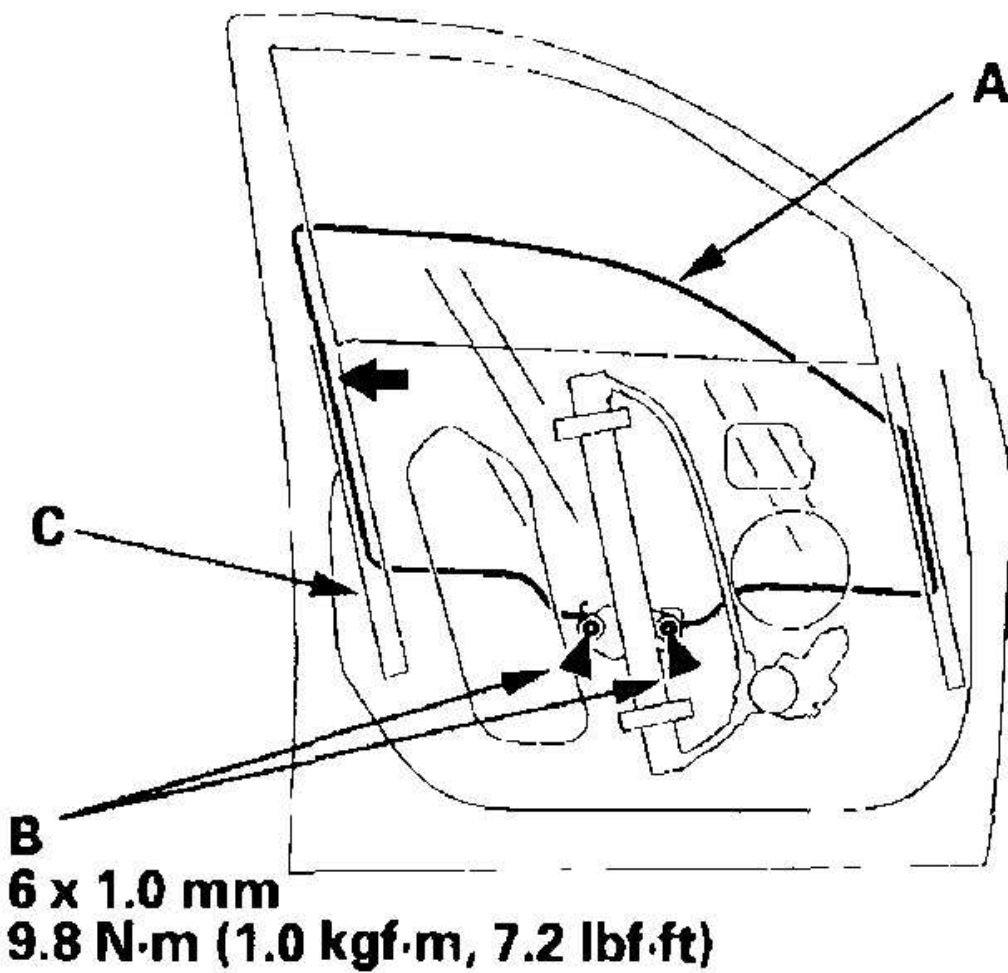

G03641523

Fig. 47: Moving Front Glass

Courtesy of AMERICAN HONDA MOTOR CO., INC.

Rear

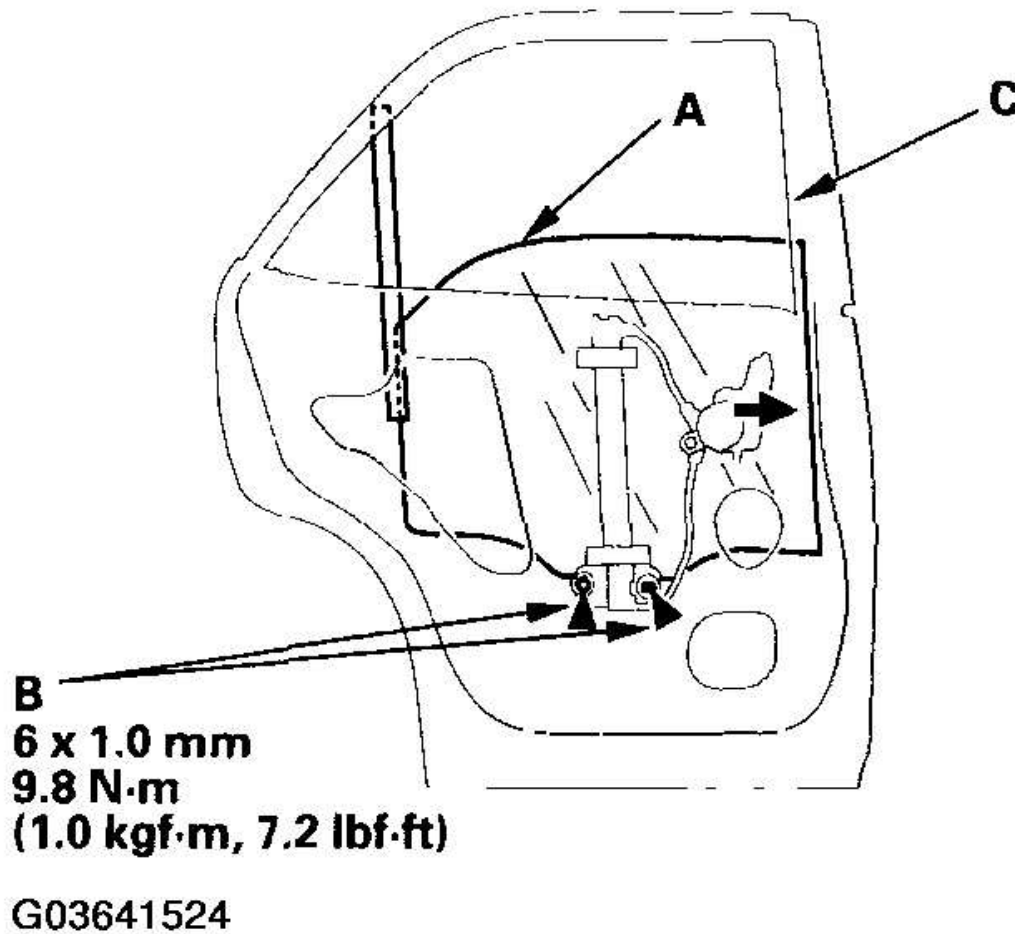
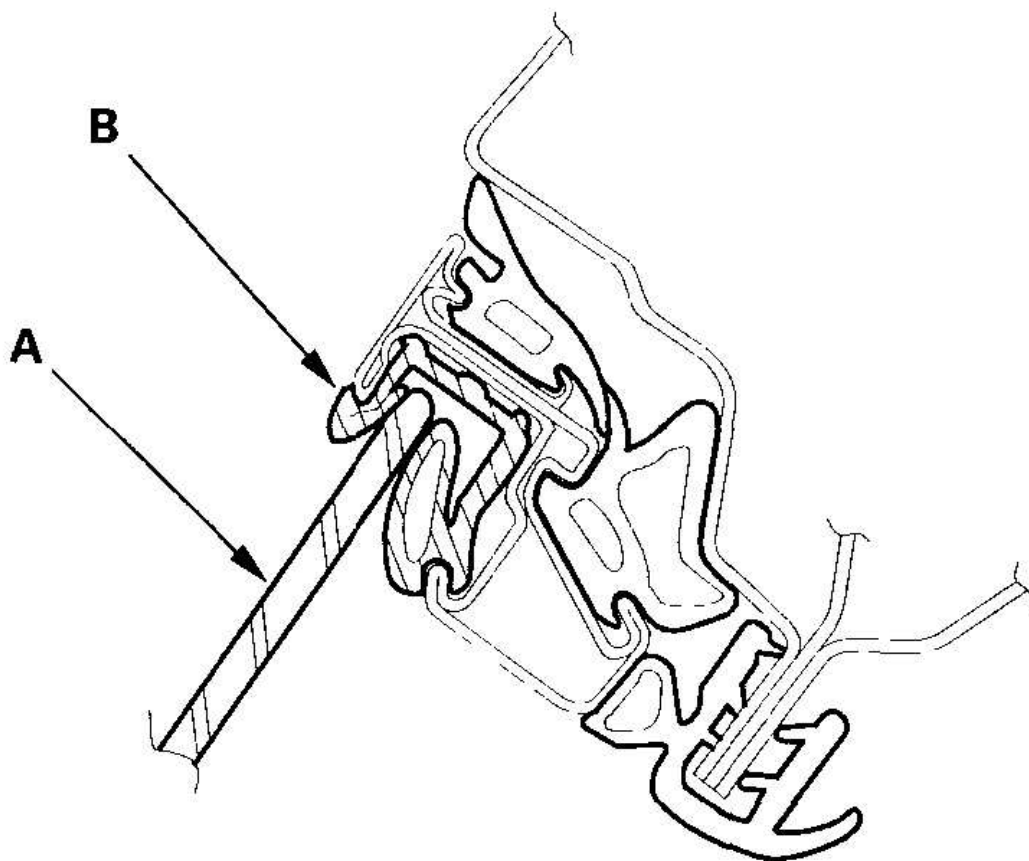

Fig. 48: Moving Rear Glass

Courtesy of AMERICAN HONDA MOTOR CO., INC.

4. Push the glass against the center channel (C), then tighten the glass mounting bolts.
5. Check that the glass moves smoothly.
6. Raise the glass fully, and check for gaps. Check that the glass (A) contacts the glass run channel (B) evenly.



G03641525

Fig. 49: Checking That Glass Contacts Glass Run Channel Evenly
Courtesy of AMERICAN HONDA MOTOR CO., INC.

7. Check for water leaks. Run water over the roof and on the sealing area as shown in **Fig. 50** , and note these items:
 - Use a 12 mm (1/2 in.) diameter hose (A).
 - Adjust the rate of water flow as shown (B) in **Fig. 50** .
 - Do not use a nozzle.
 - Hold the hose about 300 mm (12 in.) away from the door.

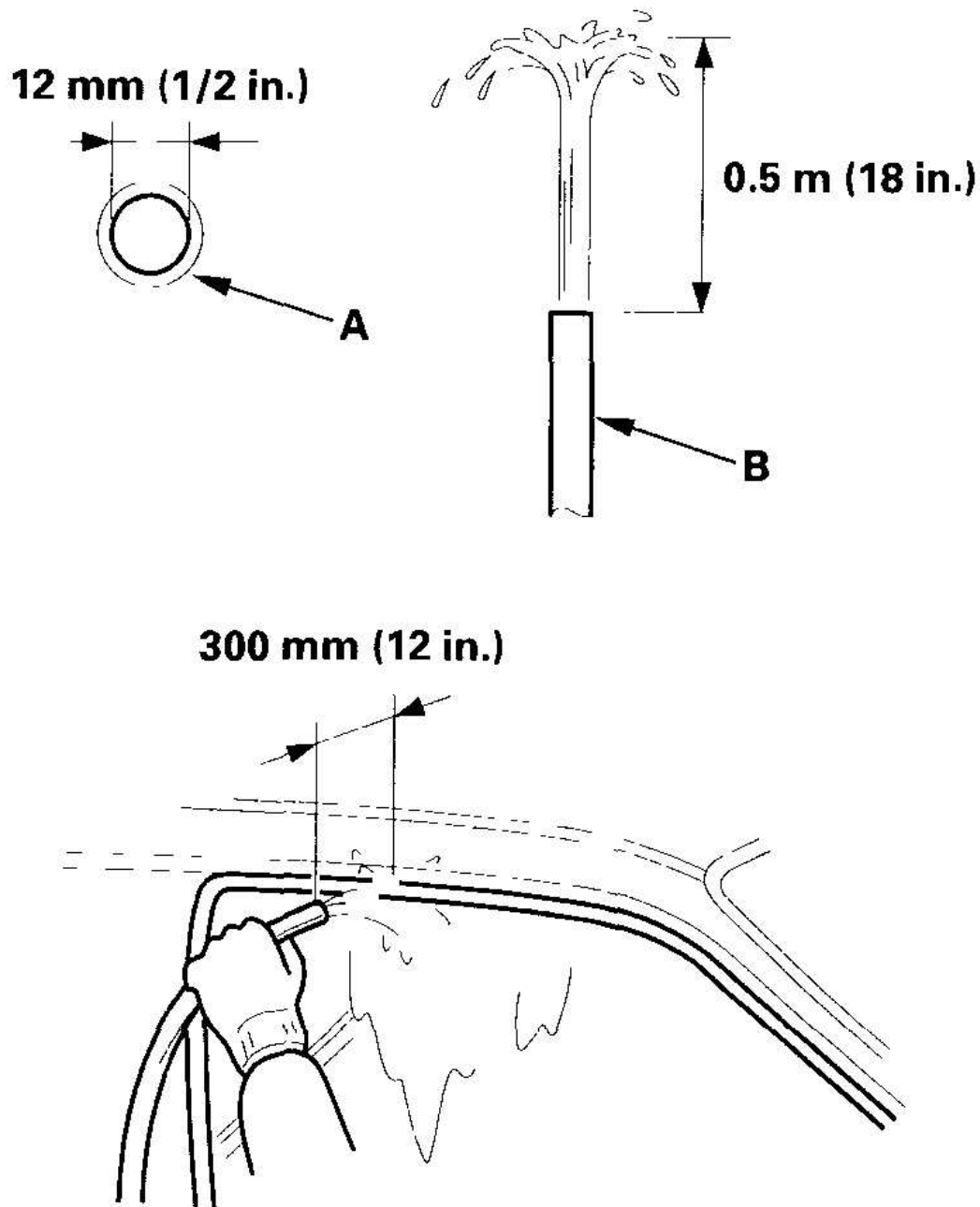

G03641526

Fig. 50: Checking Water Leaks By Running Water Over Roof
Courtesy of AMERICAN HONDA MOTOR CO., INC.

8. Attach the plastic cover, and reinstall the door panel, front door (see **FRONT DOOR PANEL**

REMOVAL/INSTALLATION), rear door (see **REAR DOOR PANEL REMOVAL/INSTALLATION**).

9. Test-drive and check for wind noise.

FRONT AND REAR DOOR POSITION ADJUSTMENT

NOTE: Check for a flush fit with the body, then check for equal gaps between the front, rear, and bottom door edges and the body. Check that the door and body edges are parallel.

1. Place the vehicle on a firm, level surface when adjusting the doors.
2. Adjust at the door (A):
 - Support the door with a jack (B) that is padded with a shop towel (C).
 - Loosen the door mounting bolts (D) slightly, and move the door up or down as necessary to equalize the gaps, and in or out until it's flush with the body.

2006 Acura MDX

2003-06 ACCESSORIES & EQUIPMENT Doors - MDX

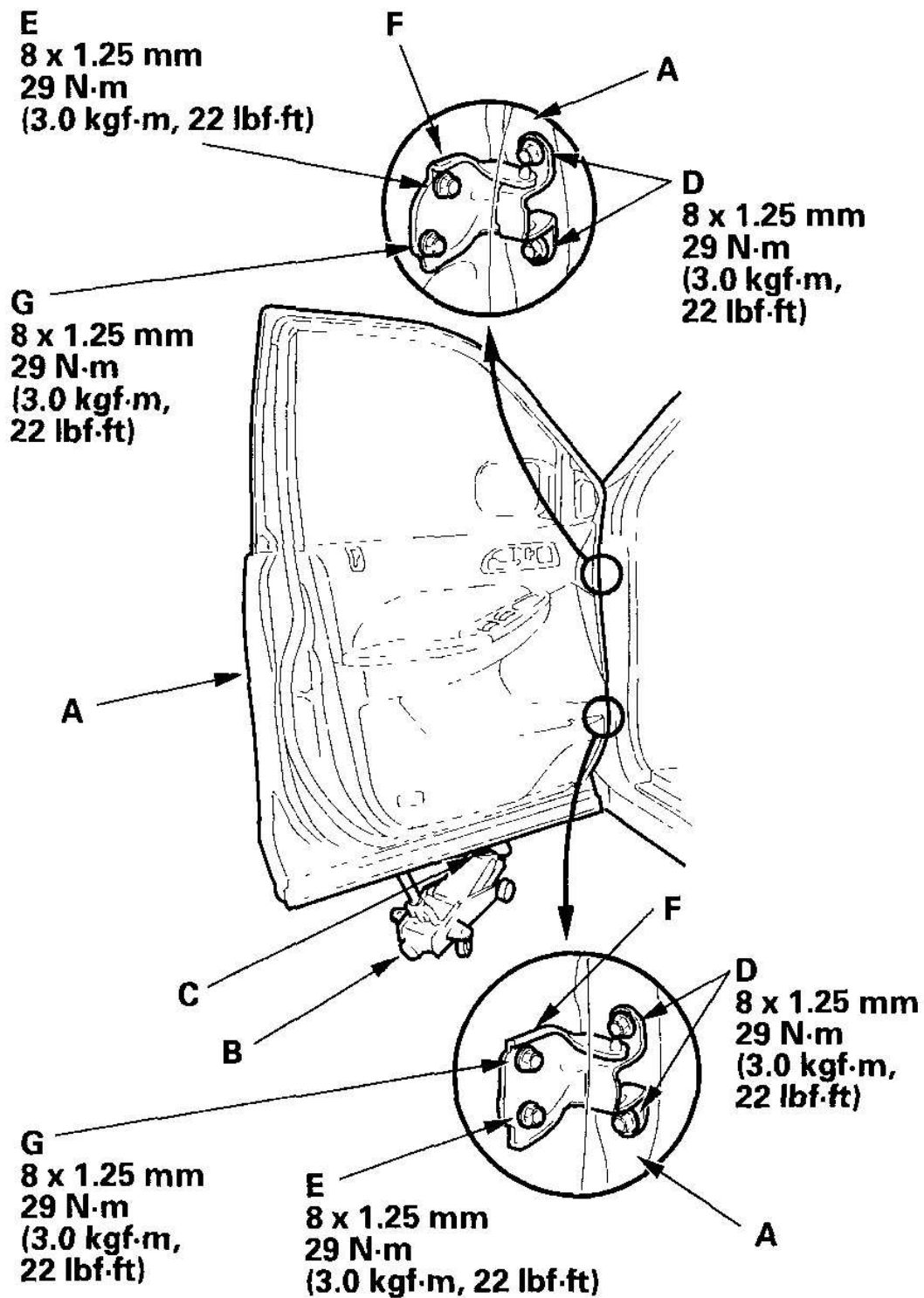

G03641527

Fig. 51: Adjusting Door

Courtesy of AMERICAN HONDA MOTOR CO., INC.

3. If necessary, replace the hinge mounting bolts (E) with adjusting bolts (P/N 90101-SZ3-000) made specifically for door adjustment, then adjust at the hinges (F):
 - Remove the front inner fender (see **FRONT INNER FENDER REPLACEMENT**) and front fender fairing (see **FRONT FENDER FAIRING REPLACEMENT**).
 - Loosen the hinge mounting bolts (E, G) slightly, and move the door backward or forward, up or down as necessary to equalize the gaps.
4. Check that the door and body edges are parallel. If necessary, adjust the door cushions (A) to make the rear of the doors flush with the body.

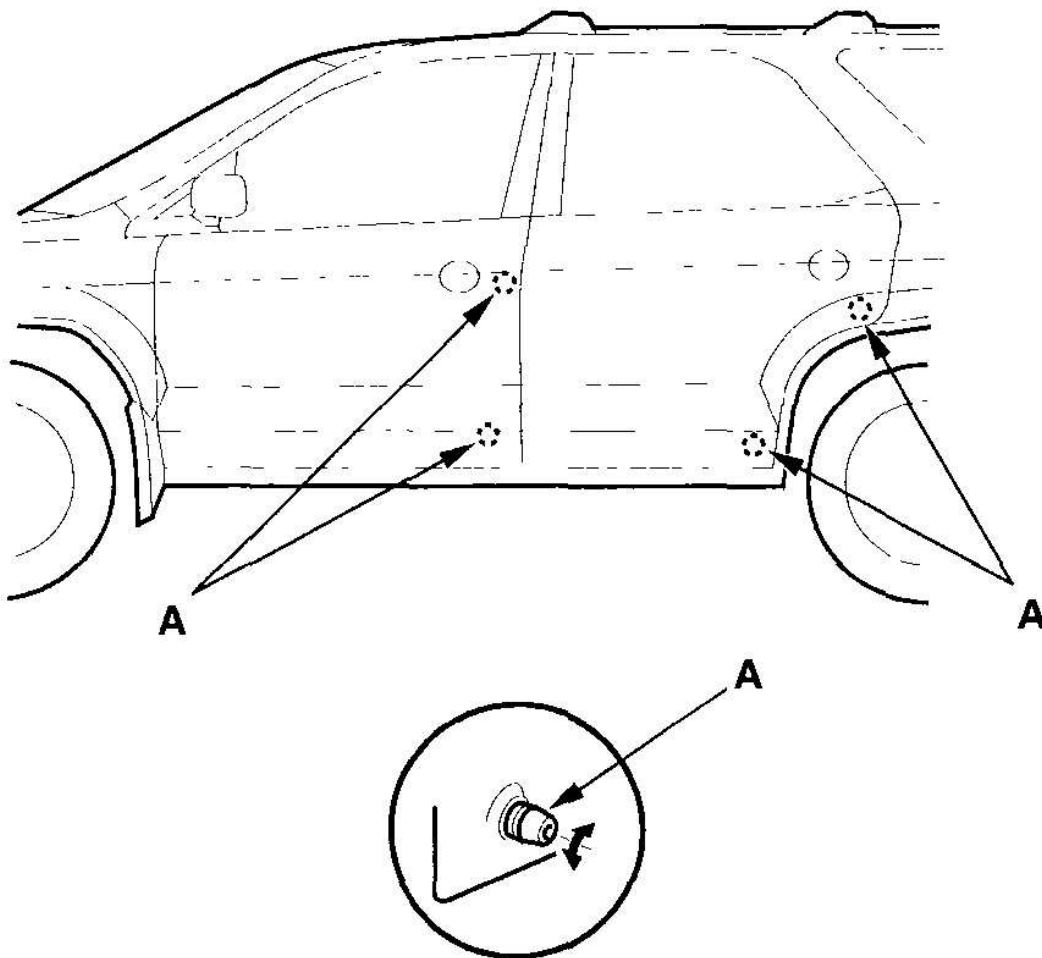

G03641528

Fig. 52: Adjusting Door Cushions

Courtesy of AMERICAN HONDA MOTOR CO., INC.

5. Apply multipurpose grease to the pivot portions of the hinges indicated by the arrows in **Fig. 53**.

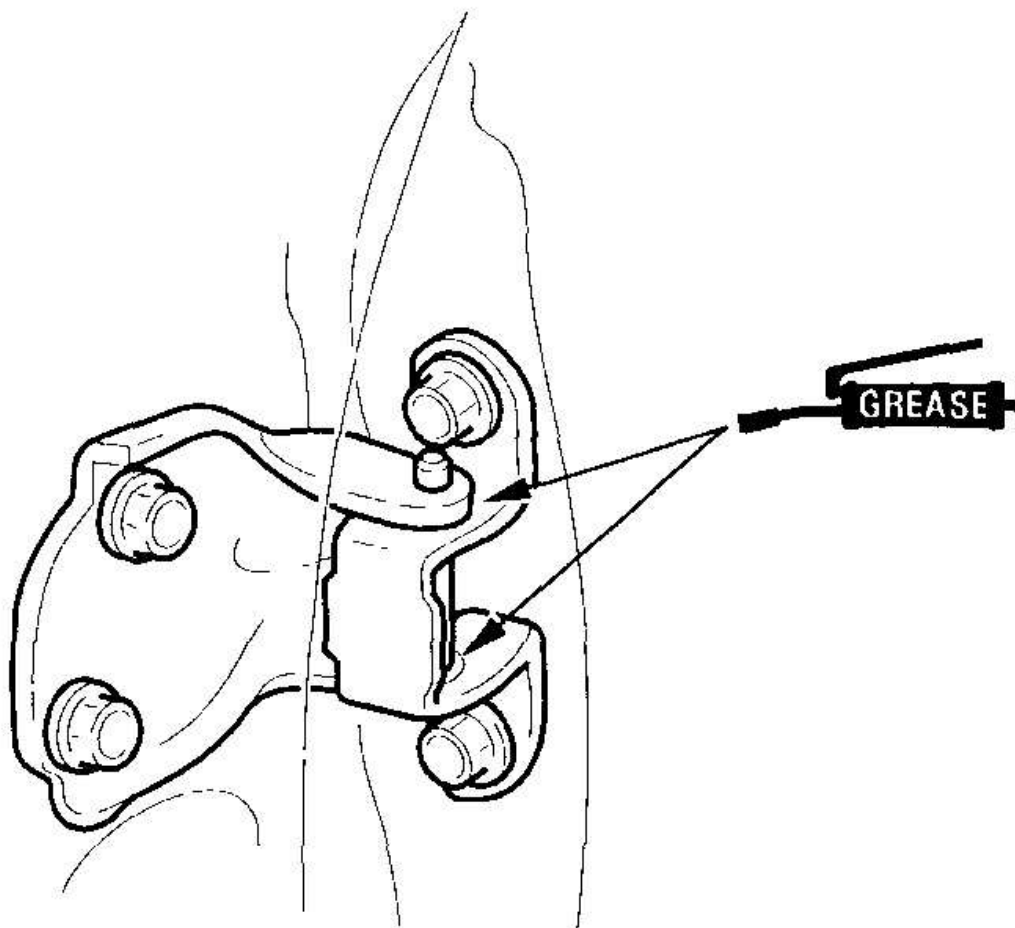

G03641529

Fig. 53: Applying Multipurpose Grease To Pivot Portions

Courtesy of AMERICAN HONDA MOTOR CO., INC.

6. Apply touch-up paint to the hinge mounting bolts, and around the hinges.
7. Check for water leaks (see step 7 in **FRONT AND REAR DOOR GLASS ADJUSTMENT**).
8. Test-drive and check for wind noise.
9. Reinstall all remaining removed parts.