

<b>2006 Acura MDX</b>
2003-06 ACCESSORIES & EQUIPMENT Exterior Trim - MDX

## **2003-06 ACCESSORIES & EQUIPMENT**

### **Exterior Trim - MDX**

## **FRONT BULKHEAD COVER REPLACEMENT**

### **Special Tools Required**

KTC trim tool set SOJATP2014

#### **NOTE:**

- **Use the appropriate tool from the KTC trim tool set to avoid damage when prying components.**
- **Take care not to scratch the front bulkhead and body.**

1. Detach the clips, then remove the front bulkhead cover (A).

## Fastener Locations

▷ : Clip, 11

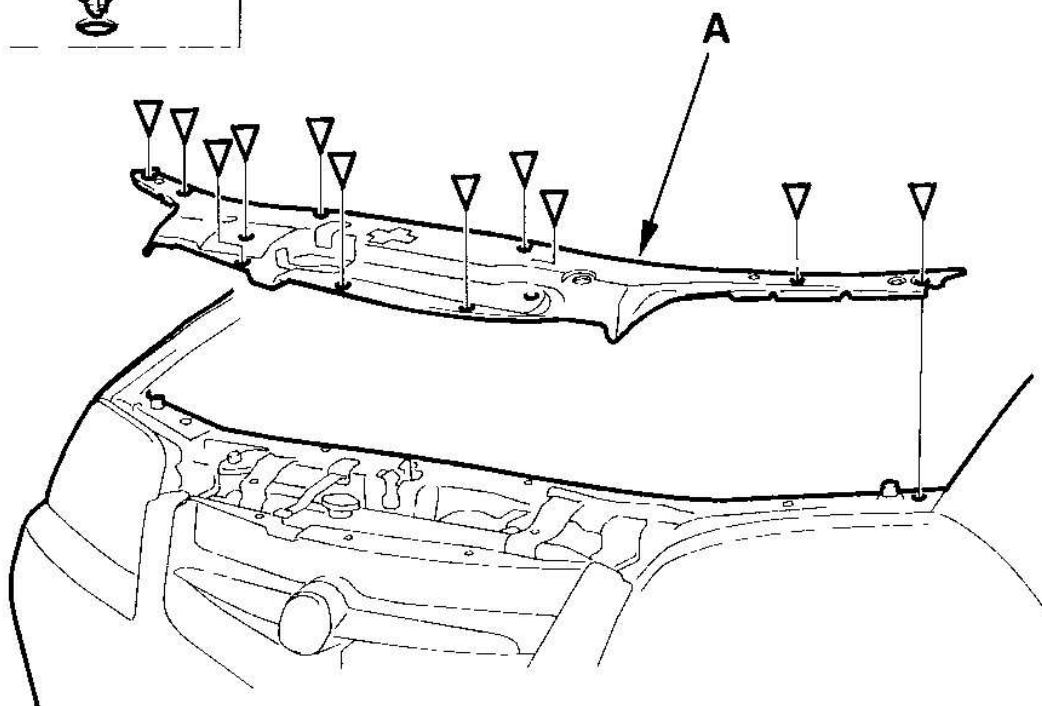

G03641766

### **Fig. 1: Removing Front Bulkhead Cover**

Courtesy of AMERICAN HONDA MOTOR CO., INC.

2. Install the front bulkhead cover in the reverse order of removal, and note these items:
  - Check the clip(s) for damage or stress-whitened, and replace them with new one(s).
  - Push the clips into place securely.

## COWL COVER REPLACEMENT

### NOTE:

- Take care not to scratch the cowl cover and body.
- Use a clip remover to remove the hood rear seal clips.

1. Remove the windshield wiper arms (see **WIPER MOTOR REPLACEMENT** ).
2. Detach the clips (A), then remove the hood rear seal (B).

### Fastener Locations

A▷: Clip, 11

D▷: Clip, 6

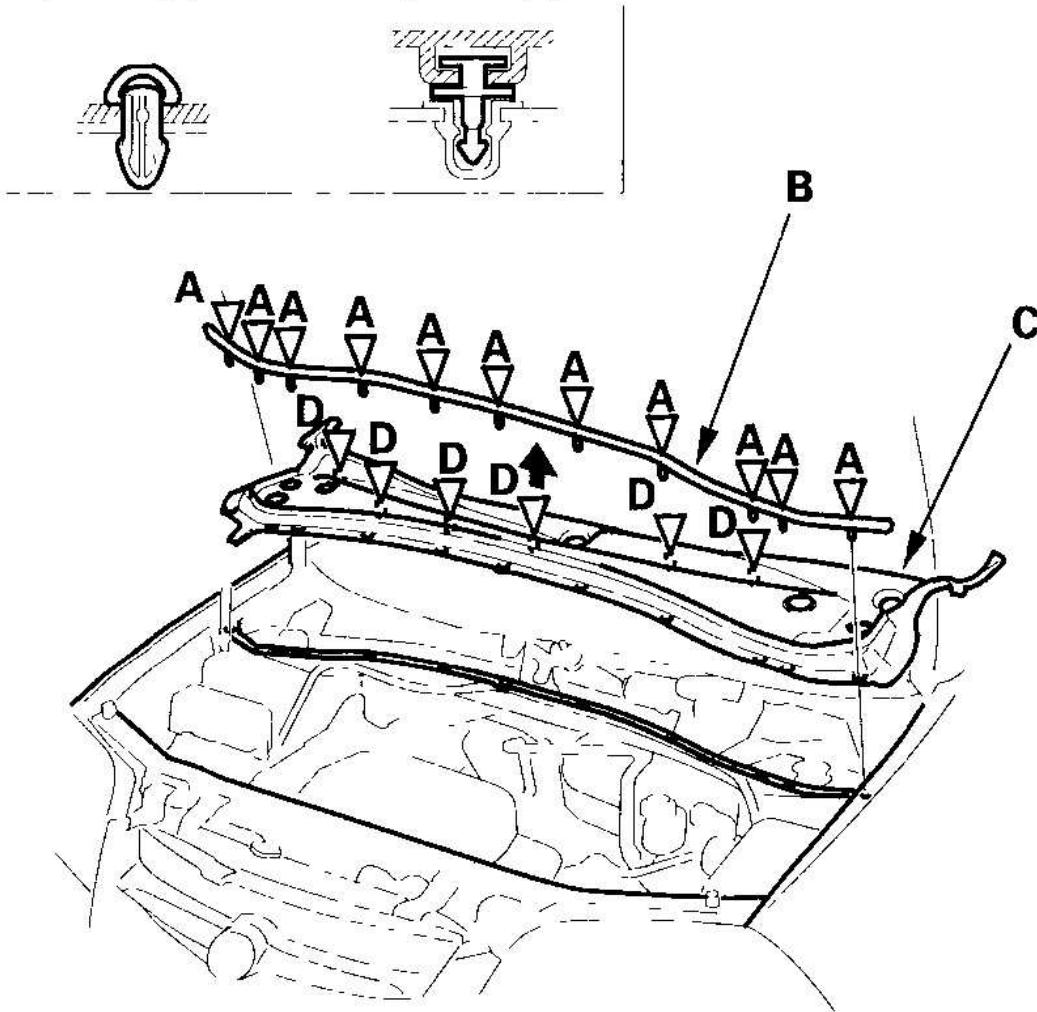

G03641767

**Fig. 2: Removing Hood Rear Seal**  
Courtesy of AMERICAN HONDA MOTOR CO., INC.

3. Pull the cowl cover (C) upward to detach the clips (D), then remove the cover.

4. Install the cowl cover in the reverse order of removal, and note these items:
  - Check the clip(s) for damage or stress-whitened, and replace them with new one(s).
  - Push the clips into place securely.

## ROOF RACK REPLACEMENT

### NOTE:

- When prying with a flat-tip screwdriver, wrap it with protective tape to prevent damage.
- Take care not to scratch the cover, roof rack and body.
- The front roof rack is wider than the rear roof rack. The rear cross rail has a caution label.

1. Remove the bracket covers (A) by sliding them in the direction shown in **Fig. 3** while pushing the spring plate (B) through the hole on each bracket with a flat-tip screwdriver. With a T30 Torx bit, remove the nuts from each bracket (C).

#### Fastener Locations

● : Nut, 8

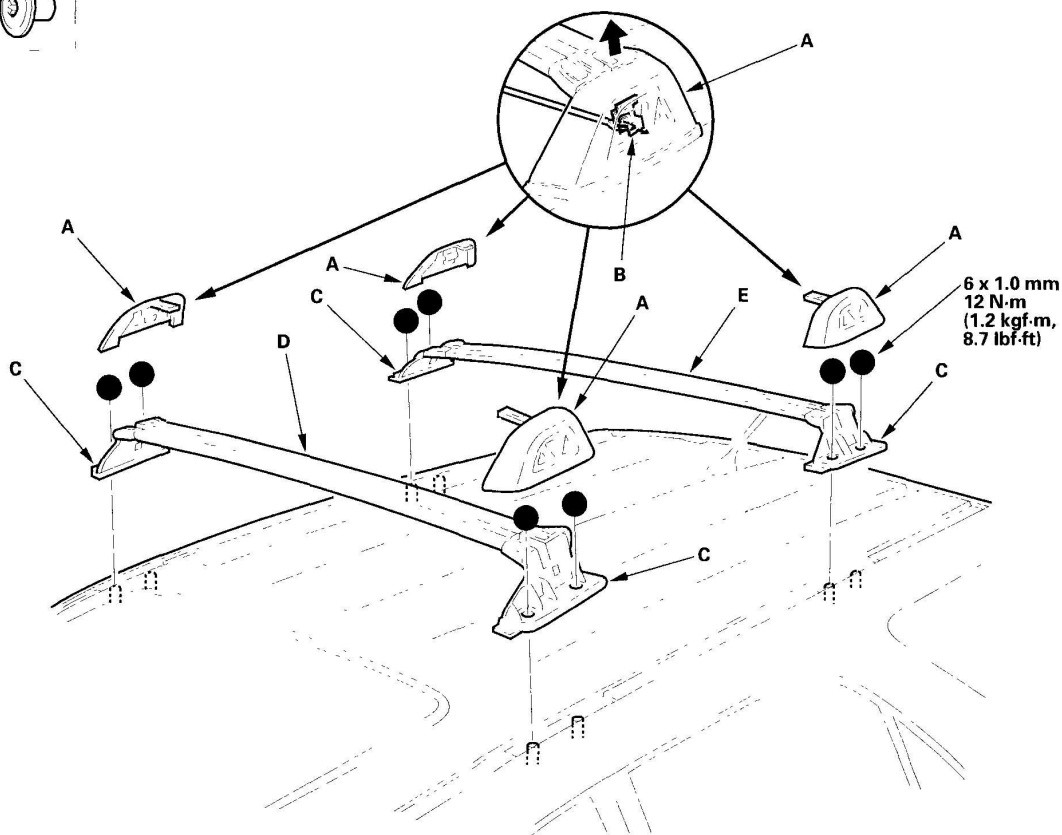

**Fig. 3: Removing Bracket Covers****Courtesy of AMERICAN HONDA MOTOR CO., INC.**

2. Remove the front roof rack (D) and rear roof rack (E). Do not remove the rubber pads from the brackets.
3. Install the roof racks in the reverse order of removal, and make sure the bracket covers are tightly snapped into place.

**ROOF MOLDING REPLACEMENT****Special Tools Required**

KTC trim tool set SOJATP2014

**NOTE:**

- Take care not to scratch the body.
- Use the appropriate tool from the KTC trim tool set to avoid damage when prying components.
- The steel core in the roof molding cannot be restored to its original shape once it is bent. Replace the roof molding when the steel core is bent.

1. If equipped, remove the front and rear roof racks (see **ROOF RACK REPLACEMENT** ).
2. Using a trim tool and a shop towel on the body, detach the clips by prying up the roof molding (A), or front roof molding (B) and rear roof molding (C), and middle molding (D) on vehicles without a roof rack.

### Fastener Locations

▷ : Clip

Without roof rack, 4

With roof rack, 2

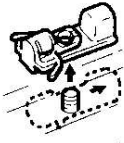

Without roof rack

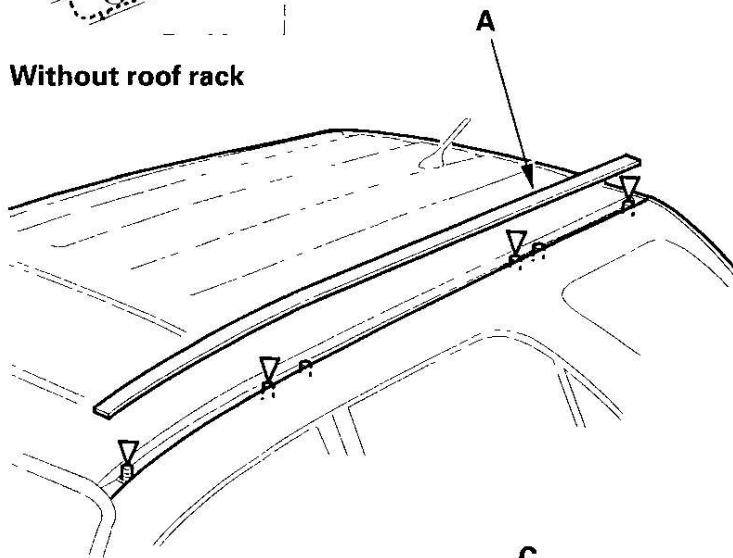

With roof rack

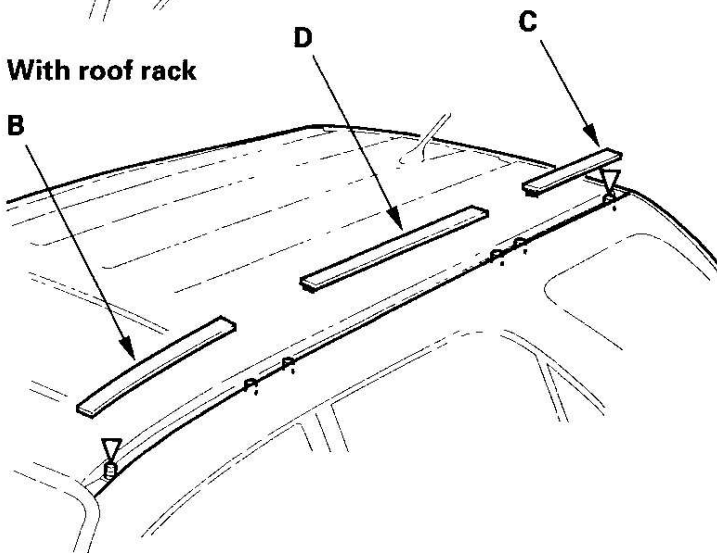

G03641769

**Fig. 4: Prying Up Roof Molding**

Courtesy of AMERICAN HONDA MOTOR CO., INC.

3. Install the roof molding(s) in the reverse order of removal, and note these items:

- Replace any damaged clips. The front end clip should be installed on the body with its hook toward the front, and the rear end clip should be installed with its hook toward the rear.
- Make sure the roof moldings (A) are installed on the clips (B) securely.

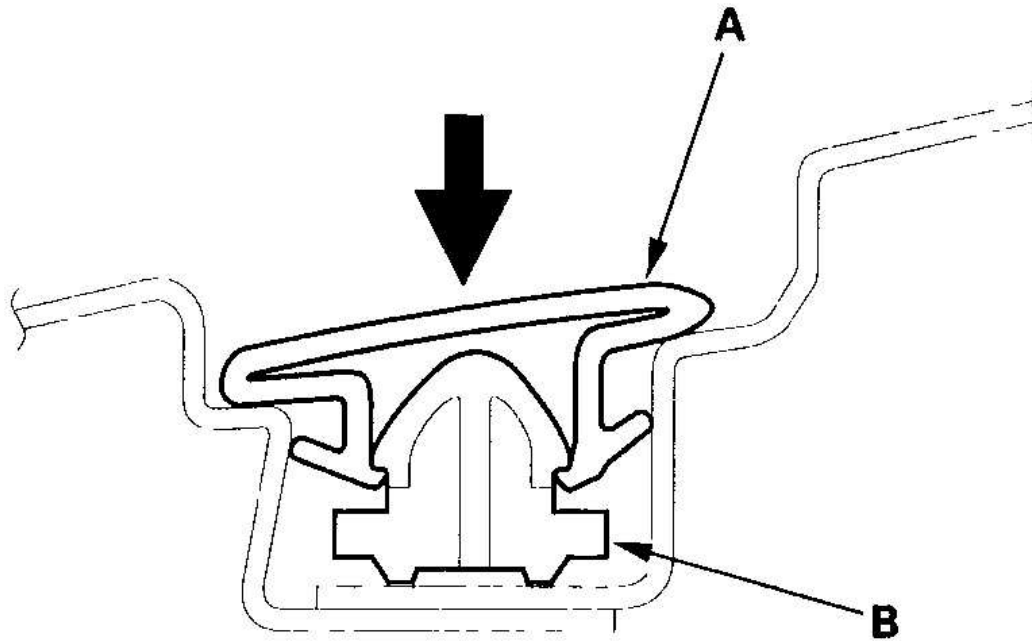

G03641770

**Fig. 5: Making Sure Roof Molding Are Installed On Clips**  
Courtesy of AMERICAN HONDA MOTOR CO., INC.

## **SIDE SILL PANEL REPLACEMENT**

1. Remove the side sill panel.
  - 1 Remove the screws (A), then remove the front splash guard (B).
  - 2 Pull the inner fender (C) back as necessary.
  - 3 Slide the side sill panel (D) forward, and remove it. The side clips (E) will stay in the body.
  - 4 Remove the side clips from the body.

**Fastener Locations**

A ► : Screw, 5    E ► : Clip, 11

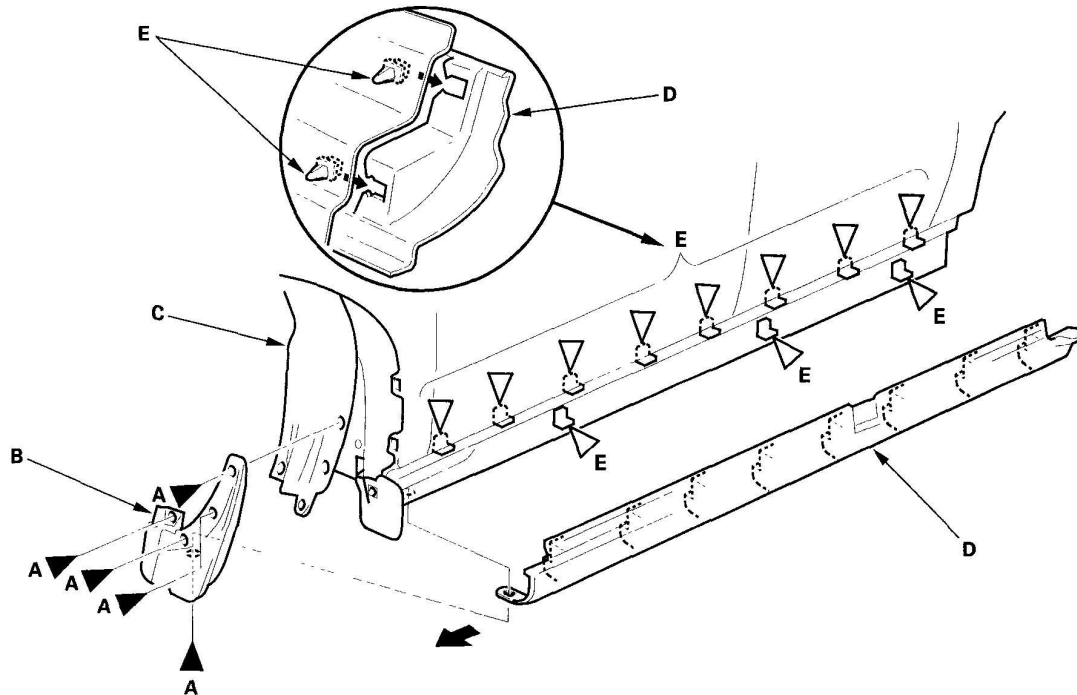
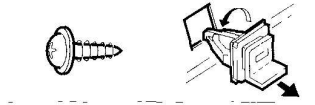

G03641771

**Fig. 6: Removing Side Sill Panel**

Courtesy of AMERICAN HONDA MOTOR CO., INC.

2. Check the clips for damage or stress-whitening, and replace them with new one.
3. Install the side clips on the side sill panel.
4. Hold the panel up, and fit all the side clips into the holes in the body, then push on the panel until the clips snap into place.
5. Reinstall the inner fender and front splash guard.

## REAR LICENSE TRIM REPLACEMENT

**NOTE:** Take care not to scratch the rear license trim and tailgate.

1. Remove the tailgate trim panel (see **TRIM REMOVAL/INSTALLATION - TAILGATE AREA** ).
2. Remove the nuts (A), and push out the clips (B) from inside, then remove the rear license trim (C).



## Fastener Locations

A ● : Nut, 2

B ▷ : Clip, 2

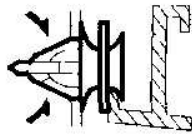

5 x 0.8 mm  
4 N·m  
(0.4 kgf·m, 3 lbf·ft)

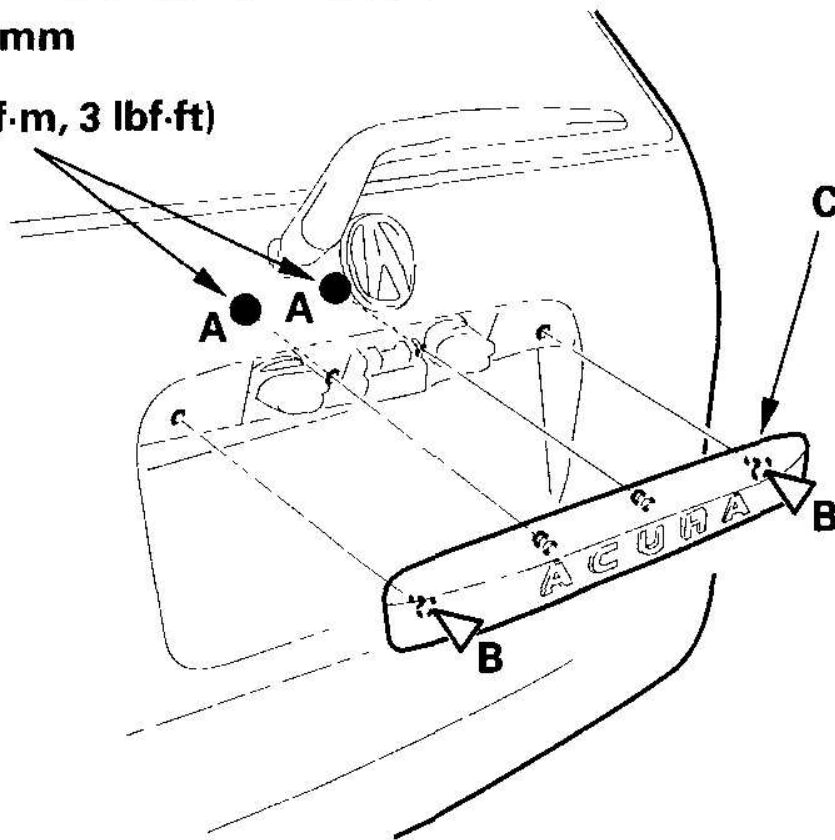

G03641772

**Fig. 7: Removing Rear License Trim**

Courtesy of AMERICAN HONDA MOTOR CO., INC.

3. Install the rear license trim in the reverse order of removal, and note these items:
  - Check the clips for damage or stress-whitening, and replace them with new one.
  - Push the clips into place securely.

## EMBLEM REPLACEMENT

**NOTE:** When removing the emblems, take care not to scratch the trunk lid.

Apply the emblems where shown in **Fig. 8**, and note these items:

- Clean the body and rear license trim surface, and the rear door quarter glass inside surface with a sponge dampened in isopropyl alcohol.
- After cleaning, keep oil, grease, and water from getting on the surface.
- Apply the ULEV emblem on the inside surface of the left rear door quarter glass, parallel with the glass mark as shown in **Fig. 8**.

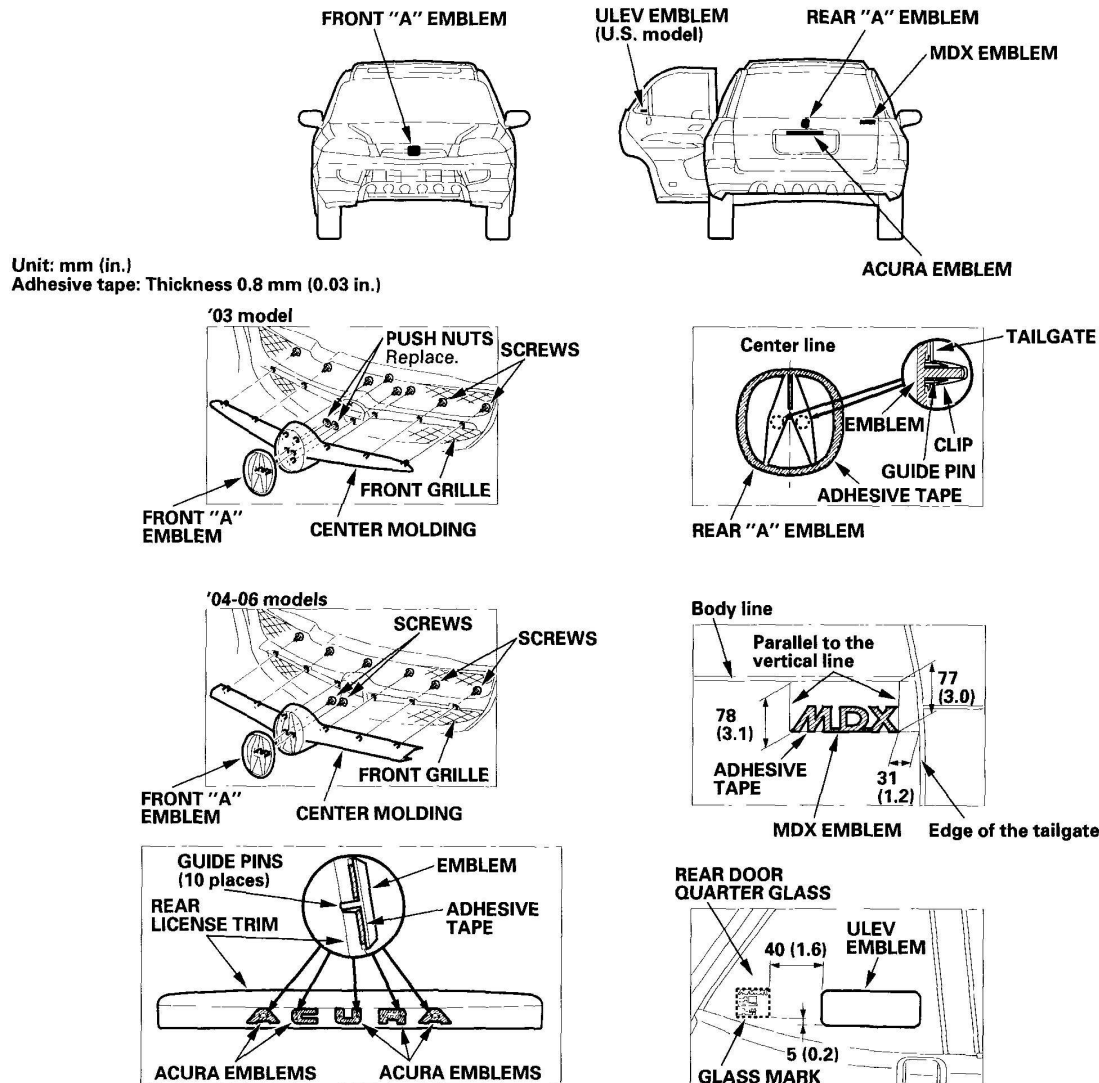

## 2006 Acura MDX

2003-06 ACCESSORIES & EQUIPMENT Exterior Trim - MDX

### **Fig. 8: Replacing Emblem**

Courtesy of AMERICAN HONDA MOTOR CO., INC.