

2003-06 ENGINE

Intake Manifold and Exhaust System - MDX

INTAKE MANIFOLD REMOVAL AND INSTALLATION

EXPLODED VIEW

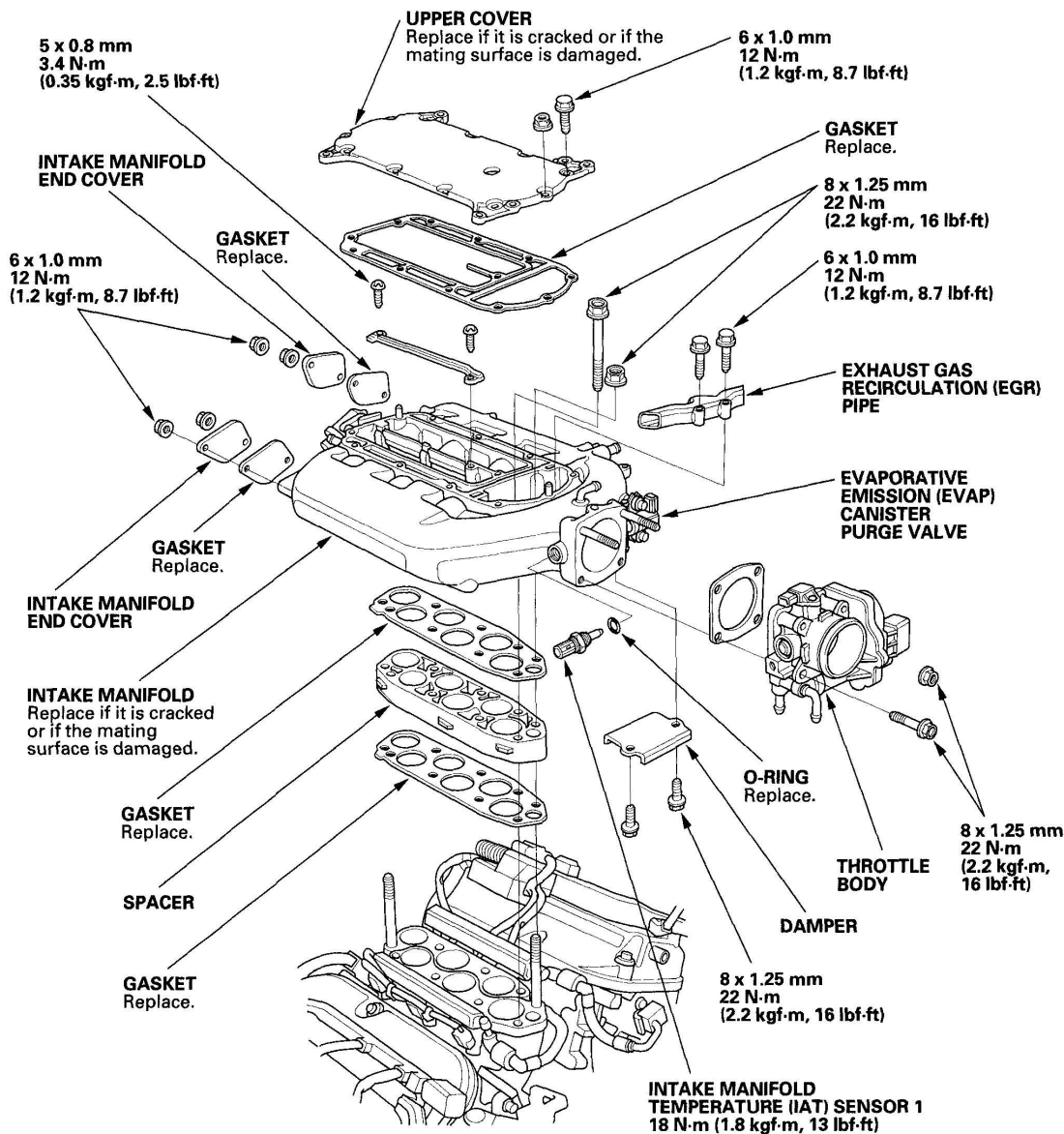

G03639521

Fig. 1: Exploded View Of Intake Manifold
Courtesy of AMERICAN HONDA MOTOR CO., INC.

2006 Acura MDX
2003-06 ENGINE Intake Manifold and Exhaust System - MDX

REMOVAL

1. Remove the intake manifold cover.

2006 Acura MDX

2003-06 ENGINE Intake Manifold and Exhaust System - MDX

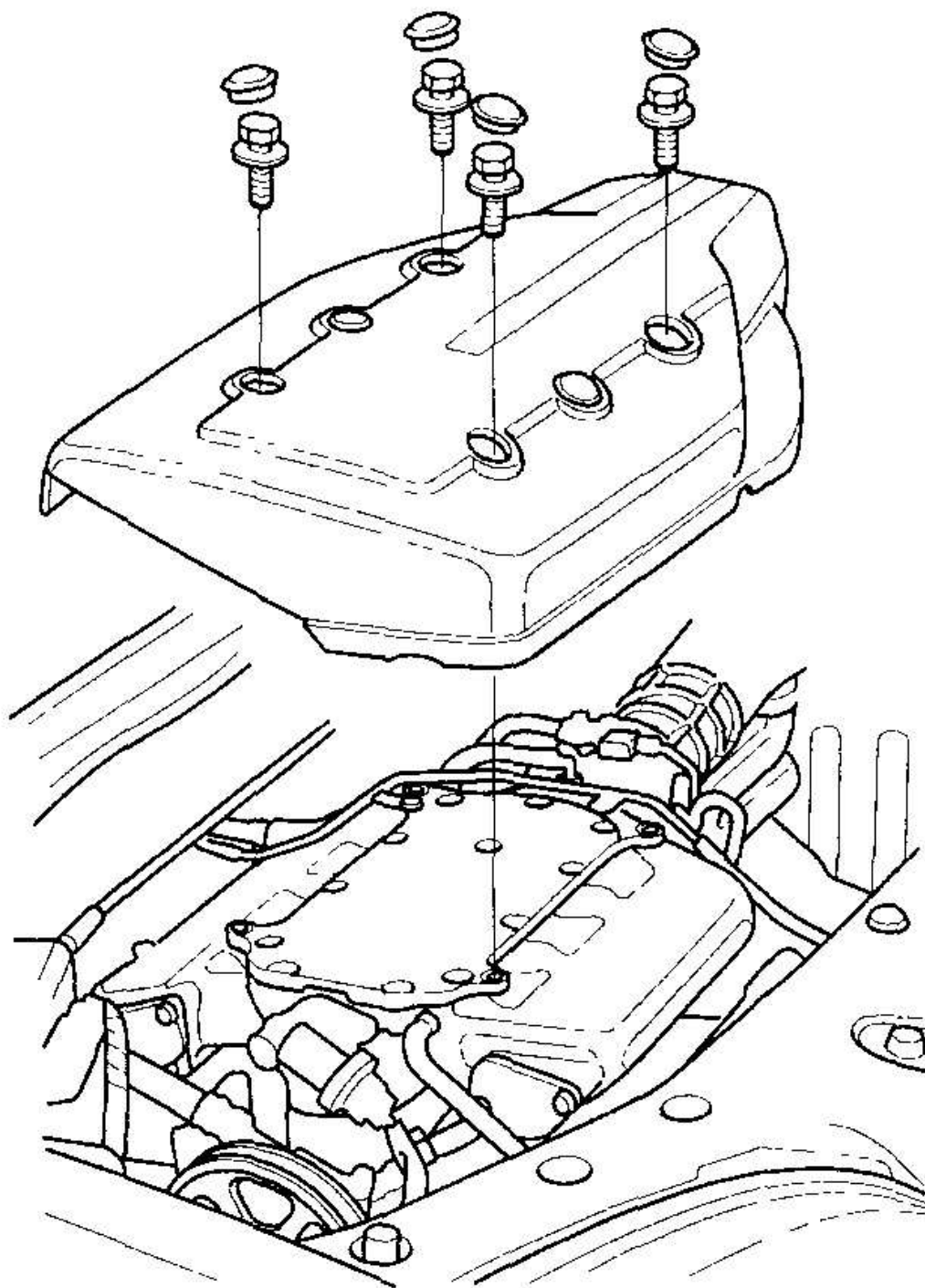

G03639522

Fig. 2: Removing Intake Manifold Cover

Courtesy of AMERICAN HONDA MOTOR CO., INC.

2. Disconnect the intake air temperature (IAT) sensor 2 connector (A), and remove the breather pipe (B), then remove the intake air duct (C).

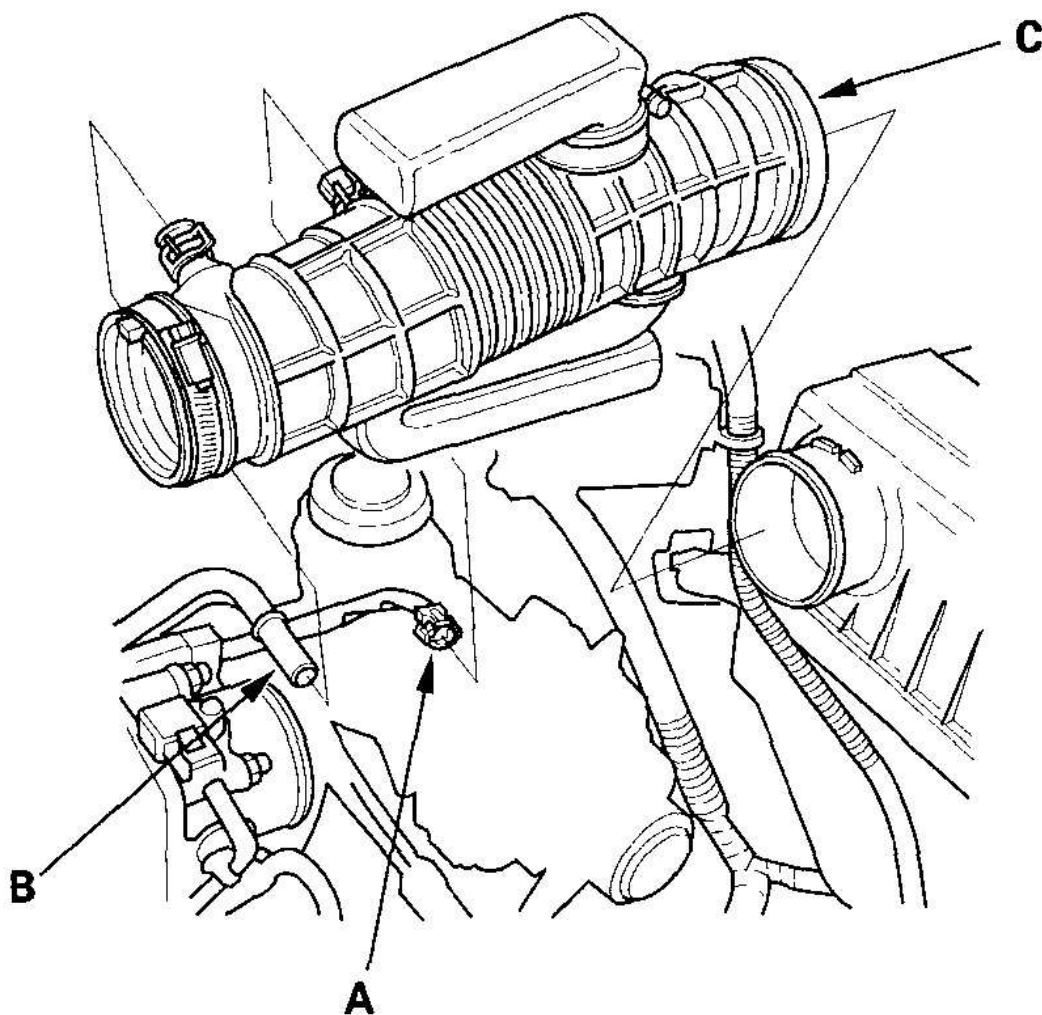

G03639523

Fig. 3: Disconnecting Intake Air Temperature Sensor 2 Connector

Courtesy of AMERICAN HONDA MOTOR CO., INC.

3. Remove the positive crankcase ventilation (PCV) hose (A), brake booster vacuum hose (B), vacuum hose (C) and vacuum line mounting bolts (D).

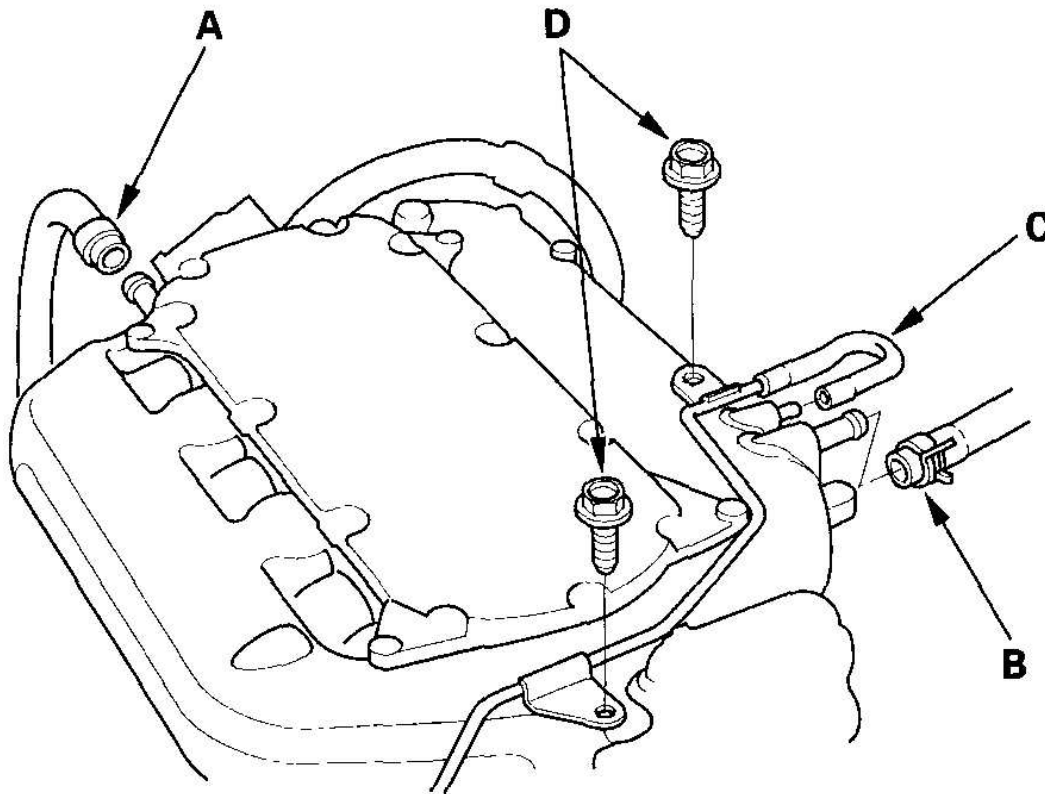

G03639524

Fig. 4: Removing Positive Crankcase Ventilation Hose
Courtesy of AMERICAN HONDA MOTOR CO., INC.

4. Remove the evaporative emission (EVAP) canister hose (A) and the transmission breather hose clamp bracket (B).

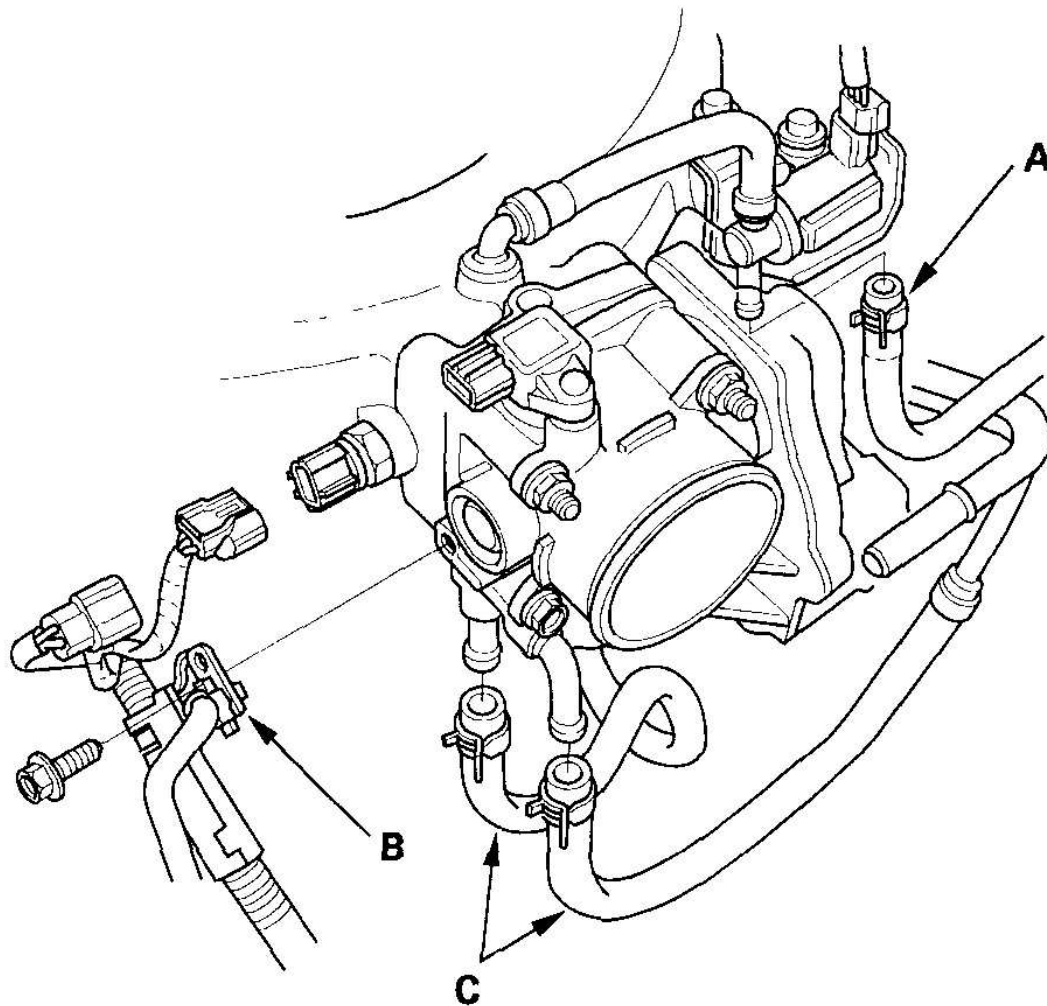

G03639525

Fig. 5: Removing Evaporative Emission Canister Hose
Courtesy of AMERICAN HONDA MOTOR CO., INC.

5. Remove and plug the water bypass hoses (C).
6. Remove the engine wire harness connectors and wire harness clamps from the intake manifold.
 - Intake air temperature (IAT) sensor 1 connector
 - Throttle actuator connector
 - Manifold absolute pressure (MAP) sensor connector
 - Evaporative emission (EVAP) canister purge valve connector
 - Intake manifold tuning (IMT) (intake manifold runner control (IMRC)) actuator connector
7. Remove the upper cover mounting bolts and nuts sequentially in two or three steps, then remove the

upper cover.

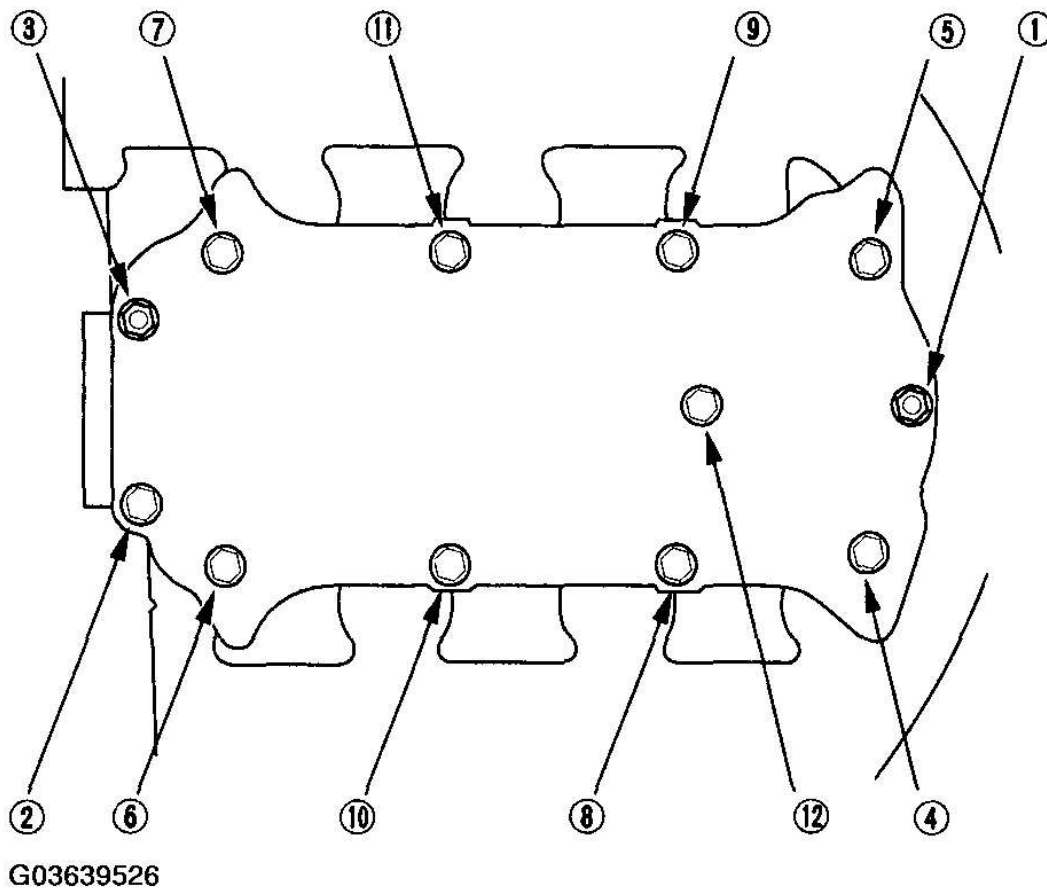

Fig. 6: Removing Upper Cover Mounting Bolts And Nuts In Sequence
 Courtesy of AMERICAN HONDA MOTOR CO., INC.

8. Remove the intake manifold mounting bolts and nuts sequentially in two or three steps, then remove the intake manifold and spacer.

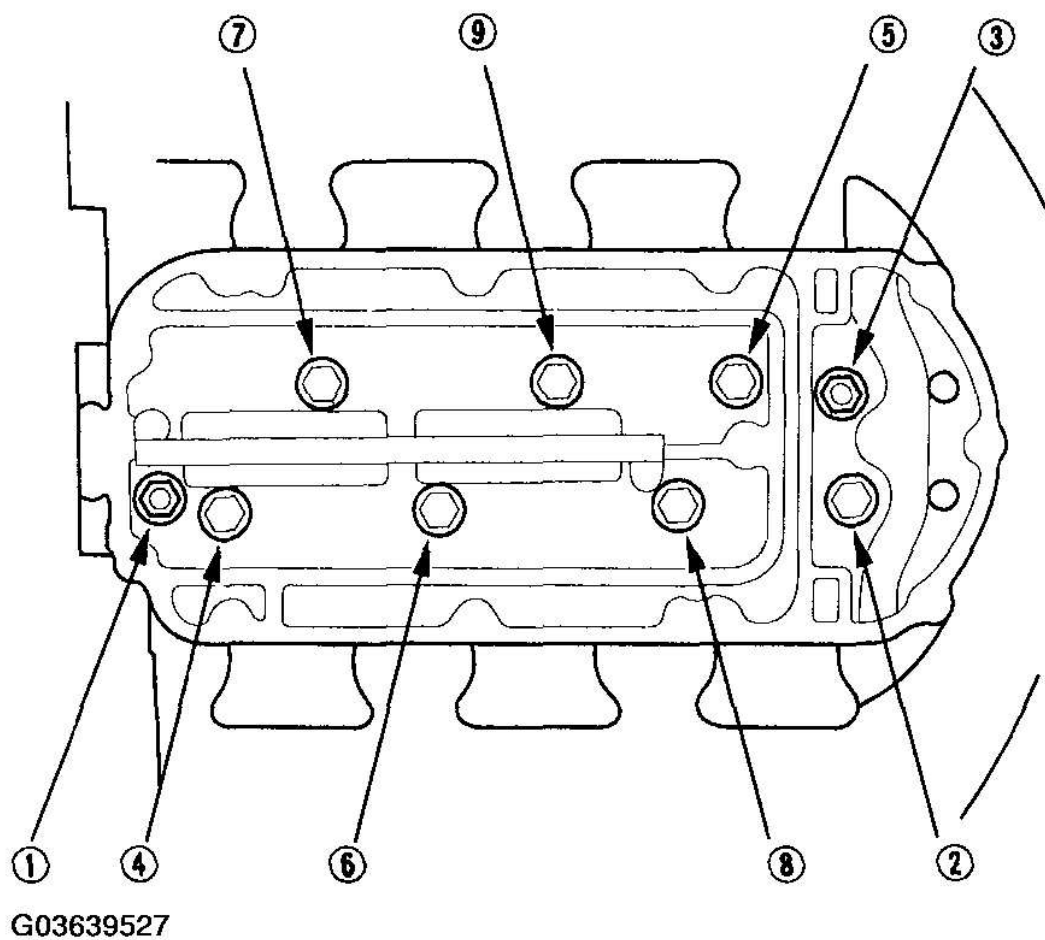

Fig. 7: Removing Intake Manifold Mounting Bolts And Nuts In Sequence
Courtesy of AMERICAN HONDA MOTOR CO., INC.

INSTALLATION

1. Install the gasket and spacer on the injector base.
2. Install the intake manifold. Tighten the bolts and nuts sequentially in two or three steps. Always use a new intake manifold gasket.

Specified Torque

8 x 1.25 mm: 22 N.m (2.2 kgf.m, 16 lbf.ft)

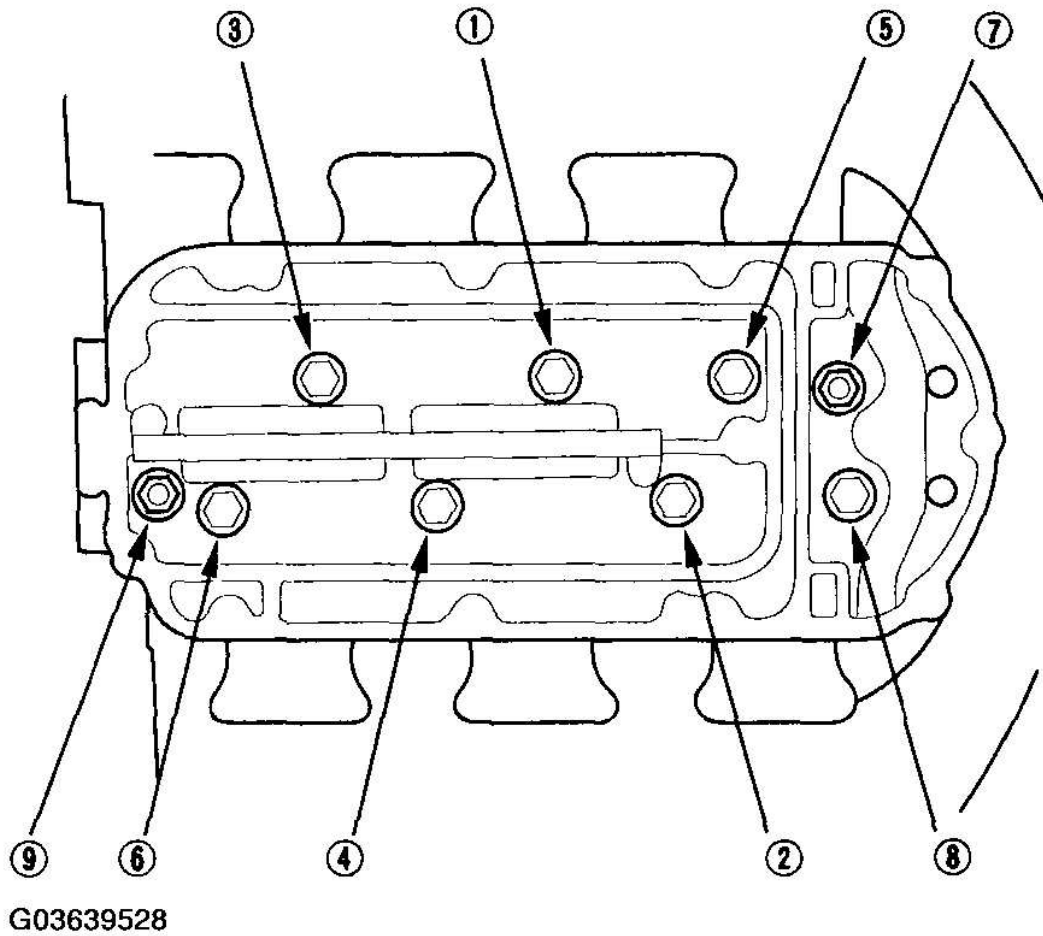

Fig. 8: Installing Intake Manifold Bolts And Nuts In Sequence
Courtesy of AMERICAN HONDA MOTOR CO., INC.

3. Install the upper cover. Tighten the bolts and nuts sequentially in two or three steps. Always use a new gasket.

Specified Torque

6x 1.0 mm: 12 N.m (1.2 kgf.m, 8.7 lbf.ft)

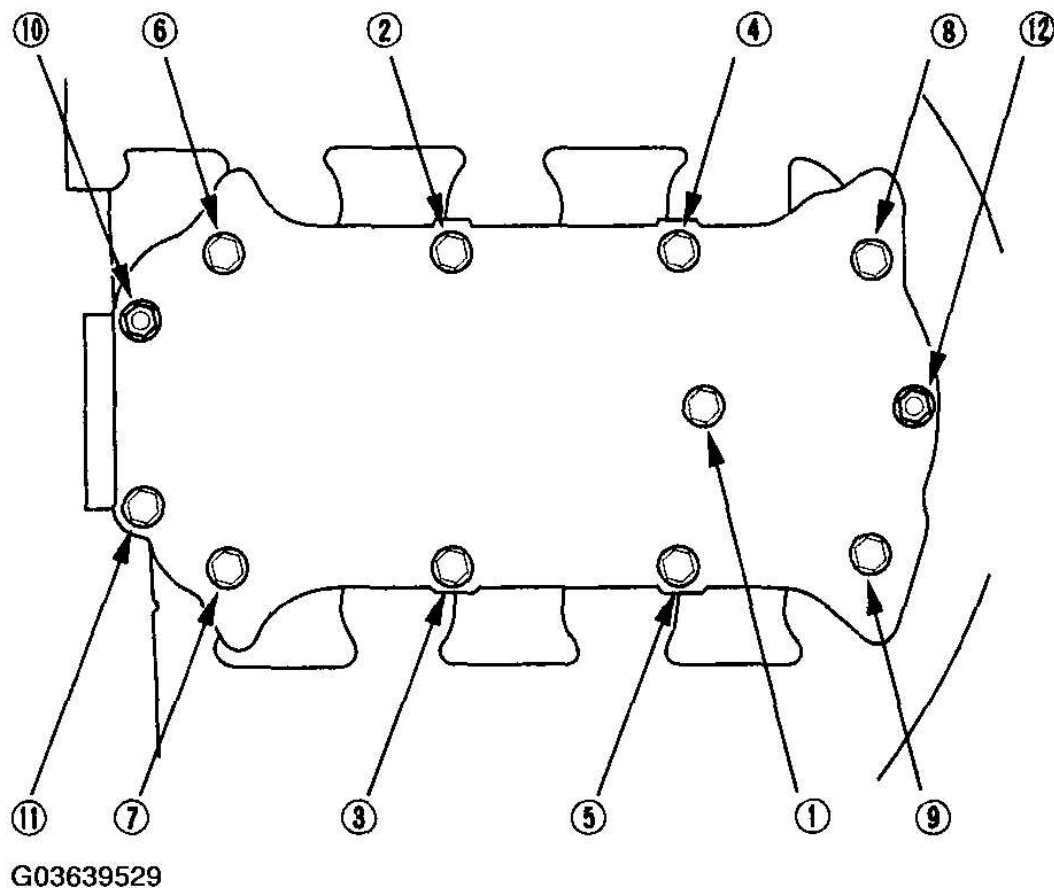
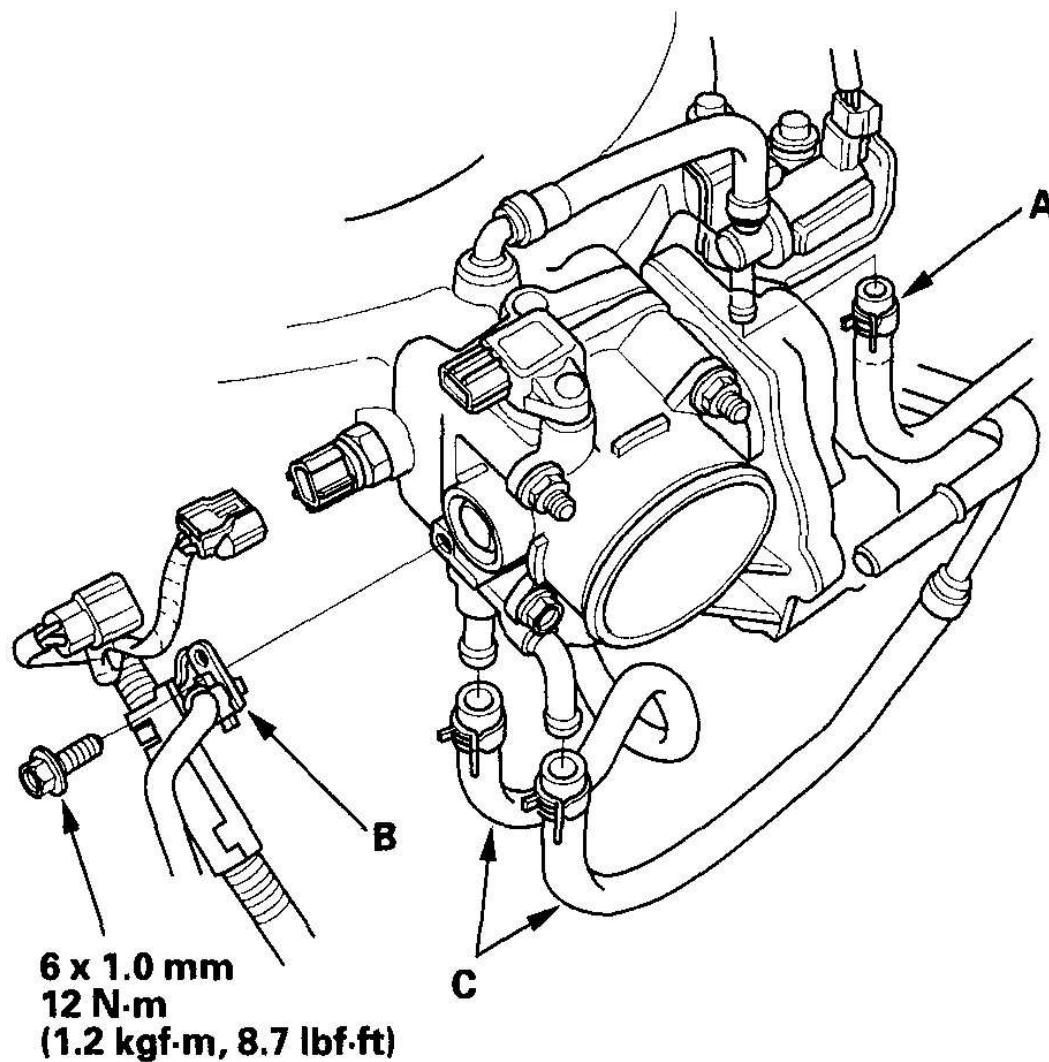

Fig. 9: Installing Upper Cover Bolts And Nuts In Sequence
 Courtesy of AMERICAN HONDA MOTOR CO., INC.

4. Install the engine wire harness connectors and wire harness clamps from the intake manifold.
 - Intake air temperature (IAT) sensor 1 connector
 - Throttle actuator connector
 - Manifold absolute pressure (MAP) sensor connector
 - Evaporative emission (EVAP) canister purge valve connector
 - Intake manifold tuning (IMT) (intake manifold runner control (IMRC)) actuator connector
5. Install the evaporative emission (EVAP) canister hose (A), transmission breather hose clamp bracket (B), and water bypass hoses (C).



G03639530

Fig. 10: Installing Evaporative Emission Canister Hose
Courtesy of AMERICAN HONDA MOTOR CO., INC.

6. Install the positive crankcase ventilation (PCV) hose (A), brake booster vacuum hose (B), vacuum hose (C), and vacuum line mounting bolts (D).

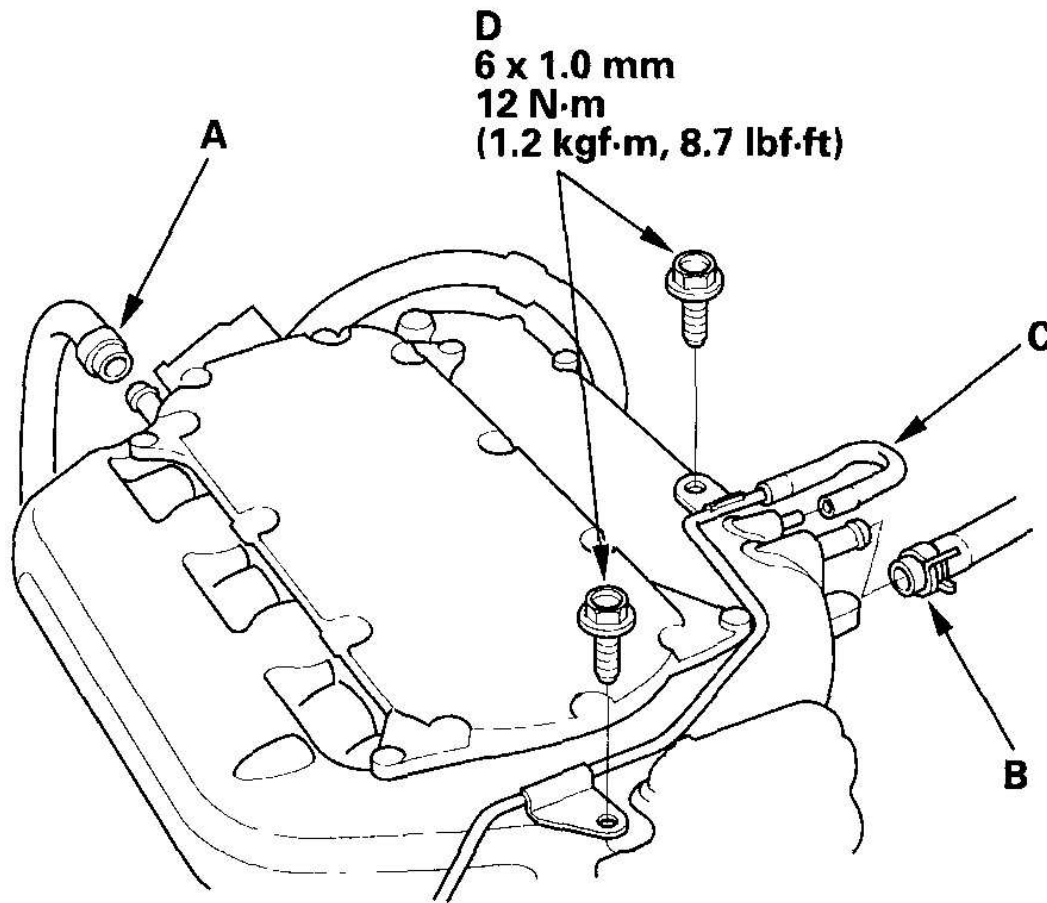

G03639531

Fig. 11: Installing Positive Crankcase Ventilation Hose
Courtesy of AMERICAN HONDA MOTOR CO., INC.

7. Install the intake air duct (A), then install the breather pipe (B).

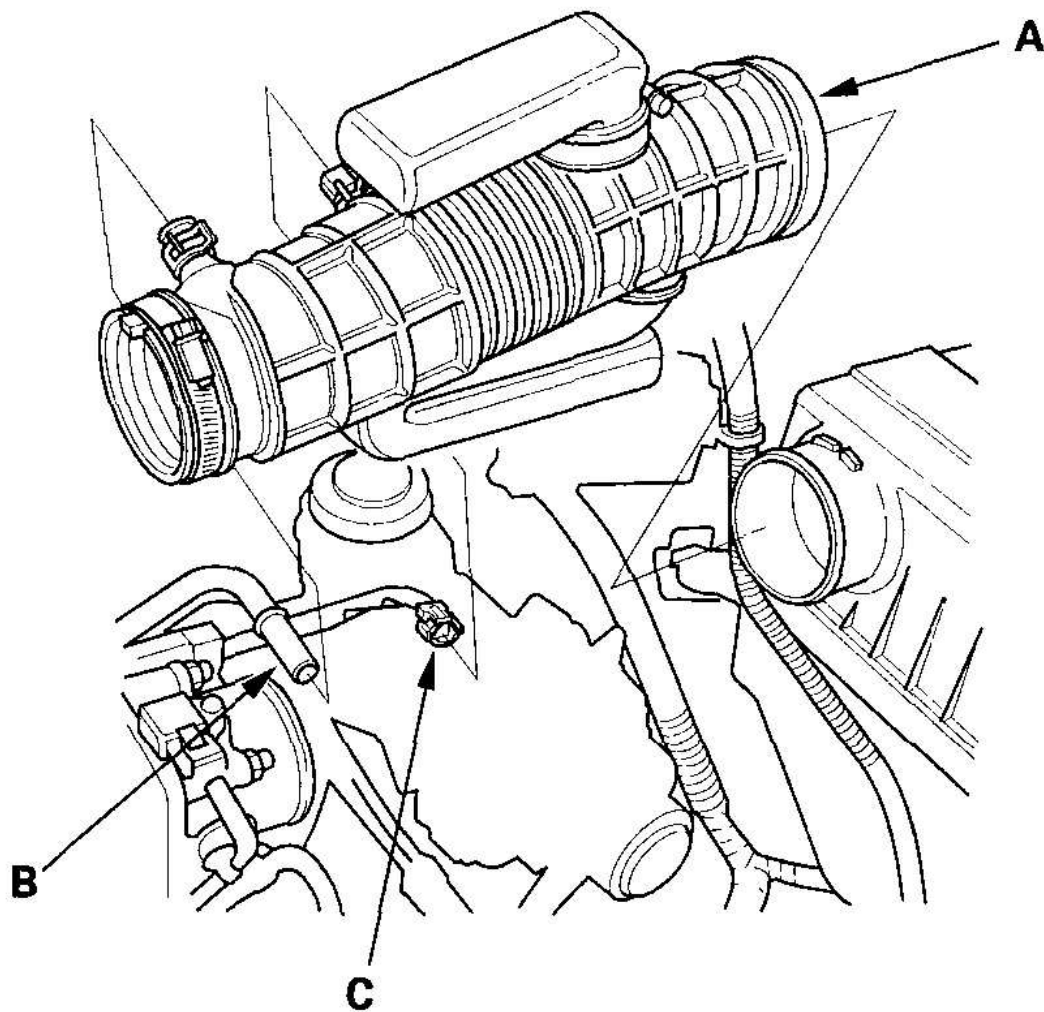

G03639532

Fig. 12: Installing Intake Air Duct And Breather Pipe
Courtesy of AMERICAN HONDA MOTOR CO., INC.

8. Connect the IAT sensor 2 connector (C).
9. Install the intake manifold cover.

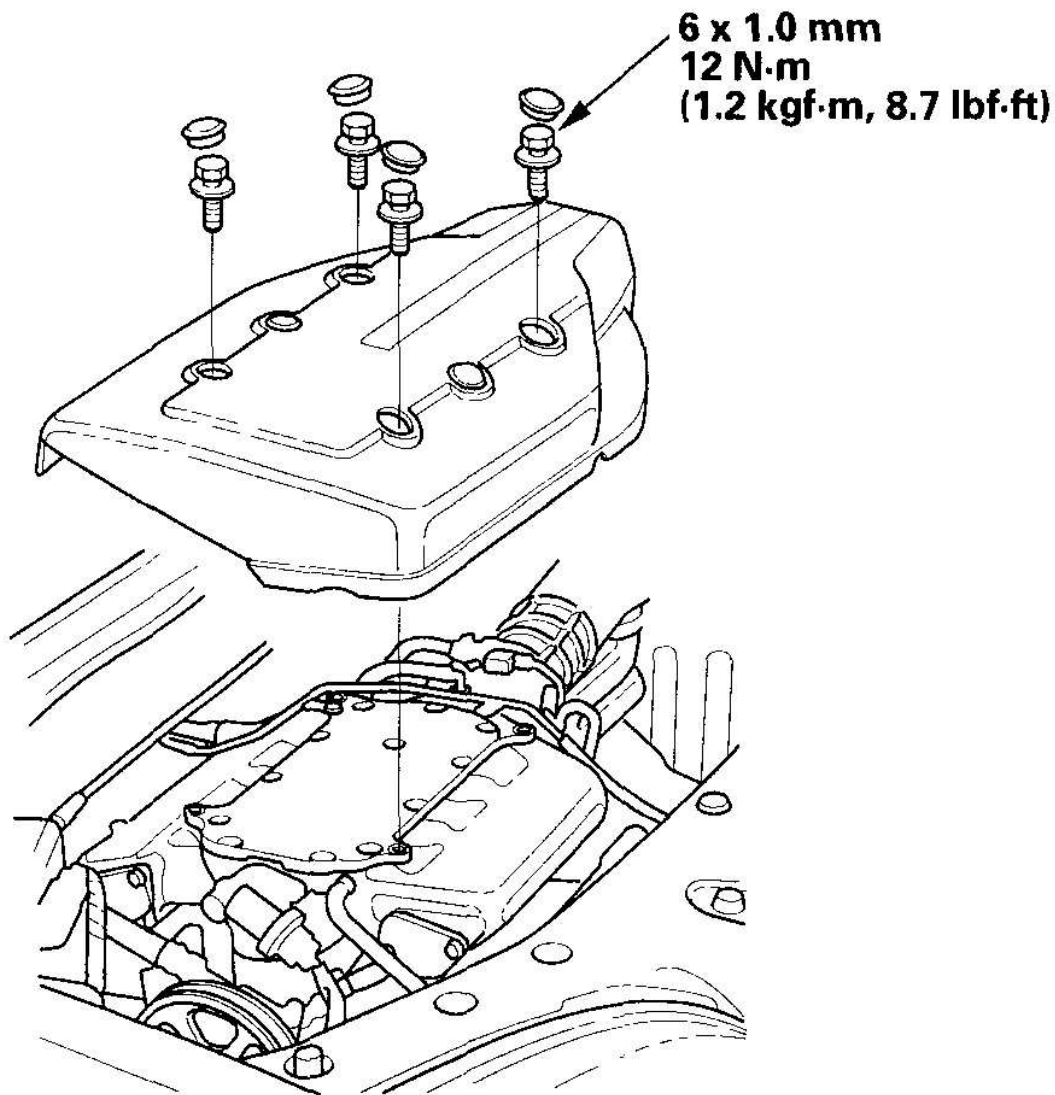

G03639533

Fig. 13: Installing Intake Manifold Cover

Courtesy of AMERICAN HONDA MOTOR CO., INC.

10. Clean up any spilled engine coolant.
11. After installation, check that all tubes, hoses, and connectors are installed correctly.
12. Refill the radiator with engine coolant, and bleed air from the cooling system with heater valve open (see step 8 in **COOLANT REPLACEMENT**).

EXHAUST PIPE AND MUFFLER REPLACEMENT

2006 Acura MDX

2003-06 ENGINE Intake Manifold and Exhaust System - MDX

NOTE: Use new gaskets and self-locking nuts when reassembling.

2003 MODEL

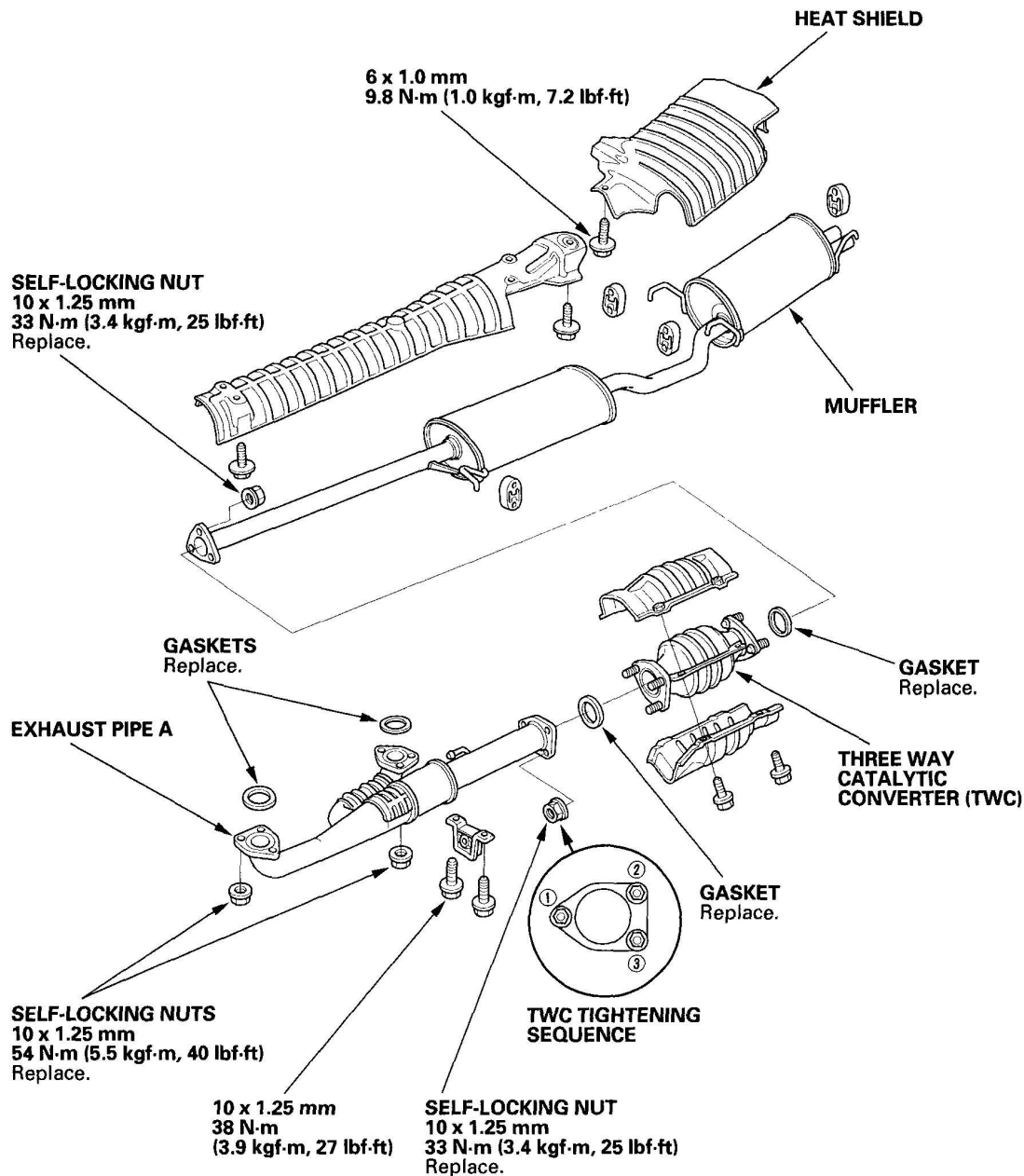

G03639534

Fig. 14: Exploded View Of Exhaust Pipe And Muffler (2003 Model)
Courtesy of AMERICAN HONDA MOTOR CO., INC.

NOTE: Use new gaskets and self-locking nuts when reassembling.

2006 Acura MDX

2003-06 ENGINE Intake Manifold and Exhaust System - MDX

2004-2006 MODELS

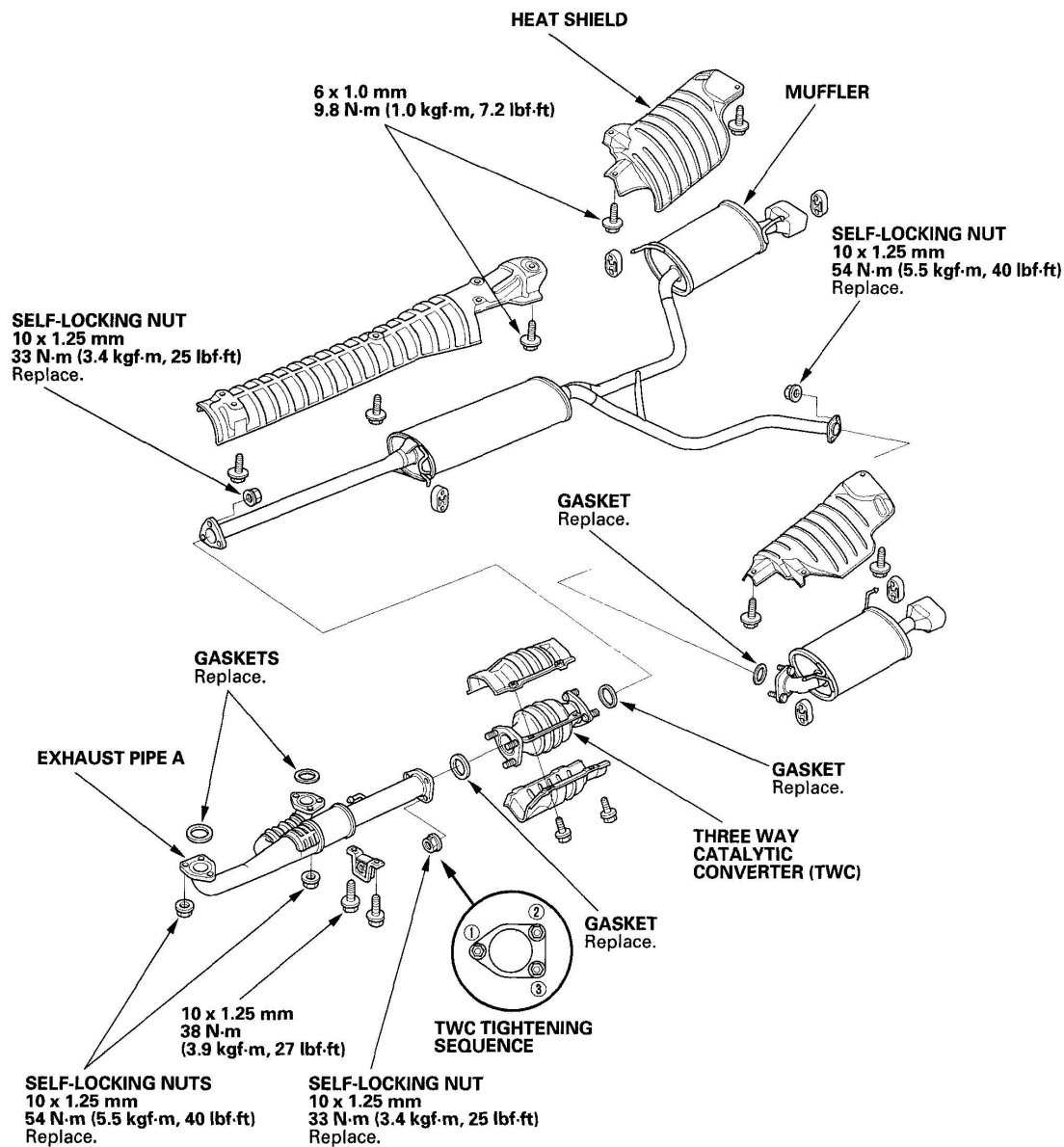

Fig. 15: Exploded View Of Exhaust Pipe And Muffler (2004-2006 Models)
Courtesy of AMERICAN HONDA MOTOR CO., INC.