

## 2006 Acura MDX

2003-06 ACCESSORIES & EQUIPMENT Interior Lights - MDX

### 2003-06 ACCESSORIES & EQUIPMENT

#### Interior Lights - MDX

### COMPONENT LOCATION INDEX

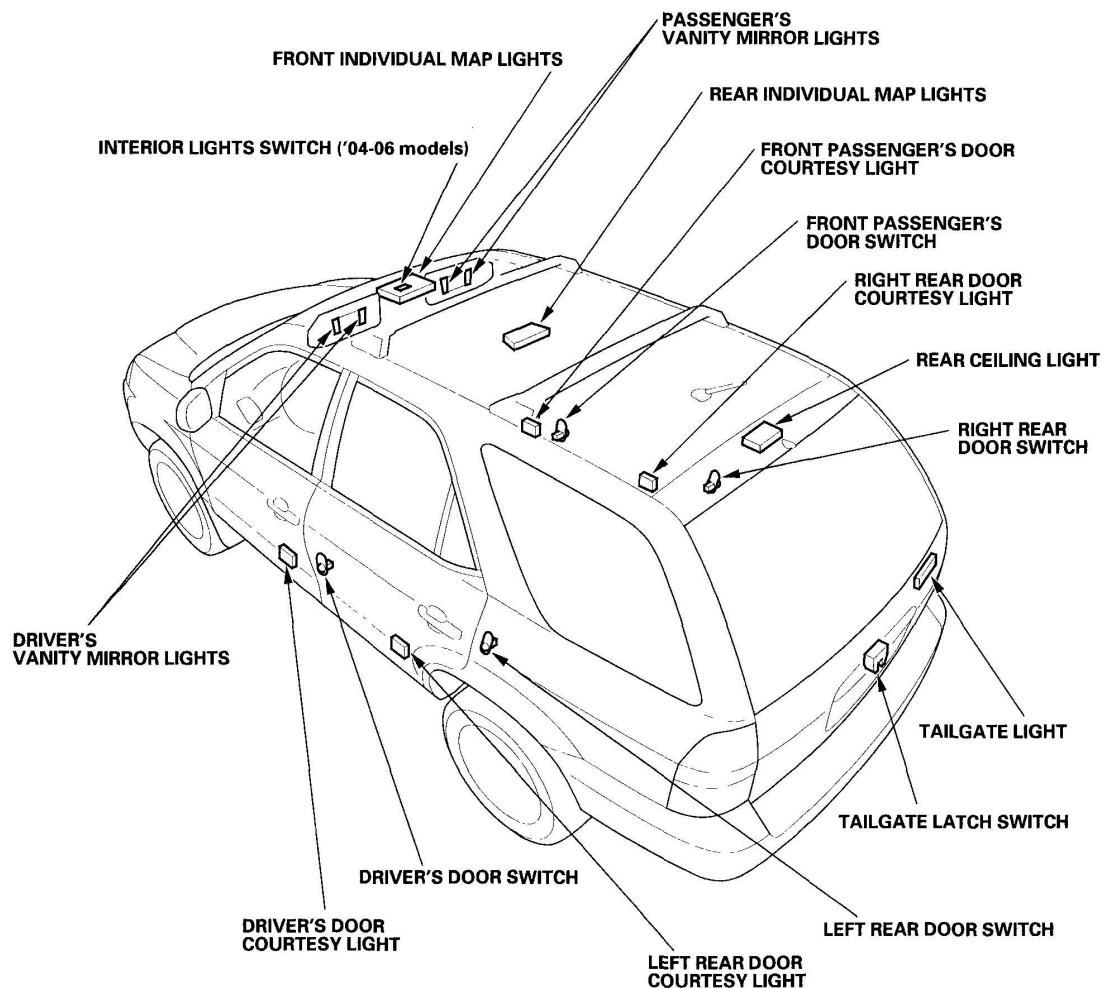

G03642160

**Fig. 1: Identifying Interior Lights Components Location (1 Of 2)**  
Courtesy of AMERICAN HONDA MOTOR CO., INC.

## 2006 Acura MDX

### 2003-06 ACCESSORIES & EQUIPMENT Interior Lights - MDX

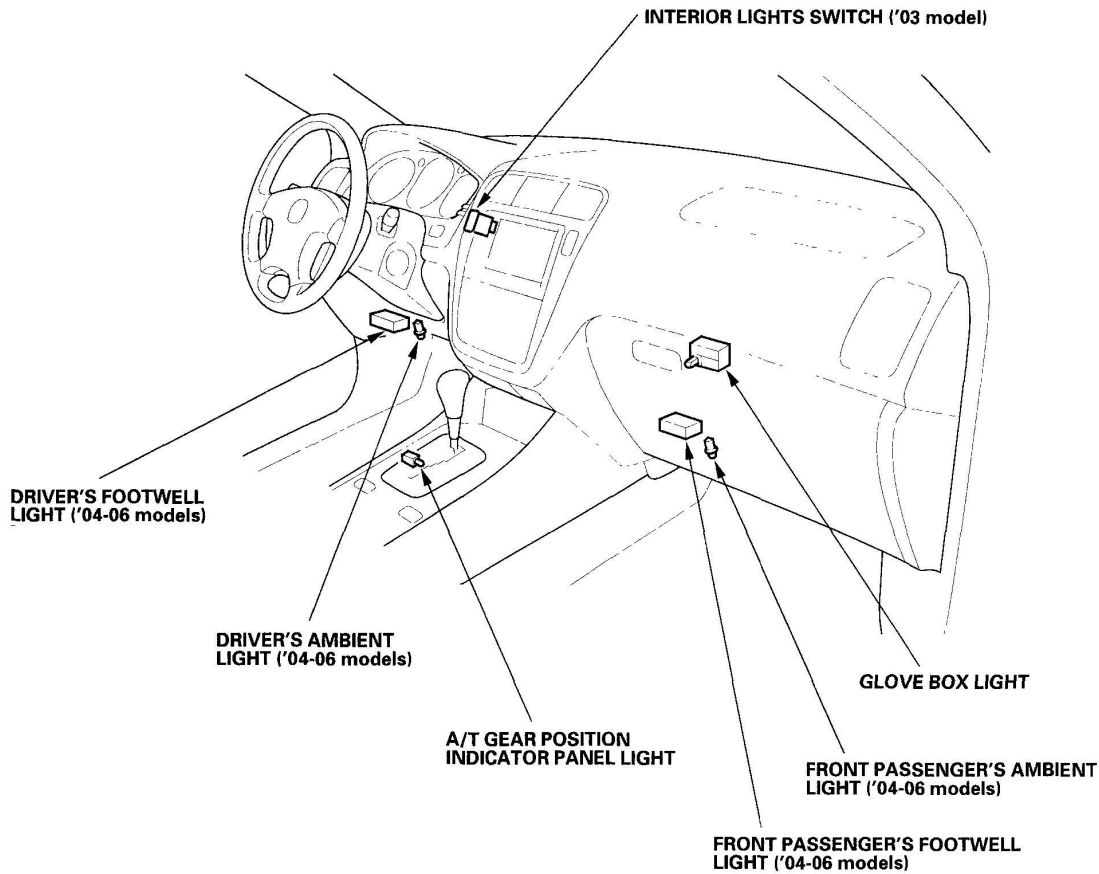

G03642161

**Fig. 2: Identifying Interior Lights Components Location (2 Of 2)**  
Courtesy of AMERICAN HONDA MOTOR CO., INC.

## CIRCUIT DIAGRAM

'04-'06 MODELS

## 2003-06 ACCESSORIES &amp; EQUIPMENT Interior Lights - MDX

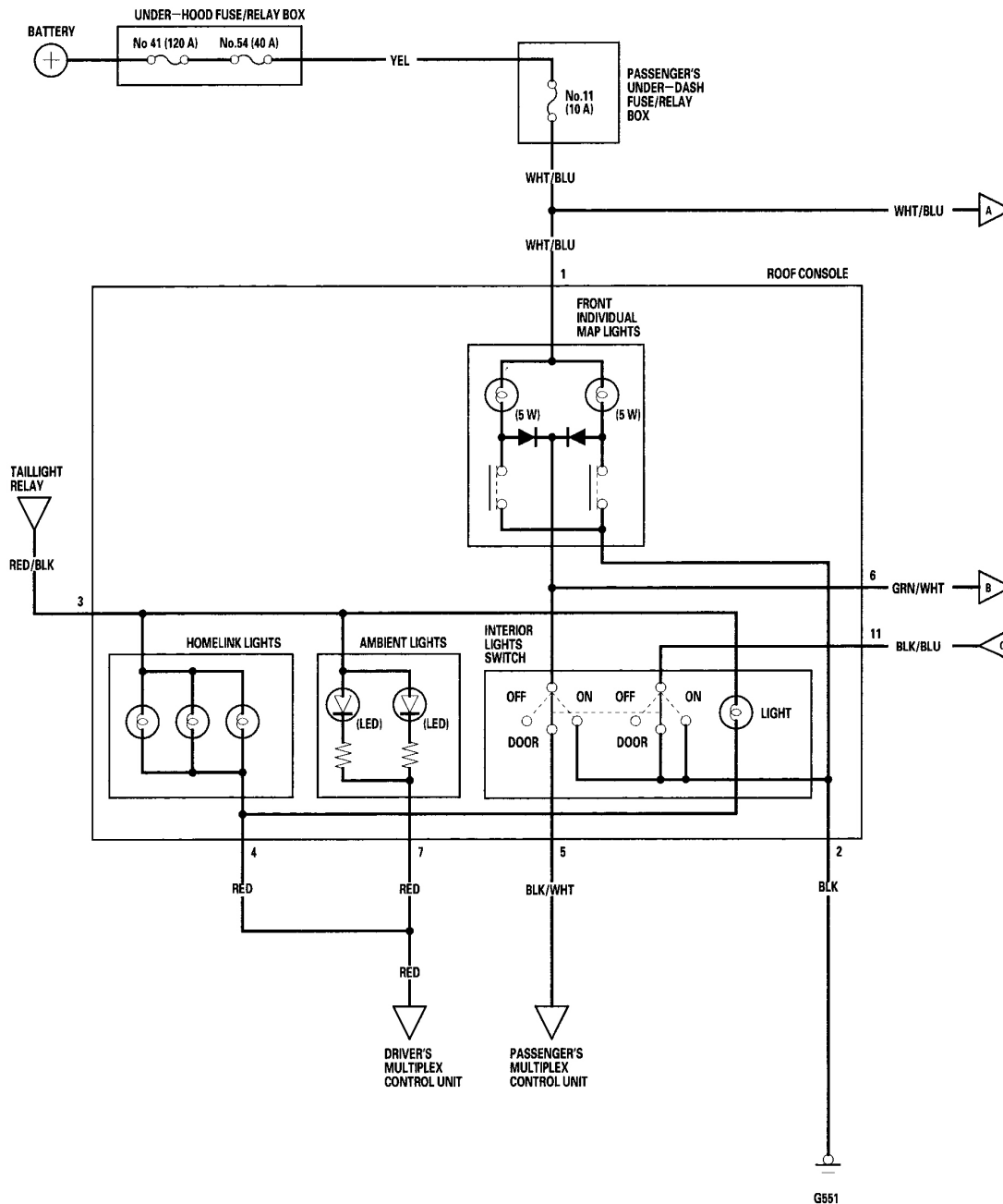

G03642162

**Fig. 3: Interior Lights Circuit Diagram ('04-06 Models - 1 Of 3)**  
**Courtesy of AMERICAN HONDA MOTOR CO., INC.**

# 2006 Acura MDX

## 2003-06 ACCESSORIES & EQUIPMENT Interior Lights - MDX

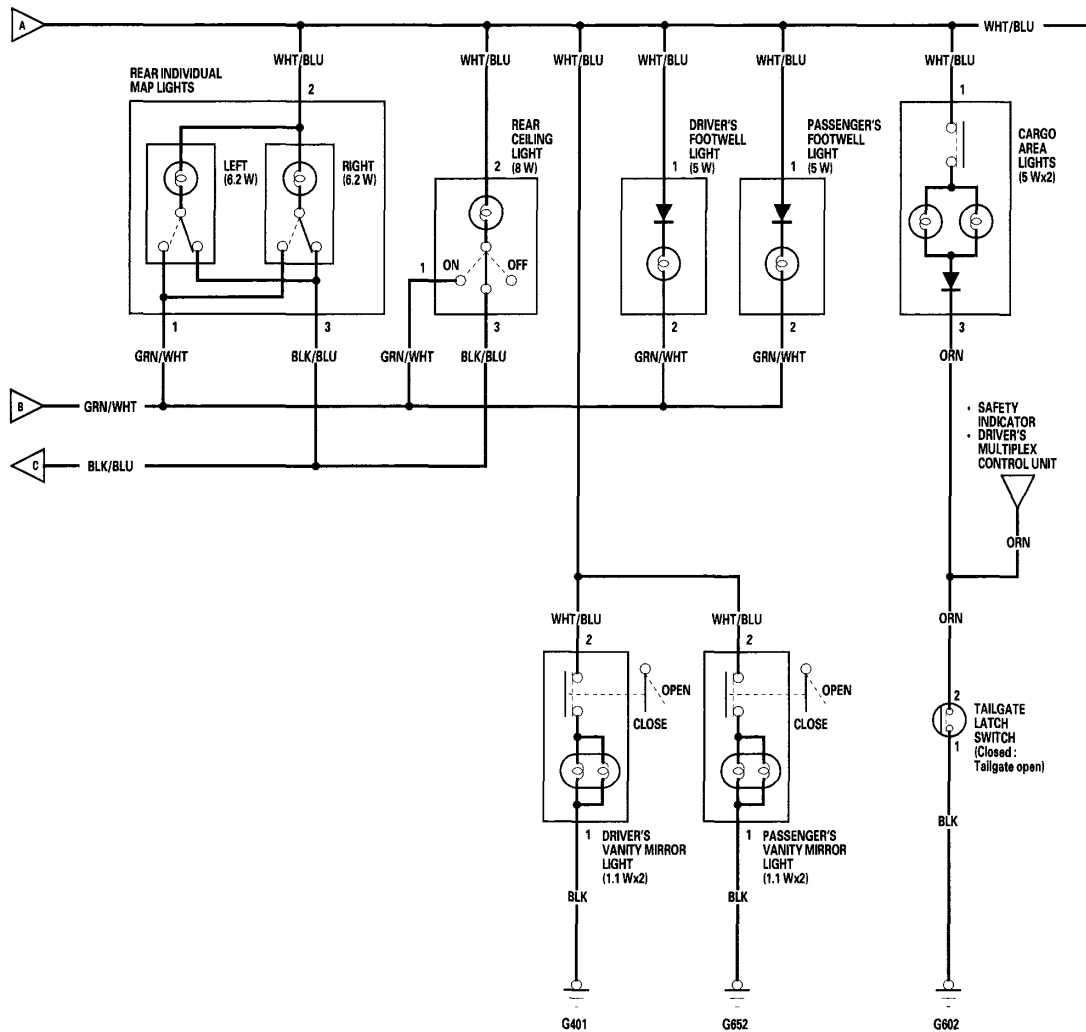

G03642163

**Fig. 4: Interior Lights Circuit Diagram ('04-06 Models - 2 Of 3)**  
 Courtesy of AMERICAN HONDA MOTOR CO., INC.

# 2006 Acura MDX

## 2003-06 ACCESSORIES & EQUIPMENT Interior Lights - MDX

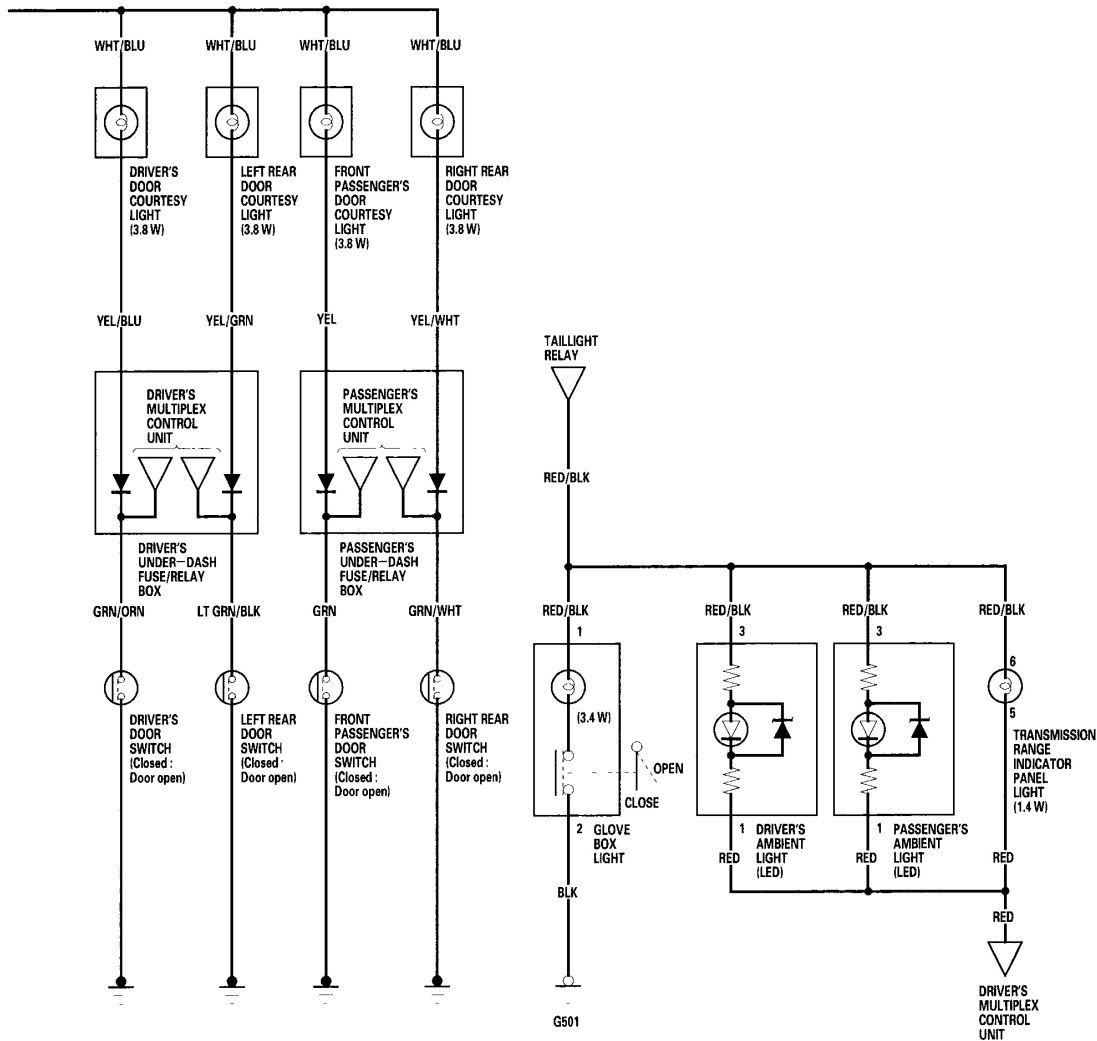

G03642164

**Fig. 5: Interior Lights Circuit Diagram ('04-06 Models - 3 Of 3)**  
Courtesy of AMERICAN HONDA MOTOR CO., INC.

'03 MODEL

# 2006 Acura MDX

## 2003-06 ACCESSORIES & EQUIPMENT Interior Lights - MDX

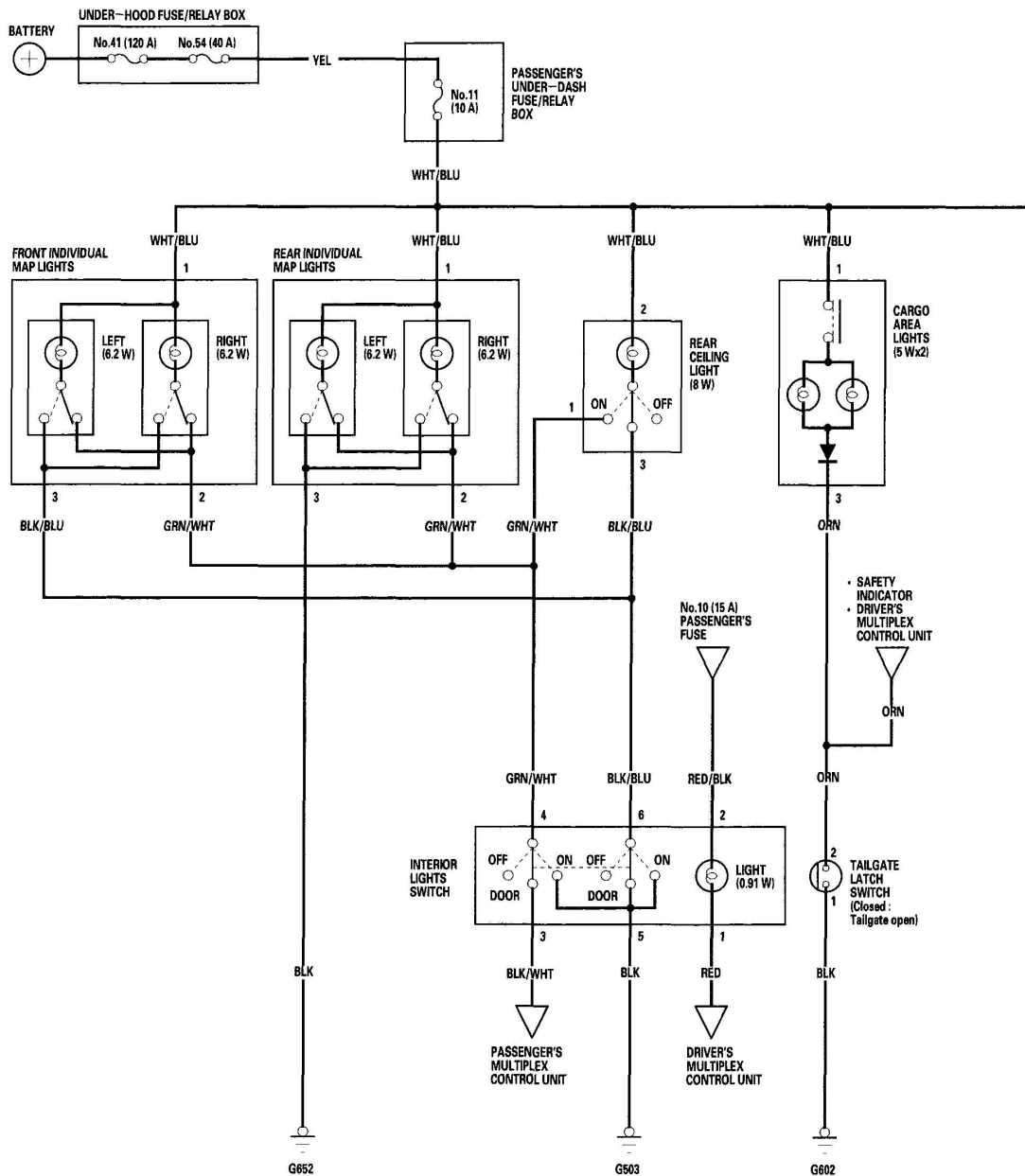

G03642165

**Fig. 6: Interior Lights Circuit Diagram ('03 Model - 1 Of 2)**  
Courtesy of AMERICAN HONDA MOTOR CO., INC.

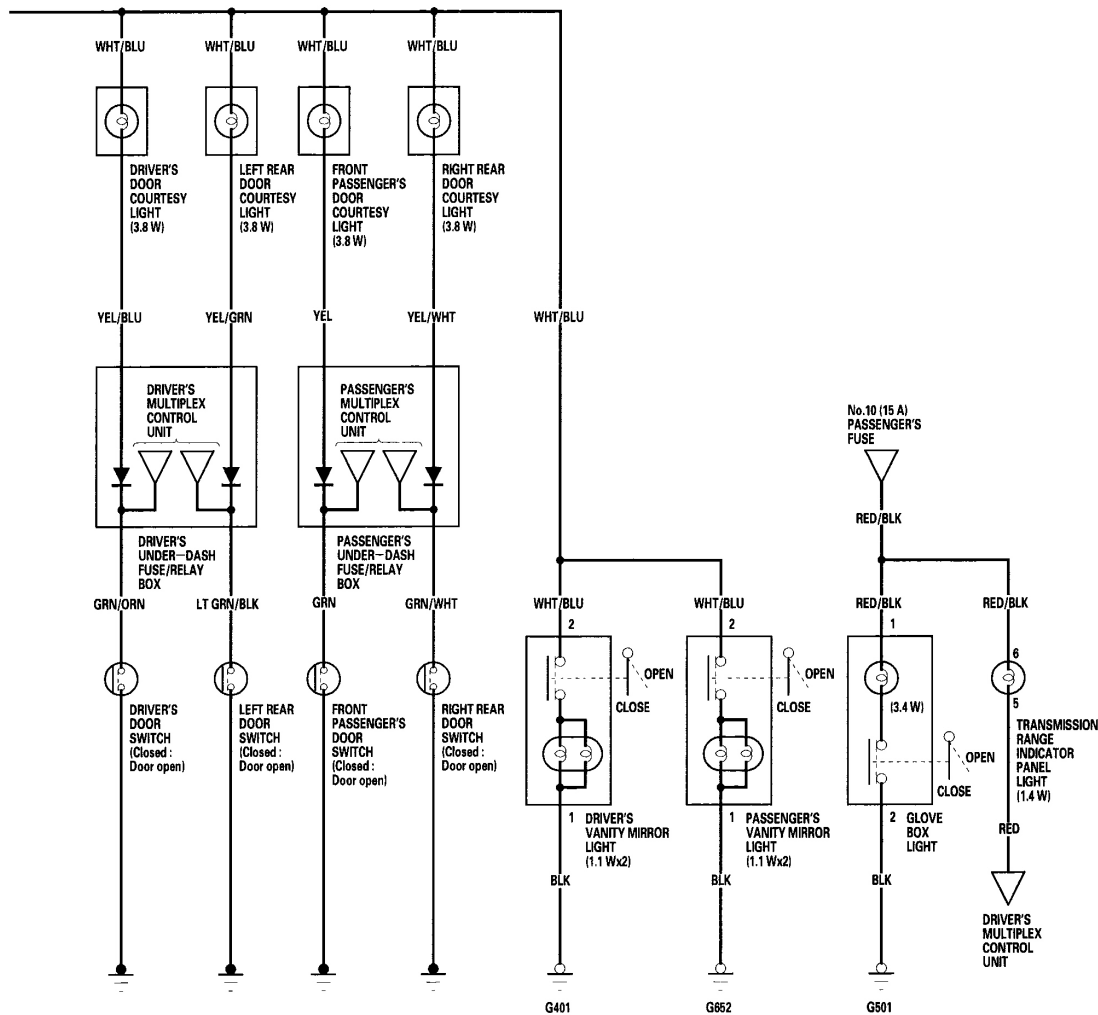

**Fig. 7: Interior Lights Circuit Diagram ('03 Model - 2 Of 2)**  
Courtesy of AMERICAN HONDA MOTOR CO., INC.

## FRONT INDIVIDUAL MAP LIGHT TEST

### Special Tools required

KTC trim tool set SOJATP2014

#### NOTE:

- Use the appropriate tool from the KTC trim tool set to avoid damage when prying components.
- Take care not to scratch the roof console and related parts.
- The microphone for voice control (with navigation or HandsFreeLink) is built into roof console.

<b>2006 Acura MDX</b>
2003-06 ACCESSORIES & EQUIPMENT Interior Lights - MDX

## **'04-'06 MODELS**

1. Turn the light switch OFF.
2. Remove the moonroof switch (see '04-'06 MODELS ).
3. Carefully pry off the lens (A).

**Front Map Light: 5 W x 2**



## 2006 Acura MDX

2003-06 ACCESSORIES & EQUIPMENT Interior Lights - MDX

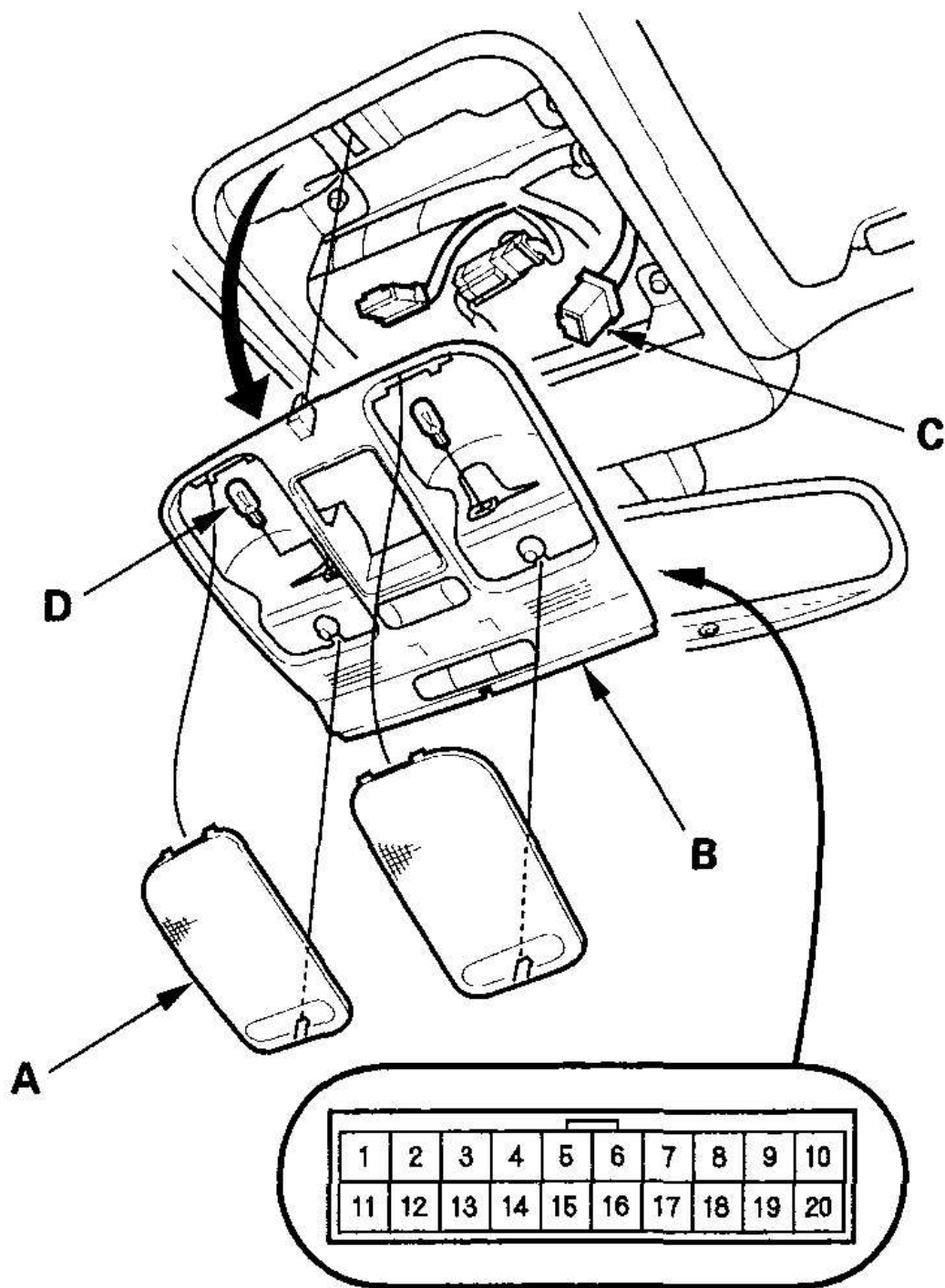

G03642167

**Fig. 8: Prying Off Lens****Courtesy of AMERICAN HONDA MOTOR CO., INC.**

4. Carefully remove the roof console (B).
5. Disconnect the 20P connector (C) from the roof console.
6. Turn the interior lights switch in middle (DOOR) position.
7. Check for continuity between the terminals.
  - There should be continuity between the No. 1 and No. 5 terminals, No. 2 and No. 11 terminals, and No. 5 and No. 6 terminals.
  - With the front individual map light switch ON, there should be continuity between the No. 1 and No. 2 terminals.
8. If the continuity is not as specified, check the bulb(s) (D). If the bulb is OK, replace the roof console.

**'03 MODEL**

1. Turn the light switch OFF.
2. Carefully pry off the lens (A) with a small screwdriver.

**MAP LIGHT: 6.2 w x 2**

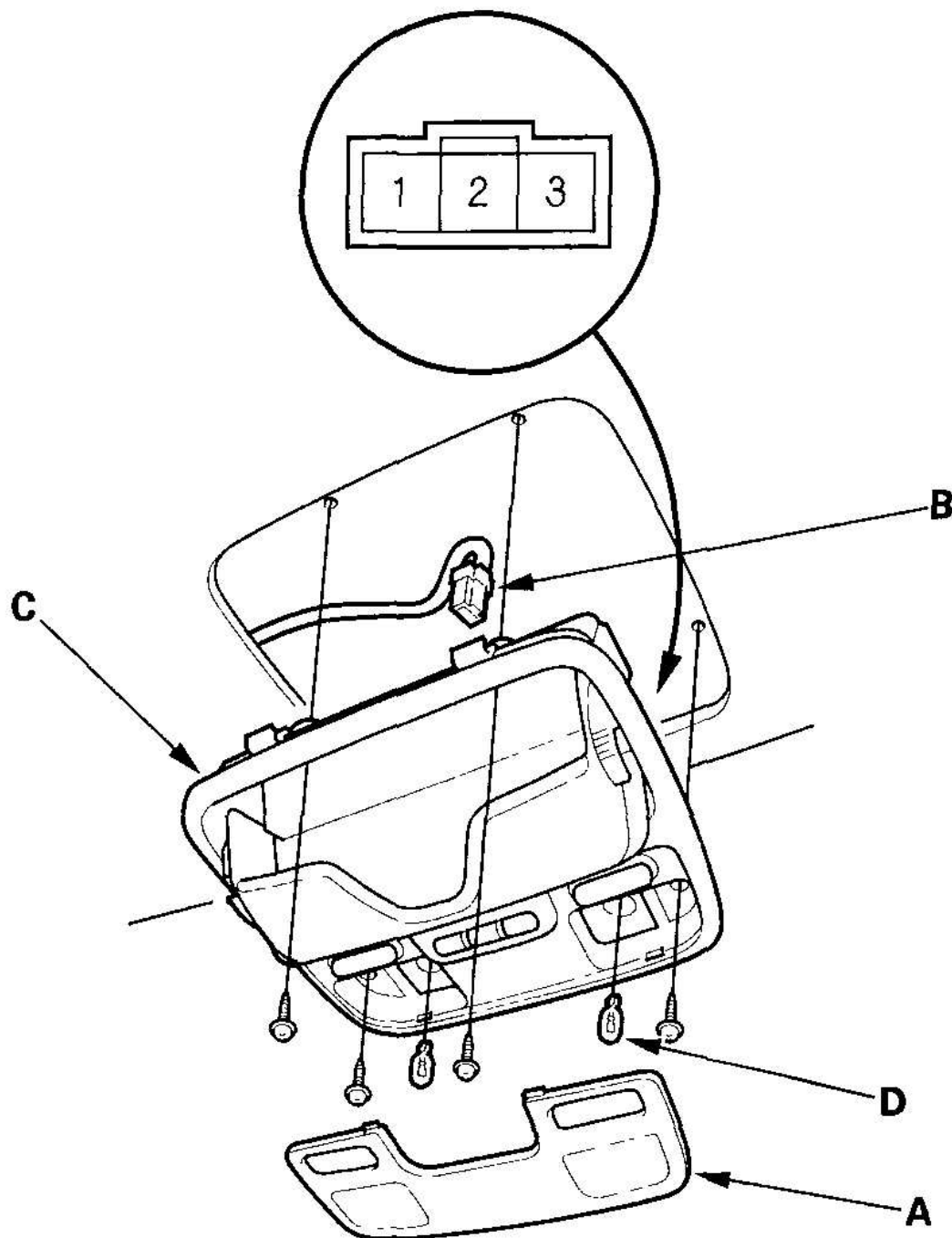

G03642168

**Fig. 9: Prying Off Lens With Screwdriver**  
Courtesy of AMERICAN HONDA MOTOR CO., INC.

## 2006 Acura MDX

### 2003-06 ACCESSORIES & EQUIPMENT Interior Lights - MDX

3. Remove the four mounting screws.
4. Disconnect the 3P connector (B) from the housing (C).
5. Check for continuity between the terminals.
  - There should be continuity between the No. 1 and No. 3 terminals with the left switch ON.
  - There should be continuity between the No. 1 and No. 2 terminals with the right switch ON.
6. If the continuity is not as specified, check the bulb(s) (D). If the bulbs are OK, replace the light.

## REAR INDIVIDUAL MAP LIGHT TEST

1. Turn the light switch OFF.
2. Carefully pry off the lens (A) with a small screwdriver.

**MAP LIGHT: 6.2 x 2**

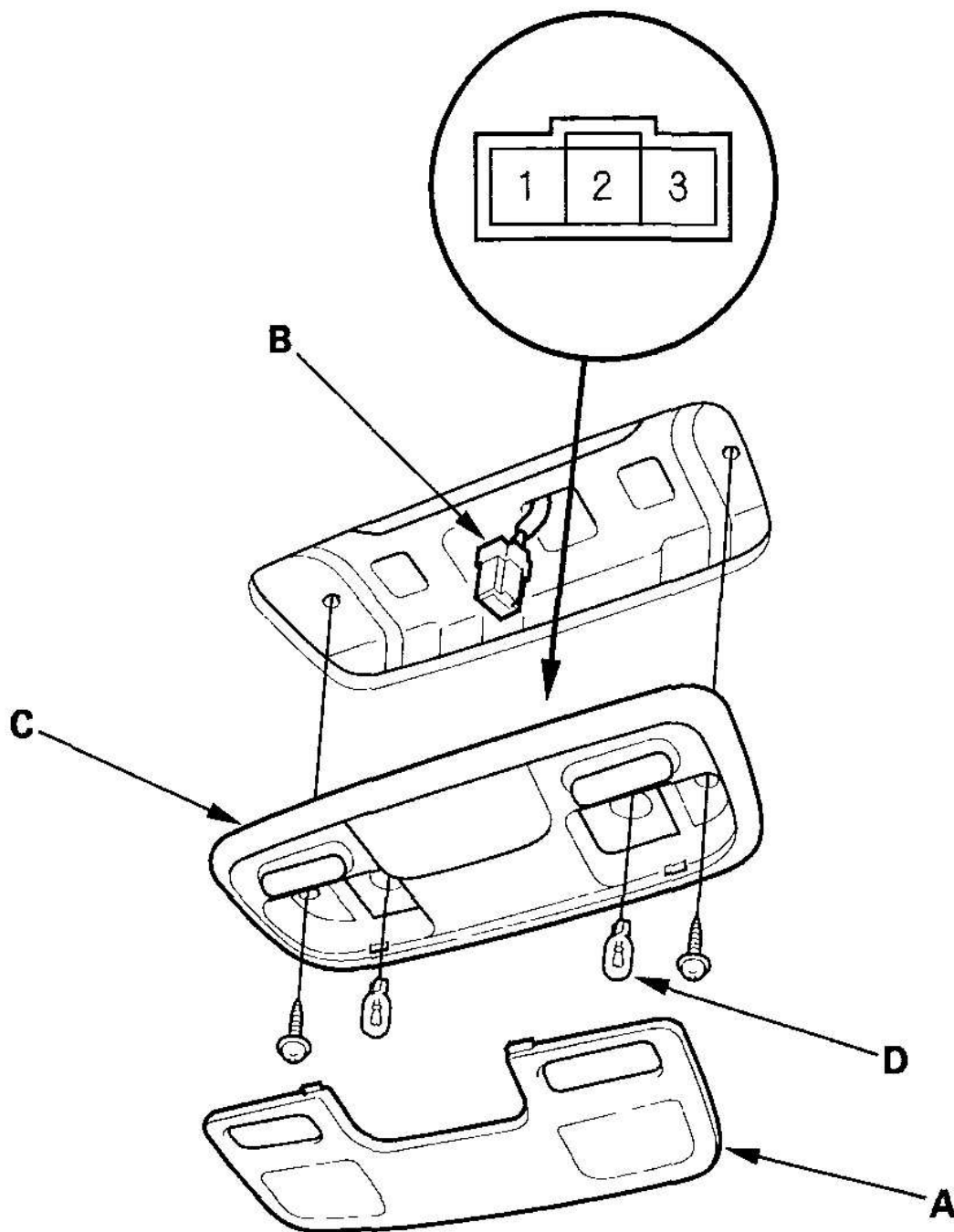

G03642169

**Fig. 10: Prying Off Lens With Screwdriver**  
Courtesy of AMERICAN HONDA MOTOR CO., INC.

## 2006 Acura MDX

### 2003-06 ACCESSORIES & EQUIPMENT Interior Lights - MDX

3. Remove the two mounting screws.
4. Disconnect the 3P connector (B) from the housing (C).
5. Check for continuity between the terminals.
  - There should be continuity between the No. 1 and No. 3 terminals with the left switch ON.
  - There should be continuity between the No. 1 and No. 2 terminals with the right switch ON.
6. If the continuity is not as specified, check the bulb(s) (D). If the bulbs are OK, replace the light.

## REAR CEILING LIGHT TEST/REPLACEMENT

1. Turn the light switch OFF.
2. Carefully pry off the lens (A) with a small screwdriver.

**CEILING LIGHT: 8 W**

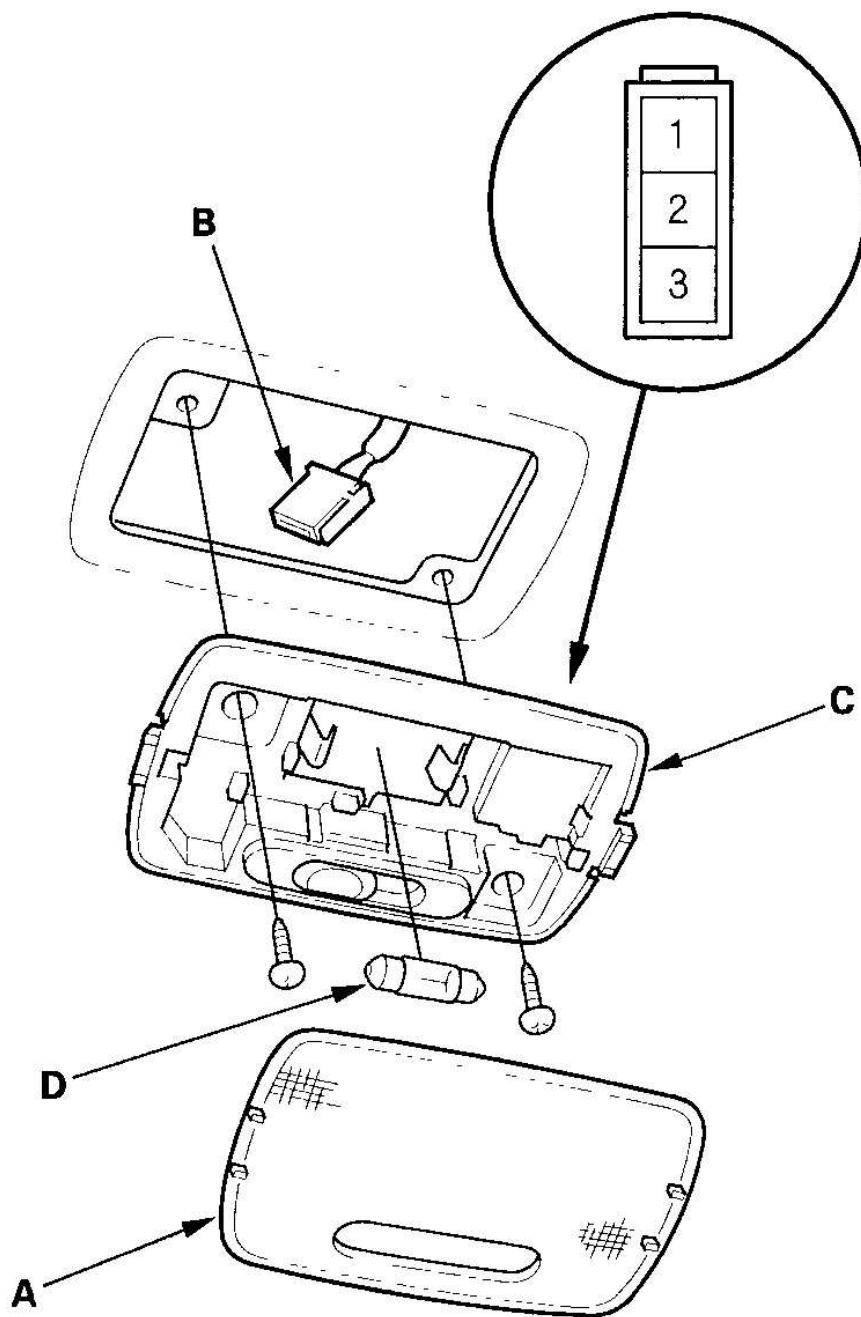

G03642170

**Fig. 11: Prying Off Lens With Screwdriver**  
Courtesy of AMERICAN HONDA MOTOR CO., INC.

3. Remove the two mounting screws.

## 2006 Acura MDX

### 2003-06 ACCESSORIES & EQUIPMENT Interior Lights - MDX

4. Disconnect the 3P connector (B) from the housing (C).
5. Check for continuity between the terminals in each switch position according to the table.
  - There should be continuity between the No. 2 and No. 3 terminals with the switch in the MIDDLE position.
  - There should be continuity between the No. 2 and No. 1 terminals with the switch in the ON position.
6. If the continuity is not as specified, check the bulb (D). If the bulb is OK, replace the light.

## TAILGATE LIGHT TEST/REPLACEMENT

1. Open the tailgate.
2. Carefully pry off the lens (A) with a small screwdriver.

**TAILGATE LIGHT: 5 W x 2**



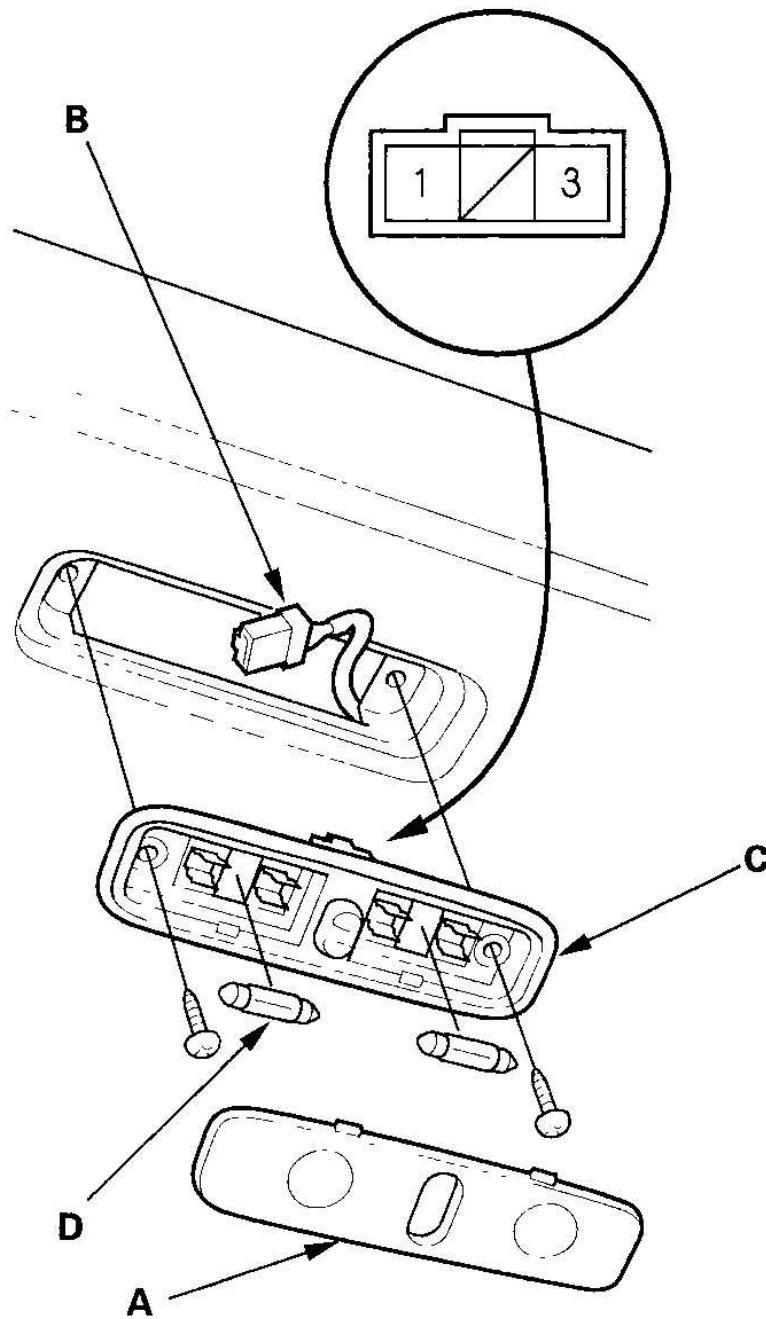

G03642171

**Fig. 12: Prying Off Lens With Screwdriver**  
Courtesy of AMERICAN HONDA MOTOR CO., INC.

3. Remove the two mounting screws.

<b>2006 Acura MDX</b>
2003-06 ACCESSORIES & EQUIPMENT Interior Lights - MDX

4. Disconnect the 3P connector (B) from the housing (C).
5. Check for continuity between the terminals. There should be continuity between the No. 1 and No. 3 terminals with the switch in the ON position.
6. If the continuity is not as specified, check the bulb (D). If the bulbs are OK, replace the light.

## **GLOVE BOX LIGHT TEST/REPLACEMENT**

1. Remove the glove box (see **GLOVE BOX REMOVAL/INSTALLATION** ).
2. Disconnect the 2P connector (A) from the glove box light (B).

**GLOVE BOX LIGHT: 3.4 W**

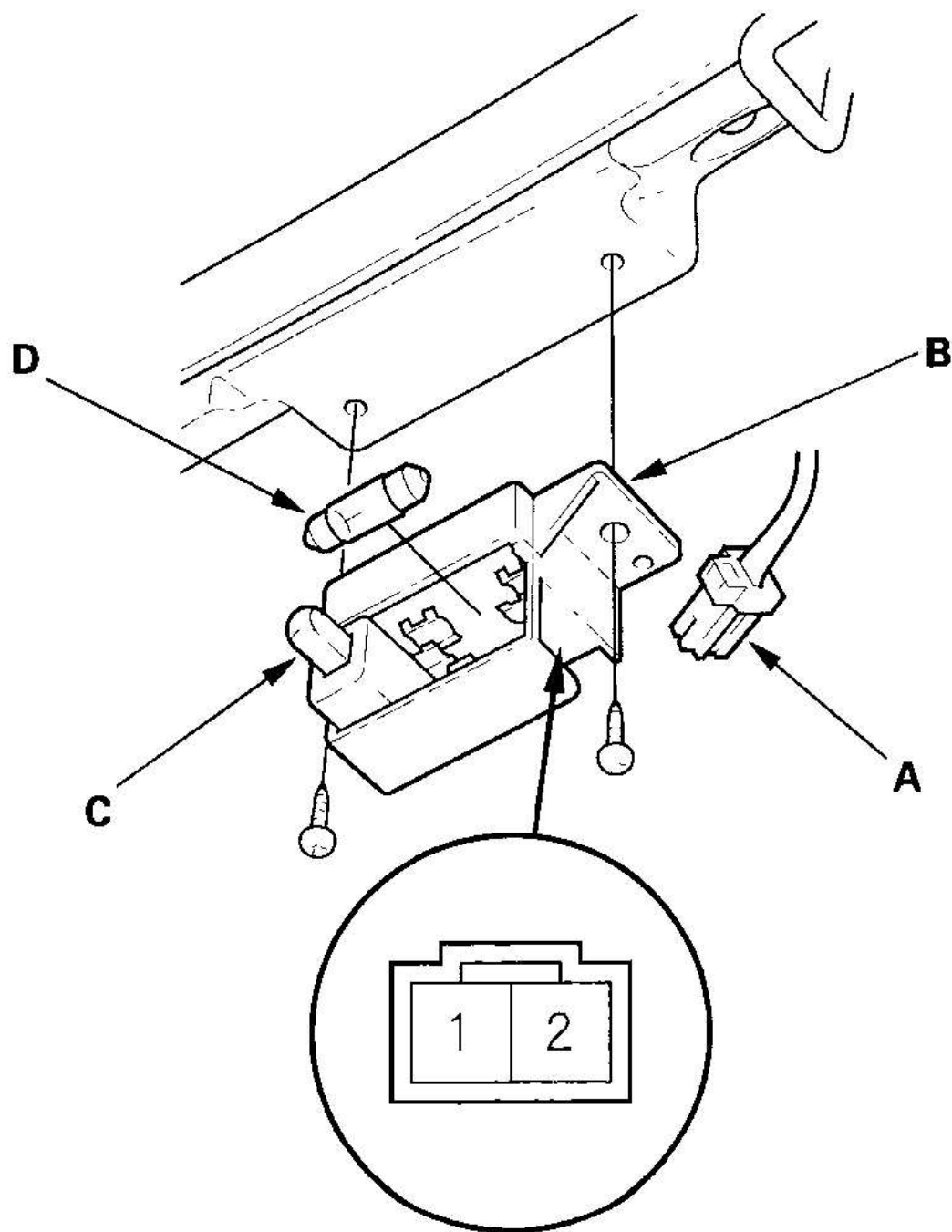

G03642172

**Fig. 13: Disconnecting 2P Connector From Glove Box Light**  
Courtesy of AMERICAN HONDA MOTOR CO., INC.

## 2006 Acura MDX

### 2003-06 ACCESSORIES & EQUIPMENT Interior Lights - MDX

3. Check for continuity between the No. 1 and No. 2 terminals.
  - With the button (C) released, there should be continuity.
  - With the button pressed, there should be no continuity.
4. If the continuity is not as specified, check the bulb (D), if the bulb is OK, replace the light.

## TAILGATE LATCH SWITCH TEST

1. Open the tailgate.
2. Remove the tailgate trim panel (see **TRIM REMOVAL/INSTALLATION - TAILGATE AREA** ).
3. Disconnect the 2P connector from the tailgate latch.

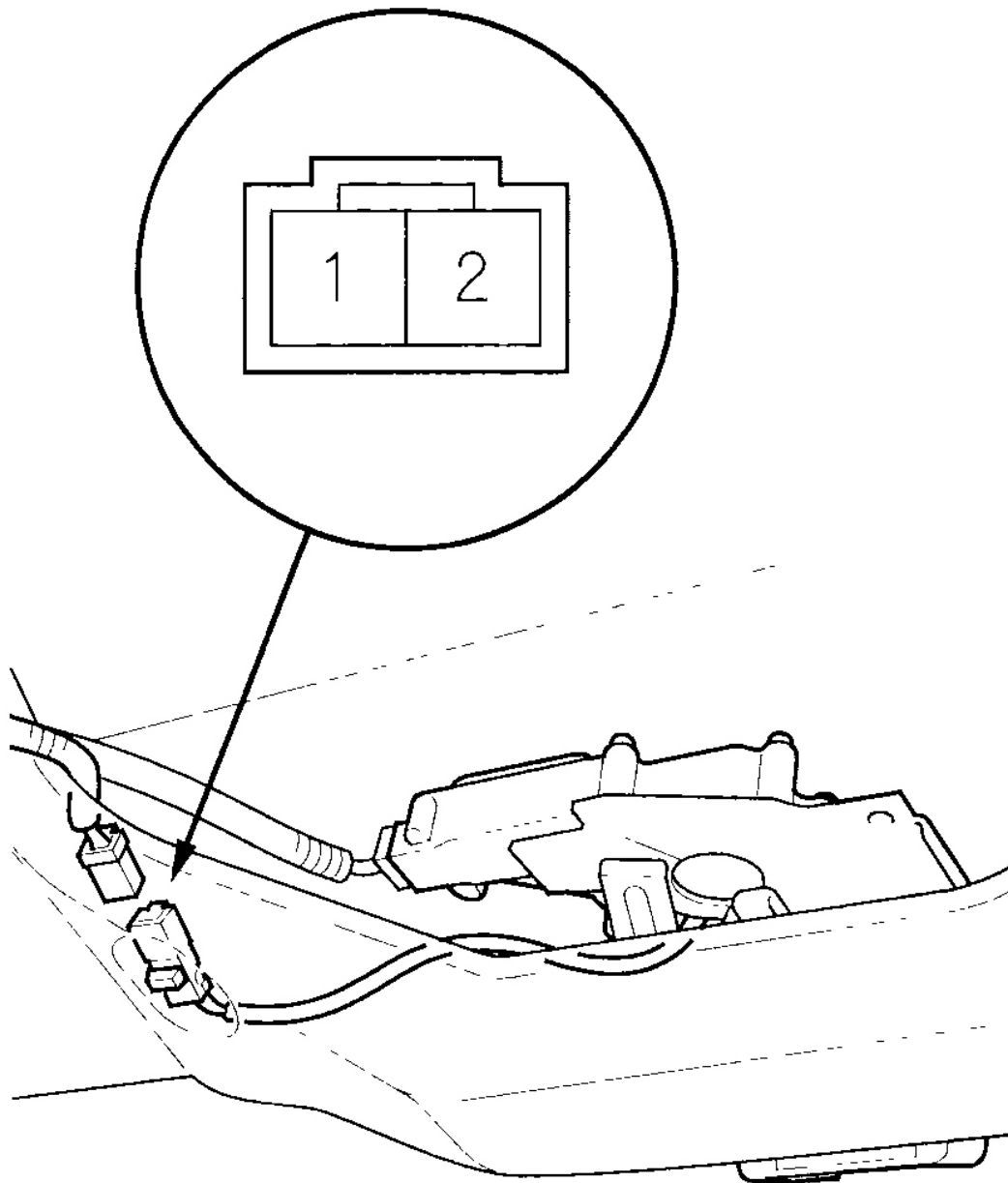

G03642173

**Fig. 14: Disconnecting 2P Connector From Tailgate Latch**  
Courtesy of AMERICAN HONDA MOTOR CO., INC.

4. Check for continuity between the No. 1 and No. 2 terminals.
  - With the tailgate open, there should be continuity.
  - With the tailgate closed, there should be no continuity.

5. If the continuity is not as specified, replace the latch switch.

## **VANITY MIRROR LIGHT REPLACEMENT**

1. Open the sunvisor.
2. Carefully pry off the lens (A) with a small screwdriver.

**VANITY MIRROR LIGHT: 1.1 W**

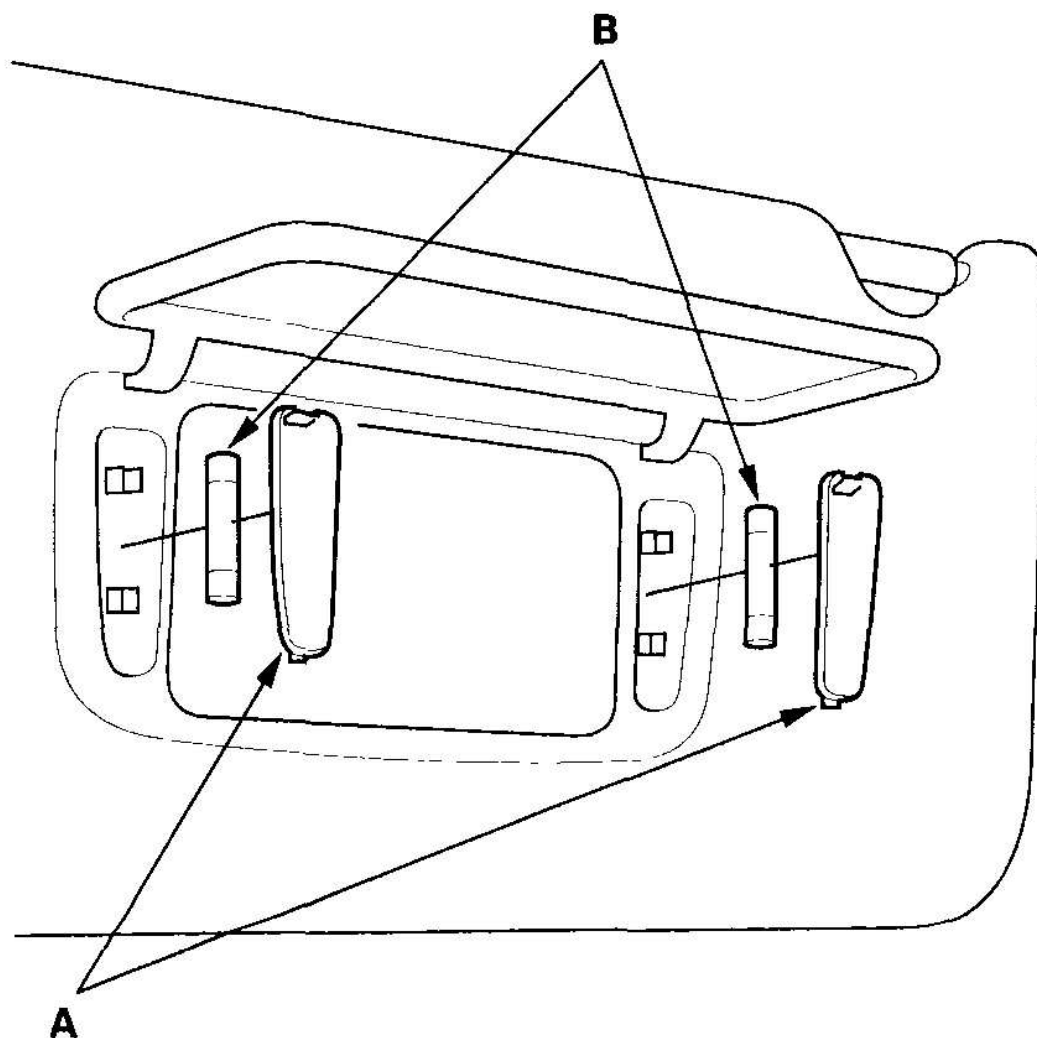

G03642174

**Fig. 15: Prying Off Lens With Screwdriver**  
Courtesy of AMERICAN HONDA MOTOR CO., INC.

3. Remove the bulb (B) from the socket.
4. Install in the reverse order of removal.

## **COURTESY LIGHT REPLACEMENT**

1. Carefully pry off the lens (A) with a small screwdriver.

**COURTESY LIGHT: 3.8 W**

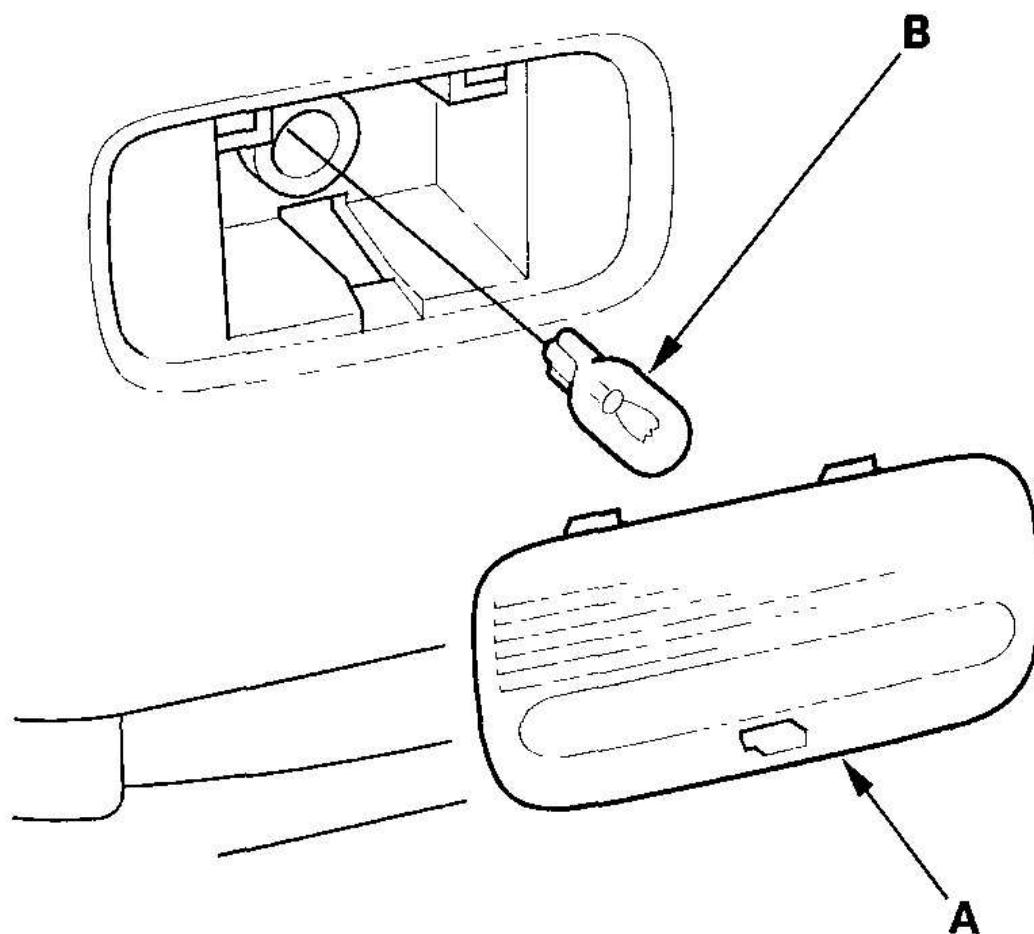

G03642175

**Fig. 16: Prying Off Lens With Screwdriver**  
**Courtesy of AMERICAN HONDA MOTOR CO., INC.**

2. Remove the bulb (B) from the socket.

<b>2006 Acura MDX</b>
2003-06 ACCESSORIES & EQUIPMENT Interior Lights - MDX

3. Install in the reverse order of removal.

## **FOOTWELL LIGHT TEST/REPLACEMENT**

### **'04-'06 MODELS**

1. Driver's: Carefully pry out the footwell light lens (A) and housing (B).

Front passenger's: Carefully pry out the footwell light (A).

**Footwell Light: 5 W**



2006 Acura MDX

2003-06 ACCESSORIES & EQUIPMENT Interior Lights - MDX

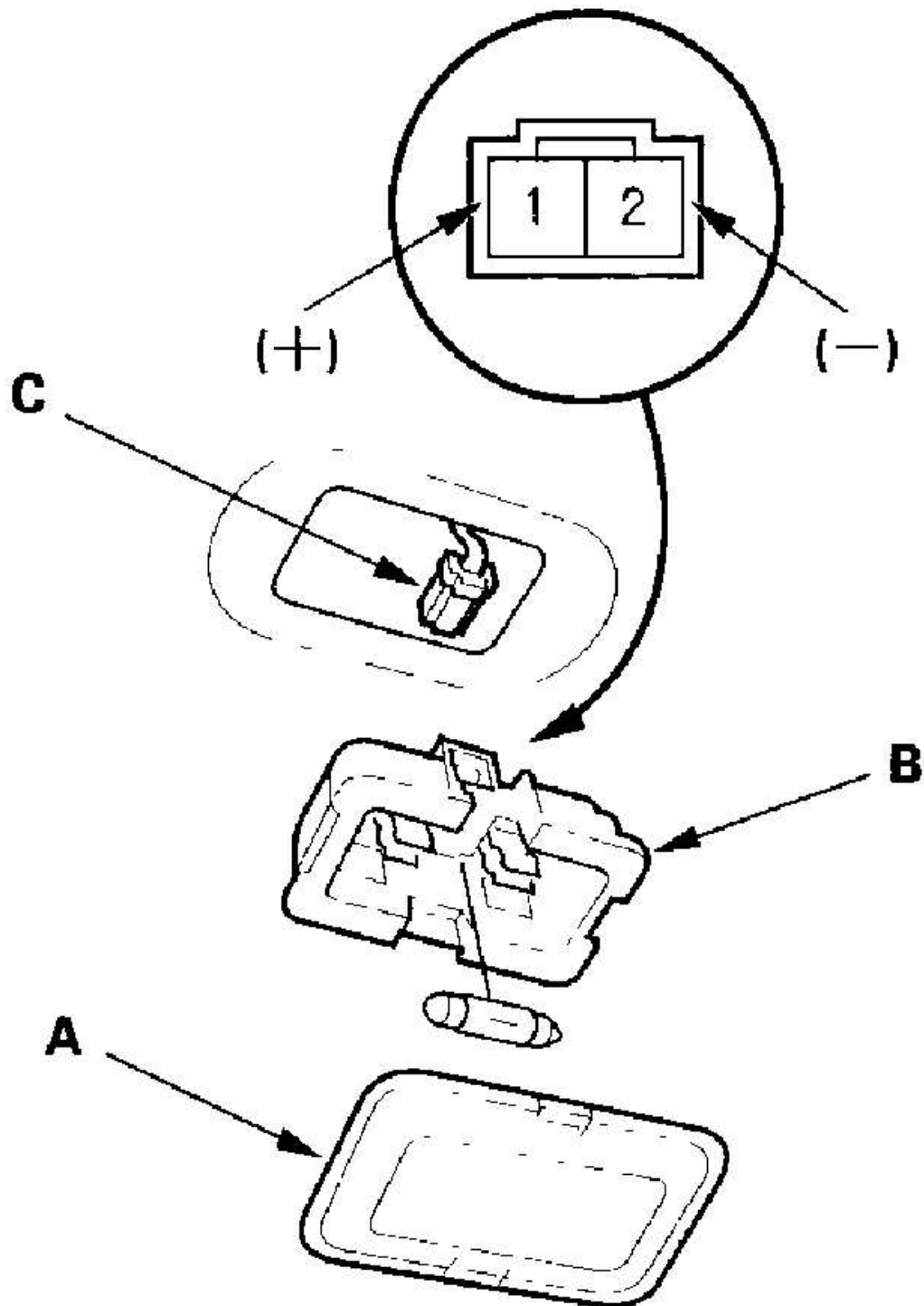

G03642176

**Fig. 17: Prying Footwell Light Lens And Housing (Driver's)**  
Courtesy of AMERICAN HONDA MOTOR CO., INC.

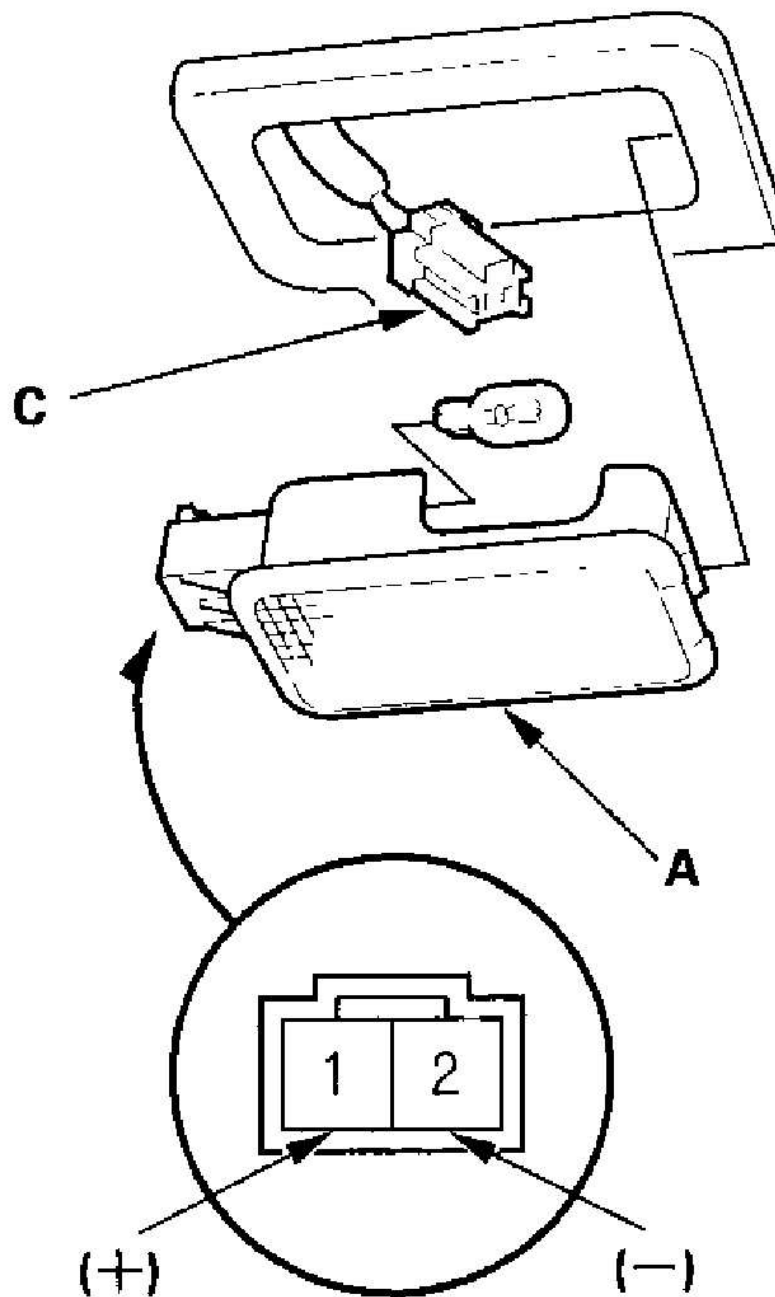

G03642177

**Fig. 18: Prying Footwell Light (Front Passenger's)**

<b>2006 Acura MDX</b>
2003-06 ACCESSORIES & EQUIPMENT Interior Lights - MDX

**Courtesy of AMERICAN HONDA MOTOR CO., INC.**

2. Disconnect the 2P connector (C) from the light.
3. Check for continuity between the No. 1 (+) and No. 2 (-) terminals. There should be continuity. If there is no continuity, check the bulb (C). If the bulb is OK, replace the footwell light.
4. Install in the reverse order of removal.

## **AMBIENT LIGHT REPLACEMENT**

1. Turn the light socket (A) 45 degrees counterclockwise to remove it.

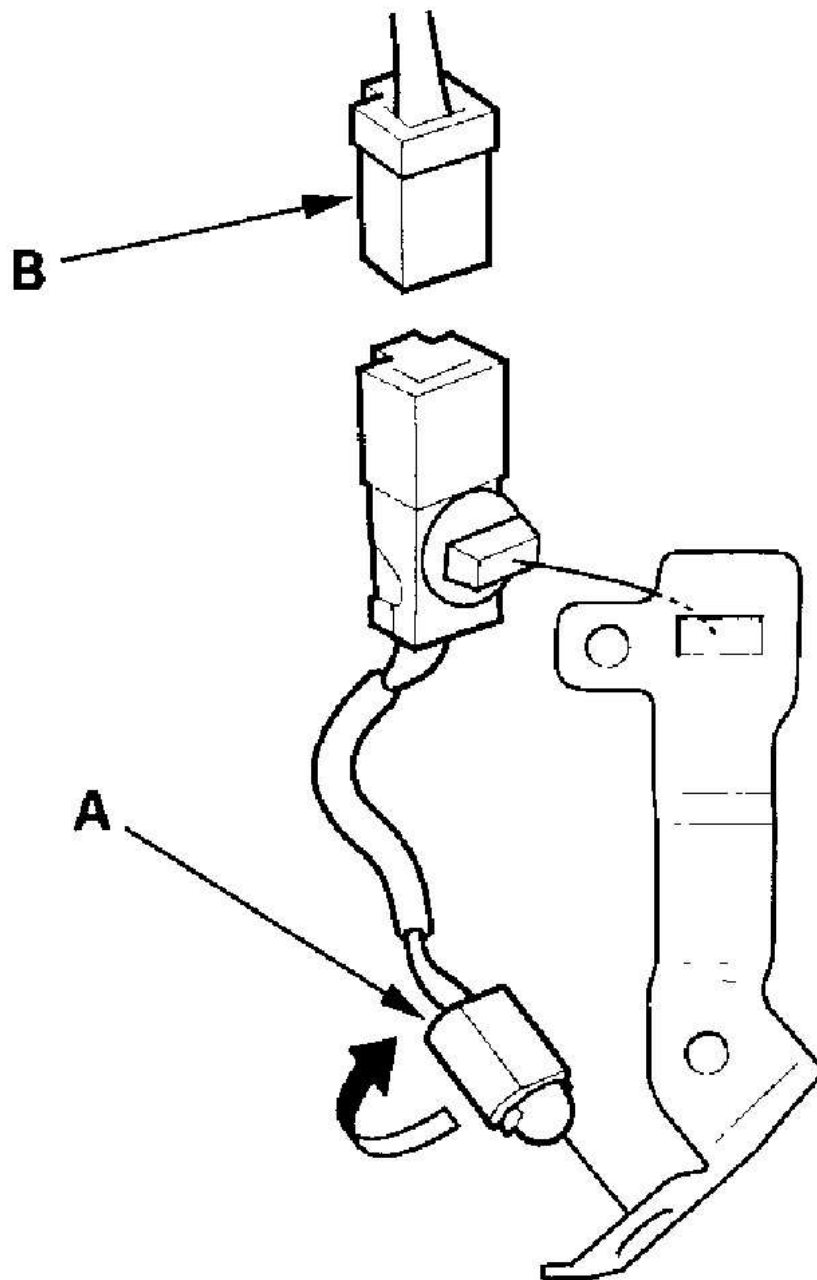

G03642178

**Fig. 19: Turning Light Socket Counterclockwise To Remove**  
Courtesy of AMERICAN HONDA MOTOR CO., INC.

2. Disconnect the 3P connector (B).

## 2006 Acura MDX

2003-06 ACCESSORIES & EQUIPMENT Interior Lights - MDX

3. Install in the reverse order of removal.

## INTERIOR LIGHT SWITCH TEST

### '03 MODEL

1. Remove the center panel (see **DASHBOARD CENTER PANEL REMOVAL/INSTALLATION** ).
2. Disconnect the 6P connector (A) from the interior lights switch (B).

**2006 Acura MDX**



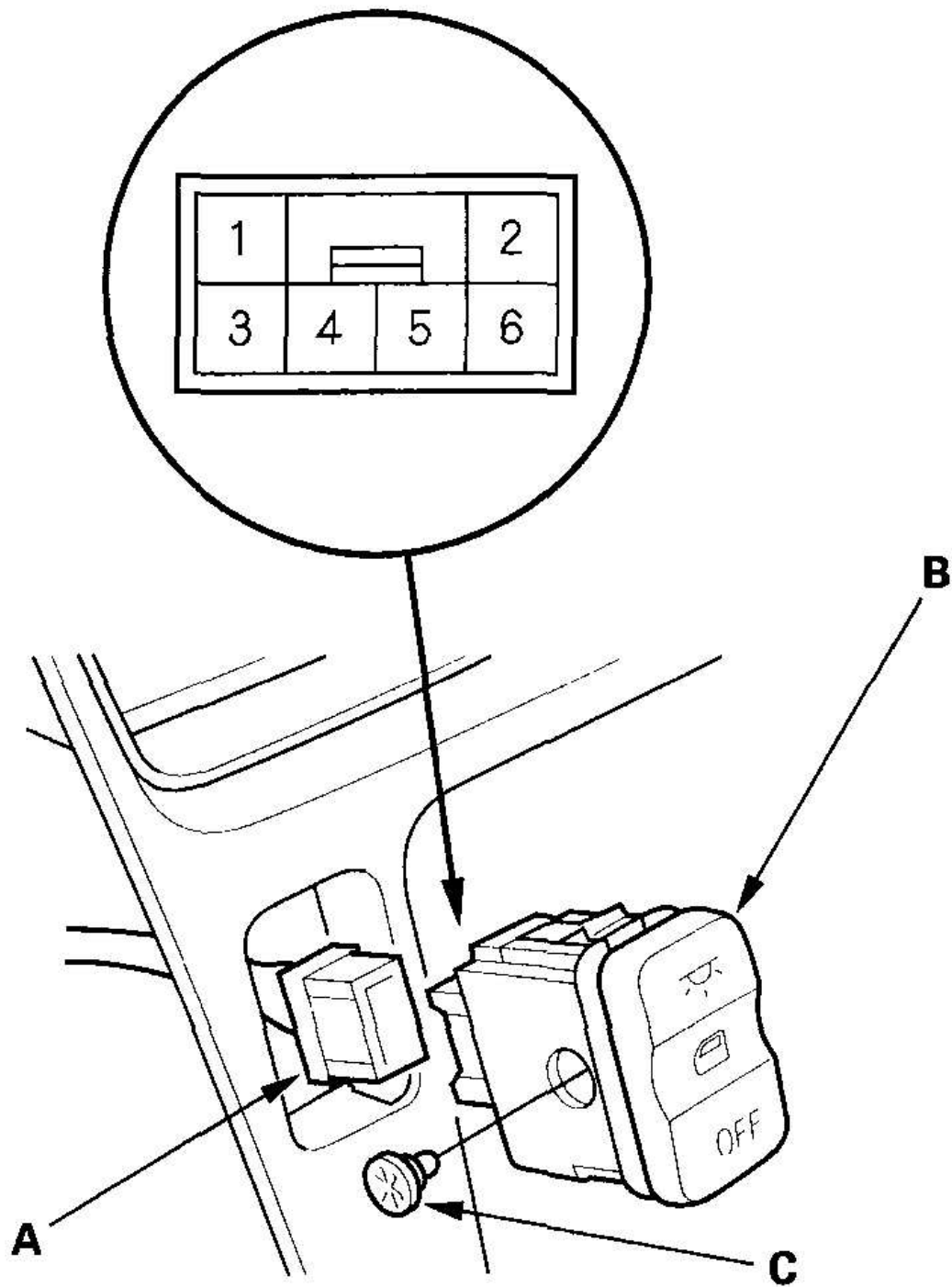



2003-06 ACCESSORIES & EQUIPMENT Interior Lights - MDX

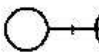
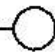
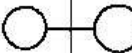
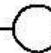
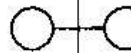
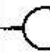

G03642179

**Fig. 20: Disconnecting 6P Connector From Interior Lights Switch**  
 Courtesy of AMERICAN HONDA MOTOR CO., INC.

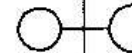
3. Pull the interior lights switch out of the center panel.
4. Check for continuity between the terminals in each switch position according to **Fig. 21**.

Terminal Position	1	2	3	4	5	6
OFF						
MIDDLE						
ON						

G03642180

**Fig. 21: Checking Continuity Between Terminals In Switch Position Chart**  
 Courtesy of AMERICAN HONDA MOTOR CO., INC.

5. If the continuity is not as specified, replace the illumination bulb (C) or the switch.

#### '04-'06 MODELS

1. Turn the interior light switch OFF.
2. Remove the moonroof switch (see **'04-'06 MODELS**).
3. Carefully remove the roof console (A).

## 2006 Acura MDX

2003-06 ACCESSORIES & EQUIPMENT Interior Lights - MDX

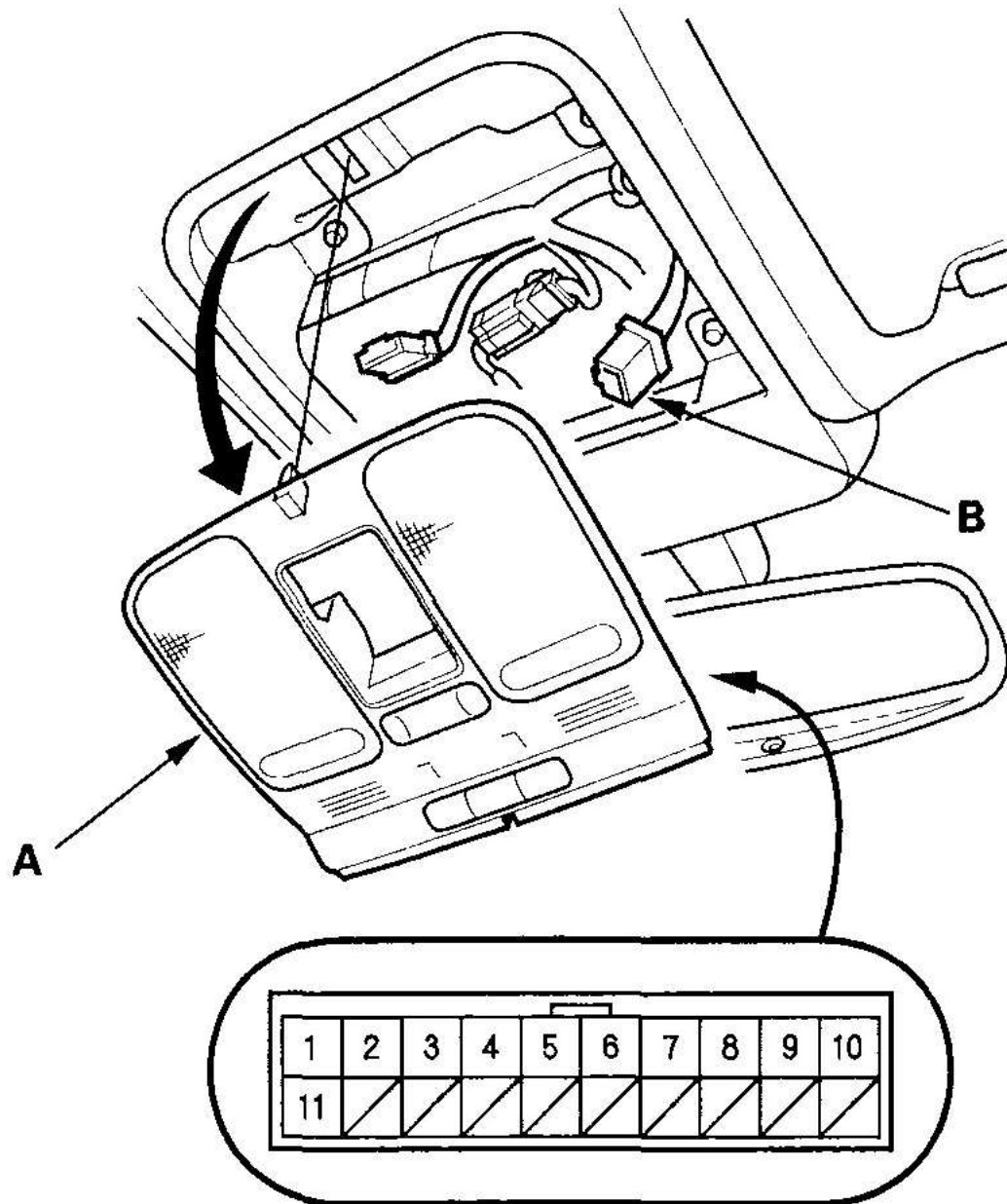

G03642181

**Fig. 22: Removing Roof Console**

Courtesy of AMERICAN HONDA MOTOR CO., INC.

**NOTE:** The illustration shows '04 model.



4. Disconnect the 20P connector (B) from the roof console.
5. Check for continuity between the terminals in each switch position according to **Fig. 23**.

<b>Terminal Position</b>	<b>2</b>	<b>11</b>	<b>5</b>	<b>6</b>
<b>OFF</b>				
<b>MIDDLE (DOOR)</b>	○—○		○—○	
<b>ON</b>	○—○—○—○			

G03642182

**Fig. 23: Checking Continuity Between Terminals In Each Switch Position Chart**  
Courtesy of AMERICAN HONDA MOTOR CO., INC.

6. If the continuity is not as specified, replace the roof console.