

2003-06 ACCESSORIES & EQUIPMENT

Mirrors - MDX

COMPONENT LOCATION INDEX

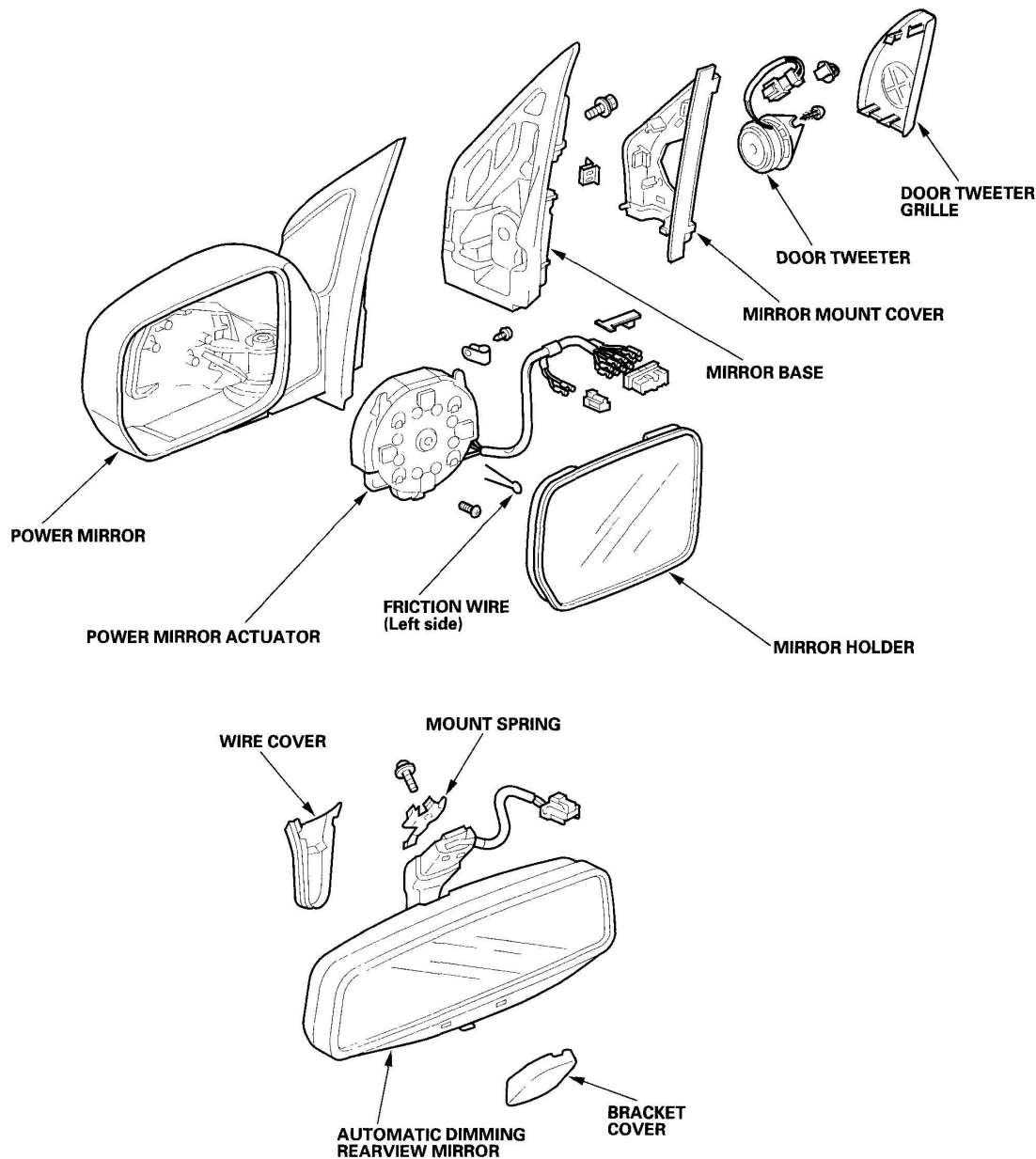

G03641530

Fig. 1: Locating Mirrors Components
Courtesy of AMERICAN HONDA MOTOR CO., INC.

POWER MIRROR REPLACEMENT

1. Lower the door glass fully.
2. Carefully detach the clips and release the hook (A), then pry out the mirror mount cover (B) by hand in the sequence shown.

Fastener Locations

▷ : Clip, 2

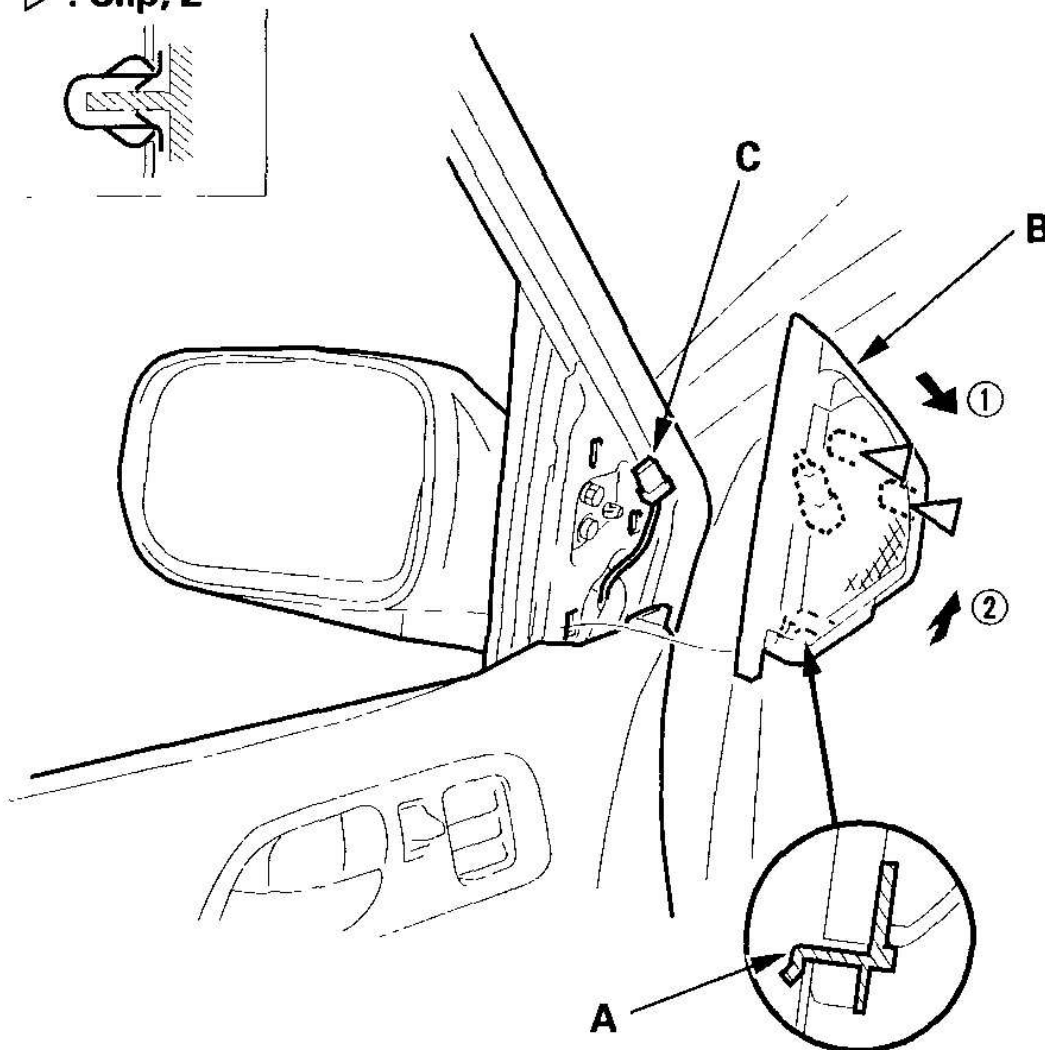

G03641531

Fig. 2: Detaching Clips And Releasing Hook
Courtesy of AMERICAN HONDA MOTOR CO., INC.

2006 Acura MDX

2003-06 ACCESSORIES & EQUIPMENT Mirrors - MDX

3. Disconnect the door tweeter connector (C).
4. Remove the door panel (see **FRONT DOOR PANEL REMOVAL/INSTALLATION**).
5. Pull the front door upper seal (A) as necessary, disconnect the connector (B), and detach the harness clip (C), then remove the bolts securing the mirror. While holding the mirror (D), push out the clip (E), and remove the mirror. Take care not to scratch the door.

Fastener Locations

► : Bolt, 3

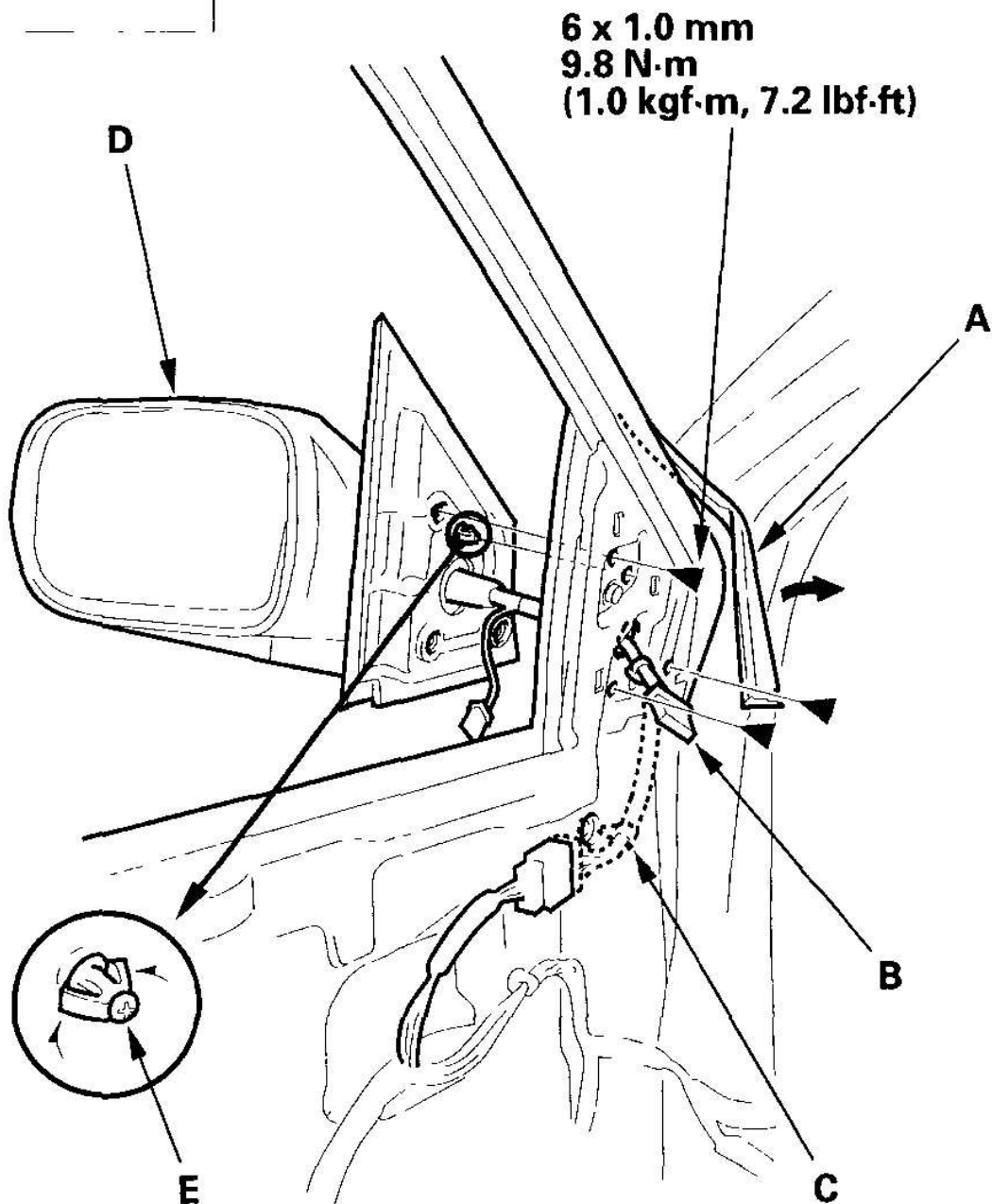
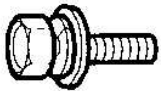

Fig. 3: Pulling Front Door Upper Seal

Courtesy of AMERICAN HONDA MOTOR CO., INC.

6. Install the mirror in the reverse order of removal, and note these items:
 - Make sure the connector is plugged in properly.
 - Attach the harness clip.

MIRROR HOLDER REPLACEMENT

1. Push in the bottom of the mirror holder (A).

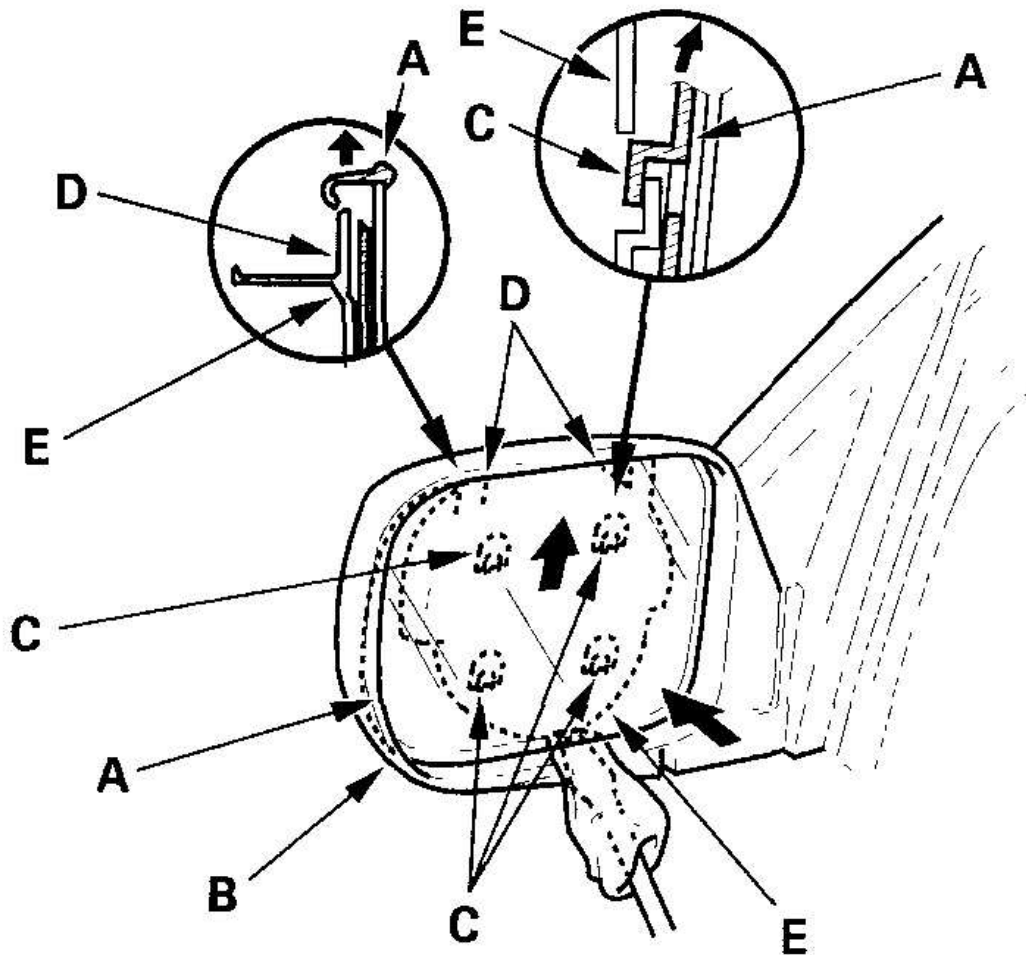

G03641533

Fig. 4: Pushing Bottom Of Mirror Holder

Courtesy of AMERICAN HONDA MOTOR CO., INC.

2. Insert a flat-tip screwdriver wrapped with a shop towel at the bottom gap between the mirror holder and mirror (B). Push the mirror holder upward to release the hooks (C, D) from the actuator adapter plate (E) while holding the mirror holder.
3. Disconnect the mirror defogger terminals (A).

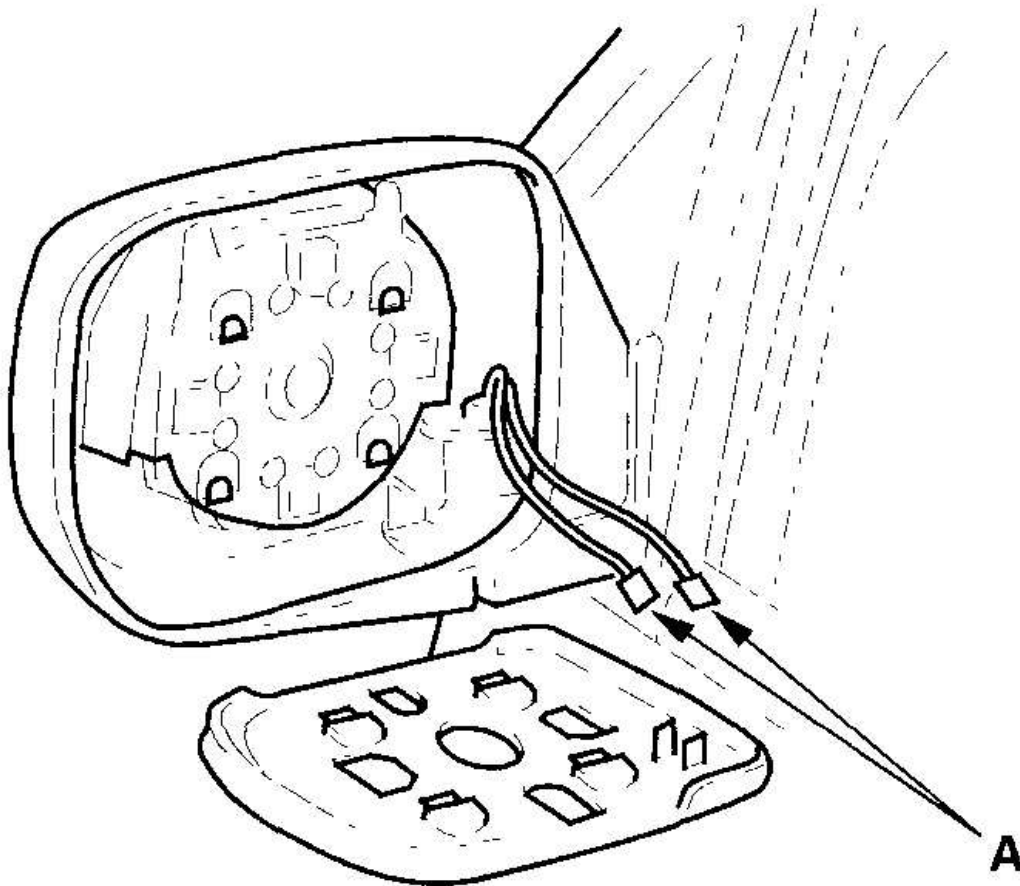

G03641534

Fig. 5: Disconnecting Mirror Defogger Terminals
Courtesy of AMERICAN HONDA MOTOR CO., INC.

4. Install the mirror holder in the reverse order of removal, and note these items:
 - Make sure the terminals are plugged in properly.
 - Push the mirror holder downward to lock in the hooks.

- Push in the bottom of the mirror fully before you push on the mirror holder.
- Check the operation of the actuator.

AUTOMATIC DIMMING REARVIEW MIRROR REPLACEMENT

Special Tools Required

KTC trim tool set SOJATP2014

NOTE:

- Use the appropriate tool from the KTC trim tool set to avoid damage when prying components.
- When prying with a flat-tip screwdriver, wrap it with protective tape to prevent damage.

1. If equipped, remove the rain sensor (see **CONTROL UNIT INPUT TEST**).
2. Remove the roof console, '03 model (see step 6 in **HEADLINER REMOVAL/INSTALLATION**), '04-06 models (see step 7 in **HEADLINER REMOVAL/INSTALLATION**).
3. Disconnect the connector (A), and carefully remove the bracket cover (B) by releasing the hooks (C). Take care not to scratch the cover and mirror bracket (D).

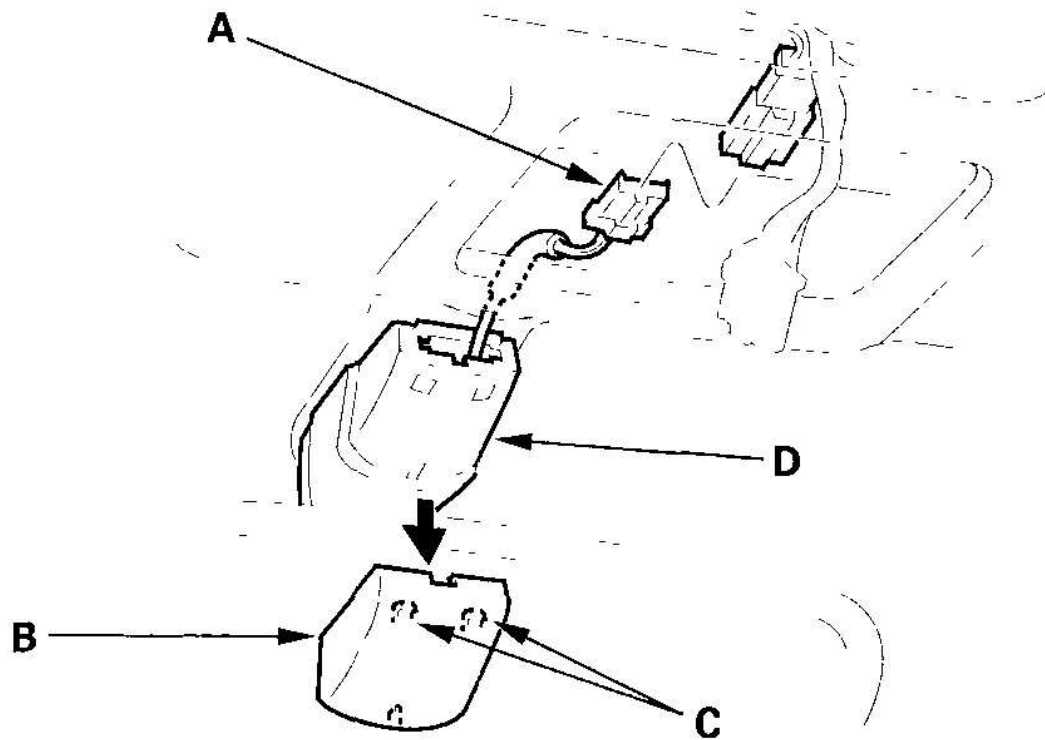

G03641535

Fig. 6: Removing Bracket Cover

Courtesy of AMERICAN HONDA MOTOR CO., INC.

4. Slide the rearview mirror (A) forward to release the spring (B) by gently tapping the mirror bracket with a flat-tip screwdriver and a plastic hammer. Remove the mirror from the lug (C).

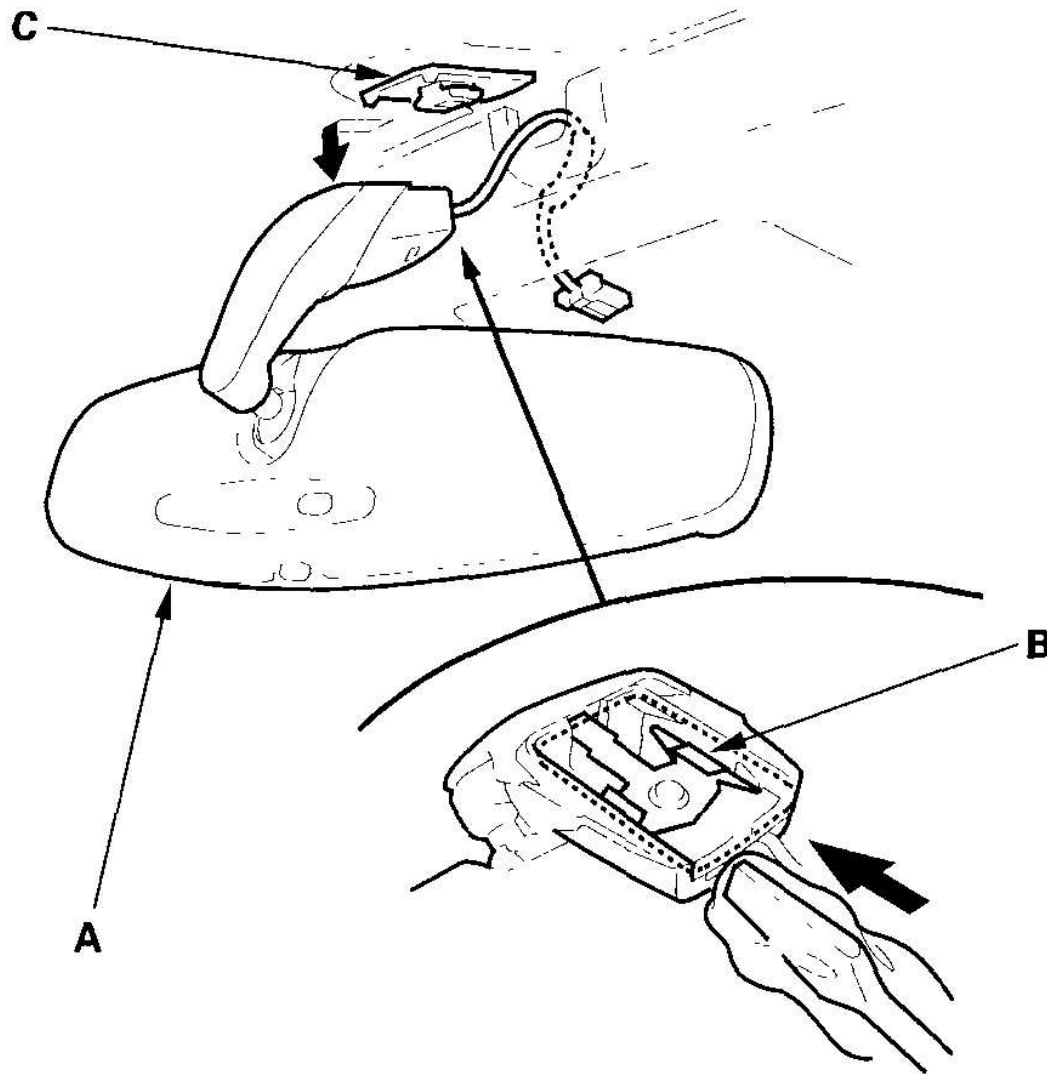

G03641536

Fig. 7: Sliding Rearview Mirror Forward To Release Spring
Courtesy of AMERICAN HONDA MOTOR CO., INC.

5. Remove the wire cover (A) from the mirror bracket (B) by releasing the hooks (C) in the sequence shown in **Fig. 8**.

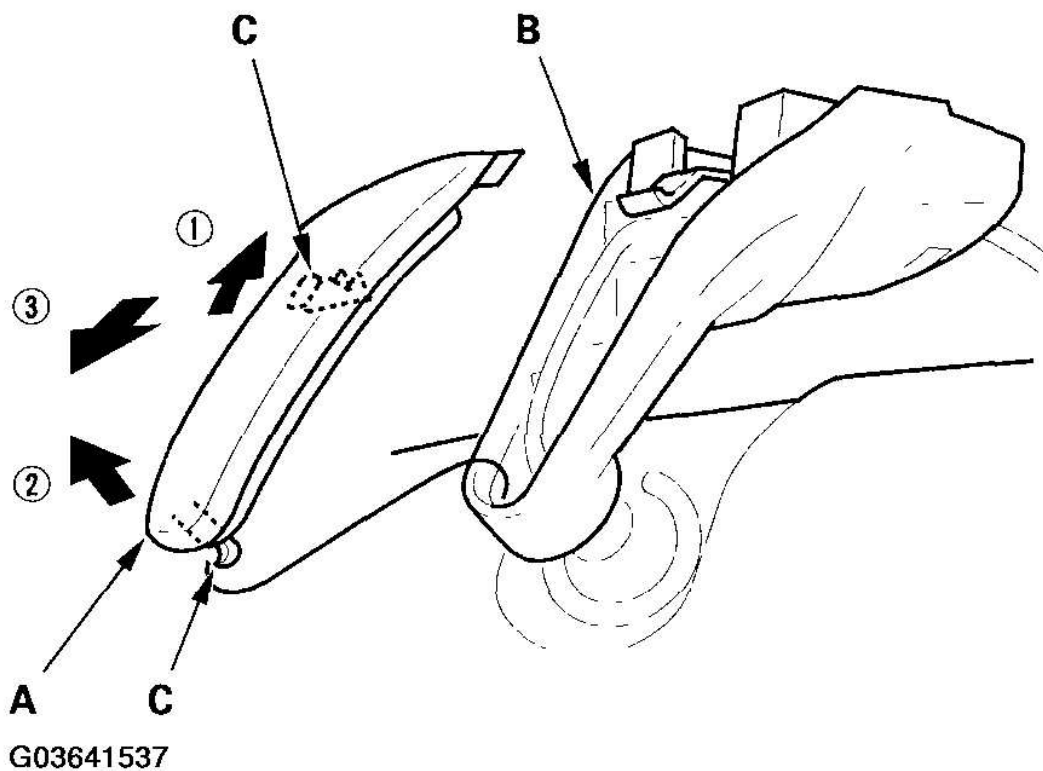
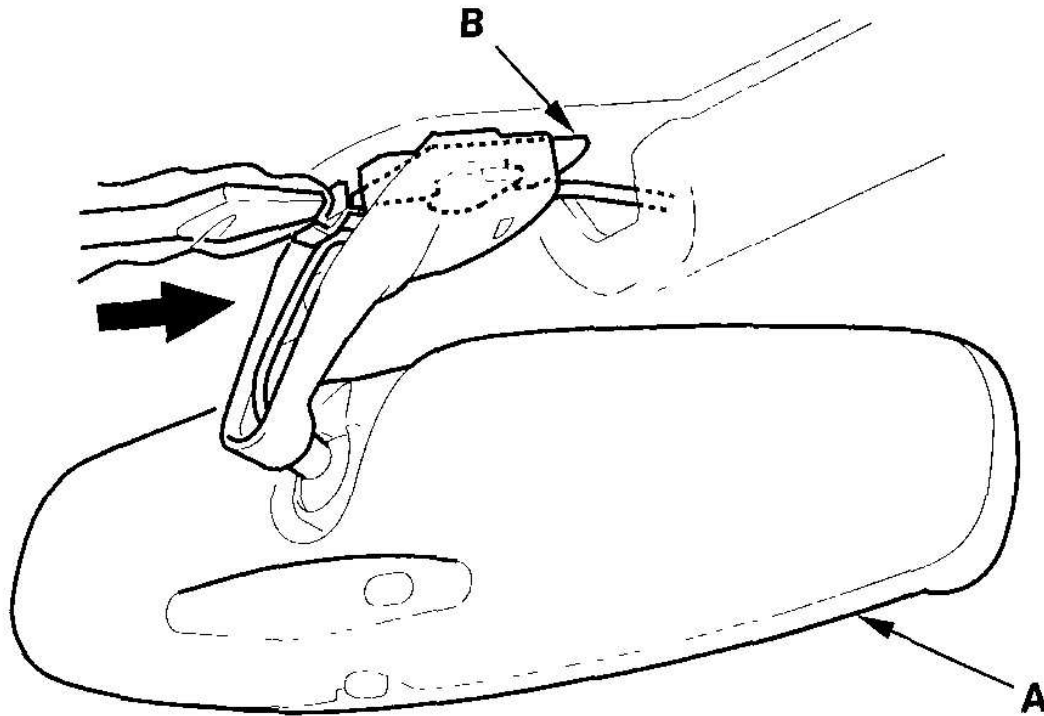

Fig. 8: Removing Wire Cover From Mirror Bracket Releasing Hooks In Sequence
Courtesy of AMERICAN HONDA MOTOR CO., INC.

6. Install the rearview mirror (A) by sliding it over the lug (B) until the spring contacts the lug. Gently tap the mirror bracket with a flat-tip screwdriver and a plastic hammer. Be careful not to damage the wires.



G03641538

Fig. 9: Installing Rearview Mirror Sliding Over Lug Until Spring Contracts Lug
Courtesy of AMERICAN HONDA MOTOR CO., INC.

7. Install the wire cover (A) in the sequence shown in **Fig. 10** . Take care not to damage the hooks (B).

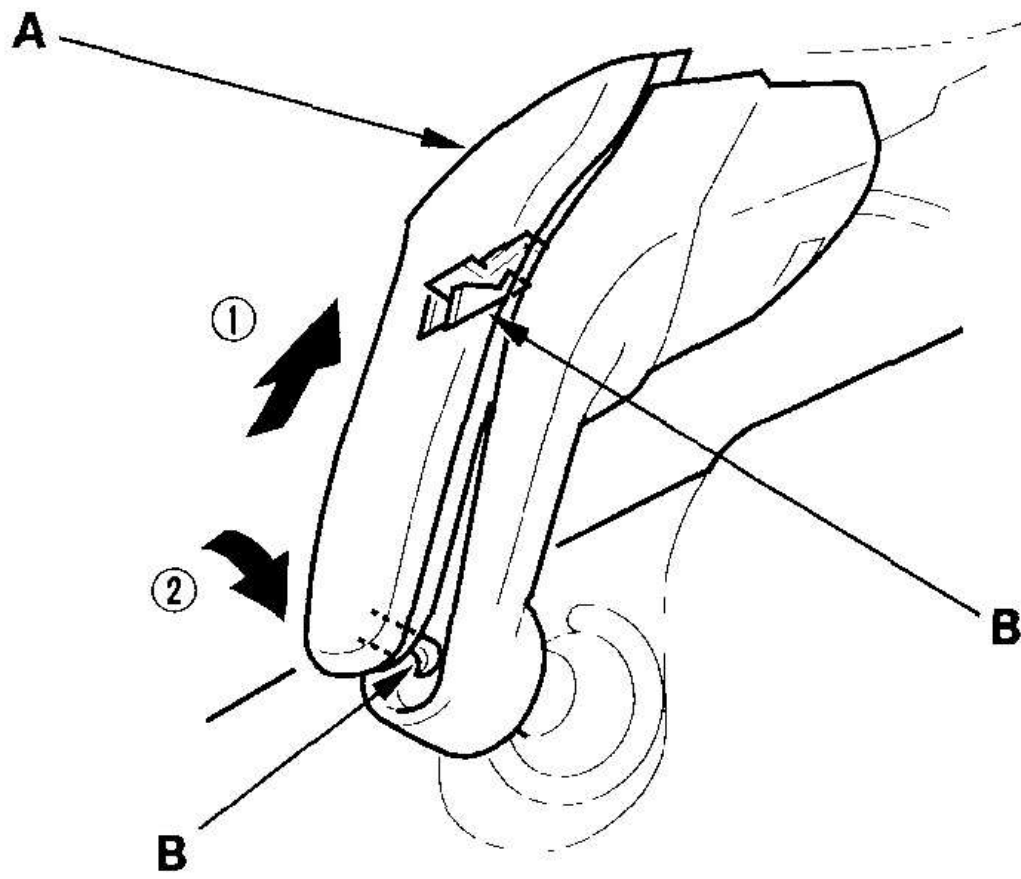

G03641539

Fig. 10: Installing Wire Cover In Sequence
Courtesy of AMERICAN HONDA MOTOR CO., INC.

8. Install the bracket cover, and connect the connector, then install the roof console.
9. If equipped, install the rain sensor.