

2003-06 ACCESSORIES & EQUIPMENT

Openers - MDX

COMPONENT LOCATION INDEX

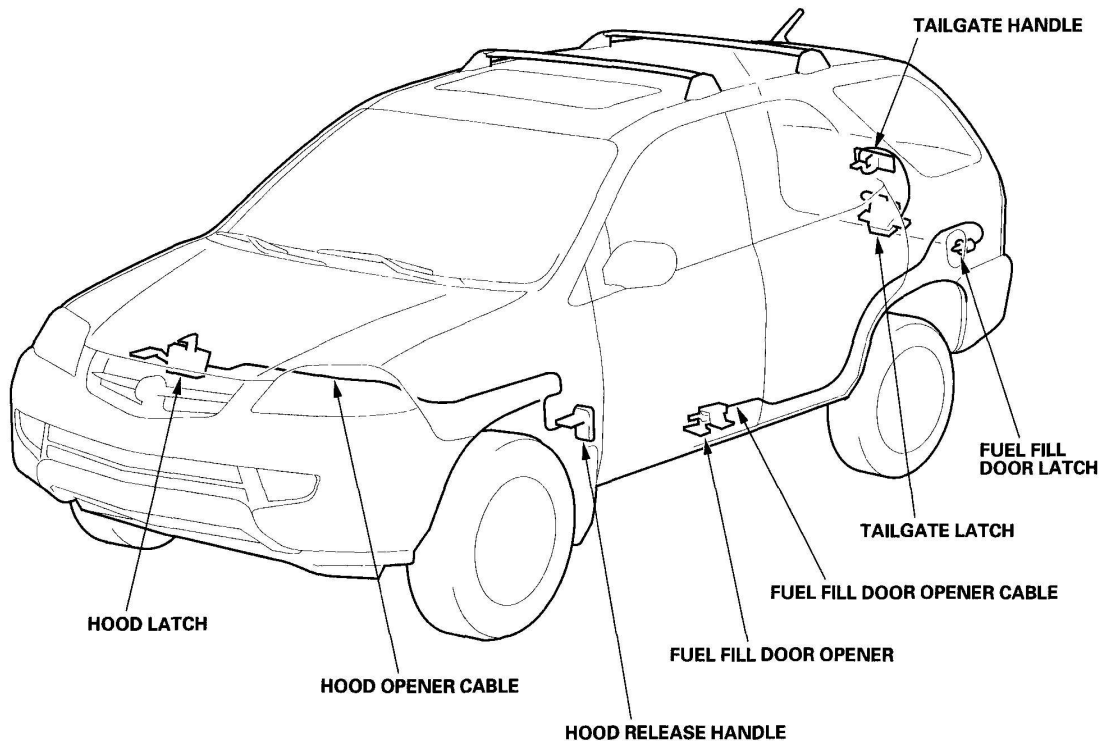

G03641781

Fig. 1: Identifying Openers Components
Courtesy of AMERICAN HONDA MOTOR CO., INC.

HOOD OPENER CABLE REPLACEMENT

1. Remove the following parts from the left side of the vehicle:
 - Front inner fender (see **FRONT INNER FENDER REPLACEMENT**)
 - Kick panel (see **TRIM REMOVAL/INSTALLATION - DOOR AREAS**)
2. Remove the hood latch (A) (see **HOOD RELEASE HANDLE REPLACEMENT**), and disconnect the hood opener cable (B).

Fastener Locations

D ▷ : Clip, 4 E ▷ : Clip, 2

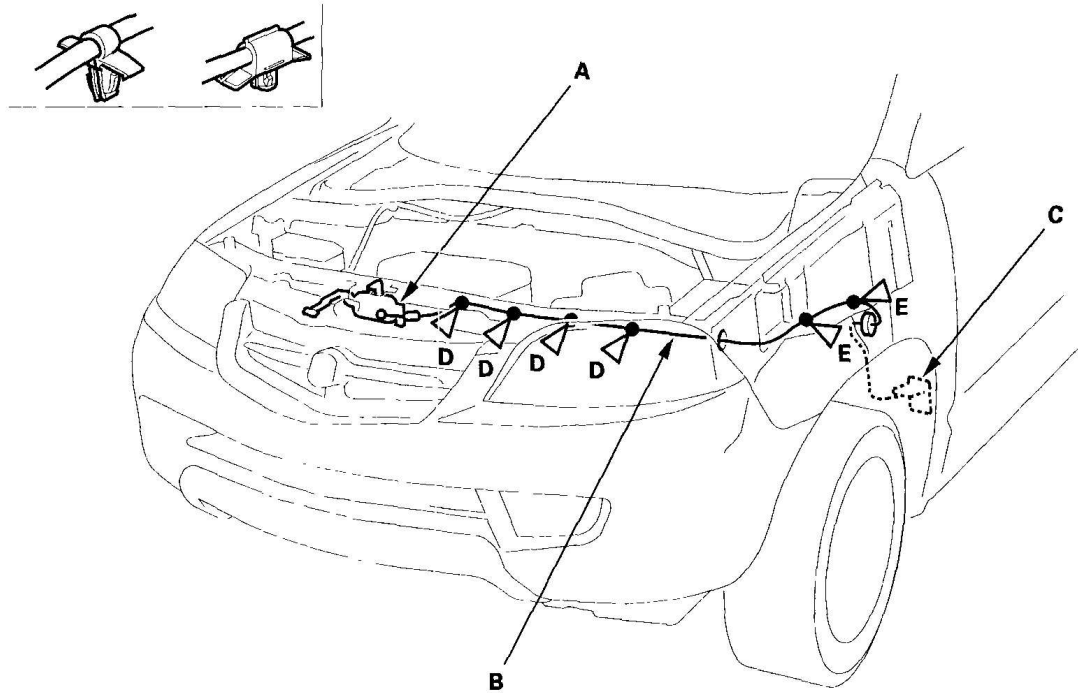

G03641782

Fig. 2: Removing Hood Latch

Courtesy of AMERICAN HONDA MOTOR CO., INC.

3. Remove the hood release handle (C) (see **HOOD RELEASE HANDLE REPLACEMENT**), and disconnect the hood opener cable.
4. Using a clip remover, detach the clips (D, E) from the body, then remove the hood opener cable from the vehicle. Take care not to kink the cable.
5. Install the cable in the reverse order of removal, and note these items:
 - Check the clips for damage or stress-whitening, and replace them with new one.
 - Push the clips into place securely.

FUEL FILL DOOR OPENER CABLE REPLACEMENT

SRS components are located in this area. Review the SRS component locations for the appropriate model:

- '03 model (see **2003 MODEL**)
- '04-06 models (see **2004-2006 MODELS**)

Also review the precautions and procedures (see **PRECAUTIONS AND PROCEDURES**) before performing repairs or service.

1. Remove these items:
 - Front door sill trim, left side (see step 1 on **TRIM REMOVAL/INSTALLATION - DOOR AREAS**)
 - Rear door sill trim, left side (see step 4 in **TRIM REMOVAL/INSTALLATION - DOOR AREAS**)
 - Rear side trim panel (see **TRIM REMOVAL/INSTALLATION - REAR SIDE LOWER AREA**)
2. Pull the carpet back as necessary (see **CARPET REPLACEMENT**).
3. Disconnect the fuel fill door opener cable (A) from the opener (B) (see step 3 in **FUEL FILL DOOR OPENER REPLACEMENT**).

Fastener Locations

C ▷ : Clip, 7 D ▷ : Clip, 1

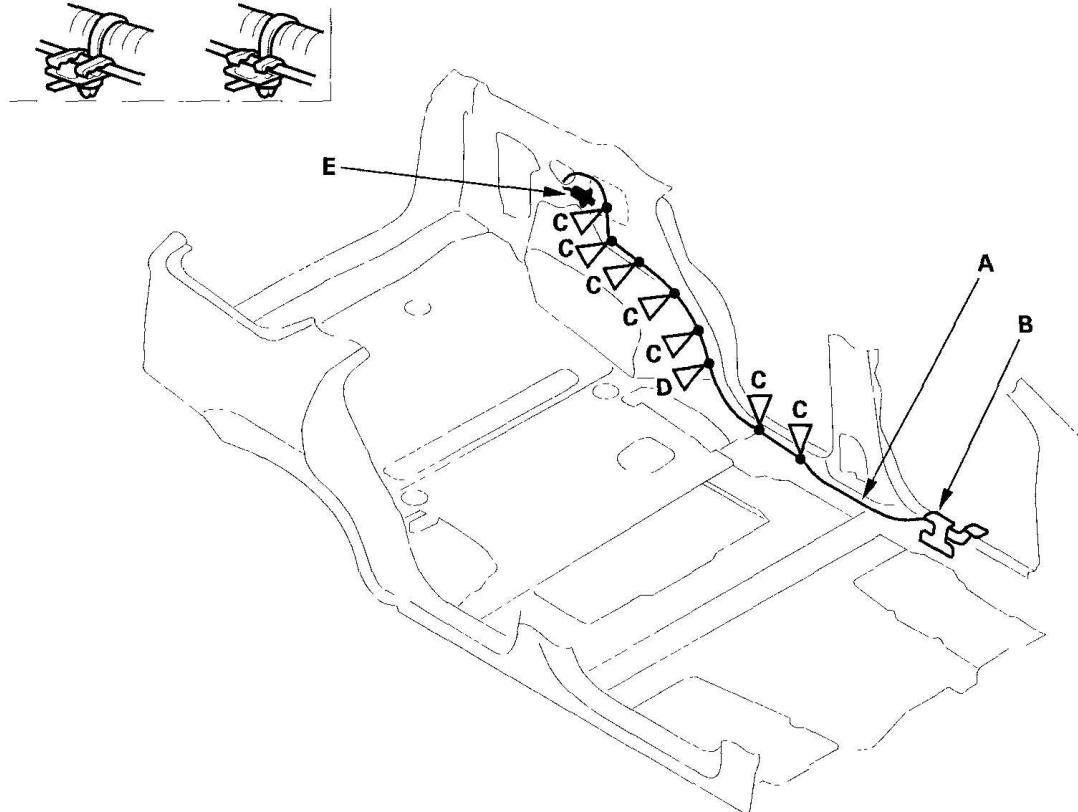

G03641783

Fig. 3: Disconnecting Fuel Fill Door Opener Cable
 Courtesy of AMERICAN HONDA MOTOR CO., INC.

4. Release the opener cable from the clips (C, D), then remove the fuel fill door latch (E) from the body by turning it 90°.

2006 Acura MDX
2003-06 ACCESSORIES & EQUIPMENT Openers - MDX

5. Remove the fuel fill door opener cable from the vehicle. Take care not to kink the cable.
6. Install the cable in the reverse order of removal.

HOOD RELEASE HANDLE REPLACEMENT

1. Remove the left kick panel (see **TRIM REMOVAL/INSTALLATION - DOOR AREAS**).
2. Remove the bolts, then remove the hood release handle (A).

Fastener Locations

► : Bolt, 2

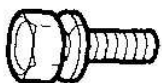

6 x 1.0 mm
9.8 N·m
(1.0 kgf·m, 7.2 lbf·ft)

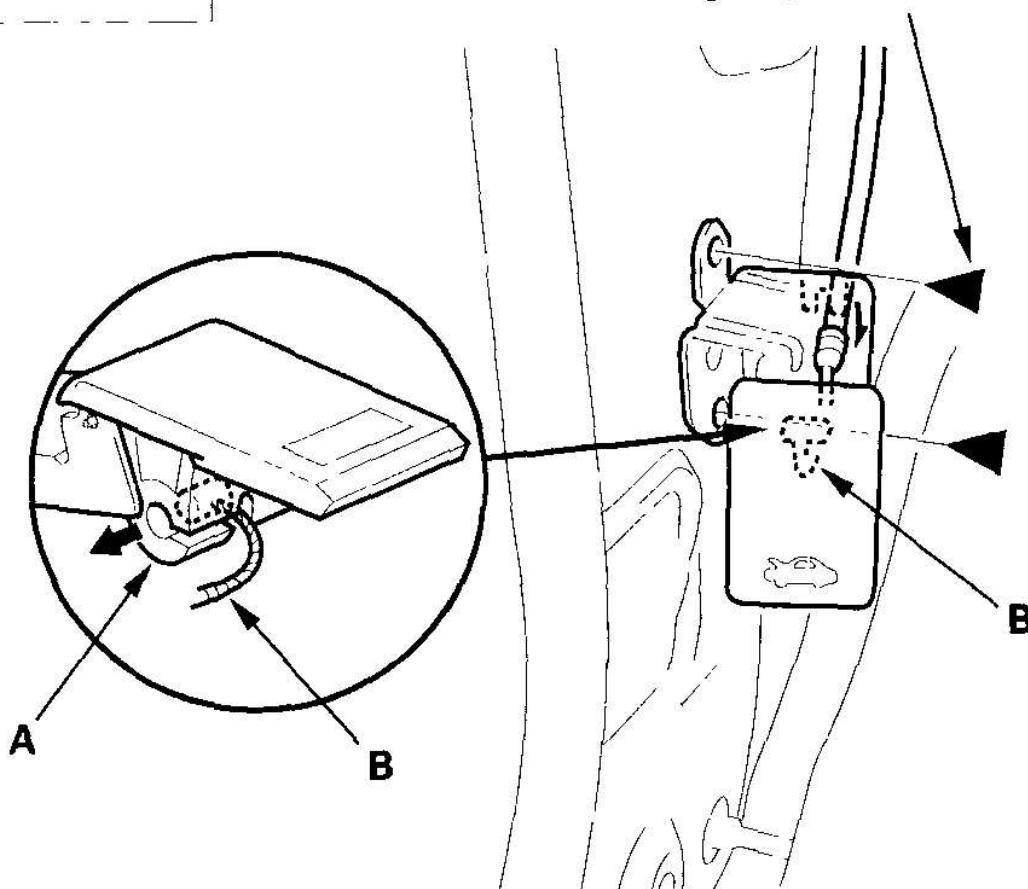

G03641784

Fig. 4: Removing Hood Release Handle

Courtesy of AMERICAN HONDA MOTOR CO., INC.

3. Disconnect the hood opener cable (B) from the hood release handle. Take care not to kink the cable.
4. Install the hood release handle in the reverse order of removal, and note these items:
 - Make sure the hood opener cable is connected properly.
 - Make sure the hood opens properly.

HOOD LATCH REPLACEMENT

NOTE:

- Put on gloves to protect your hands.
- Take care not to scratch the body.

1. Remove the bolts securing the hood latch (A) on the body.

Fastener Locations

► : Bolt, 3

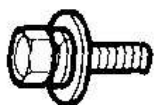

6 x 1.0 mm
9.8 N·m
(1.0 kgf·m, 7.2 lbf·ft)

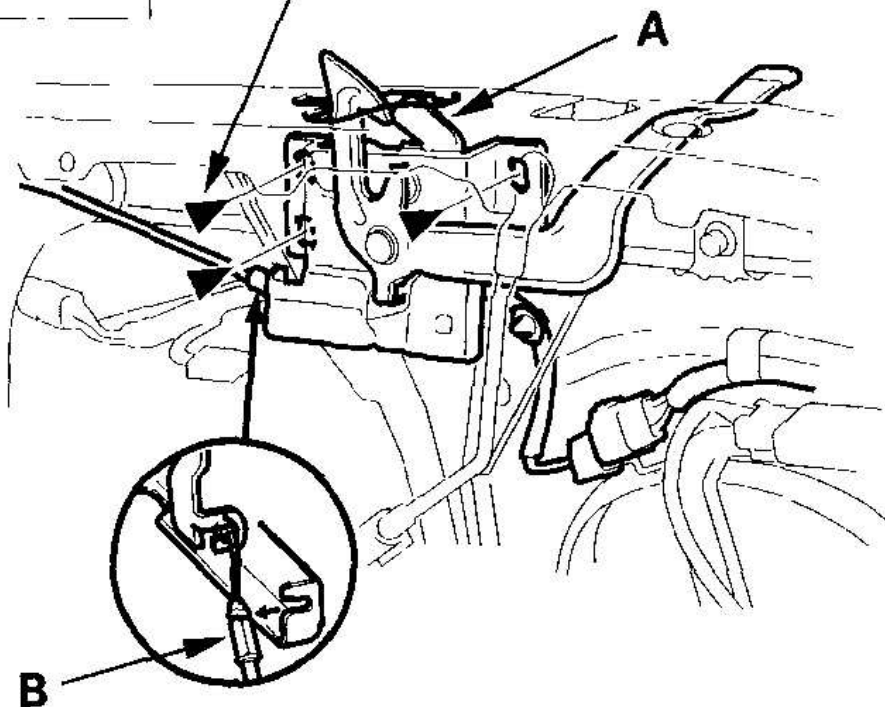

G03641785

Fig. 5: Removing Hood Latch Bolts

Courtesy of AMERICAN HONDA MOTOR CO., INC.

2. Detach the hood opener cable (B) from the latch, then remove the latch from the body.
3. Disconnect the hood opener cable (A) from the hood latch (B), and disconnect the hood latch switch connector (C), and detach the harness clip (D). Take care not to kink the cable.

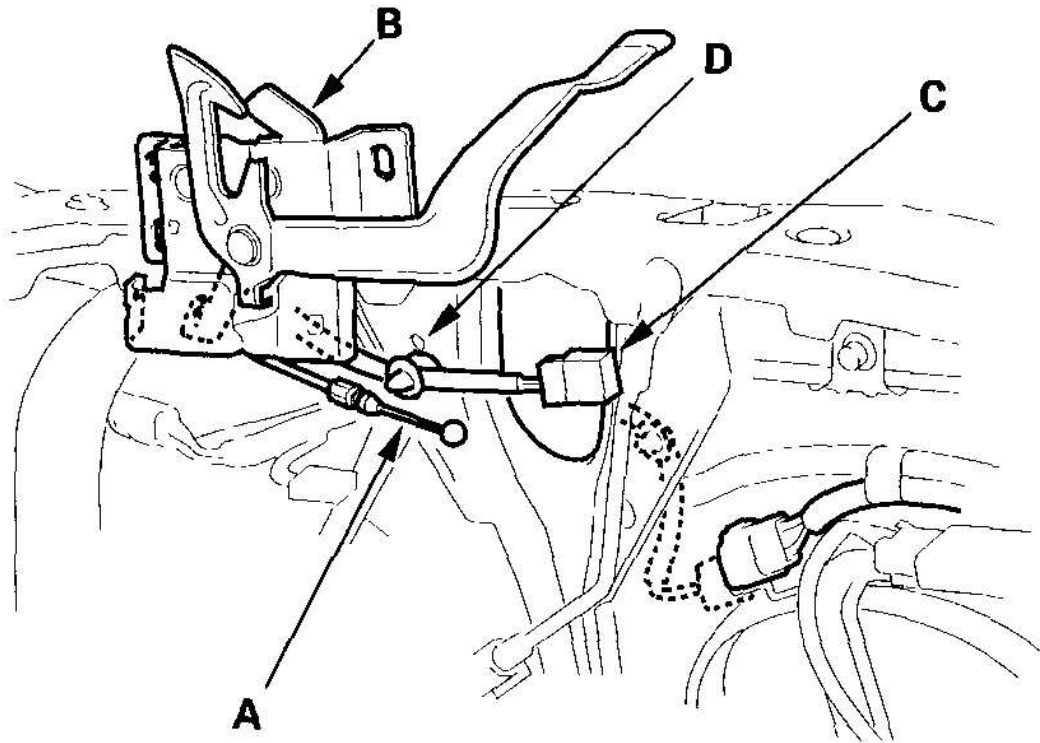

G03641786

Fig. 6: Disconnecting Hood Opener Cable From Hood Latch
 Courtesy of AMERICAN HONDA MOTOR CO., INC.

4. Install the hood latch in the reverse order of removal, and note these items:
 - Apply multipurpose grease to each location of the hood latch as indicated by the arrows shown in **Fig. 7**.
 - Make sure the hood opener cable is connected properly and hood latch switch connector is plugged in properly.
 - Make sure the cable actuates the latch before you close the hood.
 - Adjust the hood latch alignment (see **ADJUSTMENT**).
 - Make sure the hood locks securely.

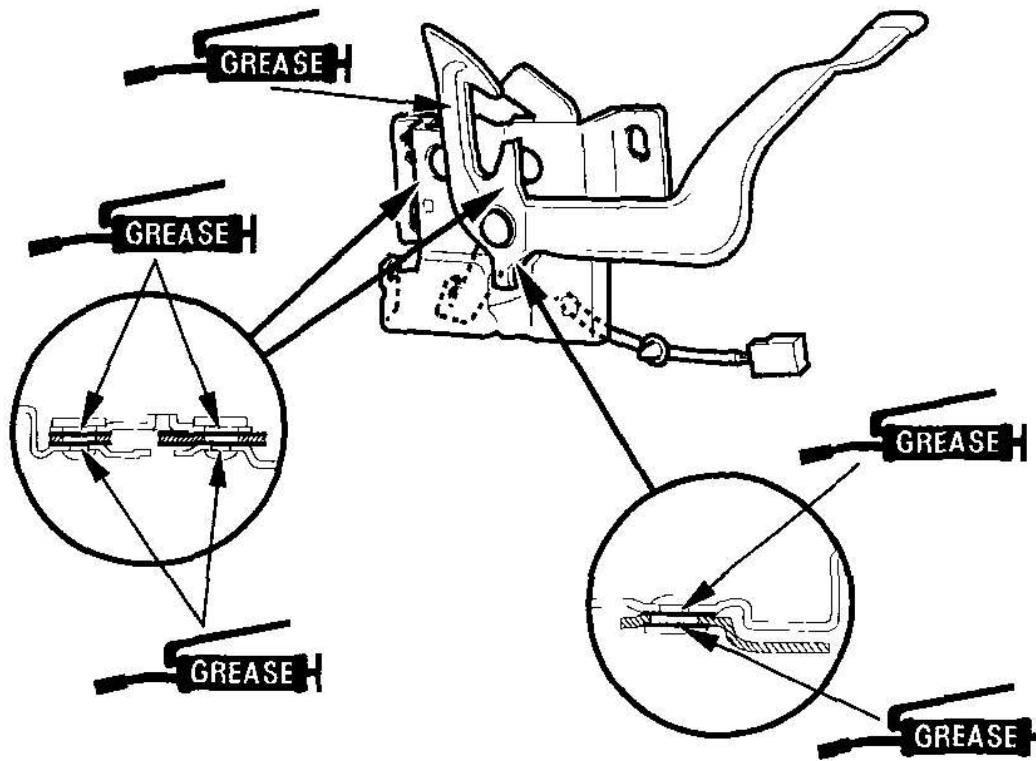

G03641787

Fig. 7: Applying Multipurpose Grease To Each Location Of Hood Latch
Courtesy of AMERICAN HONDA MOTOR CO., INC.

FUEL FILL DOOR OPENER REPLACEMENT

1. Remove the opener knob (A).

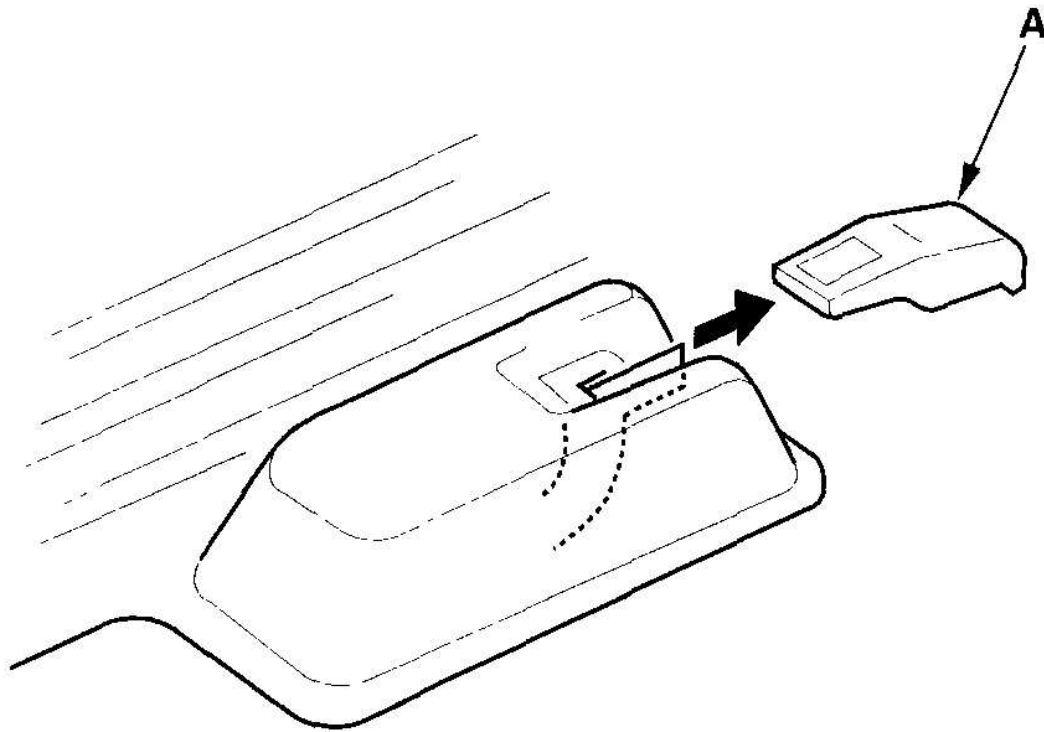

G03641788

Fig. 8: Removing Opener Knob

Courtesy of AMERICAN HONDA MOTOR CO., INC.

2. Remove the front door sill trim (see step 1 in **TRIM REMOVAL/INSTALLATION - DOOR AREAS**).
3. Turn over the carpet (A) and remove the bolts, then remove the fuel fill door opener (B) from the floor.

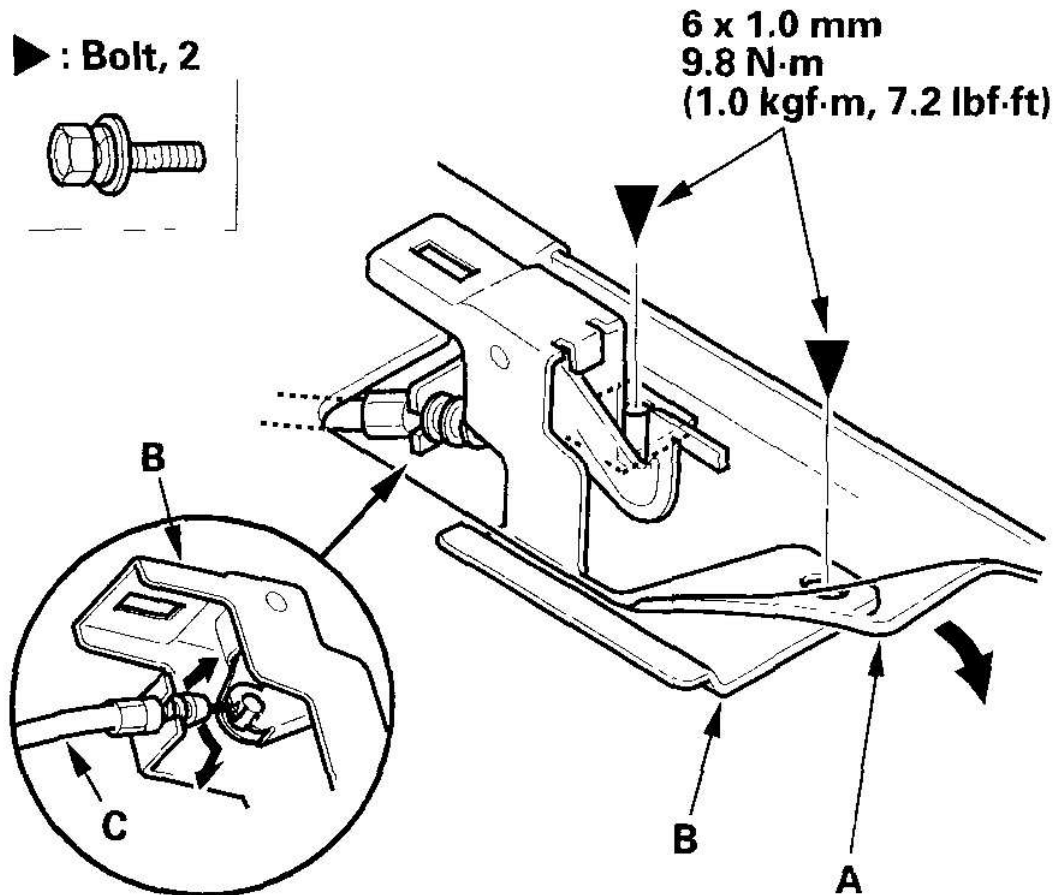
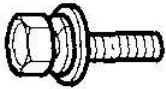
Fastener Locations**► : Bolt, 2**

G03641789

Fig. 9: Turning Over Carpet And Removing Bolts
Courtesy of AMERICAN HONDA MOTOR CO., INC.

4. Disconnect the fuel fill door opener cable (C), then remove the fuel fill door opener. Take care not to kink the cable.
5. Install the fuel fill door opener in the reverse order of removal, and note these items:
 - Make sure the opener cable is connected properly.
 - Make sure the fuel fill door opens properly.

TAILGATE HANDLE REPLACEMENT

NOTE: Put on gloves to protect your hands.

1. Remove the tailgate trim panel (see **TRIM REMOVAL/INSTALLATION - TAILGATE AREA**).
2. Disconnect the handle cable (A) from the tailgate handle (B). Take care not to kink the cable.

Fastener Locations

● : Nut, 2



6 x 1.0 mm
9.8 N·m (1.0 kgf·m, 7.2 lbf·ft)

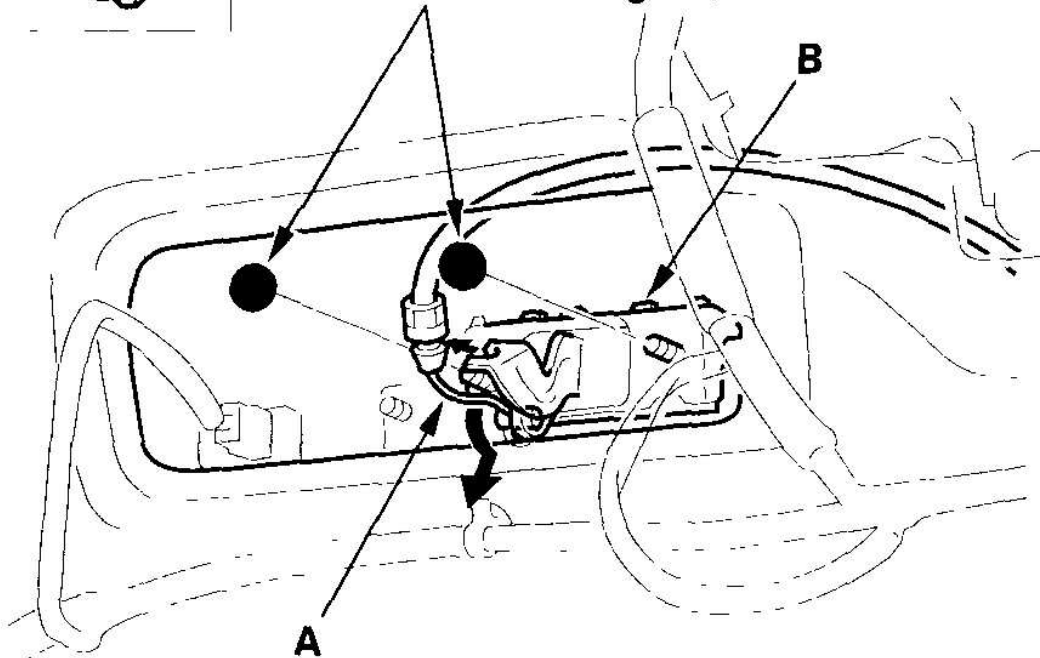

G03641790

Fig. 10: Disconnecting Handle Cable From Tailgate Handle
Courtesy of AMERICAN HONDA MOTOR CO., INC.

3. Remove the nuts, then remove the tailgate handle.
4. Install the tailgate handle in the reverse order of removal, and note these items:
 - Make sure the handle cable is connected securely.
 - Make sure the tailgate opens properly.

TAILGATE LATCH REPLACEMENT

NOTE: Put on gloves to protect your hands.

1. Remove the tailgate trim panel (see **TRIM REMOVAL/INSTALLATION - TAILGATE AREA**).
2. Disconnect the handle cable (A), tailgate latch actuator connector (B), and tailgate latch switch connector (C), and detach the connector. Take care not to kink the cable.

Fastener Locations

► : Bolt, 3

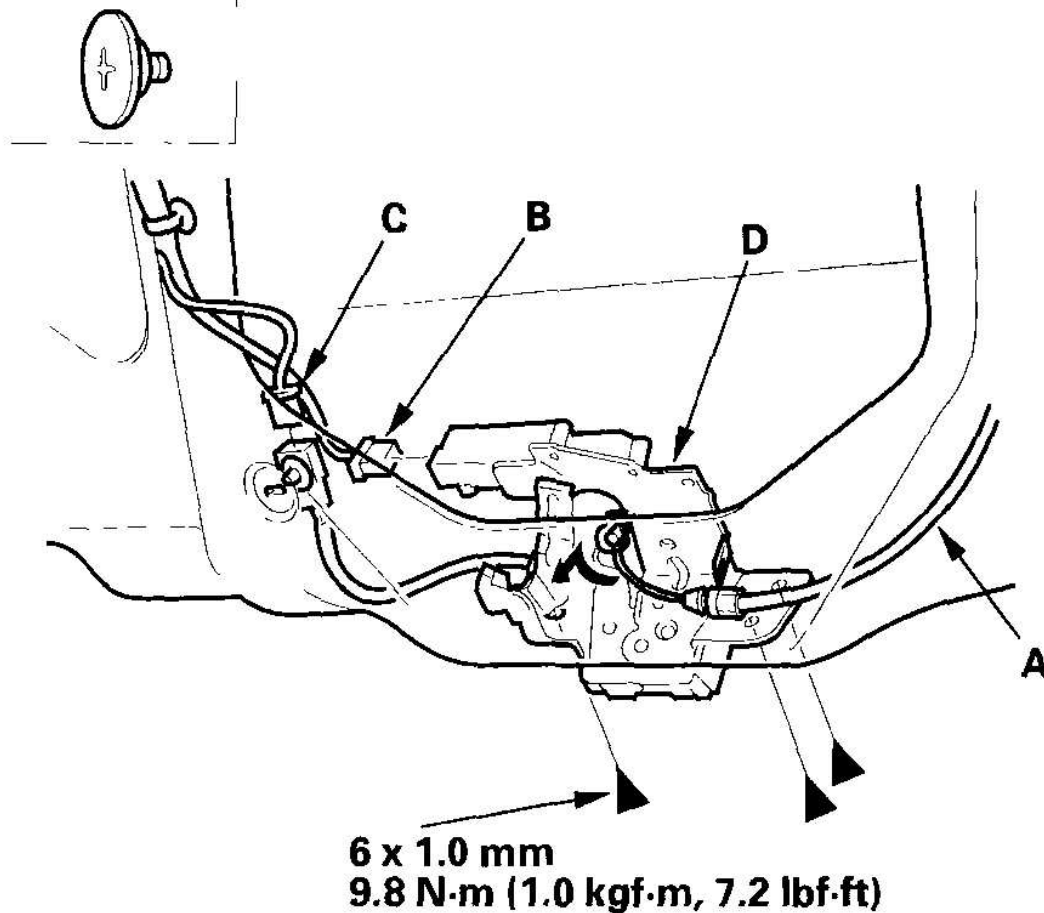

G03641791

Fig. 11: Disconnecting Handle Cable, Tailgate Latch Actuator Connector And Tailgate Latch Switch Connector

Courtesy of AMERICAN HONDA MOTOR CO., INC.

3. Remove the bolts, then remove the tailgate latch (D).
4. Install the tailgate handle in the reverse order of removal, and note these items:

2006 Acura MDX

2003-06 ACCESSORIES & EQUIPMENT Openers - MDX

- Make sure the connectors are plugged in properly and the handle cable is connected properly.
- Make sure the cable actuate the latch before you close the tailgate.
- Make sure the tailgate opens properly and locks securely.