

**2004-06 ACCESSORIES & EQUIPMENT**

**Power Lumbar Support - MDX**

**COMPONENT LOCATION INDEX**

**'04-06 Touring models**

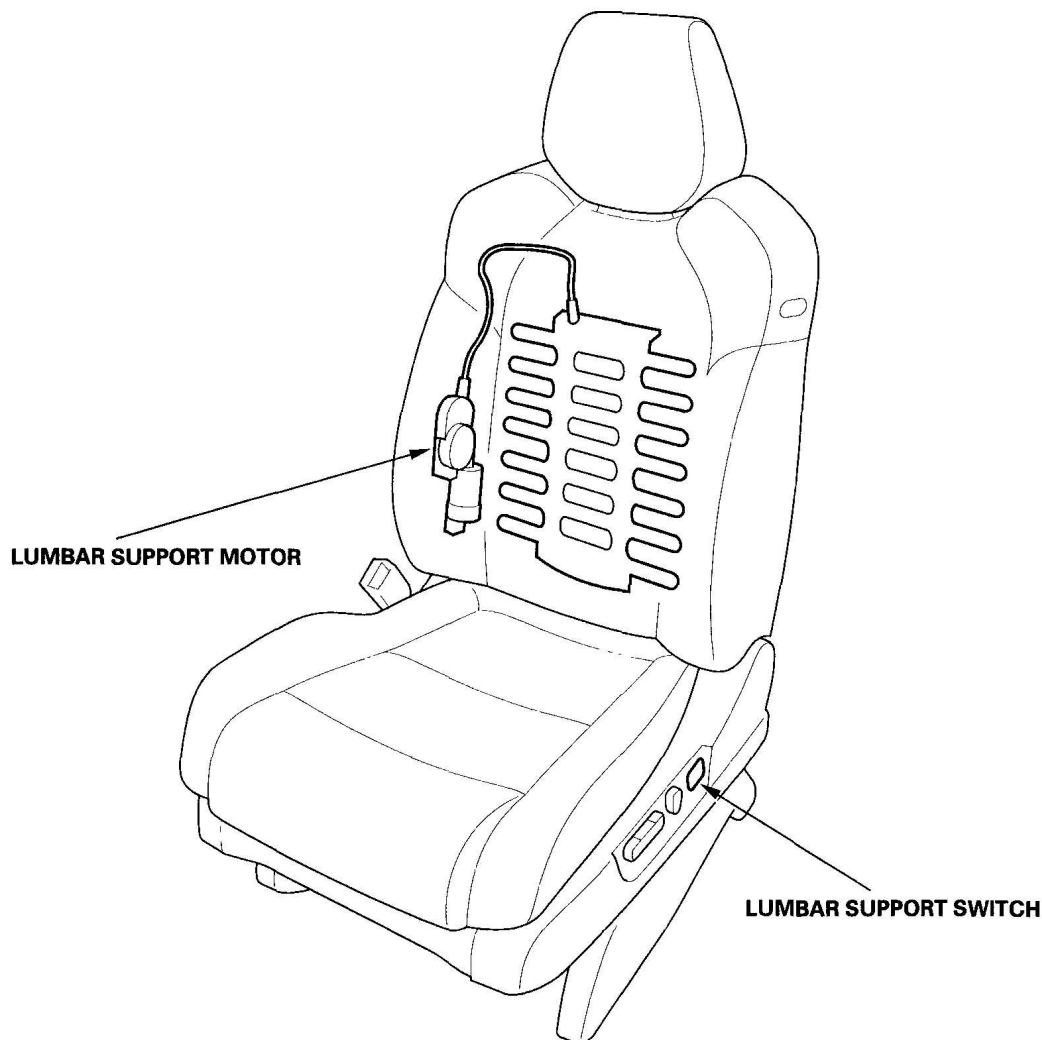

G03642278

**Fig. 1: Identifying Power Lumbar Support Components ('04-06 Touring Models)**  
**Courtesy of AMERICAN HONDA MOTOR CO., INC.**

**2006 Acura MDX**

2004-06 ACCESSORIES & EQUIPMENT Power Lumbar Support - MDX

**CIRCUIT DIAGRAM**

## 2006 Acura MDX

### 2004-06 ACCESSORIES & EQUIPMENT Power Lumbar Support - MDX

#### '04-06 Touring models

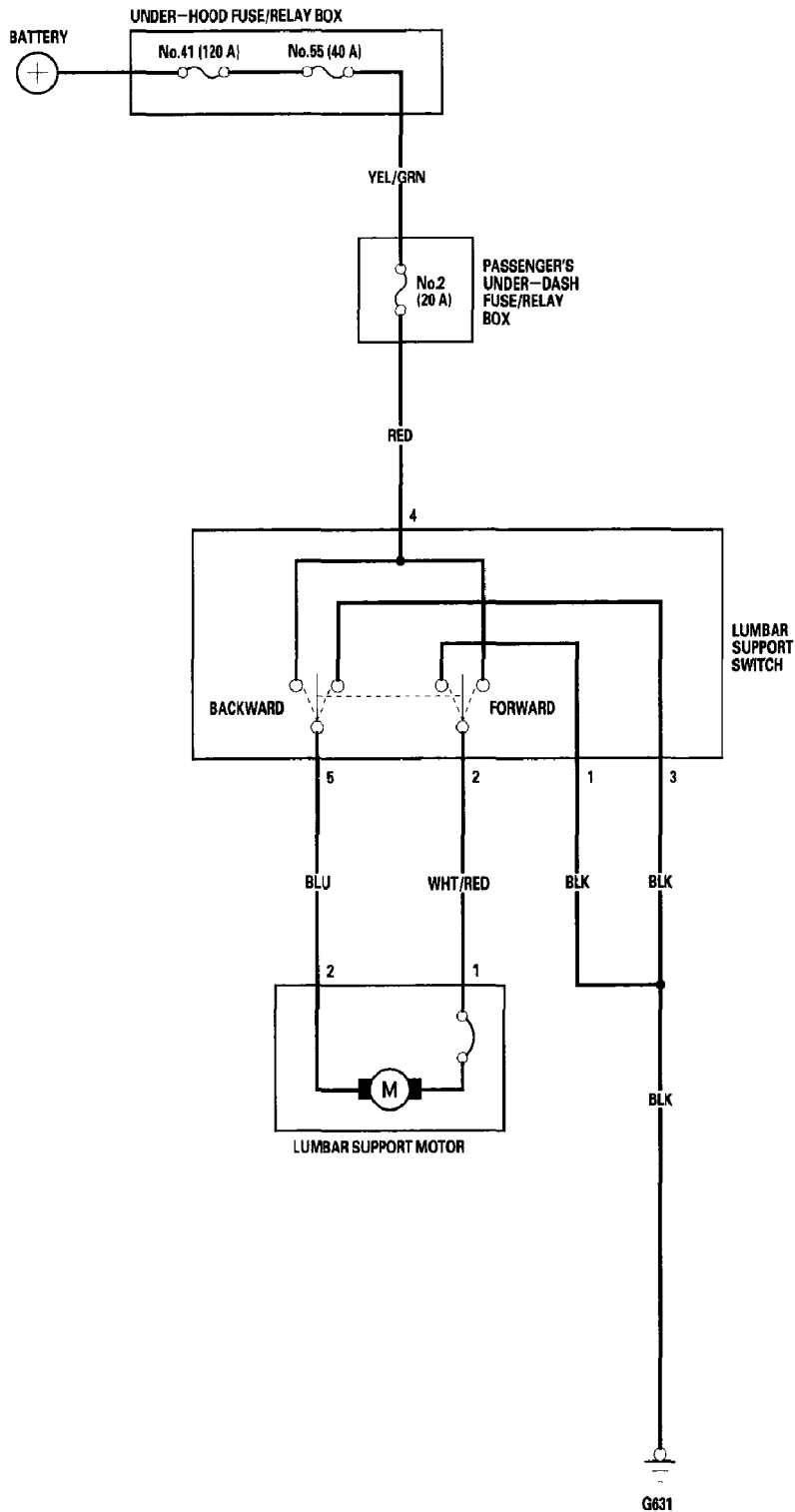
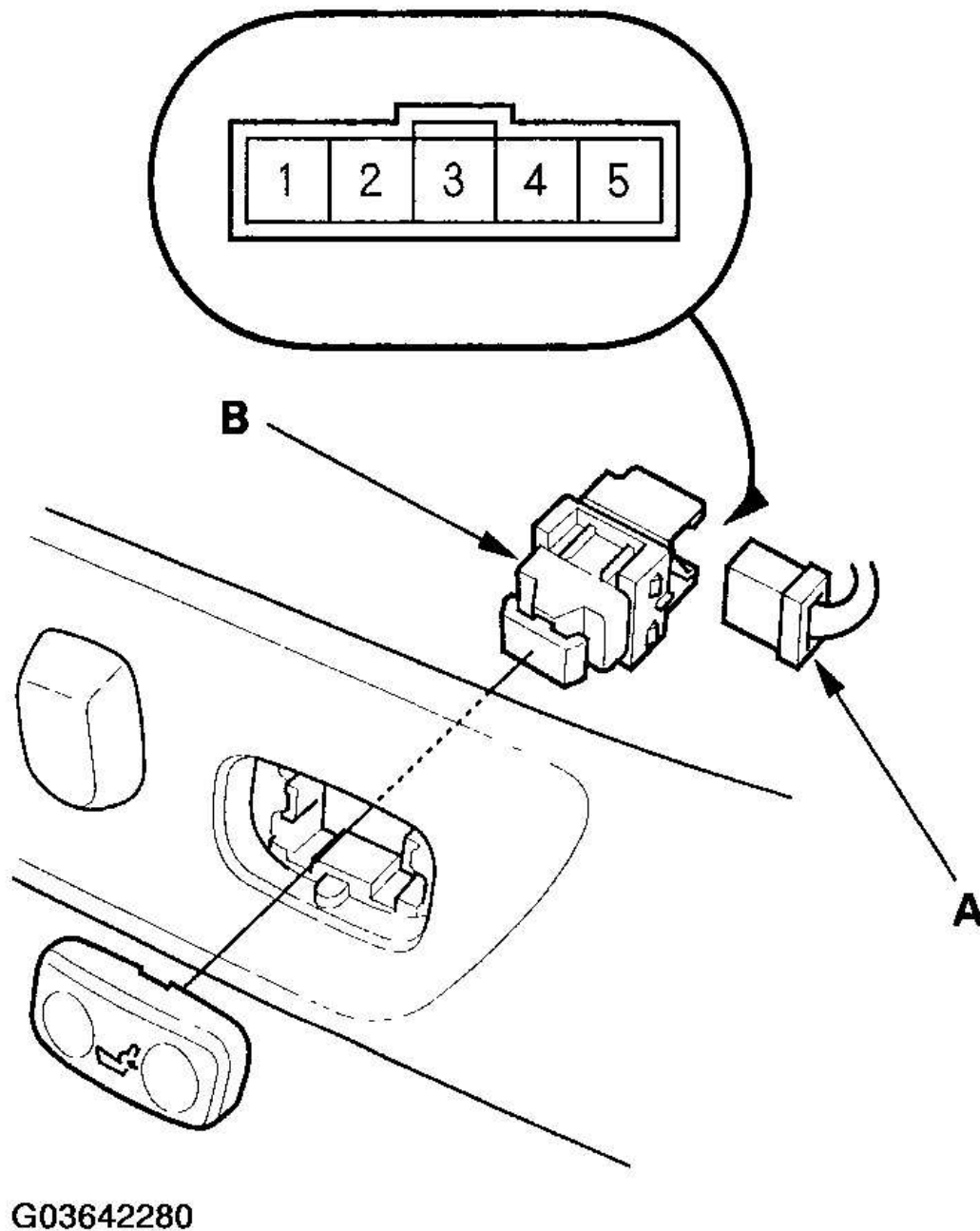

**Fig. 2: Circuit Diagram - Power Lumbar Support ('04-06 Touring Models)**  
Courtesy of AMERICAN HONDA MOTOR CO., INC.

## **SWITCH TEST/REPLACEMENT**

### **'04-'06 TOURING MODELS**

1. Remove the recline cover (see **'04-06 MODELS** ).
2. Disconnect the 5P connector (A) from the lumbar support switch (B).



**Fig. 3: Disconnecting 5P Connector From Lumbar Support Switch**  
Courtesy of AMERICAN HONDA MOTOR CO., INC.

3. Carefully remove the switch from the recline cover.
4. Check for continuity between the terminals in each switch position according to **Fig. 4**.

Terminal Position	1	2	3	4	5
Forward		○	○	○	○
Backward	○	○		○	○

G03642281

**Fig. 4: Checking Continuity Between Terminals In Each Switch Position Chart**  
 Courtesy of AMERICAN HONDA MOTOR CO., INC.

5. If the continuity is not as specified, replace the switch.

## MOTOR TEST

### '04-'06 TOURING MODELS

1. Remove the driver's seat (see **FRONT SEAT REMOVAL/INSTALLATION** ).
2. Disconnect the 2P connector (A) from the lumbar support motor.

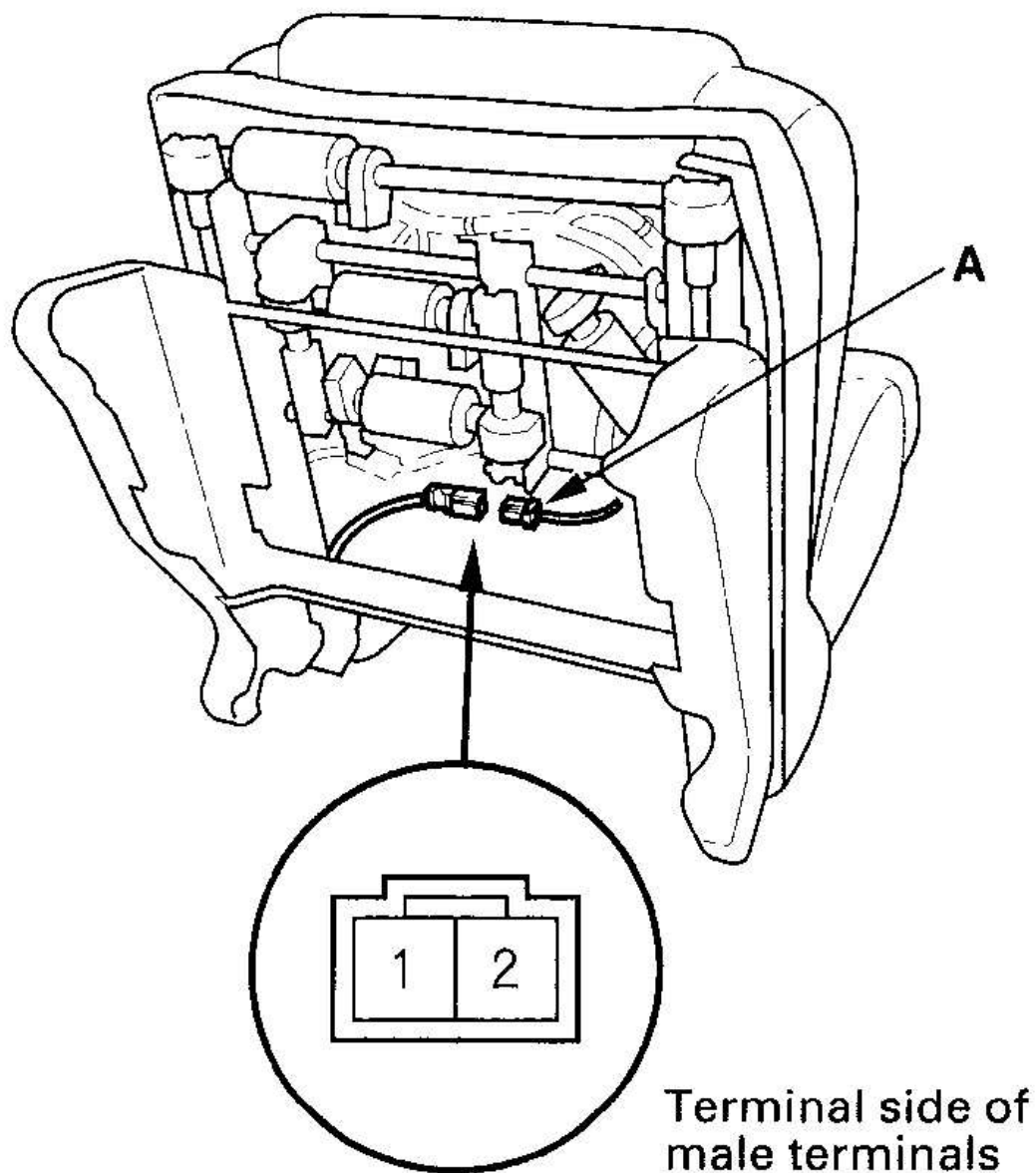

G03642282

**Fig. 5: Disconnecting 2P Connector From Lumbar Support Motor**  
Courtesy of AMERICAN HONDA MOTOR CO., INC.

3. Test the motor by connecting power and ground according to **Fig. 6**.

Terminal Position	1	2
Forward	⊕	⊖
Backward	⊖	⊕

G03642283

**Fig. 6: Testing Motor Connecting Power And Ground Chart**  
Courtesy of AMERICAN HONDA MOTOR CO., INC.

4. If the motor does not run or fail to run smoothly, replace it (see '**04-06 MODELS**').